

Problem Details:

- On M2 Plus 4-Door crew cab units, the door locks switches on the FWD doors open the 4 door locks, but the switches on the rear doors only open their own door lock. All door locks should open from any door position.

FSPRs, FRACAS, DPR, Zeus:

- Shop Call 553331

Affected Models / Truck options:

- Population A- for vehicles ordered with Data code 655-005 = 563 vehicles
- Population B- for vehicles ordered with Data code 655-028 = 122 vehicles
- Total Population = 685 Vehicles**

Responsible Supplier:

- DTNA

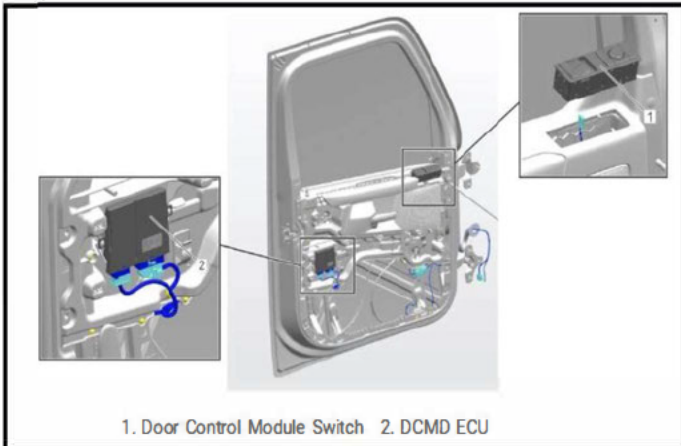

Production Containment:

No Yes

- Corrections:
- If 655-005 (Population A) is present, Apply 66W-D002 or make the following parameter changes:
 - DCMD02T: remove 007 447 71 32, add 007 447 72 32.
 - DCMP02T: remove 000 447 43 19, add 000 447 44 19
 - DCMDR01T: remove 008 447 00 32, add 007 447 99 32
 - DCMPR01T: remove 000 447 70 19, add 000 447 69 19
- If 655-028 (Population B) is present, Apply 66W-D003 or make the following parameter changes:
 - DCMD02T: remove 007 447 71 32, add 007 447 72 32.
 - DCMP02T: remove 000 447 43 19, add 000 447 44 19

Field Containment (short term):

- Same as production containment

No Yes

Root Cause:

- Incorrect charting for Data codes 655-005 and 655-028

No Yes

Long Term Corrective Action Plan:

- Corrected with EWR P24CAB-53

No Yes

Long Term Field Plan:

- Publish Field Service Campaign SF701 on 10/9/2024.

No Yes