

Title:	Aerial Wear Pad and Guide Pad Adjustment			
Number:	712	Release Date:	10/08/2024	
Revision Number:	Not Applicable	Revision Date:	Not Applicable	
Chassis Type:	Custom Chassis w/ Ascendant and Non-Ascendant Ladders & Platforms			
Component Description:	Wear pad and guide pad adjustment for Ascendant and Non-Ascendant Ladders & Platforms			
Tools:	Non-Ascendant Ladders & Platforms: Aerial Shim Sheet, Black (PN 4610718) Ascendant Ladders & Platforms: Aerial Shim Sheet, Coral (PN 4610721)			

Purpose:

This bulletin will cover the general procedures for adjusting the wear pads and guide pads on Ascendant and Non-Ascendant Ladders & Platforms.

Procedure:

Non-Ascendant (Legacy) Ladders & Platforms



When replacing wear/guide pads, ladder rails contacting wear/guide pads on attaching brackets must be properly supported. Proper support can be achieved by using a crane or resting rails on a solid supporting object. Failure to comply may result in serious injury to personnel.



After replacing and adjusting each set of wear/guide pads, aerial must be operated to ensure gapping is set correctly and that there are no tight spots before replacing other wear/guide pads. Failure to comply may result in damage to equipment.

NOTE:

- The location and orientation of wear/guide pad and mounting components may vary depending on vehicle configuration, but the general procedure remains the same.
- The side (vertical) guide pads hold the ladder sections in alignment (side-to-side) and are located at the rear of the ladder sections.
- Wear pads and guide pads gaps should be set when the ladder section is at its tightest spot.
- Each section must be adjusted to ensure smooth operation of entire ladder system.
- Shim sheets should be cut to size as needed.



1. With the ladder at 0-degrees of elevation, extend/retract ladder section (1) as needed to find the tightest spot on the ladder section (1) and support with solid supporting object.
2. Loosen jam nuts (2) and set screws (3) on ladder section (1).

NOTE: The ladder to guide pad clearance should be 1/16-inch on each side (1/8-inch total).

3. Insert 1/8-inch shim sheet (PN 4610718) or feeler gauge between guide pad (4) and ladder section (1).
4. Tighten set screws (3) until guide pad (4) makes uniform contact with shim sheet or feeler gauge.
5. Tighten set screws (3) and jam nuts (2).
6. Remove and insert shim sheet or feeler gauge fully to ensure guide pad (4) is tightened evenly.
7. Extend/retract ladder section (1) as needed to ensure ladder section (1) operates smoothly.
8. If ladder section (1) still has tight spots, repeat steps 1-7 as needed until ladder section (1) operates smoothly.

Ascendant Ladders & Platforms

WARNING

When replacing wear pads and guide pads, ladder rails contacting guide pads and wear pads on attaching brackets must be properly supported. Proper support can be achieved by using a crane or resting rails on a solid supporting object. Failure to comply may result in serious injury to personnel.

CAUTION

After replacing and adjusting each set of wear/guide pads, aerial must be operated to ensure gapping is set correctly and that there are no tight spots before replacing other wear/guide pads. Failure to comply may result in damage to equipment.

NOTE:

- The location and orientation of wear/guide pad and mounting components may vary depending on vehicle configuration, but the general procedure remains the same.
- The side (vertical) guide pads hold the ladder sections in alignment (side-to-side) and are located at the rear of the ladder sections.
- Wear pads and guide pads gaps should be set when the ladder section is at its tightest spot.
- Each section must be adjusted to ensure smooth operation of entire ladder system.
- Shim sheets should be cut to size as needed.

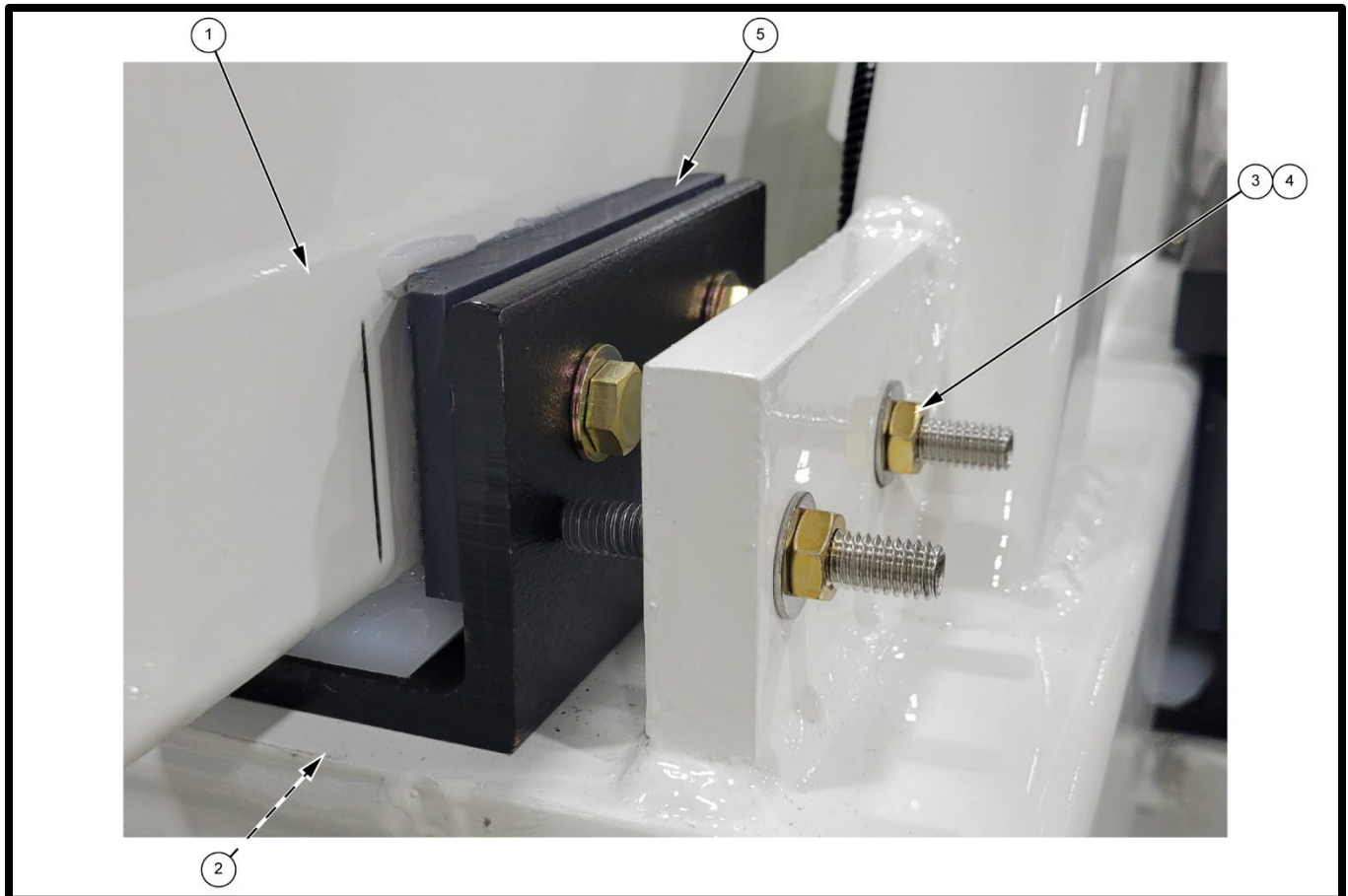

1. With the ladder at 0 degrees of elevation, extend/retract ladder section (1) as needed to find the tightest spot on the ladder section (1) and support with solid supporting object.

SERVICE BULLETIN #712

2. Loosen two screws (2).
3. Loosen jam nuts (3) and set screws (4) on ladder section (1).

NOTE: The ladder to guide pad clearance should be 1/32-inch on each side (1/16-inch total).

4. Insert 1/16-inch shim sheet (PN 4610721) or feeler gauge between guide pad (5) and ladder section (1).
5. Tighten set screws (4) until guide pad (5) makes contact with shim sheet or feeler gauge.
6. Tighten set screws (4) and jam nuts (3).
7. Remove and insert shim sheet or feeler gauge fully to ensure guide pad (5) is tightened evenly.
8. Extend/retract ladder section (1) as needed to ensure ladder section (1) operates smoothly.
9. If ladder section (1) still has tight spots, repeat steps 1-8 as needed until ladder section (1) operates smoothly.

If any additional support is needed, please open a technical support incident on Pierceparts.com.