



Technical Service Bulletin

SUBJECT: CORRECTION TO WINDSHIELD WIPER AND WASHER MAINTENANCE PROCEDURE – SERVICE MANUAL REVISION			No: TSB-24-51-003
			DATE: October 2024
			MODEL: Eclipse Cross
CIRCULATE TO:	<input type="checkbox"/> GENERAL MANAGER	<input checked="" type="checkbox"/> PARTS MANAGER	<input checked="" type="checkbox"/> TECHNICIAN
<input checked="" type="checkbox"/> SERVICE ADVISOR	<input checked="" type="checkbox"/> SERVICE MANAGER	<input checked="" type="checkbox"/> WARRANTY PROCESSOR	<input type="checkbox"/> SALES MANAGER

PURPOSE

This TSB provides correction to the Windshield Wiper and Washer Maintenance Procedure in the applicable Service Manuals:

AFFECTED VEHICLES

2018–2020 and 2022–2025 Eclipse Cross

AFFECTED SERVICE MANUAL

- 2018–2020 and 2022–2025 Eclipse Cross Service Manual

PROCEDURE

Please use the following chart as a guide to replace the indicated pages in the affected Service Manual, Group 51, Exterior, Windshield Wiper and Washer, Windshield Washer, windshield Washer Removal and Installation.

Applicable Manual	Pub. No.	Applicable Title	Contents	
2018 ECLIPSE CROSS Service Manual	MSCD-020B-2018	EXTERI └ WINDSHIELD WIPER AND WASHER └ WINDSHIELD WASHER └ WINDSHIELD WASHER REMOVAL AND INSTALLATION	Attached sheet 2	
2019 ECLIPSE CROSS Service Manual	MSCD-020B-2019			
2020 ECLIPSE CROSS Service Manual	MSCD-020B-2020			
2022 ECLIPSE CROSS Service Manual	MSCD-020B-2022			Attached sheet 3
2023 ECLIPSE CROSS Service Manual	MSCD-020B-2023			
2024 ECLIPSE CROSS Service Manual	MSCD-020B-2024			
2025 ECLIPSE CROSS Service Manual	MSCD-020B-2025			



Copyright 2024, Mitsubishi Motors North America, Inc.

<p>The information contained in this bulletin is subject to change. For the latest version of this document, go to the Mitsubishi Dealer Link, MEDIC, or the Mitsubishi Service Information website (www.mitsubishitechinfo.com).</p>

WINDSHIELD WIPER AND WASHER

WINDSHIELD WASHER

REMOVAL AND INSTALLATION

- Pre-removal and Post-installation Operation**
- Front Bumper Assembly Removal and Installation.
 - Splash Shield (RH) Mounting Clips Removal and Installation (Refer to GROUP 42A, Splash Shield).
 - Windshield Washer Fluid Draining and Filling.
 - Rear Washer Hose Connection.
 - Windshield Washer Motor Connector Connection.

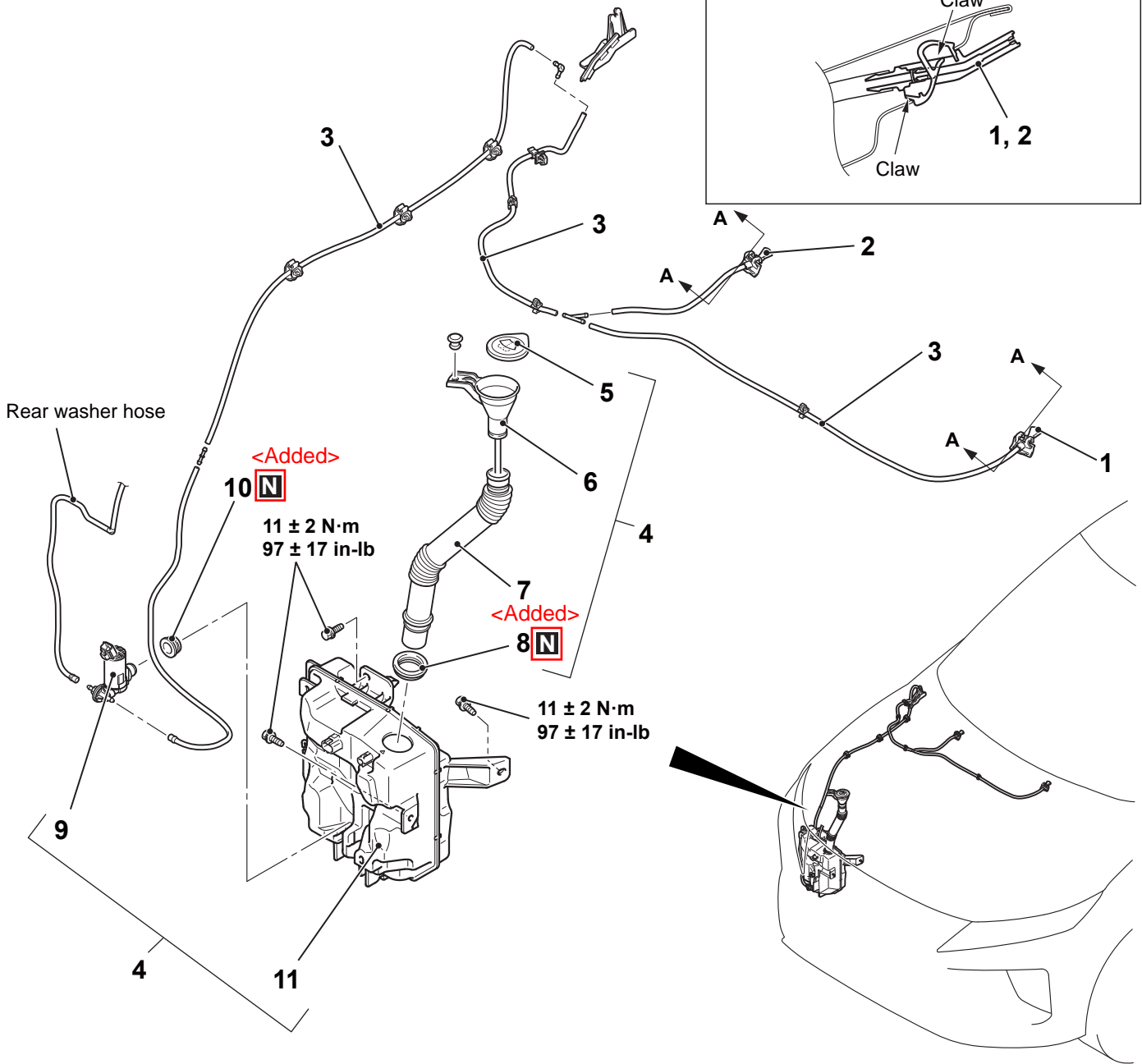
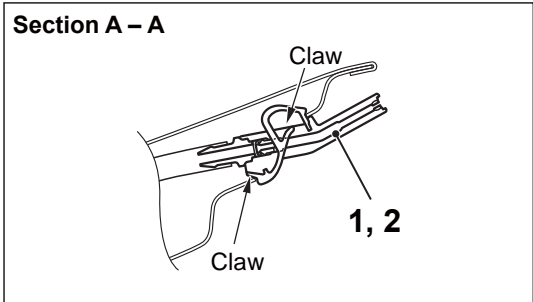

BCH04385AD

WINDSHIELD WASHER

REMOVAL AND INSTALLATION

- Pre-removal and Post-installation Operation**
- Front Bumper Assembly Removal and Installation.
 - Splash Shield (RH) Mounting Clips Removal and Installation (Refer to GROUP 42A, Splash Shield).
 - Windshield Washer Fluid Draining and Filling.

<Up to 20 Model year>

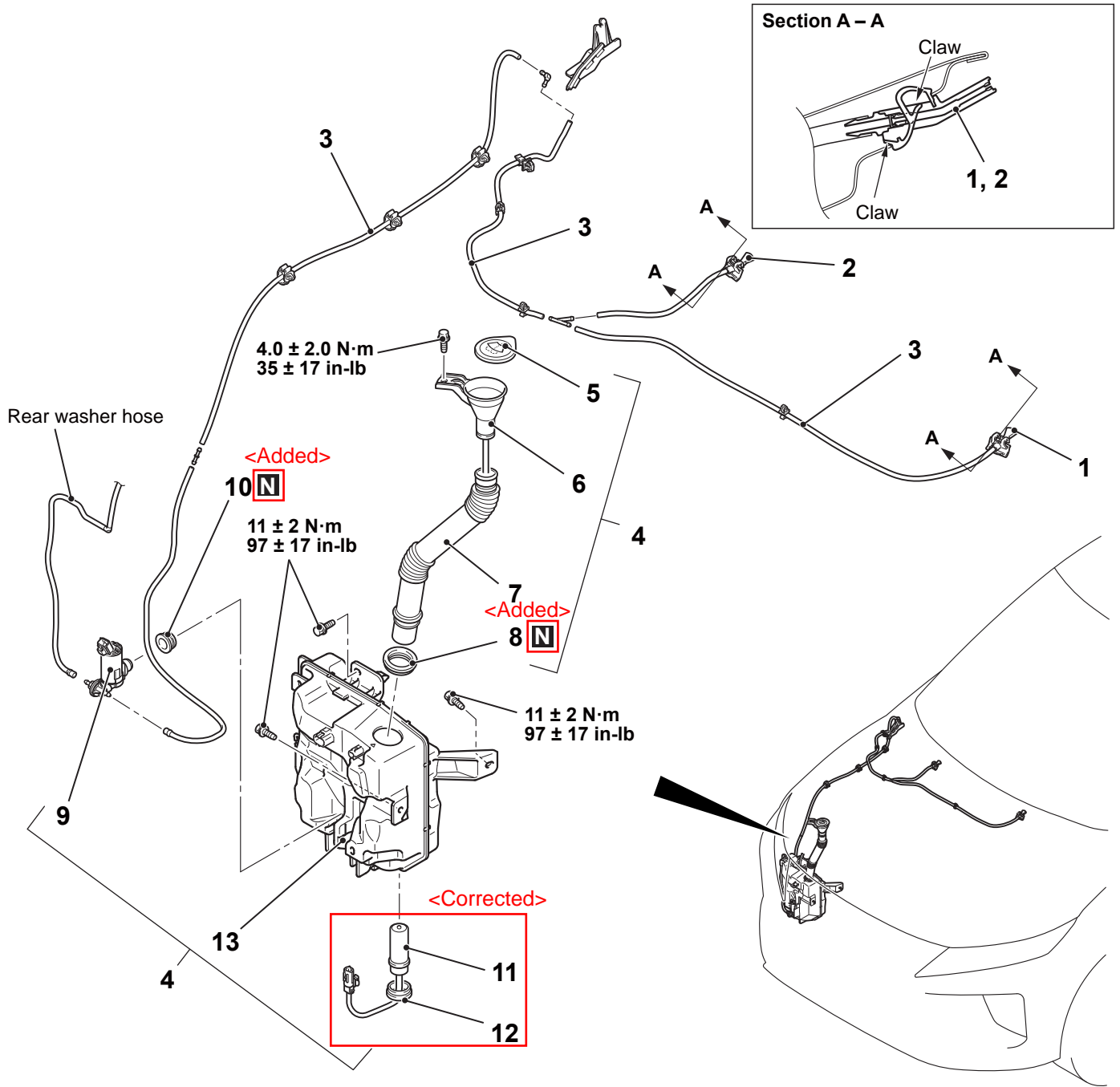

BCH02860AH

**EXTERIOR
WINDSHIELD WIPER AND WASHER**

Attached sheet 3 (2/3)

Removal steps

1. Windshield washer nozzle assembly
<LH>
2. Windshield washer nozzle assembly
<RH>
3. Windshield washer hose
4. Windshield washer tank assembly
5. Windshield washer tank filler cap
6. Windshield washer tank filler hose A
7. Windshield washer tank filler hose B
8. Grommet
9. Windshield and rear washer motor

Removal steps

10. Windshield washer tank inlet gasket
11. Windshield washer tank fluid level
sensor
- <Added> 12. Grommet
13. Windshield washer tank

NOTE: For removal and installation of the wiper and washer switch, refer to GROUP 54A, Column Switch

<From 22 Model year>

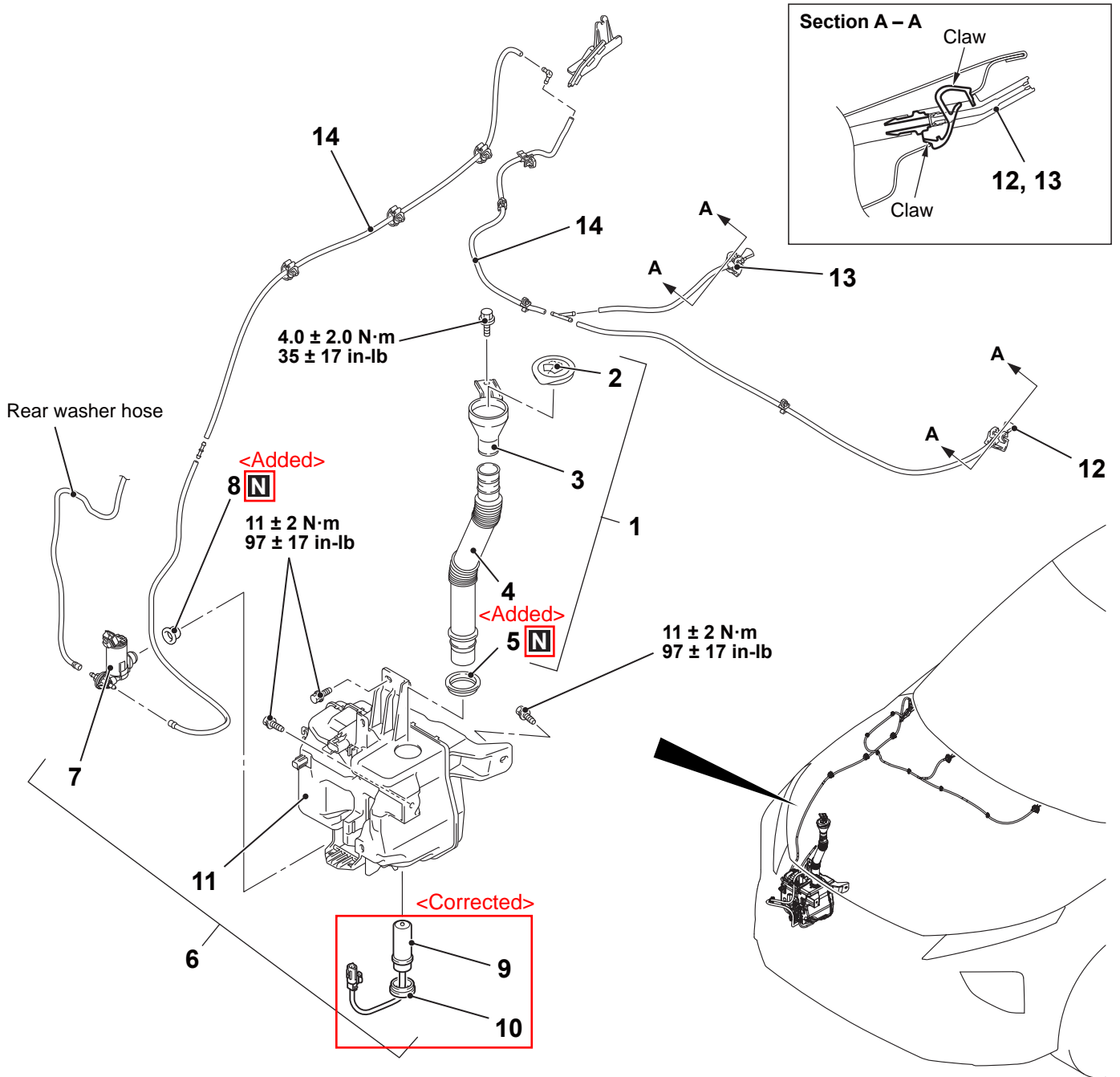

BCKA2179AJ

Removal steps

1. Windshield washer tank assembly
2. Windshield washer tank filler cap
3. Windshield washer tank filler hose A
4. Windshield washer tank filler hose B
5. Grommet
6. Windshield washer tank assembly
7. Windshield washer motor
8. Windshield washer tank inlet gasket
9. Windshield washer tank fluid level sensor

Removal steps

- <Added> **10. Grommet**
11. Windshield washer tank
 12. Windshield washer nozzle assembly
 13. Windshield washer nozzle assembly
 14. Windshield washer hose

NOTE: For removal and installation of the wiper and washer switch, refer to GROUP 54A, Column Switch