



# Technical Service Bulletin

<b>SUBJECT:</b> <b>STEERING COLUMN SHAFT  DISASSEMBLY AND ASSEMBLY –  SERVICE MANUAL REVISION</b>			No: <b>TSB-24-37-003</b>
			DATE: <b>October 2024</b>
			MODEL: <b>Mirage &amp; Mirage G4</b>
<b>CIRCULATE TO:</b>	<input type="checkbox"/> GENERAL MANAGER	<input checked="" type="checkbox"/> PARTS MANAGER	<input checked="" type="checkbox"/> TECHNICIAN
<input checked="" type="checkbox"/> SERVICE ADVISOR	<input checked="" type="checkbox"/> SERVICE MANAGER	<input checked="" type="checkbox"/> WARRANTY PROCESSOR	<input type="checkbox"/> SALES MANAGER

## PURPOSE

This TSB provides Steering Lock Bolt changes for the Steering Column Shaft Disassembly and Assembly sections of the applicable Service Manuals:

## AFFECTED VEHICLES

2014-2024 Mirage  
2017-2024 Mirage G4

## AFFECTED SERVICE MANUAL

- 2014-2024 Mirage Service Manual
- 2017-2024 Mirage G4 Service Manual

## PROCEDURE

Please use the following chart as a guide to replace the indicated pages in the affected Service Manuals, Group 37, Electric Power Steering (EPS), Steering Column Shaft Assembly, Disassembly and Assembly.



Copyright 2024, Mitsubishi Motors North America, Inc.

The information contained in this bulletin is subject to change. For the latest version of this document, go to the Mitsubishi Dealer Link, MEDIC, or the Mitsubishi Service Information website ([www.mitsubishitechinfo.com](http://www.mitsubishitechinfo.com)).

**MMNA  
MIRAGE**

<b>Applicable Manual</b>	<b>Pub. No.</b>	<b>Applicable Title</b>	<b>Content</b>
2014 MIRAGE Service Manual	MSCD-016B-2014	ELECTRIC POWER STEERING (EPS) └ STEERING COLUMN SHAFT ASSEMBLY └ DISASSEMBLY AND REASSEMBLY	Attached sheet 2
2015 MIRAGE Service Manual	MSCD-016B-2015		
2017 MIRAGE Service Manual	MSCD-016B-2017	ELECTRIC POWER STEERING (EPS) └ STEERING COLUMN SHAFT ASSEMBLY └ DISASSEMBLY AND ASSEMBLY	
2018 MIRAGE Service Manual	MSCD-016B-2018		
2019 MIRAGE Service Manual	MSCD-016B-2019		
2020 MIRAGE Service Manual	MSCD-016B-2020		
2021 MIRAGE Service Manual	MSCD-016B-2021		
2022 MIRAGE Service Manual	MSCD-016B-2022		
2023 MIRAGE Service Manual	MSCD-016B-2023		
2024 MIRAGE Service Manual	MSCD-016B-2024		

**MIRAGE G4**

<b>Applicable Manual</b>	<b>Pub. No.</b>	<b>Applicable Title</b>	<b>Content</b>
2017 MIRAGE G4 Service Manual	MSCD-018B-2017	ELECTRIC POWER STEERING (EPS) └ STEERING COLUMN SHAFT ASSEMBLY └ DISASSEMBLY AND REASSEMBLY	Attached sheet 2
2018 MIRAGE G4 Service Manual	MSCD-019B-2018		
2019 MIRAGE G4 Service Manual	MSCD-019B-2019	ELECTRIC POWER STEERING (EPS) └ STEERING COLUMN SHAFT ASSEMBLY └ DISASSEMBLY AND ASSEMBLY	
2020 MIRAGE G4 Service Manual	MSCD-019B-2020		
2021 MIRAGE G4 Service Manual	MSCD-019B-2021		
2022 MIRAGE G4 Service Manual	MSCD-019B-2022		
2023 MIRAGE G4 Service Manual	MSCD-019B-2023		
2024 MIRAGE G4 Service Manual	MSCD-019B-2024		

## ELECTRIC POWER STEERING (EPS) STEERING COLUMN SHAFT ASSEMBLY

### DISASSEMBLY AND ASSEMBLY

M13720117A0031

#### **CAUTION**

When replacing the electric steering lock, complete the chassis number registration (Refer to GROUP 42B - On-vehicle Service, Registration when Replacing KOS&OSS-ECU and Electric Steering Lock).

&lt;Corrected&gt;

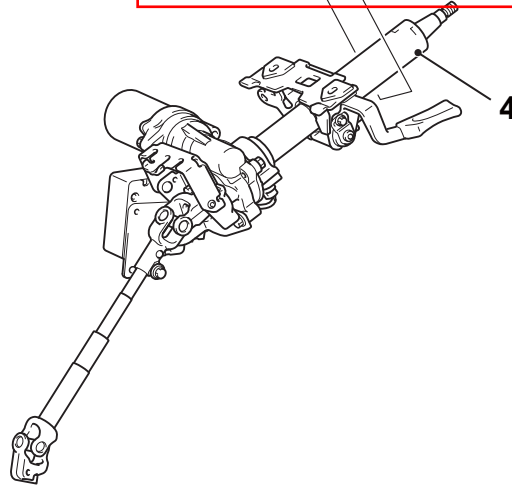
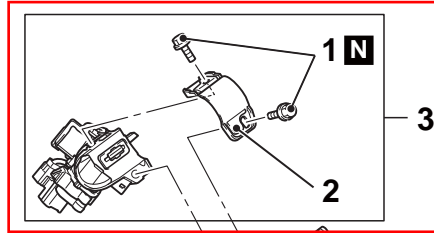

BCD00007AA

&lt;Added&gt;

&lt;&lt;A&gt;&gt;

&gt;&gt;A&lt;&lt;

#### Disassembly steps

1. Steering lock bolt
2. Steering lock bracket
3. Engine starting switch assembly
4. Steering column shaft assembly

&lt;Deleted&gt;

&gt;&gt;A&lt;&lt;

&gt;&gt;A&lt;&lt;

#### NOTE:

&lt;Added&gt;

- The steering lock bracket and the steering lock bolt is supplied not only as an individually but also assembly (the engine starting switch, the steering lock bracket and the steering lock bolt).
- When the engine starting switch assembly is supplied, the steering lock bracket is assembled to the engine starting switch assembly and the steering lock bolt head (upper) is broken off.
- For removal and installation of key reminder switch/key ring antenna and ignition switch, Refer to GROUP 54A, Ignition Switch .

### DISASSEMBLY SERVICE POINT <Corrected>

#### <<A>> STEERING LOCK BOLT REMOVAL

1. Use a drill to make a hole just deeply enough for the tap to stand on the steering lock bolt.
2. Remove the steering lock bolt using a screw extractor or equivalent.

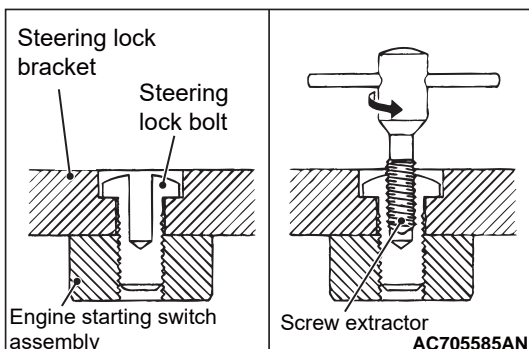

## ELECTRIC POWER STEERING (EPS) STEERING COLUMN SHAFT ASSEMBLY

### ASSEMBLY SERVICE POINT <Corrected>

#### >>A<< ENGINE STARTING SWITCH ASSEMBLY/STEERING LOCK BRACKET/STEERING LOCK BOLT INSTALLATION

1. Secure the steering lock bracket to the engine starting switch assembly with steering lock bolt (Upper). Tighten the steering lock bolt until its head is broken off.
2. Insert the engine starting switch assembly into the tip of the column shaft, fit the protrusion of the engine starting switch assembly to the hole of the steering column shaft assembly, install the engine starting switch assembly and tighten the steering lock bolt (lower) until its head is broken off.

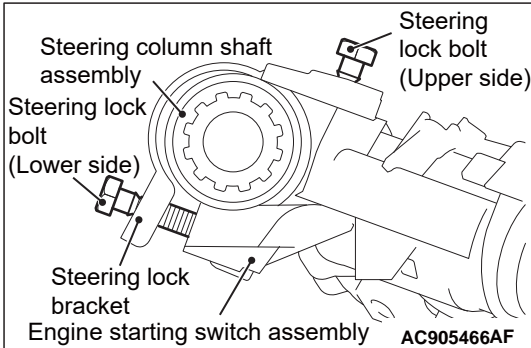

#### **CAUTION**

Connect the body side wiring harness connector to the key interlock solenoid connector. Do not connect the harness connector to the key interlock solenoid dummy connector.

