



GROUP	MODEL
ELE	2024MY EV9 (MV)
NUMBER	DATE
327 (Rev 2, 10/25/2024)	June 2024

## TECHNICAL SERVICE BULLETIN

### SERVICE ACTION: RSPA LOGIC IMPROVEMENT (SA558)

#### NOTICE

**This bulletin has been revised to include additional information. New/revised sections of this bulletin are indicated by a black bar in the margin area.**

This bulletin provides the procedure to update the software logic of the Advanced Drivers Assistance System Parking (ADAS\_PRK) system on certain 2024MY EV9 (MV) vehicles produced from September 24, 2023 through November 30, 2023, to restore Remote Start Parking Assist (RSPA) operation following incorrect software version installation, which may have resulted in RSPA becoming inoperative. This software upgrade may also be available via Over The Air (OTA) through Kia Connect if it has been activated. Follow the procedure outlined in this publication to apply the improved logic to the 'ADAS\_PRK' system using the KDS ECU Upgrade function in Manual Mode only as described in this bulletin. For confirmation that the latest reflash has been applied to a vehicle you are working on, verify the ROM ID using the table on page 6 of this bulletin.



#### NOTICE

**A Service Action is a repair program without customer notification that is performed during the warranty period. Any dealer requesting to perform this repair outside the warranty period will require DPSM approval.**

**Repair status for a VIN is provided on KDealer+ (Service → Warranty Coverage → Warranty Coverage Inquiry → Campaign Information). Not completed Recall / Service Action reports are available on KDealer+ (Consumer Affairs → Not Completed Recall → Recall VIN → Select Report), which includes a list of affected vehicles.**

**This issue number is SA558.**

A printed copy is for reference only; publication information can be updated at any time. Always refer to KGIS for the latest information. After logging in kdealer.com, the newest technical publications are listed in 'Service Releases' and has the latest service information that has been released.

**ECI Cable Configuration Procedure:**

- 1a. Connect the ECI DLC connector to the OBD-II connector, located under the driver’s side of the instrument panel.
- 1b. Connect the ECI USB -C connector to the KDS tablet.
- 1c. Connect the VCI II to the ECI OBD-II connector

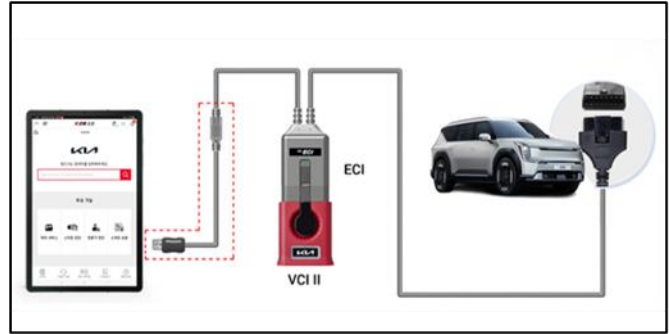

- 2. Select 'OK'.

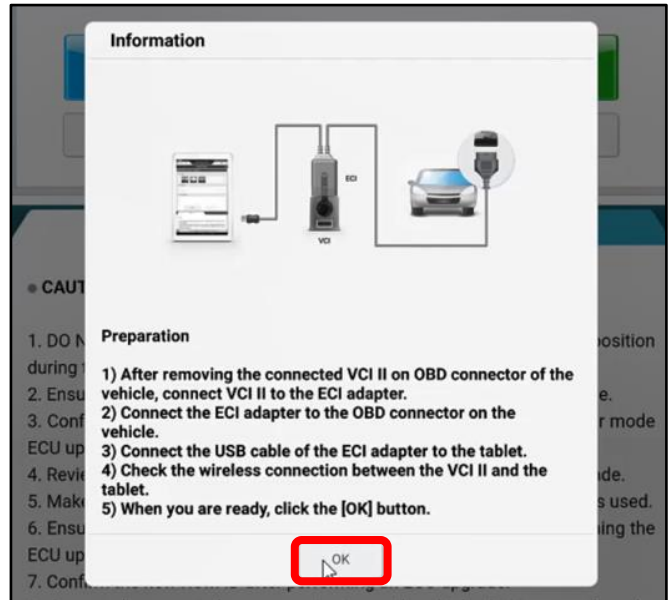

- 3a. Select 'Settings' on the KDS tablet.
- 3b. Select 'Connections'.
- 3c. Select 'More connection settings'.



SUBJECT:

# SERVICE ACTION: RSPA LOGIC IMPROVEMENT (SA558)

4. Select 'Ethernet'.

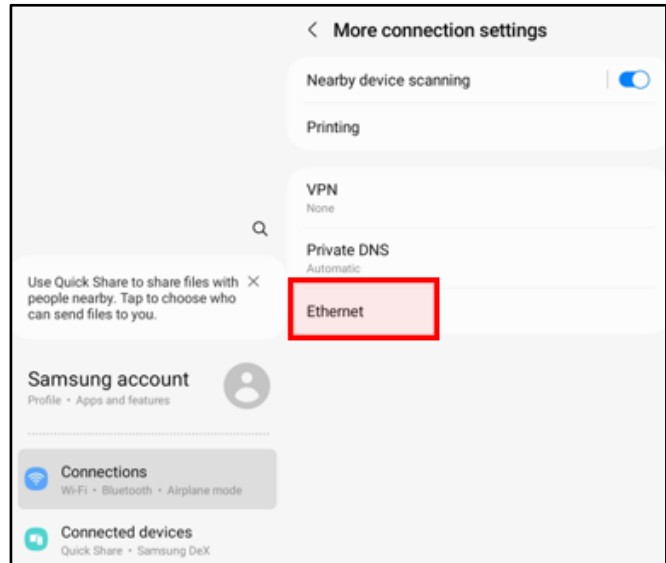

5. Select 'Configure Ethernet device'.

6. Select 'Static IP'.

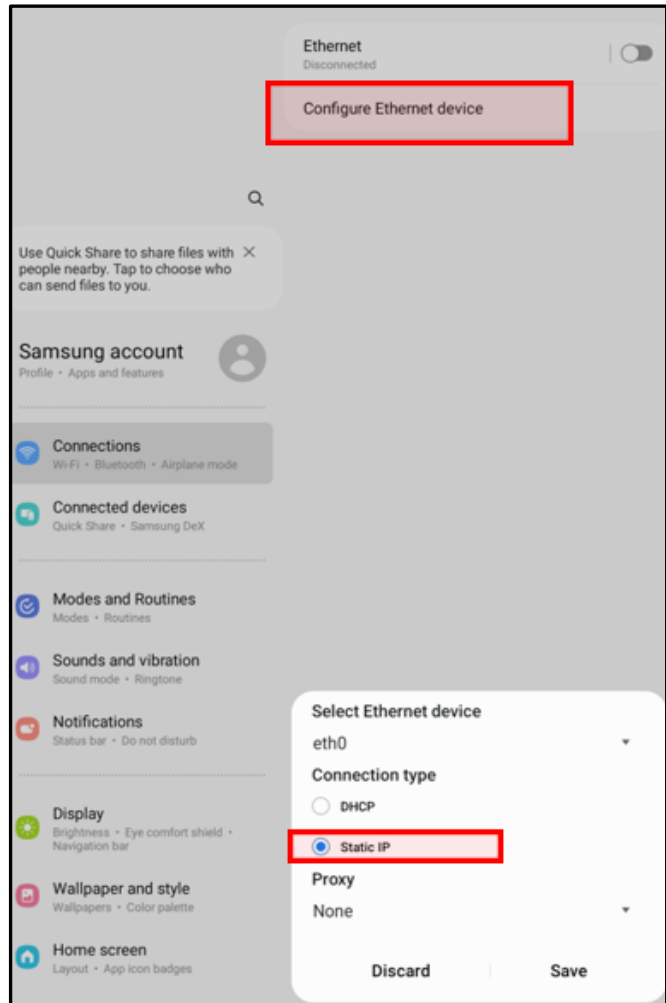

SUBJECT: **SERVICE ACTION: RSPA LOGIC IMPROVEMENT (SA558)**

- 7a. Input 10.0.128.0 under 'IP address'.
- 7b. Input 255.0.0.0 under 'Netmask'.
- 7c. Input 8.8.8.8 under 'DNS address'.
- 7d. Input 10.0.128.0 under 'Default gateway'.
- 8. Select 'Save'.



- 9. Proceed to 'ECU Upgrade Procedure' in Manual Mode ONLY.



SUBJECT:

## SERVICE ACTION: RSPA LOGIC IMPROVEMENT (SA558)

## ECU Upgrade Procedure:

To correct this condition, the ECU should be reprogrammed using the KDS download, as described in TSB [SST081](#).

**ⓘ IMPORTANT**

The ECU **MUST** be reprogrammed in **Manual Mode ONLY** using the KDS download as described in this bulletin.

**BOTH** Upgrade Event #719 **AND** Upgrade Event #720 need to be installed.

Upgrade Event Name
719.MV1 ADAS_PRK Operation Logic Improvement (MCU)
720.MV1 ADAS_PRK Operation Logic Improvement (VPU)

**📄 NOTICE**

- Confirm a **fully charged battery** (12.3 volts or higher is necessary) is used or utilize a fully charged jump starter box connected to the battery.
- **Ensure the KDS GDS is sufficiently charged at 60% or higher prior to reflash.**
- All ECU upgrades must be performed with the ignition set to the 'ON' position unless otherwise stated.
- **Damaged VCI II units should not be used and promptly replaced.**
- Be careful not to disconnect the VCI-II connected to the vehicle during the ECU upgrade procedure.
- **DO NOT start the engine during ECU upgrade.**
- DO NOT turn the ignition key 'OFF' or interrupt the power supply during ECU upgrade.
- **When the ECU upgrade is completed, turn the ignition 'OFF' and wait 10 seconds before starting the engine.**
- ONLY use approved ECU upgrade software designated for the correct application.

**ⓘ IMPORTANT**

It is recommended to ALWAYS check the Electronic Parts Catalog (EPC) to locate the ECU Part Number respective to Auto/Manual Mode ROM IDs. DO NOT reference the parts label affixed to the ECU.

**📄 NOTICE**

Before attempting an ECU upgrade on any Kia model, make sure to first determine whether the applicable model is equipped with an immobilizer  security system. Failure to follow proper procedures may cause the PCM to become inoperative after the upgrade and any claims associated with this repair may be subject to chargeback.



**ROM ID INFORMATION TABLE:**

Upgrade Event #719 (MCU) and #720 (VPU)

Event No.	System	Comment	ECU P/No.	ROM ID	
				Previous	New
719	ADAS (MCU)	No Lidar Normal Mirror	99910 D0000	1.03 1.04 1.05 1.06 1.07 1.08	1.09
720	ADAS (VPU)	No Lidar Normal Mirror	99910 D0000	1.03 1.04 1.05 1.06 1.07 1.08	1.08

*To verify the vehicle is affected, be sure to check the Calibration Identification of the vehicle's ECM ROM ID and reference the Information Table as necessary.*

SUBJECT:

**SERVICE ACTION: RSPA LOGIC IMPROVEMENT (SA558)**

Refer to [TSB SST081](#) for instructions to upgrade the 'ADAS/PRK' system:

Ensure the ECI cable is configured by referring to the '[KDS Configuration for ECI Cable Usage](#)'.

- 1a. Connect the ECI DLC connector to the OBD-II connector, located under the driver's side of the instrument panel.
- 1b. Connect the ECI USB -C connector to the KDS tablet.
- 1c. Connect the VCI II to the ECI OBD-II connector

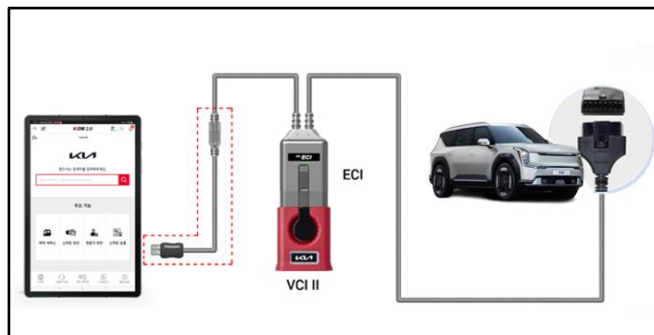

**UPGRADE BOTH EVENTS:**

- 719.MV1 ADAS\_PRK Operation Logic Improvement (MCU)
- 720.MV1 ADAS\_PRK Operation Logic Improvement (VPU)



**❗ IMPORTANT**

The ECU **MUST** be reprogrammed in **Manual Mode ONLY** using the KDS download as described in this bulletin.

**BOTH** Upgrade Event #719 **AND** Upgrade Event #720 need to be installed.

**❗ IMPORTANT**

An **Over-The-Air (OTA) Software Update** for this procedure is planned for release but may not be available at the time of TSB publication. Dealers can confirm OTA availability by checking for OTA release notes on the [Owners Portal](#) of [kia.com](#): [OTA Software Update Release Notes](#)

**Manual Mode ECU Upgrade Passwords**

Event No.	Menu	Password
#719	MV1 ADAS_PRK (No lidar, normal mirror) : 99910-DO000 (MCU)	4128
#720	MV1 ADAS_PRK (No lidar, normal mirror) : 99910-DO000 (VPU)	5195





SUBJECT:

**SERVICE ACTION: RSPA LOGIC IMPROVEMENT (SA558)**

**AFFECTED VEHICLE RANGE:**

Model	Production Date Range
EV9 (MV)	September 24, 2023 to November 30, 2023

**REQUIRED TOOL:**

Tool Name	Part Number	Figure	Comments
KDS	N/A		Kia Diagnostic System
ECI Adapter	GIT1XDDMN057 or GIT0XDDMN052		Located in Toolbox #1 Drawer 8

**WARRANTY INFORMATION:**

**N Code: N99 C Code: C99**

Claim Type	Causal P/N	Qty.	Repair Description	Labor Op Code	Op Time	Replacement P/N	Qty.
V	99910 D0000	0	(SA558) RSPA Logic Improvement	230138R1	0.5 M/H	N/A	0

**NOTICE**

VIN inquiry data for this repair is provided for tracking purposes only. Kia retailers should reference **SA558** when accessing the KDealer+ system.

