



# TECHNICAL SERVICE BULLETIN

<b>ISSUE DATE:</b>	04/07/2023
<b>SERVICE BULLETIN SUBJECT:</b>	ZX5.A02 Park Brake Override Tank Bracket Securement
<b>VINs or MODELS AFFECTED:</b>	Service Specified Buses
<b>COMPLETE BY:</b>	Next Service Opportunity
<b>SERVICE BULLETIN #:</b>	SC-23-044
<b>LABOR OPERATION CODE:</b>	BD44Z

**NOTICE! It is expected that this process may require up to 1 hour per bus. Please schedule appropriately to minimize vehicle downtime.**

## ZX5.A02 Park Brake Override Tank Bracket

### Description:

The procedure describes the process of removing the previously used parking brake tank bracket and installing a more secured bracket.

## Tools/Parts Required:

### Tools and Supplies Required:

- Wheel Lifts (Four Required)
- Jack Stands (Four Required)
- M13 Socket
- Torque Paint
- Torque Wrench
- Schrader Valve Tool

### Kit Parts Required:

- 064387 Kit, Service, Phoenix Park Brake Override Tank Bracket (Consisting of)
  - 138-3173 BRACKET, 2.5 GAL TANK 1 EA
  - 005443-004 BOLT,HEX,FLANGE,STL,YZPL,CLASS 10.9, M8-1.25X25X25 2 EA

## Procedure:

1. Use the Proterra approved Lockout/Tagout procedure to make the bus safe for work.
2. Using four Wheel Lifts, raise the bus into the air. Using four Jack Stands, support the bus for safety.
3. Using a Schrader Valve Tool, remove the four valve cores shown to drain the air bags located in the Streetside Access Panel.



4. Disconnect all air lines that connect to the parking tank.
5. Using a 13mm ratchet, remove parking brake tank by unscrewing the 4 M8 bolts from PN 052405 and set parking brake tank to the side.
6. Remove PN 052405 using an 13mm ratchet remove the 2 m8s at the rear of the bracket.

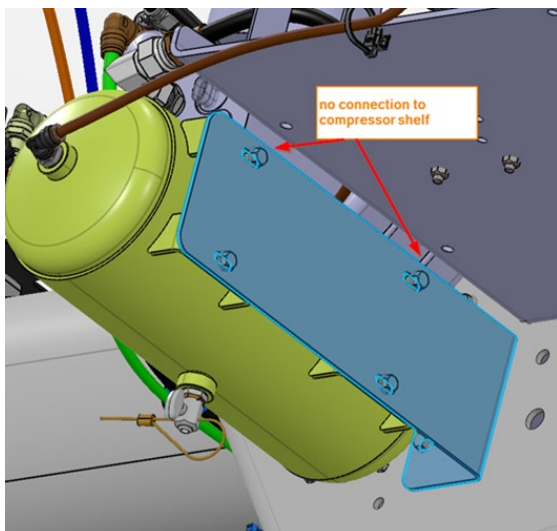

7. Install bracket provided (138-3173) using the additional hardware (005443-004). A 13mm wrench should be used to install bracket. Notice now that bracket has an additional point of contact to the bottom of the rear shelf.

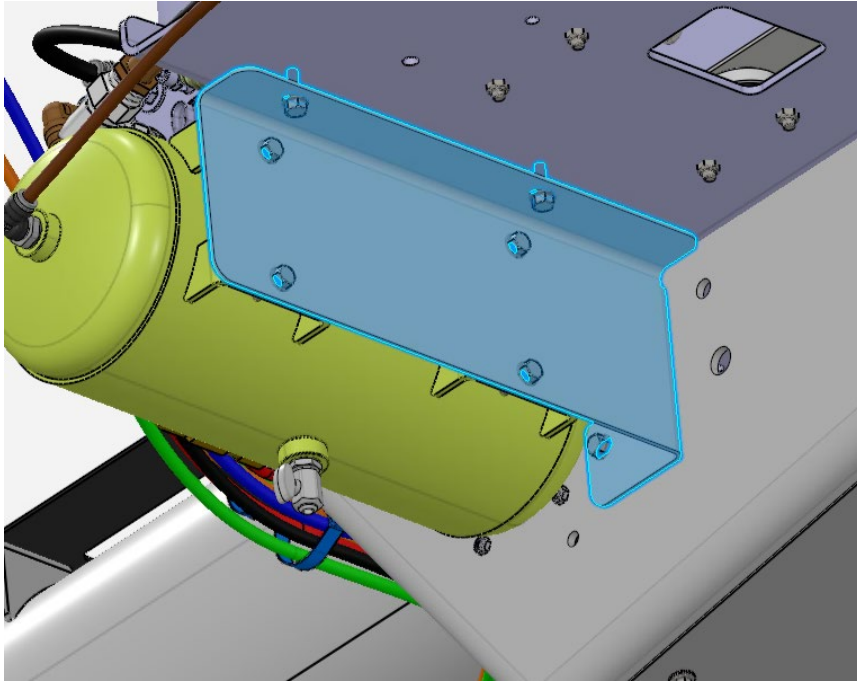

8. Using a Calibrated Torque Wrench with a 13mm Socket, **torque the 4 fasteners to 29 foot Pounds**. Apply torque stripe to the bolts after they are tightened.



9. Install the parking brake tank using the remaining hardware **torque the 4 fasteners to 29 foot Pounds**. Torque Strip these bolts.
10. Return the airlines to where they were previously connected.
11. Install the 4 cores back to the airbags using the Schrader Valve Tool.



12. Remove the Jack Stands and lower the bus using the Wheel Lifts.
13. Remove the Lockout/Tagout devices and return the bus to service.