

AAT, DS Hose Chutes, W-Access (P/N 4594522)			
P/N	DESC1	DESC2	QTY
4512470	CATWALK,4-WAY,RR CTR	AAT,DS CHT,PS CHT,W-ACCESS	1
82-2072-0100	SCREW,.25-20,HX HD,SS 1.00LG	1.00"LG	8
82-1030-0025	WASHER,FLAT,SS,ST,18-8 .25 BOLT, .69" OD		16
82-1017-003	WASHER,FLAT,NYLON,.25" X .50" .25 X .50		16
82-3037-0025	NUT,LOCK,NYLON INSERT,SS,NC .25-20NC		8
82-0270-0100	BOLT,.38-16NC,HX HD CS,YWZC,G8	1.00" LG	8
82-0270-0200	BOLT,.38-16NC,HX HD CS,YWZC,G8	2.00" LG	4
82-1033-004	WASHER,FLAT,STD,PLN	.38 DIA	12
4511725	CROSSMEMBER,BODY,TOP	RR,ASSY W-ACCESS	1
4512440	DOOR,CATWALK,4-WAY,RR CTR	AAT,TRQ BOLT ACCESS	2

AAT, PS Hose Chutes,W-Access (P/N 4594519)			
P/N	DESC1	DESC2	QTY
4512464	CATWALK,4-WAY,RR CTR	AAT,PS CHUTE,W-ACCESS	1
82-2072-0100	SCREW,.25-20,HX HD,SS 1.00LG	1.00"LG	8
82-1030-0025	WASHER,FLAT,SS,ST,18-8 .25 BOLT, .69" OD		16
82-1017-003	WASHER,FLAT,NYLON,.25" X .50" .25 X .50		16
82-3037-0025	NUT,LOCK,NYLON INSERT,SS,NC .25-20NC		8
82-0270-0100	BOLT,.38-16NC,HX HD CS,YWZC,G8	1.00" LG	8
82-0270-0200	BOLT,.38-16NC,HX HD CS,YWZC,G8	2.00" LG	4
82-1033-004	WASHER,FLAT,STD,PLN	.38 DIA	12
4511725	CROSSMEMBER,BODY,TOP	RR,ASSY W-ACCESS	1
4512440	DOOR,CATWALK,4-WAY,RR CTR	AAT,TRQ BOLT ACCESS	2

Removal

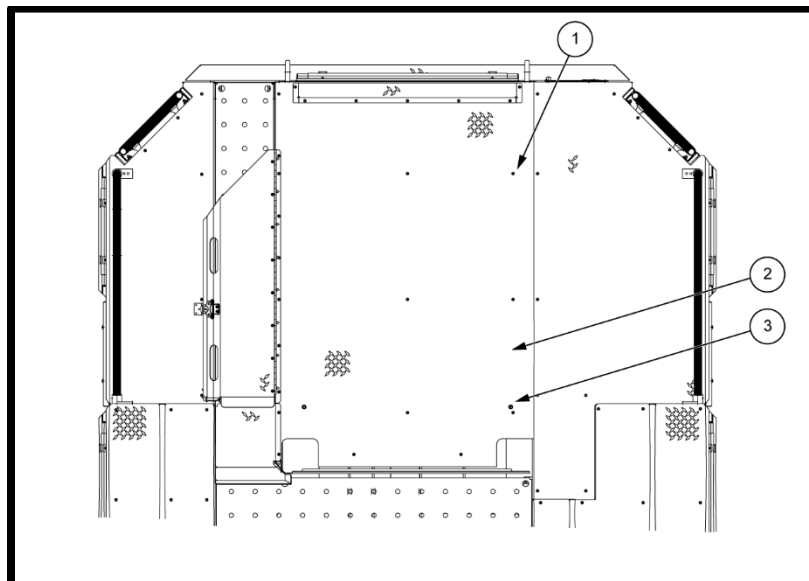

NOTE: Individual apparatus may be different than shown. Typical configuration shown.

1. Remove 23 screws (1) from walkway (2). Do not discard screws.

NOTE: Screws may require more force than would normally be required for a screw of equivalent size. Screws may have Loctite applied that needs to be taken into account.

2. Remove 2 screws (3) from catwalk (2). Do not discard screws.
3. Remove catwalk (2) from apparatus.

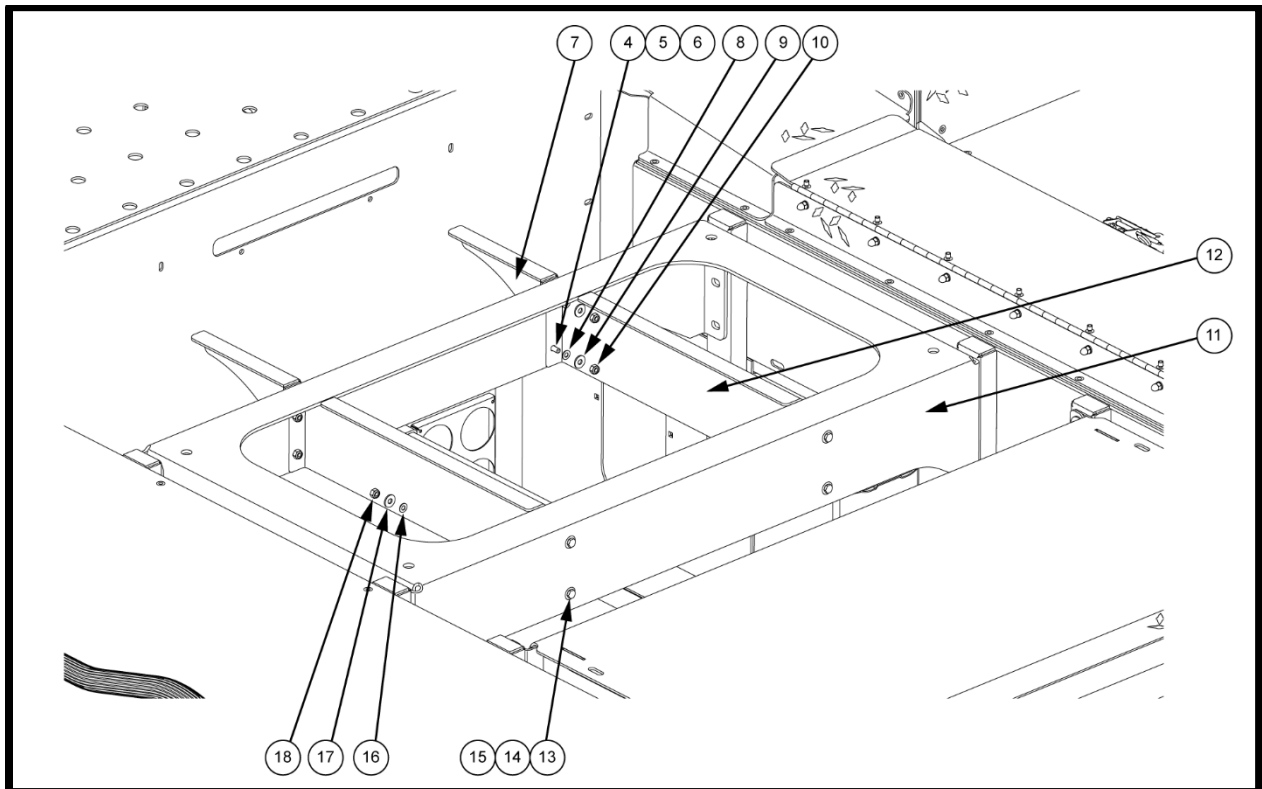

4. Remove 2 screws (4), washers (5), nylon washers (6), rear catwalk support bracket (7), 2 nylon washers (8), 2 washers (9), and 2 locknuts (10) from top rear body crossmember (11) and top rear crossmember braces (12). Discard screws, washers, nylon washers, and locknuts. Repeat for opposite side.
5. Remove 2 screws (13), 4 washers (14), 4 nylon washers (15) nut, 4 washers, and 2 locknuts from top rear body crossmember (11) and 2 top rear crossmember brace (12). Discard screws, washers, nylon washers, and locknuts. Repeat for opposite side
6. Remove 2 top rear crossmember braces (12) from top rear crossmember (11) and vehicle.

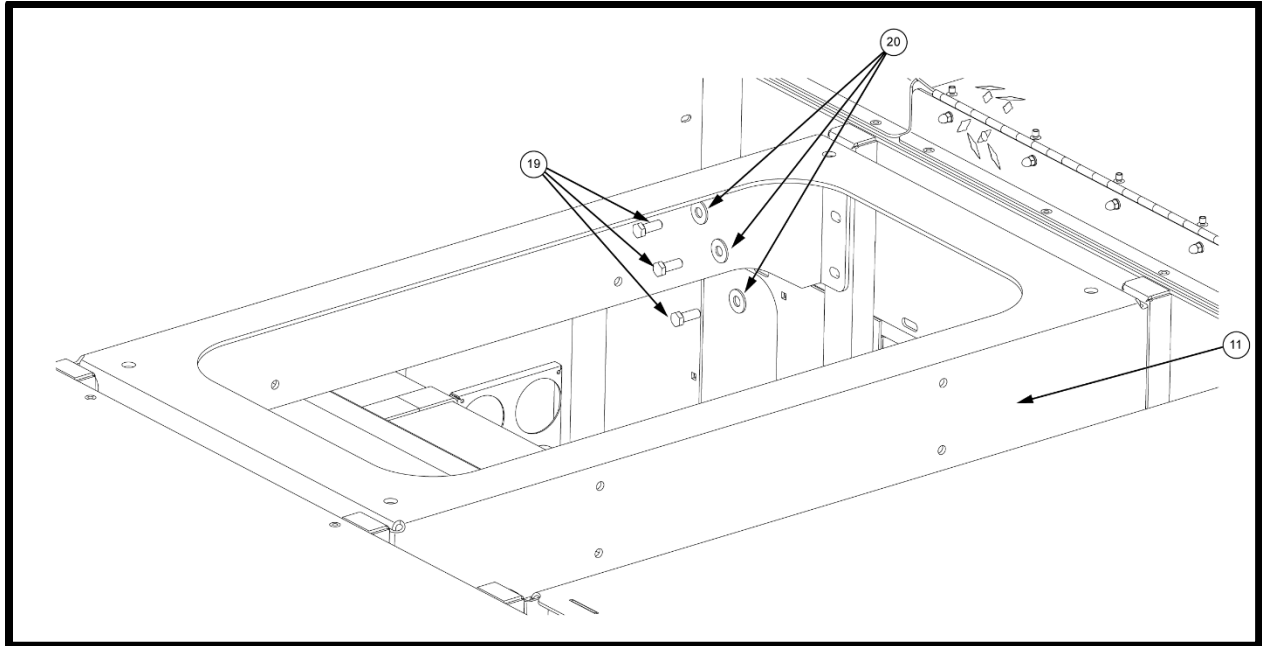

7. Remove 3 screws (12) and washers (13) from top rear body crossmember (11) and vehicle. Repeat for each corner of top rear body crossmember.
8. Remove top rear body crossmember (11) from vehicle.

Install

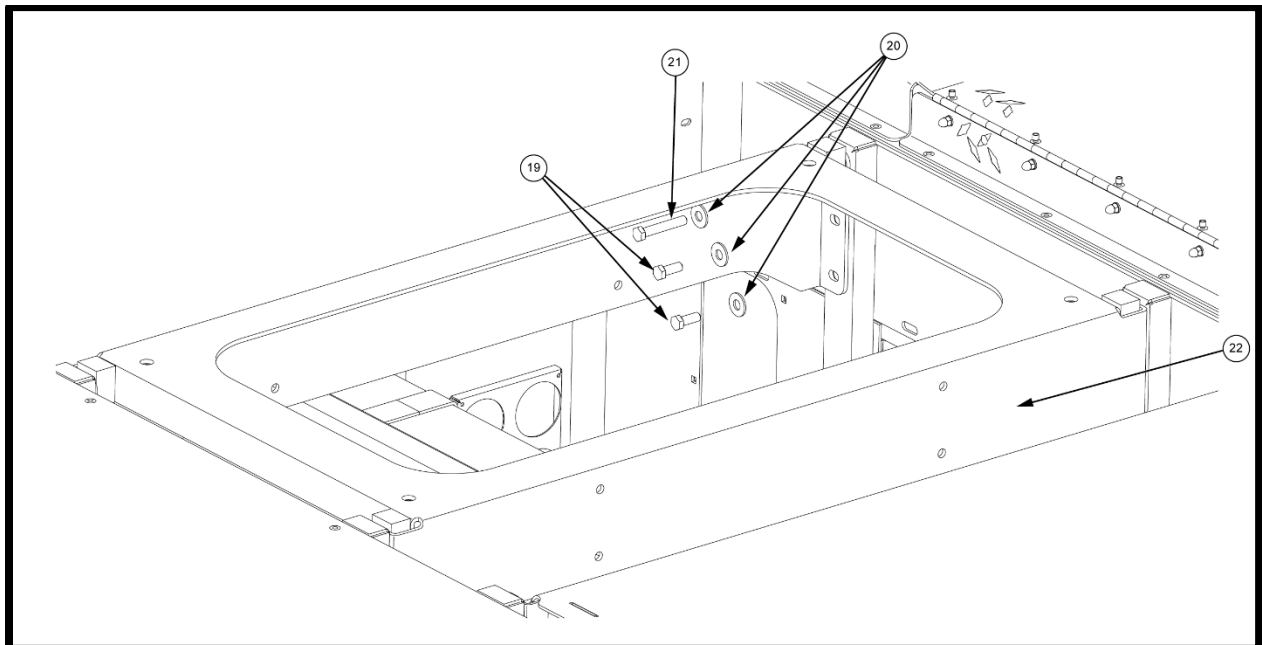

Callout	Part Name	Part Number
19	BOLT, .38-16NC, HX HD CS, YWZC, G8, 1.00" LG	82-0270-0100
20	WASHER, FLAT, STD, PLN	82-1033-004
21	BOLT, .38-16NC, HX HD CS, YWZC, G8	82-0270-0200
22	CROSSMEMBER, BODY, TOP RR, ASSY W-ACCESS	4511725

9. Install new top rear body crossmember (13) on vehicle with 2 screws (12), screw (14), and 3 washers (13). Repeat for each corner of top rear body crossmember.

10. Install new top rear body crossmember on vehicle with 2 screws, screw, and 3 washers. Torque to 10 lb-ft (13.56 Nm). Repeat for each corner of new top rear body crossmember.

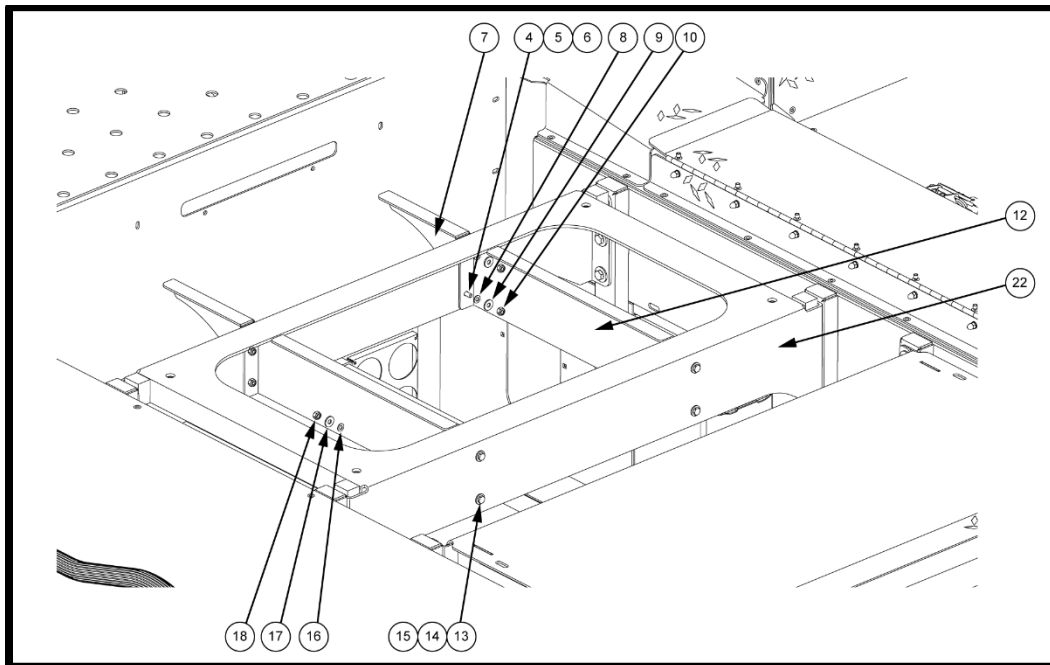

Callout	Part Name	Part Number
4	SCREW, .25-20,HX HD,SS 1.00LG	82-2072-0100
5	WASHER,FLAT,SS,STANDARD,18-8 .25 BOLT, .69" OD	82-1017-003
6	WASHER,FLAT,NYLON,.25" X .50" .25 X .50	82-3037-0025
8	WASHER,FLAT,NYLON,.25" X .50" .25 X .50	82-3037-0025
9	WASHER,FLAT,SS,STANDARD,18-8 .25 BOLT, .69" OD	82-1017-003
10	NUT,LOCK,NYLON INSERT,SS,NC .25-20NC	82-3037-0025
13	SCREW, .25-20,HX HD,SS 1.00LG	82-2072-0100
14	WASHER,FLAT,SS,STANDARD,18-8 .25 BOLT, .69" OD	82-1017-003
15	WASHER,FLAT,NYLON,.25" X .50" .25 X .50	82-3037-0025
16	WASHER,FLAT,NYLON,.25" X .50" .25 X .50	82-3037-0025
17	WASHER,FLAT,SS,STANDARD,18-8 .25 BOLT, .69" OD	82-1017-003
18	NUT,LOCK,NYLON INSERT,SS,NC .25-20NC	82-3037-0025

11. Install rear catwalk support bracket (7) on top rear crossmember (22) with screw (4), washer (5), nylon washer (6), top rear crossmember brace (12), nylon washer (8), washer (9), and locknut (10). Torque to 10 lb-ft (13.56 Nm). Repeat for opposite side.
12. Install top rear crossmember brace (12) on top rear crossmember (22) with screw (13), washer (14), nylon washer (15), nylon washer (16), washer (17), and locknut (18). Torque to 10 lb-ft (13.56 Nm). Repeat for opposite side.

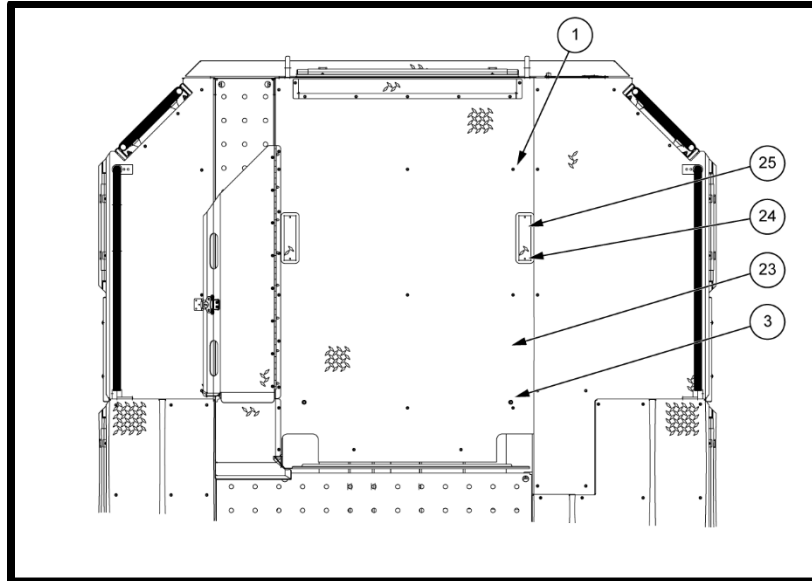

Callout	Part Name	Part Number
23	CATWALK,4-WAY,RR CTR AAT,PS CHUTE,W-ACCESS	4512464
	CATWALK,4-WAY,RR CTR AAT,NO CHUTES,W-ACCESS	4512467
	CATWALK,4-WAY,RR CTR AAT,DS CHUTE,W-ACCESS	4512470
24	DOOR,CATWALK,4-WAY,RR CTR AAT,TRQ BOLT ACCESS	82-1017-003

NOTE: Individual apparatus may be different than shown. Typical configuration shown.

- 13. Install catwalk (23) from apparatus with 23 screws (1) and 2 screws (3).
- 14. Install access door (25) with 2 screws (24).

This is non-warrantable. If any additional support is needed, please open a technical support incident on Pierceparts.com.