

## Field campaign

<b>Topic</b>	Software update to 0042 / 07D2 (Driver door control module) and 0052 / 07D3 (Passenger door control module) - SC24/16
<b>Market area</b>	Australia E04 Bentley rest Asia and Australia (6E04),China 796 VW Import Comp. Ltd (Vico), Beijing (6796),Germany E02 Bentley rest Europe (6E02),Japan E03 Bentley Japan (6E03),United Arab Emirates E06 Bentley Middle East and Africa (6E06),United Kingdom E01 Bentley UK (6E01),United States E05 Bentley USA and rest America (6E05)
<b>Brand</b>	Bentley
<b>Transaction No.</b>	2074063/2
<b>Campaign number</b>	ED09
<b>Note</b>	
<b>Type</b>	
<b>US code</b>	

## Vehicle data

### Bentayga Extended Wheel Base

#### Sales types

Type	MY	Brand	Designation	Engine code	Gearbox code	Final drive code
ZV1*	2024	E		*	*	*

#### Chassis numbers

Manufacturer	Filler	Type	Filler	MY	Factory	From	To	Prod from	Prod to
SJA	*	*	*	R	C	012458	026465		

## Documents

Document name
<a href="#">master.xml</a>
<a href="#">sc2416vinlist.pdf</a>

---

## Notes



### Technical background

The rear door strikers require checking for correct alignment and adjustment (if required)

Software updates must also be applied to following control modules on vehicles which are specified with the power door function:

- Driver door control module (Diagnostic address 0042 / 07D2)

And

- Passenger door control module (Diagnostic address 0052 / 07D3)



**Note:** 07D2 / 07D3 are subsystems of 0042 and 0052

**Hint:** Updates cannot be conducted to the door control modules alone therefore the following control modules will also be updated sequentially once the applicable SVM code has been applied:

**0019** - Gateway control module

**0046** - Convenience system control module

**0075** - Emergency call module and communication control module

**07D2** - Power close door module (subsystem of 0042)

**07D3** - Power close door module (subsystem of 0052)

### CAUTION

In the event the Software version is 0430 or 0440 please raise a technical DISS query ensuring a current ODIS log is attached / saved online, the operative **MUST** await feedback before conducting any further work

**NOTE TO PRODUCT SUPPORT:** On receipt of a qualifying DISS query please second level the query to Diagnostics and await feedback before responding to the retailer

**DO NOT CONDUCT THE SOFTWARE UPDATE UNTIL APPROVAL HAS BEEN GIVEN VIA THE OPEN DISS QUERY**

Or

Should the Software version already be 0450, the software is at the latest level, in this scenario the operative should confirm the rear strikers are aligned as detailed within the Work section and then conduct all remaining instruction from Step 8

### Remedy

The instructions within the Work section must be conducted to completion

### Customer notification

Please ensure all applicable instructions are conducted at the nearest opportunity, make a note of the required action on the workshop order before it is signed by the customer

If it is omitted to perform the work required during a workshop visit, the customer should be notified immediately

You should also pass on this information to your new and used car sales departments so that affected vehicles are checked and repaired immediately

### Warranty accounting instructions

Warranty type 710 or 790

Damage service number ED09

Damage code 00 66

Criterion ID 01

### NOTICE

Please ensure the correct Labour Operation Time is claimed depending on the original Software version (0430,0440 or 0450) as detailed below

**Time to conduct the Software Version Management (SVM) updates (Software Version at 0430 or 0440 - All Steps 1 - 9 )**

Labour operation code 01 51 00 00

Time As per ODIS log Must not exceed 170 Time units

**Time to only conduct Steps 1,2,7,8 and 9 (Software version already at 0450 )**

Labour operation code 64 38 50 05

Time 20 Time units

**Time to adjust (x1) striker (see note below)**

Labour Operation Code 58 25 15 00

Time 10 TU

**Time to adjust (x2) strikers (see note below)**

Labour Operation Code 58 25 16 00

Time 20 TU



Photographs must be attached to a non technical DISS query titled - SC24/16 Striker alignment. In the event a non technical DISS query is not raised (with photographs attached) the warranty claim for striker alignment will be cancelled

**Genuine parts**

Not applicable

**Parts supply**

Not applicable

**Parts despatch control**

Not applicable

---

## Repair instructions

**Notes**

### Technical background

The rear door strikers require checking for correct alignment and adjustment (if required)

Software updates must also be applied to following control modules on vehicles which are specified with the power door function:

- Driver door control module (Diagnostic address 0042 / 07D2)

And

- Passenger door control module (Diagnostic address 0052 / 07D3)



**Note:** 07D2 / 07D3 are subsystems of 0042 and 0052

**Hint:** Updates cannot be conducted to the door control modules alone therefore the following control modules will also be updated sequentially once the applicable SVM code has been applied:

**0019** - Gateway control module

**0046** - Convenience system control module

**0075** - Emergency call module and communication control module

**07D2** - Power close door module (subsystem of 0042)

**07D3** - Power close door module (subsystem of 0052)

### CAUTION

In the event the Software version is 0430 or 0440 please raise a technical DISS query ensuring a current ODIS log is attached / saved online, the operative **MUST** await feedback before conducting any further work

**NOTE TO PRODUCT SUPPORT:** On receipt of a qualifying DISS query please second level the query to Diagnostics and await feedback before responding to the retailer

**DO NOT CONDUCT THE SOFTWARE UPDATE UNTIL APPROVAL HAS BEEN GIVEN VIA THE OPEN DISS QUERY**

Or

Should the Software version already be 0450, the software is at the latest level, in this scenario the operative should confirm the rear strikers are aligned as detailed within the Work section and then conduct all remaining instruction from Step 8

## Check

If the vehicle is not already listed as repaired in "Repair history" (in Elsa pro), check for the presence of the yellow paint completion mark as shown within the Identification section

If neither are evident please conduct the instructions within the Work section to completion

## Genuine parts

Not applicable

## Work

### NOTICE

Before proceeding with the instructions the operative must first ensure the left and right hand rear door strikers are centrally aligned to the latch as shown in Figure 1

### CAUTION

In the event that one or both rear door strikers are not centrally aligned the operative must take a photograph confirming that one or both of the strikers are not aligned, the operative must then proceed to align the strikers as detailed below before proceeding

Or

Should the strikers be centrally aligned, the operative should conduct all onward instructions from step 1

### Rear door striker alignment check / adjustment instructions (if required)



Figure 1

- Loosen but do not remove the fixings (Figure 2)

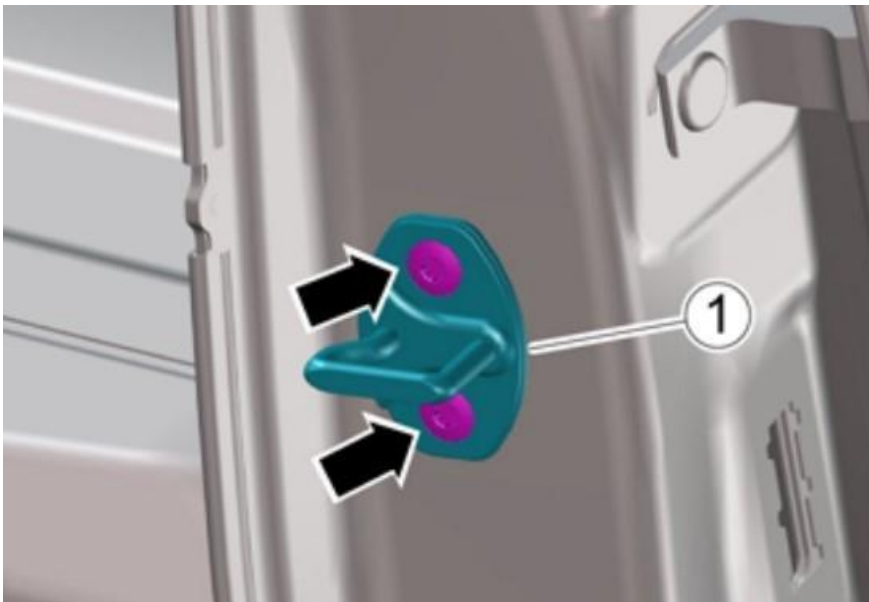

Figure 2

- Referring to Figures 3 and 4 - Adjust the position of the striker (1) so it is located centrally in the door latch (2)

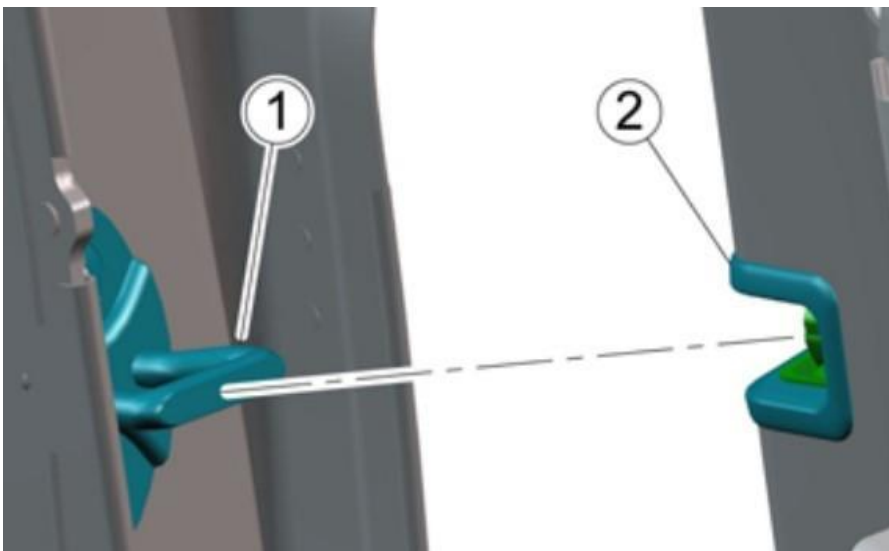

Figure 3

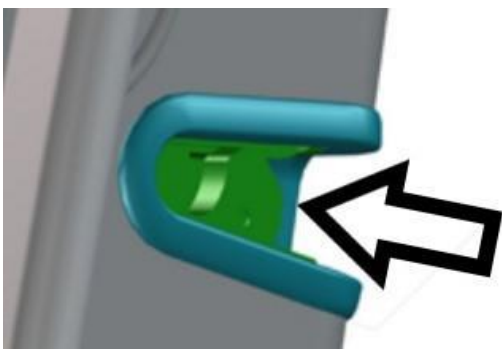

Figure 4

- Once the strikers are aligned, the operative must take a photograph which clearly shows correct alignment



Hint: The photographs must be attached to a non technical DISS query titled - SC24/16 Striker alignment

**CAUTION**

The Bentley ODIS-S Brand version must be 2.32.3 (Or later)

ODIS will automatically default to DoIP when the Bentley ODIS-S Brand version is 2.32.3 (Or later)

**WARNING**

**WARNING: DO NOT UNDER ANY CIRCUMSTANCES ATTEMPT TO CONDUCT THE SOFTWARE UPDATE VIA THE CAN NETWORK, ONLY DoIP SHOULD BE USED WHEN PERFORMING THIS UPDATE**

**CAUTION**

**VERY IMPORTANT: Before conducting the onward instructions / entering the SVM code, the operative MUST recheck the DoIP set up in ODIS and ensure that DoIP is selected (Figure 5) before proceeding**

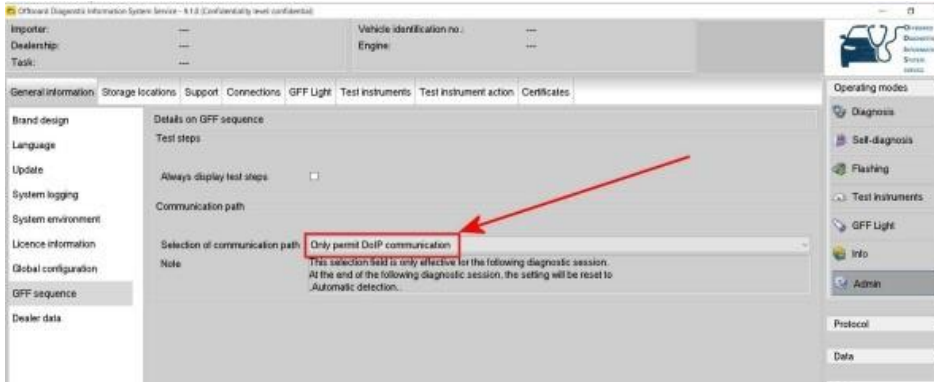

Figure 5

### Software identification procedure

- 1) Select and run Guided Fault Finding
- 2) Referring to the example shown in Figure 6 - Navigate to the front driver door module (0042 / J386) > Guided Functions > Read identification data
  - Repeat for the front passenger door module (0052 / J387)



Figure 6

**CAUTION**

**In the event the Software version is 0430 or 0440 please raise a technical DISS query ensuring a current ODIS log is attached / saved online, the operative MUST await feedback before conducting any further work**

**NOTE TO PRODUCT SUPPORT: On receipt of a qualifying DISS query please second level the query to Diagnostics and await feedback before responding to the retailer**

**DO NOT CONDUCT THE SOFTWARE UPDATE UNTIL APPROVAL HAS BEEN GIVEN VIA THE OPEN DISS QUERY**

Or

**Should the Software version already be 0450, the software is at the latest level, in this scenario the operative should conduct the instructions within the Work section from Step 8 to completion**

### Software Version Management - Software level at 0430 or 0440

- The closed-circuit voltage of the vehicle must be at least 12.5 V during the update. Connect a suitable battery charger to the vehicle. For further information refer to the Repair manual
- During the update switch off all unnecessary consumers (ventilation, seat heater, interior illumination etc) ensure the main light switch is set to 'off'

- Because of the highest transmission stability you MUST use the diagnosis interface VAS 6154 (WiFi diagnostic tool) ONLY in USB operation or the cable-connected VAS 5055 for the reprogramming (updating) of control units. If these units are not available, the diagnosis interface VAS 5054 (A) can also be used in USB mode
- Do Not under any circumstances use a Bluetooth connection to conduct the reprogramming (updating) of any control units

**CAUTION**  
The software version must be at 0430 or 0440 before proceeding with the onward update

- The operative MUST have previously raised a DISS query and been given permission to conduct the update
- Or
- Should the Software version already be 0450 the operative must go to Step 8

3) Referring to Figure 7 - Within the Special functions tab select SVM - Code Input (A) then select Perform test (B)

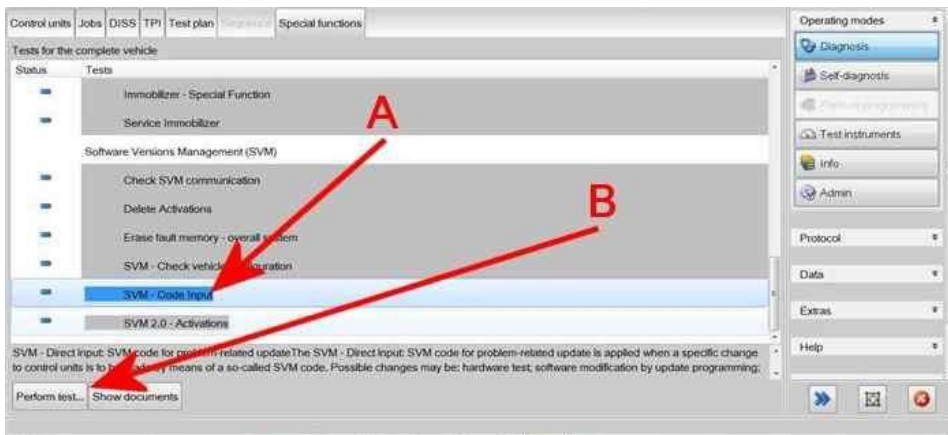

Figure 7

4) On the next screen enter SVM code 4V1BIL53 and select Adopt (Figure 8)

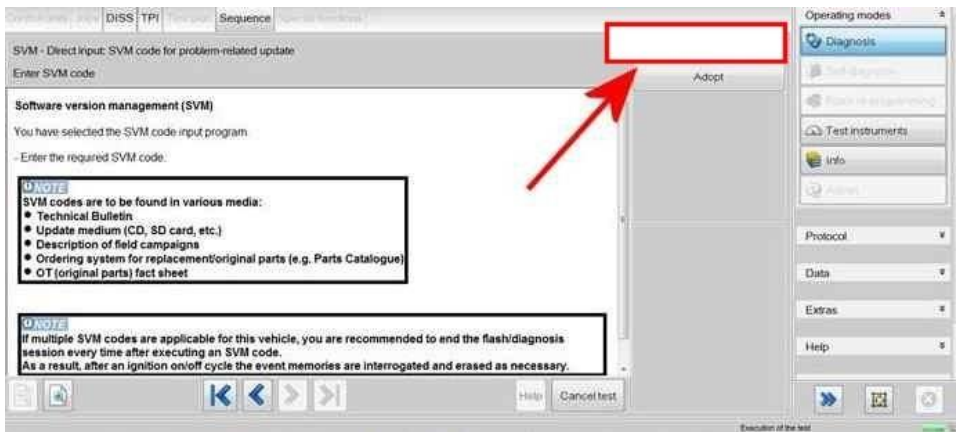

Figure 8

5) On the following screen, confirm the code is correct and select Yes

- All control modules will be interrogated



**IMPORTANT: The control modules will automatically be updated sequentially in the order shown below**

- 0019 - Gateway control module
- 0046 - Convenience system control module
- 0075 - Emergency call module and communication control module
- 07D2 - Power close door module (subsystem of 0042)
- 07D3 - Power close door module (subsystem of 0052)

- The SVM action will then take place

6) Follow all on screen prompts until program end

7) On completion - Switch off the ignition

- Remove the diagnostic interface from the OBD port
- Switch off and remove the battery charger from the vehicle
- Close the bonnet, boot and all doors
- Lock the vehicle
- Wait 5 minutes to allow the vehicle to go into bus silence
- When 5 minutes has elapsed, unlock the vehicle and open the driver's door
- Switch on the ignition

8) Left hand rear door (LHR)

- Open the LHR door
- Sit on the LHR seat *HINT: Ensure a suitable cover is used to protect the seat*

**⚠ CAUTION**

The operative must ensure the following before conducting the onward instructions

- The RHF - LHF and RHR doors must all be closed
- The tailgate must be closed
- All windows must be closed
- Referring to Figure 9 - Press and hold the left DOOR CLOSE button

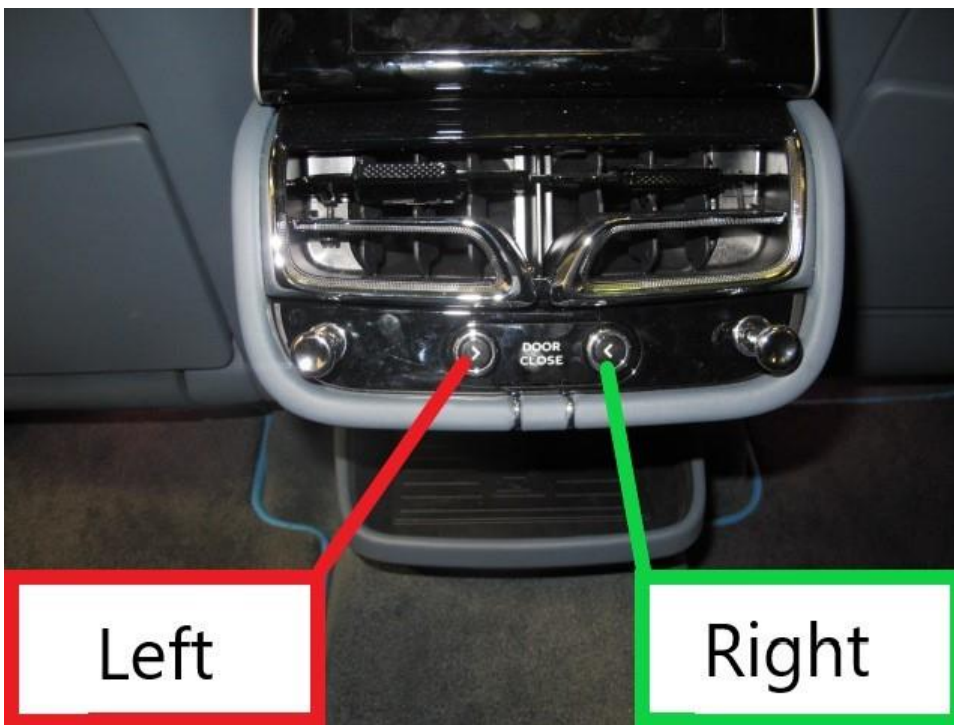

Figure 9

- Check the LHR door fully closes and latches (including soft close operation) without the requirement to press the button a second time
- Once fully closed/latched - Fully reopen the LHR door
- Repeat the power close operation (x2) times (x3 in total)

**ⓘ NOTICE**

In the event the door close / latch operation fails at any point the operative must raise a DISS query and await feedback before conducting any further work

However

In the event there are no power door close/latch operational issues and the power door could be power closed x3 times without any issues the operative must conduct the remaining instructions to completion

[Right hand rear door \(RHR\)](#)

- Open the RHR door
- Sit on the RHR seat *HINT: Ensure a suitable cover is used to protect the seat*

### **CAUTION**

The operative must ensure the following before conducting

- The RHF - LHF and LHR doors must be closed
- The tailgate must be closed
- All windows must be closed
- Referring to Figure 9 - Press and hold the right DOOR CLOSE button Check the RHR door fully closes and latches (including soft close operation) without the requirement to press the button a second time
- Once closed/latched - Fully reopen the RHR door
- Repeat the power close operation (x2) times (x3 in total)

### **NOTICE**

In the event the door close/latch operation fails at any point the operative must raise a DISS query and await feedback before conducting any further work

However

In the event there are no power door close/latch operational issues and the power door could be power closed x3 times without any issues the operative must conduct Step 9

9) Apply a yellow paint completion mark on the underside of the left hand rear door harness grommet (Figure 10)

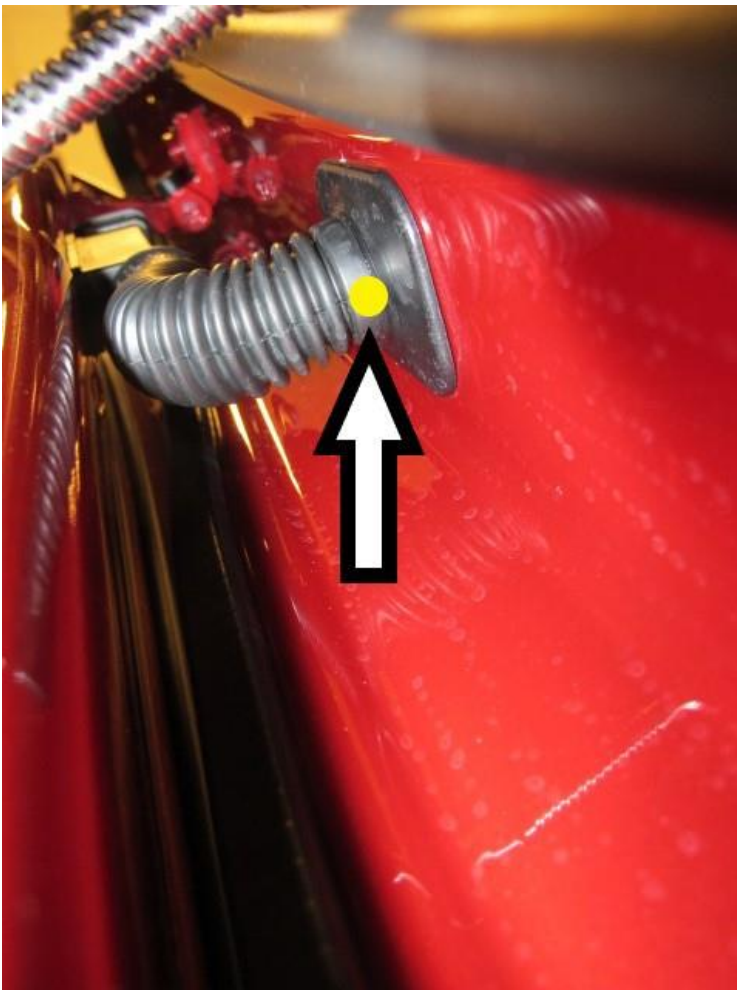

Figure 10

### **Identification**

Yellow paint completion mark at the location shown in Figure 10

SJAH614V3RC012458	SJAHT2ZV6RC025079	SJAHB14V9RC025307	SJAHP14V7RC025470	SJAHP14V2RC025652
SJAH614V4RC012534	SJAHT2ZV8RC025083	SJAHB14V9RC025310	SJAHT2ZV6RC025471	SJAHB14V8RC025654
SJAHT2ZV5RC012730	SJAHB14V8RC025086	SJAHB14V6RC025314	SJAHB14V4RC025473	SJAHU1ZV8RC025656
SJAH614V8RC012732	SJAHT2ZV7RC025088	SJAHB14V5RC025319	SJAHT2ZV5RC025476	SJAHP14V3RC025658
SJAH614VXRC012733	SJAHT2ZV5RC025090	SJAHT2ZV0RC025322	SJAHP14VXRC025477	SJAHP14V1RC025660
SJAHV14V7RC015723	SJAHB14V0RC025096	SJAHT2ZV2RC025323	SJAHP14V3RC025479	SJAHT2ZV8RC025665
SJAHT14V3RC015739	SJAHT2ZV9RC025125	SJAHT2ZV6RC025325	SJAHU1ZV5RC025503	SJAHP14V4RC025667
SJAHV14V2RC015774	SJAHP14V7RC025128	SJAHT2ZV1RC025328	SJAHP14V8RC025509	SJAHB14V8RC025668
SJAHV14V6RC015776	SJAHT2ZV2RC025130	SJAHT2ZV3RC025329	SJAHB14V6RC025510	SJAHP14V4RC025670
SJAHV14V1RC015782	SJAHP14V2RC025134	SJAHB14V6RC025331	SJAHB14VXRC025512	SJAHB14V8RC025671
SJAHT2ZV8RC015783	SJAHT2ZV3RC025136	SJAHP14V8RC025333	SJAHB14V5RC025515	SJAHP14VXRC025673
SJAHV14V9RC015786	SJAHT2ZV5RC025137	SJAHB14V5RC025336	SJAHP14V9RC025518	SJAHB14V7RC025676
SJAHV14V0RC015787	SJAHT2ZV9RC025139	SJAHT2ZV6RC025339	SJAHU1ZV7RC025521	SJAHT2ZV4RC025677
SJAHT2ZV9RC015792	SJAHT2ZV9RC025142	SJAHP14V5RC025340	SJAHP14V4RC025524	SJAHP14V0RC025679
SJAHV14V7RC019139	SJAHB14V7RC025144	SJAHP14V0RC025343	SJAHT2ZV7RC025527	SJAHP14V0RC025682
SJAHT2ZV8RC019140	SJAHP14V9RC025146	SJAHB14V8RC025346	SJAHT2ZV7RC025530	SJAHB14V4RC025683
SJAHB14V9RC020401	SJAHT2ZVXRC025151	SJAHP14V8RC025347	SJAHP14V3RC025532	SJAHP14V6RC025685
SJAHB14V0RC020402	SJAHT2ZV1RC025152	SJAHB14V1RC025351	SJAHP14V5RC025533	SJAHB14V5RC025689
SJAHT14VXRC020405	SJAHP14V8RC025154	SJAHT2ZV9RC025352	SJAHP14V2RC025540	SJAHP14V1RC025691
SJAHB14V1RC020411	SJAHT2ZV9RC025156	SJAHP14V7RC025355	SJAHT2ZV5RC025543	SJAHP14V7RC025694
SJAHT2ZV9RC020412	SJAHB14V9RC025159	SJAHB14V0RC025356	SJAHB14V5RC025546	SJAHT2ZVXRC025697
SJAHB14V2RC022040	SJAHB14V6RC025166	SJAHT2ZV8RC025360	SJAHP14V9RC025549	SJAHT2ZV3RC025699
SJAHT2ZVXRC022041	SJAHT2ZV5RC025168	SJAHU14V3RC025362	SJAHP14V7RC025551	SJAHP14V9RC025700
SJAHT2ZV1RC022042	SJAHT2ZV3RC025170	SJAHB14V8RC025363	SJAHB14V0RC025552	SJAHB14V4RC025702
SJAHP14V6RC022043	SJAHB14V5RC025174	SJAHP14VXRC025365	SJAHT2ZV1RC025555	SJAHT2ZVXRC025716
SJAHP14V8RC022044	SJAHP14V9RC025177	SJAHP14V1RC025366	SJAHB14VXRC025557	SJAHB14V6RC025720
SJAHB14V1RC022045	SJAHP14V2RC025179	SJAHU1ZV5RC025369	SJAHU1ZV6RC025560	SJAHB14V1RC025723
SJAHB14V3RC022046	SJAHP14V3RC025191	SJAHB14V4RC025375	SJAHB14V3RC025562	SJAHB14V3RC025724
SJAHB14V5RC022047	SJAHP14V9RC025194	SJAHB14V8RC025377	SJAHP14V4RC025572	SJAHP14V9RC025728
SJAHB14V7RC022048	SJAHB14V8RC025198	SJAHP14V8RC025381	SJAHP14V8RC025574	SJAHP14V7RC025730
SJAHP14V0RC024838	SJAHP14V0RC025200	SJAHT2ZV9RC025383	SJAHT2ZV9RC025576	SJAHP14V0RC025732
SJAHT2ZV8RC024841	SJAHB14V8RC025203	SJAHP14V5RC025385	SJAHP14V3RC025580	SJAHT2ZV1RC025734
SJAHB14V8RC024990	SJAHB14V3RC025206	SJAHU1ZV9RC025388	SJAHP14V7RC025582	SJAHP14V3RC025739
SJAHT2ZV7RC024992	SJAHT2ZV4RC025209	SJAHP14V9RC025390	SJAHB14V2RC025584	SJAHP14V1RC025741
SJAHT2ZV0RC024994	SJAHT2ZV0RC025210	SJAHP14V8RC025395	SJAHP14V6RC025587	SJAHT2ZV2RC025743
SJAHT2ZV4RC025002	SJAHT2ZV6RC025213	SJAHP14V8RC025400	SJAHP14V6RC025590	SJAHP14V2RC025747
SJAHP14V2RC025005	SJAHT2ZV3RC025217	SJAHP14V9RC025406	SJAHB14V3RC025593	SJAHP14V6RC025749
SJAHT2ZV1RC025006	SJAHB14V8RC025220	SJAHT2ZV1RC025412	SJAHB14V7RC025595	SJAHB14V6RC025751
SJAHT2ZV5RC025008	SJAHB14V3RC025223	SJAHP14VXRC025415	SJAHP14V9RC025597	SJAHP14V8RC025753
SJAHT2ZV3RC025010	SJAHP14V9RC025227	SJAHB14V3RC025416	SJAHP14V2RC025599	SJAHP14V3RC025756
SJAHT2ZV0RC025014	SJAHT2ZV8RC025231	SJAHB14V9RC025419	SJAHB14V9RC025601	SJAHT2ZV6RC025759
SJAHB14V2RC025018	SJAHP14V6RC025234	SJAHB14V7RC025421	SJAHP14V0RC025603	SJAHB14V9RC025761
SJAHT2ZVXRC025019	SJAHP14V1RC025240	SJAHT2ZV4RC025422	SJAHB14V6RC025605	SJAHP14V0RC025763
SJAHT2ZV8RC025021	SJAHP14V9RC025244	SJAHP14V0RC025424	SJAHB14V1RC025608	SJAHP14V6RC025766
SJAHT2ZV0RC025028	SJAHB14V6RC025247	SJAHT2ZV3RC025427	SJAHP14VXRC025611	SJAHP14V1RC025769
SJAHT2ZV9RC025030	SJAHP14V8RC025249	SJAHB14V8RC025430	SJAHP14V1RC025612	SJAHT2ZV7RC025771
SJAHT2ZV6RC025034	SJAHT2ZV3RC025251	SJAHP14VXRC025432	SJAHT2ZV4RC025615	SJAHB14V5RC025773
SJAHP14V2RC025036	SJAHB14V5RC025255	SJAHB14V3RC025433	SJAHP14V0RC025617	SJAHP14V2RC025778
SJAHT2ZV5RC025039	SJAHT2ZV6RC025258	SJAHB14V9RC025436	SJAHB14V4RC025618	SJAHU1ZV6RC025784
SJAHT2ZV5RC025042	SJAHB14V4RC025263	SJAHP14V2RC025439	SJAHP14V0RC025620	SJAHP14V1RC025786
SJAHT2ZV7RC025043	SJAHT2ZV3RC025265	SJAHP14V2RC025442	SJAHP14V8RC025624	SJAHP14V5RC025788
SJAHT2ZV2RC025046	SJAHB14V1RC025267	SJAHB14V8RC025444	SJAHP14V3RC025627	SJAHP14V3RC025790
SJAHT2ZV6RC025048	SJAHT2ZV7RC025270	SJAHU1ZV8RC025446	SJAHB14V9RC025629	SJAHB14V9RC025792
SJAHT2ZV6RC025051	SJAHT2ZV0RC025272	SJAHT2ZV2RC025449	SJAHP14V3RC025630	SJAHT2ZV8RC025794
SJAHT2ZV1RC025054	SJAHB14V4RC025277	SJAHU1ZV3RC025452	SJAHP14V7RC025632	SJAHT2ZV5RC025798
SJAHT2ZV7RC025057	SJAHT2ZVXRC025280	SJAHB14V2RC025455	SJAHP14V0RC025634	SJAHB14V3RC025805
SJAHB14V3RC025058	SJAHB14VXRC025283	SJAHB14V8RC025458	SJAHU14V3RC025636	SJAHP14V7RC025808
SJAHB14V9RC025064	SJAHB14V7RC025290	SJAHP14V4RC025460	SJAHT2ZV5RC025638	SJAHT2ZV2RC025810
SJAHT2ZV8RC025066	SJAHB14V2RC025293	SJAHB14V8RC025461	SJAHT2ZV3RC025640	SJAHB14V0RC025812
SJAHB14V6RC025068	SJAHB14V8RC025296	SJAHT2ZV9RC025464	SJAHP14VXRC025642	SJAHU1ZV4RC025816
SJAHT2ZV3RC025069	SJAHB14V8RC025301	SJAHP14V7RC025467	SJAHP14V7RC025646	SJAHU1ZV6RC025820
SJAHT2ZV1RC025071	SJAHB14V3RC025304	SJAHB14V0RC025468	SJAHB14V4RC025649	SJAHP14V3RC025823

SJAHP14V0RC025827	SJAHP14V2RC025926	SJAHP14V6RC026044	SJAHP14V5RC026150	SJAHP14V9RC026281
SJAHP14V0RC025830	SJAHP14V8RC025931	SJAHT2ZV9RC026047	SJAHP14V0RC026153	SJAHU1ZV4RC026285
SJAHP14V6RC025833	SJAHP14V5RC025936	SJAHT2ZV2RC026049	SJAHP14V8RC026157	SJAHP14V3RC026289
SJAHP14V8RC025834	SJAHP14V9RC025938	SJAHP14V3RC026051	SJAHP14V1RC026159	SJAHU1ZV1RC026292
SJAHT2ZV0RC025837	SJAHP14V0RC025939	SJAHP14V9RC026054	SJAHT2ZV8RC026167	SJAHP14V7RC026294
SJAHT2ZV4RC025839	SJAHP14V6RC025945	SJAHT2ZVXRC026056	SJAHT2ZV8RC026170	SJAHS14V2RC026296
SJAHT2ZV4RC025842	SJAHP14VXRC025947	SJAHP14V6RC026058	SJAHP14V4RC026172	SJAHP14V5RC026309
SJAHP14V0RC025844	SJAHP14V5RC025949	SJAHP14V8RC026062	SJAHT2ZV5RC026174	SJAHT2ZV4RC026313
SJAHP14V6RC025850	SJAHP14V1RC025951	SJAHP14V5RC026066	SJAHP14V5RC026181	SJAHP14V3RC026325
SJAHU1ZV1RC025854	SJAHP14V5RC025953	SJAHP14V9RC026068	SJAHT2ZV3RC026187	SJAHP14V7RC026330
SJAHP14V0RC025857	SJAHU1ZV7RC025955	SJAHP14V7RC026070	SJAHU1ZV6RC026188	SJAHP14V6RC026335
SJAHU1ZV7RC025860	SJAHP14V4RC025958	SJAHP14V4RC026074	SJAHP14V6RC026190	SJAHU14V0RC026338
SJAHP14V6RC025863	SJAHT2ZV1RC025961	SJAHU1ZV4RC026075	SJAHT2ZV4RC026196	SJAHT2ZV2RC026343
SJAHU1ZV6RC025865	SJAHP14VXRC025964	SJAHP14VXRC026077	SJAHT2ZV6RC026202	SJAHT2ZV1RC026348
SJAHP14VXRC025866	SJAHP14V1RC025965	SJAHP14V3RC026082	SJAHT2ZV3RC026206	SJAHU14V7RC026353
SJAHU1ZV3RC025869	SJAHP14V7RC025967	SJAHT2ZV2RC026083	SJAHU1ZV8RC026208	SJAHP14V1RC026355
SJAHP14V5RC025872	SJAHP14V7RC025971	SJAHU1ZV7RC026085	SJAHP14V8RC026210	SJAHT2ZV2RC026357
SJAHP14V9RC025874	SJAHP14V0RC025973	SJAHU1ZV2RC026091	SJAHP14V1RC026212	SJAHU1ZV9RC026363
SJAHU1ZV0RC025876	SJAHP14V4RC025975	SJAHP14VXRC026094	SJAHP14V7RC026215	SJAHP14V1RC026369
SJAHT2ZV5RC025879	SJAHP14VXRC025978	SJAHP14V3RC026096	SJAHP14V0RC026217	SJAHP14VXRC026371
SJAHP14V6RC025881	SJAHP14VXRC025981	SJAHT2ZV6RC026099	SJAHT2ZVXRC026221	SJAHP14V4RC026379
SJAHP14V1RC025884	SJAHT2ZV0RC025983	SJAHT2ZV8RC026105	SJAHP14V6RC026223	SJAHP14VXRC026385
SJAHP14V9RC025888	SJAHP14V4RC025989	SJAHP14V4RC026107	SJAHP14VXRC026225	SJAHP14V7RC026389
SJAHP14V7RC025890	SJAHP14V8RC025994	SJAHT2ZV5RC026109	SJAHP14V3RC026227	SJAHP14VXRC026399
SJAHP14V0RC025892	SJAHT2ZV0RC025997	SJAHU1ZV4RC026111	SJAHU1ZV5RC026229	SJAHP14V4RC026415
SJAHP14V6RC025895	SJAHT2ZV4RC026005	SJAHP14V3RC026115	SJAHU1ZV3RC026231	SJAHU1ZVXRC026419
SJAHP14V1RC025897	SJAHP14V9RC026006	SJAHT2ZV6RC026118	SJAHP14V4RC026236	SJAHU14V0RC026422
SJAHP14V3RC025899	SJAHP14V0RC026010	SJAHP14V7RC026120	SJAHP14V8RC026238	SJAHU1ZV4RC026433
SJAHT2ZV7RC025902	SJAHP14V4RC026012	SJAHT2ZVXRC026123	SJAHP14V8RC026241	SJAHU1ZV6RC026434
SJAHT2ZV0RC025904	SJAHP14VXRC026015	SJAHP14V6RC026125	SJAHP14V5RC026245	SJAHU1ZVXRC026436
SJAHP14V5RC025905	SJAHP14V5RC026018	SJAHP14V8RC026126	SJAHP14V4RC026253	SJAHP14V3RC026440
SJAHP14V2RC025908	SJAHP14V3RC026020	SJAHT2ZV9RC026128	SJAHT2ZV0RC026258	SJAHT2ZV4RC026442
SJAHP14V0RC025911	SJAHT2ZV4RC026022	SJAHP14V3RC026132	SJAHS14V5RC026261	SJAHT2ZV7RC026449
SJAHP14V6RC025913	SJAHP14V4RC026026	SJAHP14V5RC026133	SJAHU1ZV7RC026264	SJAHP14V6RC026450
SJAHT2ZV3RC025914	SJAHP14V8RC026028	SJAHU1ZV7RC026135	SJAHU1ZV2RC026267	SJAHU1ZV8RC026452
SJAHP14VXRC025916	SJAHP14V1RC026033	SJAHP14V4RC026138	SJAHT2ZV3RC026268	SJAHT2ZV8RC026458
SJAHP14V5RC025919	SJAHP14V5RC026035	SJAHP14V2RC026140	SJAHP14V4RC026270	SJAHP14V9RC026460
SJAHT2ZV2RC025922	SJAHP14V2RC026038	SJAHP14V6RC026142	SJAHT2ZV5RC026272	SJAHP14V4RC026463
SJAHP14V0RC025924	SJAHP14V2RC026039	SJAHT2ZV7RC026144	SJAHT2ZV7RC026273	SJAHP14V8RC026465