



# Technical Service Bulletin

SUBJECT:			No: <b>TSB-24-34-003</b>
<b>REAR SHOCK ABSORBER DESCRIPTION CORRECTION - SERVICE MANUAL REVISION</b>			DATE: <b>August 2024</b>
			MODEL: <b>See below</b>
<b>CIRCULATE TO:</b>	<input type="checkbox"/> GENERAL MANAGER	<input checked="" type="checkbox"/> PARTS MANAGER	<input checked="" type="checkbox"/> TECHNICIAN
<input checked="" type="checkbox"/> SERVICE ADVISOR	<input checked="" type="checkbox"/> SERVICE MANAGER	<input checked="" type="checkbox"/> WARRANTY PROCESSOR	<input type="checkbox"/> SALES MANAGER

## PURPOSE

This TSB provides corrections to the description of the Rear Shock Absorber within the Suspension section of the applicable Service Manuals.

## AFFECTED VEHICLES

2022-2024 Outlander  
2023-2024 Outlander Plug-in Hybrid

## AFFECTED SERVICE MANUAL

2022-2024 Outlander Service Manual  
2022-2024 Outlander Plug-in Hybrid Service Manual

## PROCEDURE

Please use the chart below to replace the pages in the affected Service Manuals: Suspension, Rear Suspension and General Information sections.

Applicable Manual	Pub. No.	Applicable Title	Content
2022 OUTLANDER Service Manual	MSCD-030B-2022	SUSPENSION ↳ REAR SUSPENSION ↳ PRECAUTION ↳ PRECAUTIONS	Attached sheet 5
2023 OUTLANDER Service Manual	MSCD-030B-2023	↳ PRECAUTIONS ↳ Added below "Precautions for Suspension"	
2024 OUTLANDER Service Manual	MSCD-030B-2024	SUSPENSION ↳ REAR SUSPENSION ↳ REMOVAL AND INSTALLATION ↳ REAR SHOCK ABSORBER ↳ Disassembly and Assembly	Attached sheet 4

Applicable manual	Pub. No.	Applicable title	Content
2023 OUTLANDER PLUG-IN HYBRID Service Manual	MSCD-027B-2023	GENERAL INFORMATION ↳ GENERAL INFORMATION ↳ PREPARATION ↳ PREPARATION ↳ Special Service Tool Number Substitution List	Attached sheet 6
2024 OUTLANDER PLUG-IN HYBRID Service Manual	MSCD-027B-2024	SUSPENSION ↳ REAR SUSPENSION ↳ PRECAUTION ↳ PRECAUTIONS ↳ Added below "Precautions for Suspension"	Attached sheet 3
		SUSPENSION ↳ REAR SUSPENSION ↳ REMOVAL AND INSTALLATION ↳ REAR SHOCK ABSORBER ↳ Disassembly and Assembly	Attached sheet 4



Copyright 2024, Mitsubishi Motors North America, Inc.

The information contained in this bulletin is subject to change. For the latest version of this document, go to the Mitsubishi Dealer Link, MEDIC, or the Mitsubishi Service Information website([www.mitsubishitechinfo.com](http://www.mitsubishitechinfo.com)).

## REAR SUSPENSION

## PREPARATION

## PREPARATION

## Special Service Tools

When you order special service tool, use part number on "tool order number" of special service tool number substitution list. Refer to Special Service Tool Number Substitution List.

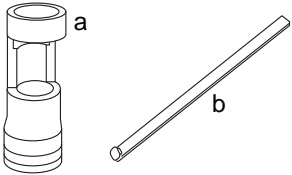
Tool number Tool name		Description
Rear shock absorber service kit KV401110S0 a. Socket 18 KV40111000 b. Rod lock handle KV40111100	 <p style="text-align: center;">DF1004QHAB00ENG</p>	Disassembling and assembling rear shock absorber

<Added>

## REAR SUSPENSION

## Disassembly and Assembly

## DISASSEMBLY

## CAUTION:

- Never damage shock absorber piston rod when removing components from shock absorber.
- When fixing shock absorber with a vise, wrap a shop cloth around lower side of shock absorber to protect from damage. Never set the cylindrical part of shock absorber with a vise.
- When removing piston rod lock nut, use special tool rear shock absorber service kit (KV401110S0).
  - Fix the tip of the piston rod using special tool rod lock handle (KV40111100) (a) so that the piston rod does not rotate, and remove the piston rod lock nut using special tool socket 18 (KV40111000) (b).

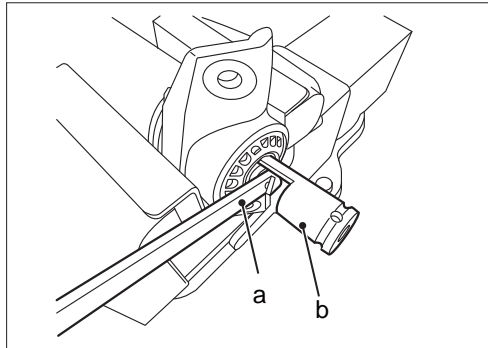

DF1004RQAA00JPN

- Perform inspection after removal. Refer to [Inspection](#).

## ASSEMBLY

Note the following, and assembly in the reverse order of disassembly.

- Never damage shock absorber piston rod when removing components from shock absorber.
- When fixing shock absorber with a vise, wrap a shop cloth around lower side of shock absorber to protect from damage. Never set the cylindrical part of shock absorber with a vise.
- When installing piston rod lock nut, use special tool rear shock absorber service kit (KV401110S0).
  - Fix the tip of the piston rod using special tool rod lock handle (KV40111100) (a) so that the piston rod does not rotate, and install the piston rod lock nut using special tool socket 18 (KV40111000) (b).

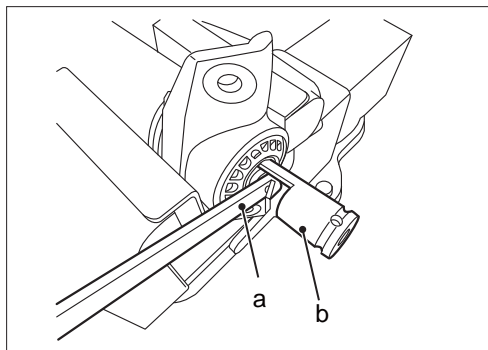

DF1004RQAA00JPN

## CAUTION:

Never reuse piston rod lock nut.

- Perform inspection after installation. Refer to [Inspection](#).

<Corrected>

## REAR SUSPENSION

## PREPARATION

## PREPARATION

## Special Service Tools

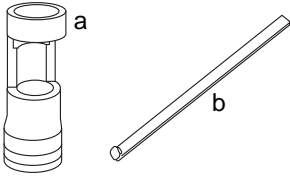
Tool number Tool name		Description
Rear shock absorber service kit KV401110S0 a. Socket 18 KV40111000 b. Rod lock handle KV40111100	 <p style="text-align: center;">DF1004QHAB00ENG</p>	Disassembling and assembling rear shock absorber

&lt;Added&gt;

## GENERAL INFORMATION

## Special Service Tool Number Substitution List

When you order special service tool, use part number on "tool order number" instead of part number on "tool number for service manual."

Tool name	Tool number for service manual	Tool order number
Hub lock nut wrench	KV40104000	MQ713879
Protector	KV38107900	MQ703696
Lock nut crimp punch	KV40108700	MQ600120
Lock nut chisel	KV40108800	MQ600063
Strut attachment	ST35652000	MQ703718
Boot band crimping tool	KV40107300	MB991561V
Laser marker	KV99120000	MQ600065
ICC target board (Type1)	KV99112700	MQ600096
Driver Assistance Targets	KV99117200	MQ600100
Rear shock absorber service kit	KV401110S0	MQ600301
Socket 18	KV40111000	MQ600302
Rod lock handle	KV40111100	MQ600303

<Added>