



# Technical Service Bulletin

## 48 Yellow steering warning lamp lights up when engine is started; B200000, B200FF4

48 24 69 2074847/1 August 9, 2024.

Model(s)	Year	VIN Range	Vehicle-Specific Equipment
A4, A4 allroad, S4, A5, A5 Cabriolet, A5 Sportback, S5, S5 Cabriolet, S5 Sportback, RS 5, and RS 5 Sportback	2024 - 2025	All	Not Applicable

### Condition

#### Customer states:

Upon starting the engine, the yellow steering warning lamp lights up and the power steering assistance is reduced.

#### Workshop findings:

The following DTCs may be stored in the steering (diagnostic address 0044) with **SW 0172** and VW-Audi part number 8W0909144N.

- **B200000** symptom 4176 and/or **B200FF4** symptom 16712020.

Or

- **B200000** symptom 4432.

### Technical Background 1

Software issue.

### Production Solution

Optimized software in after-sales service.



# Technical Service Bulletin

---

## Service

This TSB replaces Pending Service Solution (PSS) TSB 2073087: *48 PSS: Yellow steering warning lamp on - DTCs B20000 and B200FF4 stored in the J500.*

*Please ensure that you do not confuse the SVM code with the login code when entering the code!*

*Use the PR number to check whether the vehicle has a start/stop system.*

Proceed as follows:

### For vehicles **without** start/stop system:

Perform a software update of the steering system with the following SVM code:

- First code: **44A041**, then second code: **44B041**
- The red steering warning lamp may light up after the update. Switch the ignition off and on again and then erase all event memory entries.

### For vehicles **with** start/stop system:

First reset the steering control unit at diagnostic address 0044 (J500) to factory settings via Guided Functions.

- Select option “2” as shown in the picture. (Figure 1;2).
- To do this, go to the basic settings for the test program and use the **login code 1181** for the program “*0044 - Reset all adaptation values / adapt end stops*”.
- The tester may not automatically report that the reset is complete; click on the “Done/Continue” button manually. Afterwards, check whether the coding in control unit J500 (address 0044) under Identification has been set to “00000000000000”.
- If **so**, perform the software update with the specified code (refer to next paragraph).
- If **not**, reset to factory settings again.
- Perform the software update of the steering system with the following SVM code:
- First code: **44A041**, then second code: **44B041**
- The red steering warning lamp may light up after the update. Switch the ignition off and on again and then erase all DTCs.



# Technical Service Bulletin

---

Follow all instructions in TSB 20117352: *00 Software Version Management (SVM), operating instructions.*

Update the 0044 (J500) using the SVM action code as listed in the table below if necessary:

<b>Model</b>	<b>Old Software Part Number</b>	<b>Old Software Version</b>	<b>New Software Part Number</b> (or higher)	<b>New Software Version</b> (or higher)	<b>SVM Code Input</b>
A4, A5	8W0909144N	0172	8W0909144P	1181	<b>44A041</b>
	8W0909144P	1181		1181	<b>44B041</b>



# Technical Service Bulletin

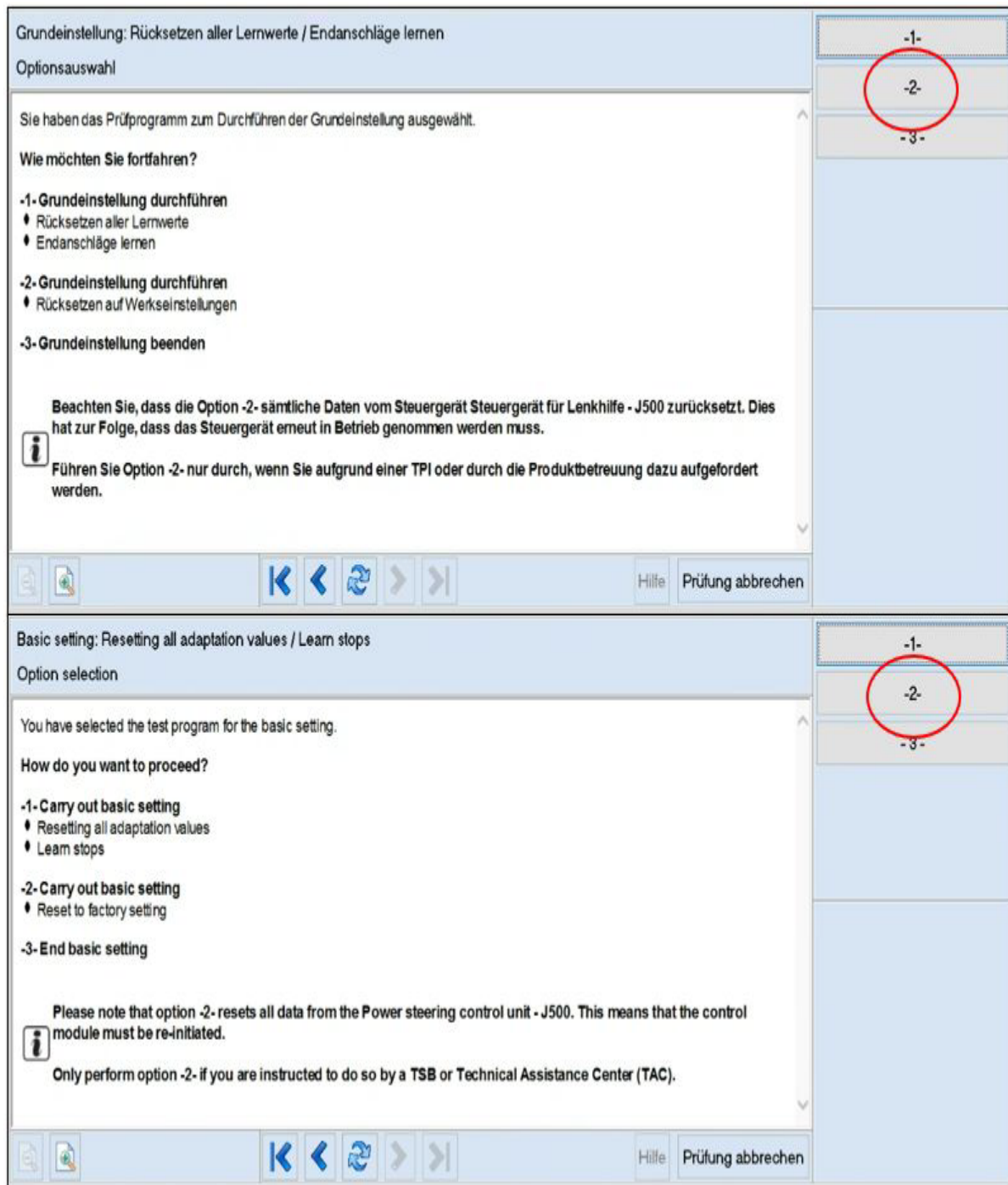

Figure 1: J500 factory settings reset – Guided Functions.



# Technical Service Bulletin

## Warranty

<b>Claim Type:</b>			
<b>Service Number:</b>	4835		
<b>Damage Code:</b>	0040		
<b>Diagnostic Time:</b>	Software update	0151 0010	Time stated on the diagnostic protocol
	Software update	0151 0060	Time stated on the diagnostic protocol
	Road test prior to the service procedure	No allowance	0 TU
	Road test after the service procedure	No allowance	0 TU
<b>Claim Comment:</b>	As per TSB 2074847/1		

All warranty claims submitted for payment must be in accordance with the *Audi Warranty Policies and Procedures Manual*. Claims are subject to review or audit by Audi Warranty.

## Required Parts and Tools

Section may remain blank.

## Additional Information

All part and service references provided in this TSB (**2074847**) are subject to change and/or removal. Always check with your Parts Department and/or ETKA for the latest information and parts bulletins. Please check the Repair Manual for fasteners, bolts, nuts, and screws that require replacement during the repair.

©2024 Audi of America, Inc. All rights reserved. The information contained in this document is based on the latest information available at the time of printing and is subject to the copyright and other intellectual property rights of Audi of America, Inc., its affiliated companies, and its licensors. All rights are reserved to make changes at any time without notice. No part of this document may be reproduced, stored in a retrieval



# Technical Service Bulletin

---

system, or transmitted in any form or by any means, electronic, mechanical, photocopying, recording, or otherwise, nor may these materials be modified or reposted to other sites, without the prior expressed written permission of the publisher.