



## STAR ONLINE PUBLICATION



**Case Number:** S2023000024 Rev. C

**Release Date:** August 2024

**Symptom/Vehicle Issue:** Water Leak Rear Of Cab Rear Seat Or Headliner

**Discussion:** Inspect backlite (rear window) upper plastic frame for cracks. Refer to Service Bulletin 23-016-21 for information on rear window leaks due to window frame cracks.

Possible causes of rear cab water leaks include:

- Incorrect urethane seal around backlite (rear window). Bubbles or pockets in the urethane.
- 3<sup>rd</sup> Brake Light (Center High Mounted Stop Lamp)
- Roof mount antenna

### Verification:

- Step 1: Use low pressure open end water hose (no nozzle) and direct water flow towards areas around the backlite (rear window) roof area. Check interior for leaks.
- Step 2: Move water hose around backlite glass perimeter. Check interior for leaks.
- Step 3: Move water hose around 3rd Brake Light. Check interior for leaks. Verify 3rd Brake Light rubber seal is in good condition. Follow repair listed below for replacing the seal. Take note of which light bulb style is on the truck- LED or Incandescent

This document does not authorize warranty repairs. This communication documents a record of past experiences. STAR Online does not provide any conclusions about what is wrong with the vehicle. Rather, it captures all previous cases known that appear to be similar or related to the vehicle symptom / condition. You are the expert, and you are responsible for deciding on the appropriate course of action.

**Contact STAR Center, or your Technical Assistance Center Via TechCONNECT or eCONTACT ticket if no solution is found**



## STAR ONLINE PUBLICATION



- Step 4: Move water hose around roof antenna. Check roof interior for leaks. Verify foam seal under antenna is in good condition. Verify antenna is torqued to spec

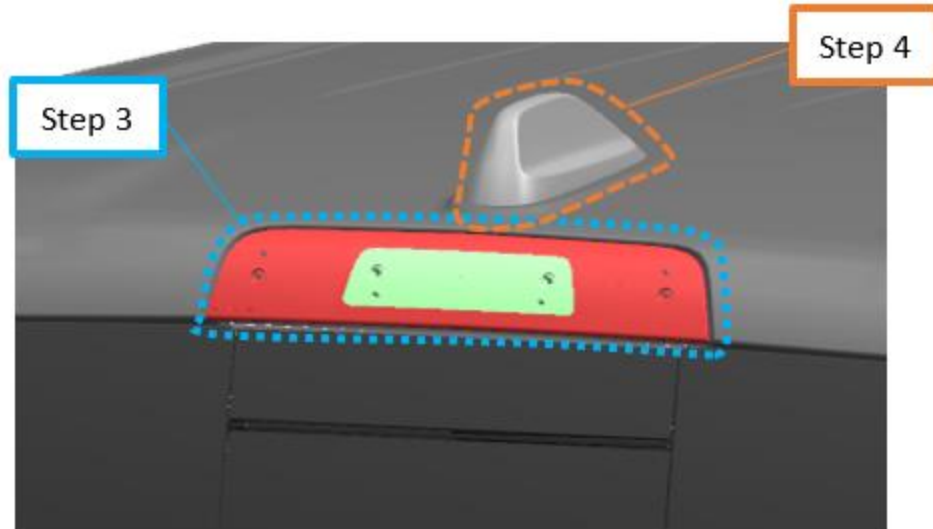

**IF Step 1 or Step 2 yields leaks:** Remove and reseal the backlite and ensure correct urethane seal.

**IF Step 3 yields leaks:** There are 2 different procedures. Note which bulb style you are working on. LED or Incandescent. Always refer to STAR Parts for up to date parts information

Steps for **LED CHMSL** with camera (Part Number 68444540AB)

Order a replacement LED CHMSL (Part Number 68444540AB) and order a secondary gasket (Part Number 68545973AA).

Apply the secondary gasket directly onto the main gasket of the CHMSL. The secondary gasket should be at the top of the part when installed. Remove the adhesive backing from the secondary gasket as you go. You may want to use a ruler or credit card to lightly press the secondary gasket onto the main gasket.

This document does not authorize warranty repairs. This communication documents a record of past experiences. STAR Online does not provide any conclusions about what is wrong with the vehicle. Rather, it captures all previous cases known that appear to be similar or related to the vehicle symptom / condition. You are the expert, and you are responsible for deciding on the appropriate course of action.

**Contact STAR Center, or your Technical Assistance Center Via TechCONNECT or eCONTACT ticket if no solution is found**



## STAR ONLINE PUBLICATION



This document does not authorize warranty repairs. This communication documents a record of past experiences. STAR Online does not provide any conclusions about what is wrong with the vehicle. Rather, it captures all previous cases known that appear to be similar or related to the vehicle symptom / condition. You are the expert, and you are responsible for deciding on the appropriate course of action.

**Contact STAR Center, or your Technical Assistance Center Via TechCONNECT or eCONTACT ticket if no solution is found**



## STAR ONLINE PUBLICATION



Final result should look like the image below:



Check: once the CHMSL is installed onto the vehicle there should be no gasket visible from the top or the sides.

### STEPS for **Incandescent Bulb CHMSL** (Part Number 68298380AE)

Order a replacement Incandescent Bulb CHMSL (Part Number 68298380AE) and a secondary gasket (Part Number 68545973AA).

**Note:** part numbers 68298380AF and 68298380AG will already have the secondary gasket applied and you won't have to order the part separately.

Apply the secondary gasket onto the plastic above the main gasket; the secondary gasket and main gasket will not touch. The secondary gasket should be at the top of the part when installed.

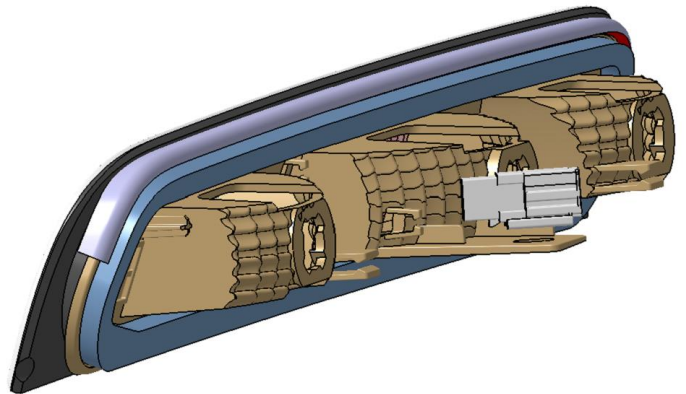

Check: once the CHMSL is installed onto the vehicle there should be no gasket visible from the top or the sides.

IF Step 4 yields leaks, ensure proper torque of fastener and good condition of foam seal. Replace the seal as necessary.

This document does not authorize warranty repairs. This communication documents a record of past experiences. STAR Online does not provide any conclusions about what is wrong with the vehicle. Rather, it captures all previous cases known that appear to be similar or related to the vehicle symptom / condition. You are the expert, and you are responsible for deciding on the appropriate course of action.

**Contact STAR Center, or your Technical Assistance Center Via TechCONNECT or eCONTACT ticket if no solution is found**