



Bulletin No.: PIP5974A

Published date: N/A

Preliminary Information

PIP5974A GF9 9T45/50/60/65 Transmission 1-2-3-4-5-6 Clutch Snap Ring Popout Causing SES / DTC Code P0746 P0747

Models

Brand:	Model:	Model Years:	VIN:		Engine:	Transmissions:
			from	to		
Buick	Encore GX	2024	All	All	All	M3F
Buick	Enclave	2024	All	All	All	M3W
Cadillac	XT4	2024	All	All	All	M3H
Cadillac	XT5	2024	All	All	All	M3G M3W
Cadillac	XT6	2024	All	All	All	M3G M3W
Chevrolet	Blazer	2024	All	All	All	M3T M3V
Chevrolet	Trailblazer	2024	All	All	All	M3F
Chevrolet	Traverse Limited	2024	All	All	All	M3V
GMC	Terrain	2024	All	All	All	M3U

Involved Region or Country	North America, Japan, South Korea, Europe, Palestine, Middle East
Condition	<p>Some Buick, Cadillac, Chevrolet and GMC vehicles equipped with the GF9 9T45/50/60/65 automatic transmission may experience: a SES light on with code P0746 or P0747. This may be accompanied by no drive or slipping drive condition.</p> <p>These transmissions will be built between 10/1/2023 and 4/22/2024</p> <p>Julian date between 23 274 and 24 113</p> <div style="text-align: center;"> </div>

1. Broadcast Code
2. Source DUNS Number
3. Transmission Unique Number (TUN)
4. 2D Machine Readable Matrix
5. VPPS Code
6. Part Sequence Number
7. Site ID
8. Broadcast Code
9. Julian Date
10. Year of Build
11. Shift ID
12. Line Plant ID
13. GM Part Number

The transmission concern could be caused by an out of round snap rings: (594) 1-2-3-4-5-6 Clutch Spring Retaining Ring or (599) 1-2-3-4-5-6 Clutch Backing Plate Retaining Ring

Cause

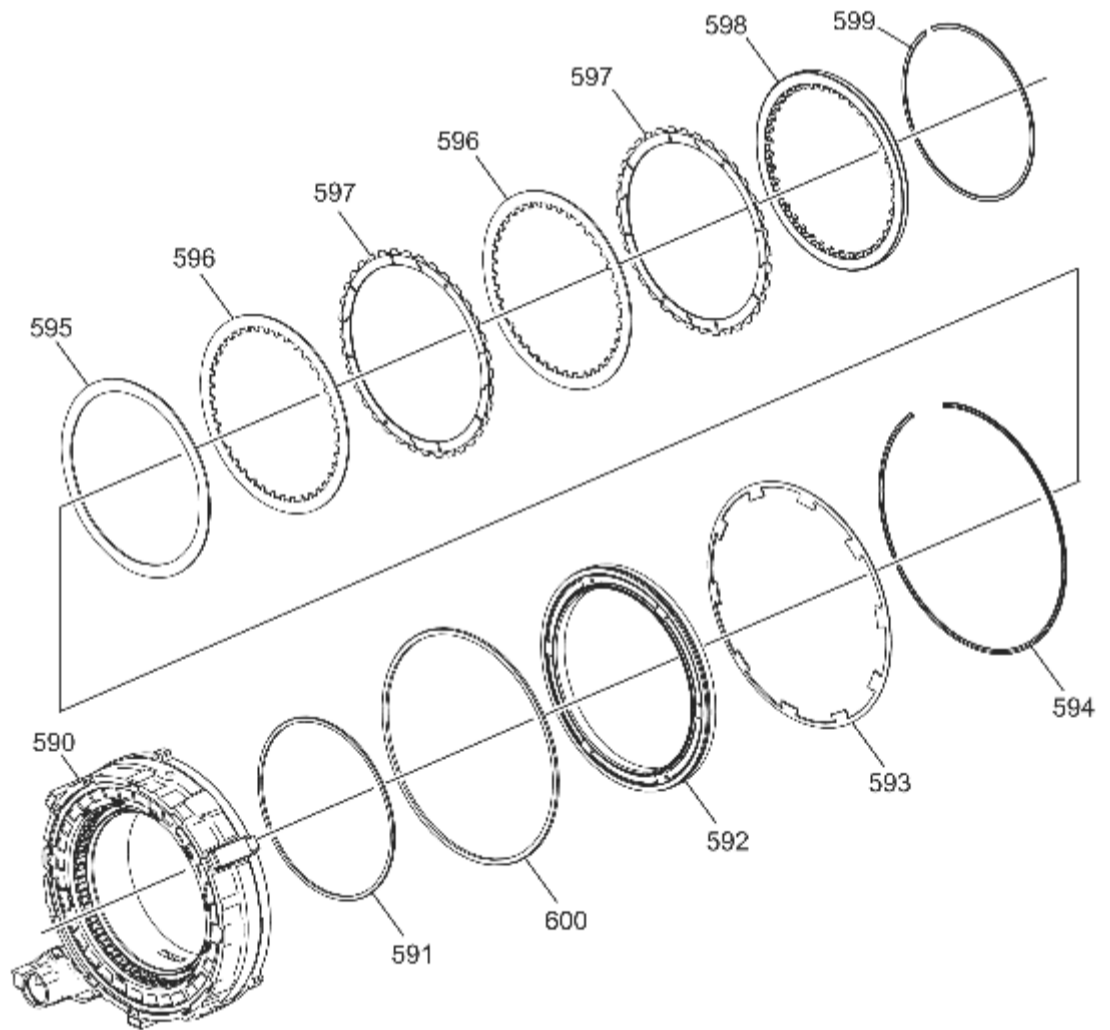

Correction:

Check transmission Julian build date.

If the transmission is built between 10/1/2023 and 4/22/2024; Julian date between 23 274 and 24 113 and the vehicle comes in with a code P0746 or P0747 and the code resets on a short test drive or the vehicle slips in drive, the transmission will need to be disassembled and inspected for damage.

***NOTE: Do not replace the Control valve body assembly (Valve body) or Control valve solenoid body assembly (Solenoid body) as these are not related to the concern.**

The following parts will need to be replaced:

(590)1-Reverse and 1-2-3-4-5-6 Clutch Piston Housing

(591)1-2-3-4-5-6 Clutch Piston Inner Seal

(592)1-2-3-4-5-6 Clutch Piston

(593)1-2-3-4-5-6 Clutch Piston Return Spring

(594)1-2-3-4-5-6 Clutch Spring Retaining Ring

(595)1-2-3-4-5-6 Clutch Plate - Wave

(596)1-2-3-4-5-6 Clutch Plate

(597)1-2-3-4-5-6 Clutch Plate - Friction

(598)1-2-3-4-5-6 Clutch Backing Plate

(599)1-2-3-4-5-6 Clutch Backing Plate Retaining Ring

(600)1-2-3-4-5-6 Clutch Piston Seal

Please follow SI procedures for repairs and all other recommendations for 1 time use components (gaskets, seals or bolts).

Note: Engineering is still researching the concern and the info will be updated if needed.

Warranty Information

For vehicles repaired under the Powertrain coverage, use the following labor operation. Reference the Applicable Warranties section of Investigate Vehicle History (IVH) for coverage information.

Labor Operation	Description	Labor Time
8465262	1-Reverse and 1-2-3-4-5-6 Clutch Piston Housing Overhaul	Use published labor for your vehicle

Version History

Version	2
Modified	04/29/2024 - Created on. 05/06/2024 - Updated parts in correction section.



GENERAL MOTORS

© 2024 General Motors. All Rights Reserved.