



S-Series™

2.0 Cab Water Leaks - HVAC

Date: July 11, 2024
Bulletin Name: FDM-SVC-040
Model: 2.0 Front Discharge Mixers
Units Affected: VIN 788727-829689

Purpose:

This bulletin provides instructions to seal around the HVAC fresh air intake and drains ports, and install a deflector bracket to prevent water ingress into the cab.

Notice:

- Read and understand this bulletin in its entirety before performing this procedure.
- All procedures outlined in the bulletin must be performed by skilled service personnel. Refer to the product service manual for descriptions of maintenance procedures.

SAFETY NOTICE

Perform your company's Lockout/Tagout procedure. If your company does not have a Lockout/Tagout procedure, follow OSHA 1910.147 and 1910.146 Confined Space as appropriate.

SAFETY NOTICE

Use appropriate Personal Protective Equipment (PPE) as required by your company.

Tools and Equipment Required

Customer to supply:

- Hand tools
- Torque wrench (inch pounds)

Parts Required

Item	Part Number	Description	Qty.
1	A001J457	BRKT, DEFLECTOR, AIR INTAKE	1
2	A001J349	L-PLATE 4.75 X 3.79 X 0.13 SS	1
3	A000A706	SCR, CAP HEX G8 MB 0.25-20 X 1.25"	2
4	A000R707	WASH, FLT TYPE A MB 0.25 X 0.62	3
5	A000A899	NUT, HEX, G8 MB 0.25-20	1
6	65270AX	LOCTITE® #242	A/R
7	24758FX*	ADHESIVE, RTV108	A/R

* or CRC 14055 RTV Silicone sealant which has a dispenser handle for easier use.



Procedure

Lockout/Tagout

1. Place unit on a flat surface, engage parking brake, turn front wheels to full right, chock truck tires, turn ignition switch OFF, and perform your company's Lockout/Tagout procedure. If your company does not have a Lockout/Tagout procedure, follow OSHA 1910.147 and 1910.146 Confined Space as appropriate.

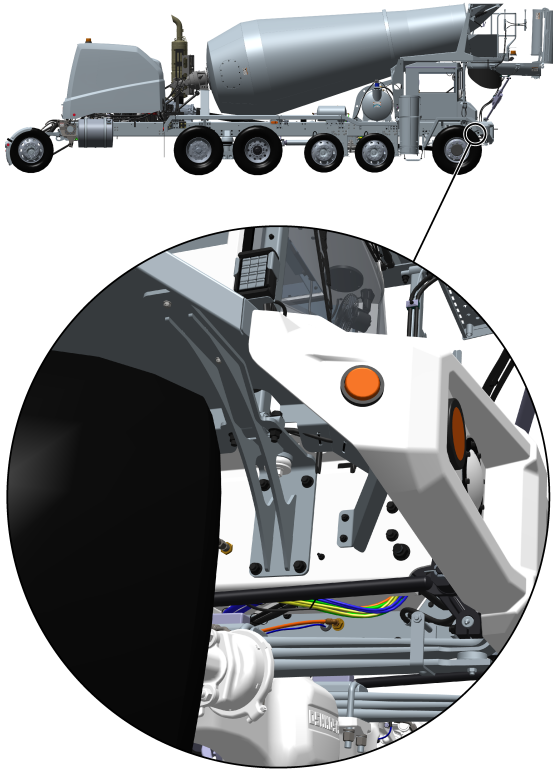

Access View with Front Wheels Turned Full Right

Figure 1. Right Front Wheel Well

2. The vehicle's BATTERY DISCONNECT switch is located on the left-hand side of the battery box. Use the battery disconnect switch when performing any maintenance so the vehicle cannot accidentally be started.

- a. Turn the battery disconnect switch (Figure A, Item 1) counterclockwise so the hole on the switch aligns with the hole in the bracket (Figure A, Item 2).
- b. Install the safety lockout device ring (Figure B, Item 1) through the holes on the battery disconnect switch and the bracket.
- c. Install a padlock (Figure B, Item 2) onto the safety lockout device ring, lock it, and put the key in your pocket. If more than one person is working on the vehicle, each person must install his or her own padlock.

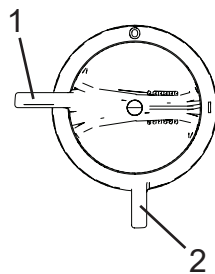

Figure A

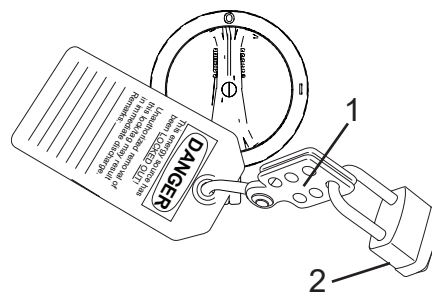

Figure B

3. Locate the three HVAC drains through the bottom of the cab near right-hand frame rail. See Figure 2.

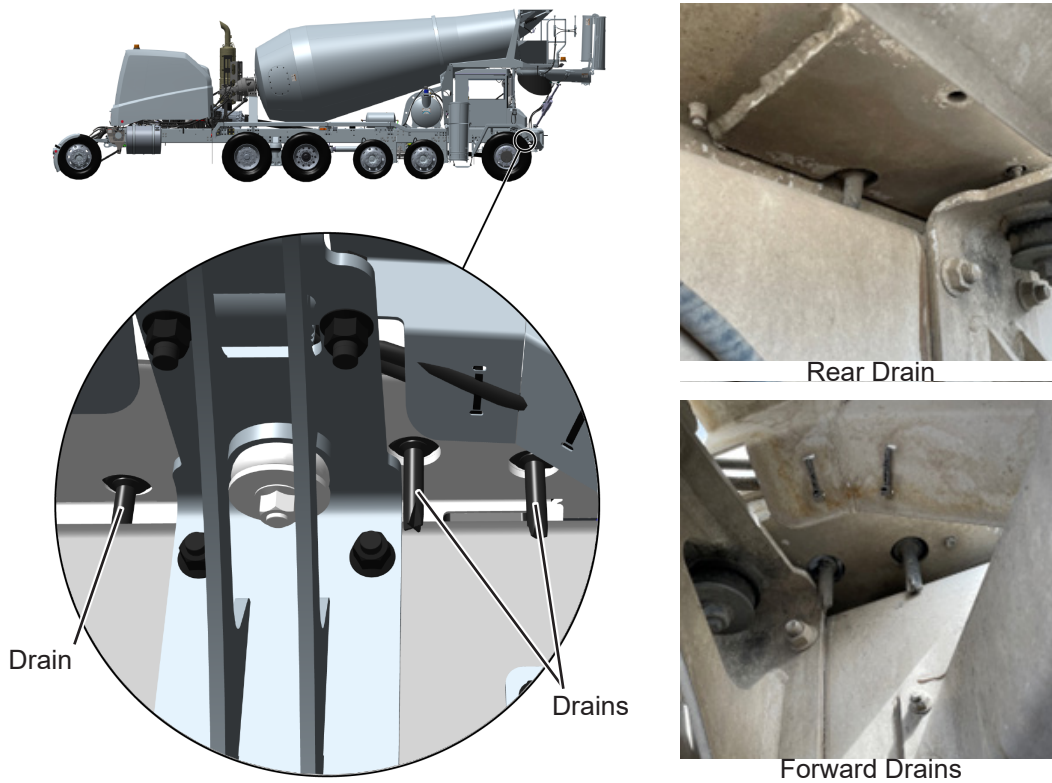

Figure 2. HVAC Drains

4. Apply RTV silicone around the 3 drains where drain comes through hole in bottom of cab. See Figure 3. Smooth RTV silicone around drain with a tool or rag and clean-up area.

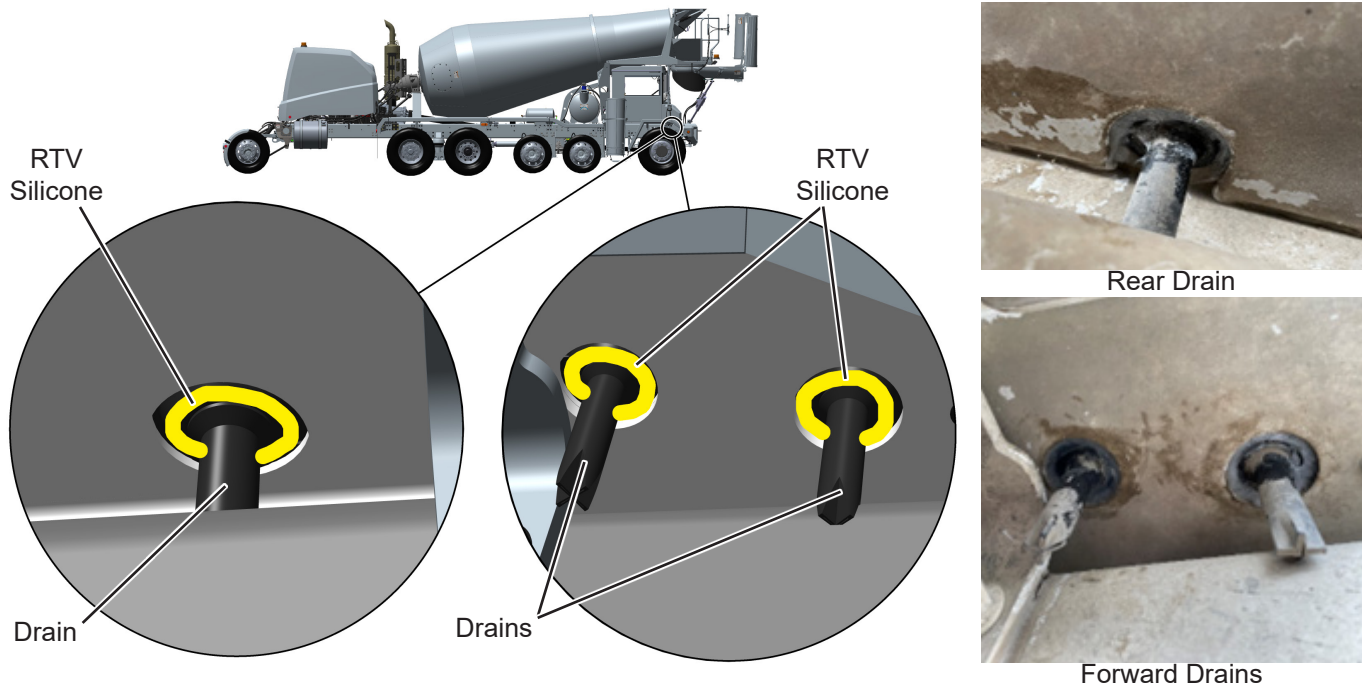

Figure 3. HVAC Drains

5. Remove the two screws securing HVAC fresh air intake inside front right-hand bottom corner of cab. See Figure 4. One of the two screws will not be reused.

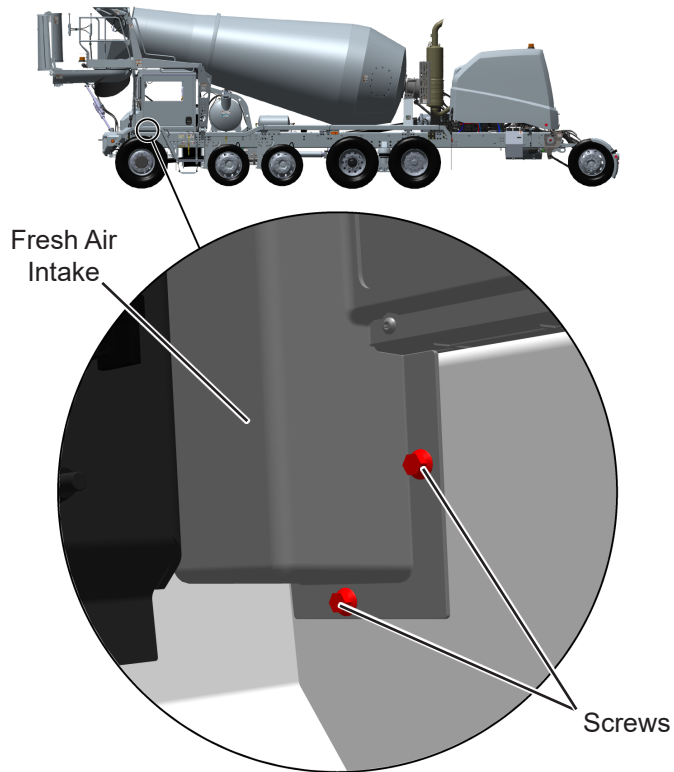

Figure 4. HVAC Fresh Air Intake

6. Apply a bead of RTV sealant around perimeter of fresh air intake mounting flange. See Figure 5.

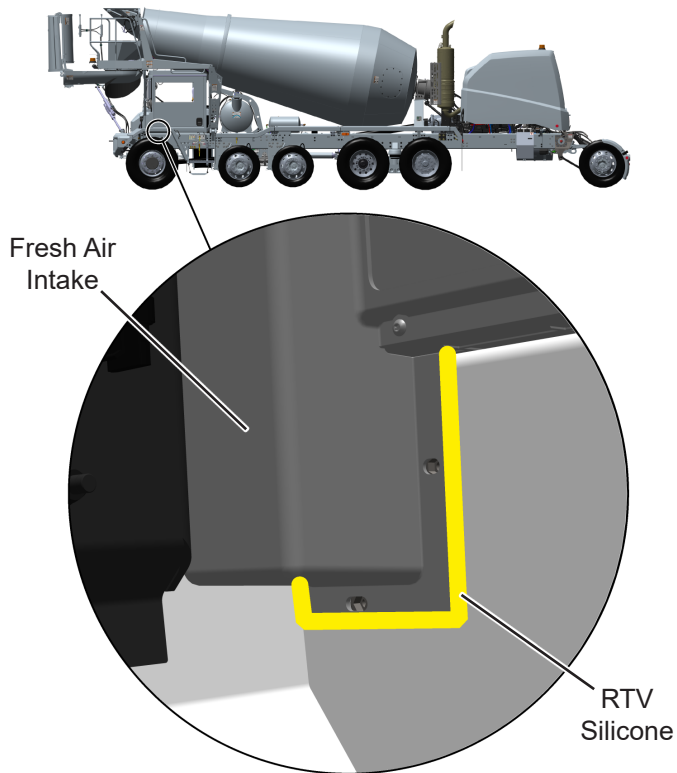

Figure 5. HVAC Fresh Air Intake



7. Apply Loctite® #242 to threads of 0.25-20 x 1.25" screw (A000A706) and one of the 0.25-20 x 0.75" screws removed in Step 5. See Figure 6.
8. Install flat washer (A000R707) on screws. See Figure 6.
9. Secure L-plate bracket (A001J349) on fresh air intake flange with screws and flat washers. See Figure 6. Install 0.25-20 x 1.25" screw in bottom L-plate bracket location. Final tighten screws to 49 in lbs.

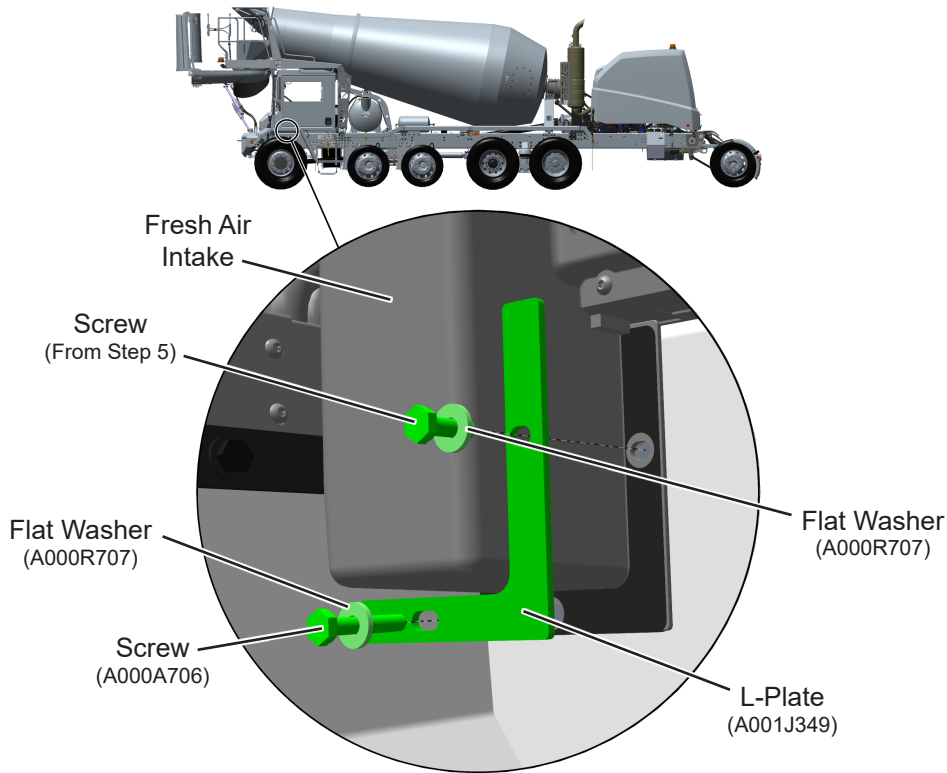

Figure 6. HVAC Fresh Air Intake

10. Locate the 0.25-20 x 1.0" mounting screw on the bottom of the cab in front of the forward drain. See Figure 7.
11. Loosen and remove screw. Screw will not be reused.

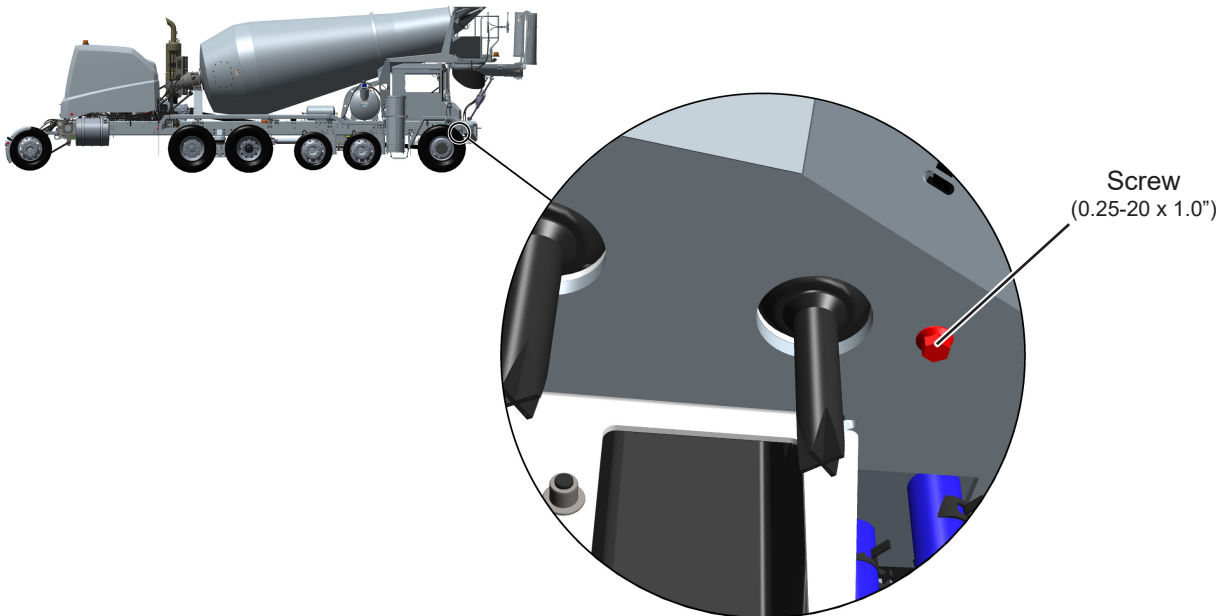

Figure 7. HVAC Drains

12. Slide deflector bracket (A001J457) under the cab nose rubber flap near the right-hand frame rail, then rotate deflector bracket into position between frame rail and cab. See Figure 8.

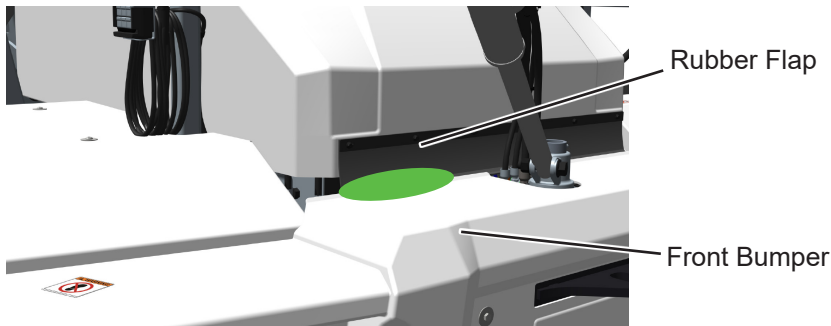

Figure 8. Cab Nose Rubber Flap

13. Cover the cab air intake opening with the bracket and slide the bracket lower mounting hole onto end of screw installed in Step 9. See Figure 9.

14. Apply Loctite® #242 to threads of screw installed in Step 9 and install flat washer (A000R707), and nut (A000A899) finger tight. See Figure 9.

15. Install flat washer (A000R707) on 0.25-20 x 1.25" screw (A000A706). See Figure 9.

16. Apply Loctite® #242 to threads of 0.25-20 x 1.25" screw (A000A706) and install screw with flat washer in bracket upper mounting hole. See Figure 9.

17. Final tighten upper mounting screw and lower nut to 49 in. lbs.

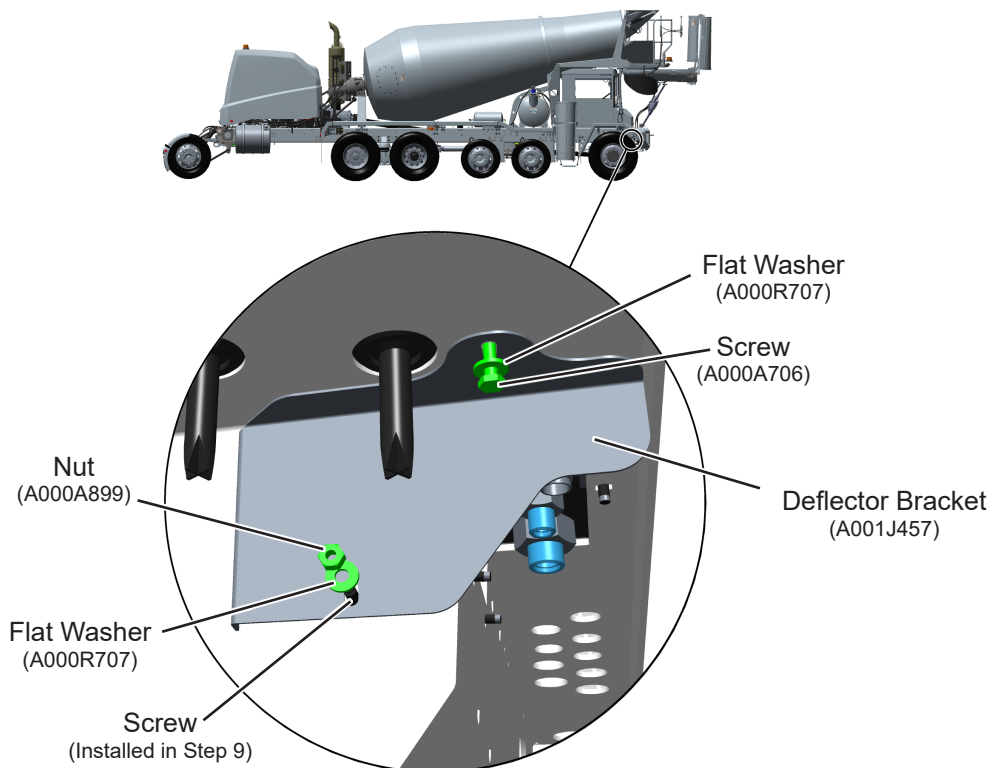

Figure 9. Deflector Bracket - Right-Hand Frame Rail Hidden for Clarity

18. Remove lockout/tagout and tire chocks.

Continuous Improvement:

The change included in this document is part of the McNeilus Continuous Improvement Process.

McNeilus's quality policy is providing customer satisfaction through innovative products, dedicated service, and a constant focus on continuous improvement.



(888) 686-7278

www.streetsmartparts.com