



PAB1160: ENABLE P&A SUBWOOFER WITH SKYLINE OS SOFTWARE VERSION 2237D

Reason for Revision

Table 1

Table 1. Document History

Date	Rev	Revision (Rev) Description
2024-07-10	-	Initial release

Purpose for Parts and Accessories Bulletin

To inform dealers on how to enable Subwoofers with Skyline™ OS software version 2237D.

NOTE

Service bulletin M1635 must be completed prior in doing this procedure.

Vehicles Affected

2023 CVO: Street Glide (FLHXSE), Road Glide (FLTRXSE)

2024: Street Glide (FLHX), Road Glide (FLTRX), CVO Street Glide (FLHXSE), CVO Road Glide (FLTRXSE), CVO Road Glide ST (FLTRXSTSE)

Key Messages

NOTE

If software version is not updated to 1.5.0.0 prior to installation, then the steps laid out below will need to be followed.

Make sure Skyline™ OS has been updated to software version 2237D and amplifier software (1.5.0.0) prior to installation.

If installed with prior Skyline™ OS software versions (2111 D and 1467D) this may result in a no audio condition.

Markets Affected

All markets affected.

USB Drive Best Practices

To optimize software updates and minimize potential issues, follow these best practices regarding your USB device.

- Use a reputable brand of USB flash drive (e.g., SanDisk, Kingston, Samsung, PNY)
- Use a dual USB-A/USB-C drive (no adapters)
- Choose a drive with at least 100 MB/s read/write speed, typically specified on the packaging (e.g. "Speed up to 200MB/s").
- Ensure the drive is formatted properly for your device:
 - IFCU/Skyline OS, Amplifier: exFAT
 - Pan America/Sportster S/Nightster S TFT Gauge, GT/GTS Radio: FAT32
- Only have one update file on the drive at a time. Review specific installation instructions to verify the correct file or folder is copied to your USB.



- Drive size should be 32GB. Drives larger than 32GB can't be formatted to FAT32 and will not work for updates requiring that format.

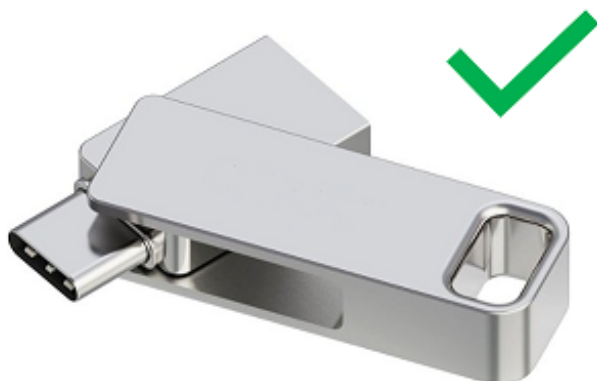

Amplifier for Software Version 1.5.0.0

NOTE

Some vehicles have already shipped with Software Version (1.5.0.0).

1. Check software version:
 - a. **Select:** Settings (on Infotainment Control Unit (IFCU))
 - b. **Navigate:** System > System Info > Product Information
2. One required software file need to be downloaded for the Skyline™ OS.
 - a. Software files may be found at: <https://serviceinfo.harley-davidson.com/sip/content/document/view?id=1921954209503626638>.

Summary

1. Remove main fuse. See service manual.
2. Install kits:
 - a. Primary Subwoofer Installation Kit (Part No. 76001302)
 - b. Secondary Amplifier Kit (76001444)
 - c. Primary Subwoofer kit (Part No. 76001376)
 - d. If applicable install the following, Secondary Subwoofer Installation Kit (Part No. 69203434) and Secondary Subwoofer Kit (Part No. 76001377).
3. See Figure 3. Disconnect connector [325].
 - a. If this is not done, the primary amplifier software will not update. Refer to link: <https://serviceinfo.harley-davidson.com/sip/content/document/view?id=1921948860436412814>
4. Install main fuse. See service manual.

NOTE

*Physically switching to Accessory mode (**ACC** or **ACCY**) is no longer a selectable feature on Center-Cooled vehicles.*

5. Turn on **Accessory** mode. See owner's manual.
6. See Figure 2. After the IFCU and Skyline™ OS has fully-booted up, insert flash drive with Primary Amplifier software version (1.5.0.0).

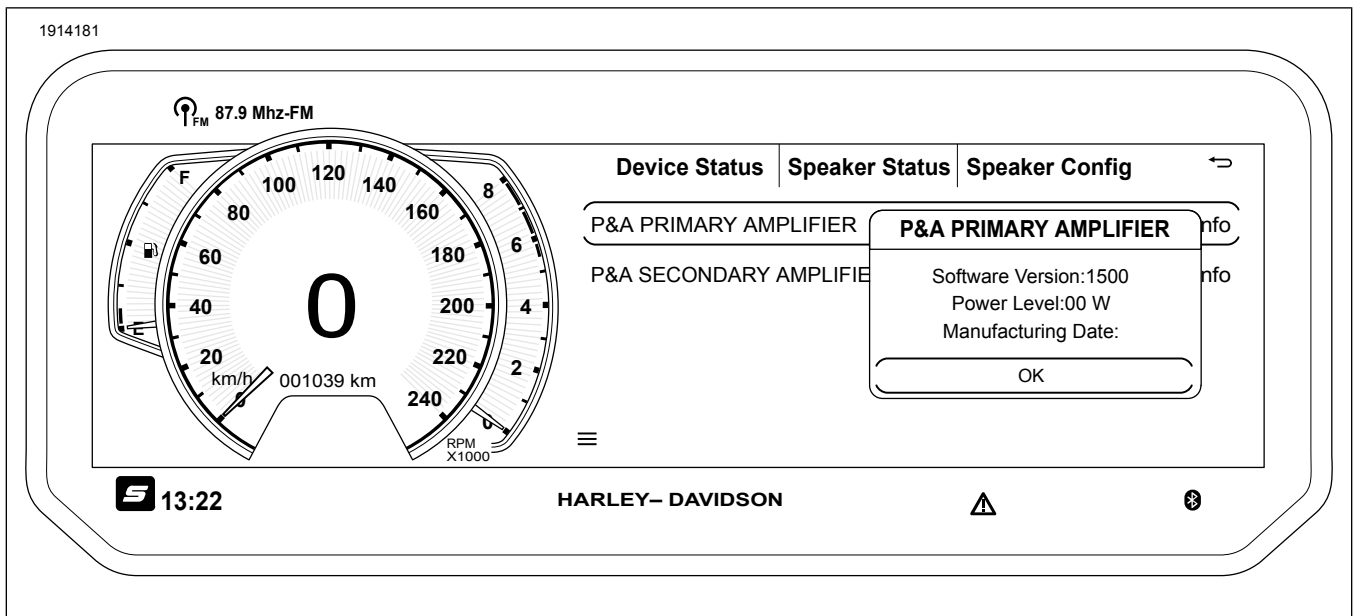

Figure 2. Skyline OS

7. Wait for software update to complete.
 - a. After completion, check software update was completed under the Speaker setup menu.
8. Turn off **Accessory** mode. See owner's manual.
 - a. Wait one minute.
 - b. See Figure 3. Connect connector [325].
9. Turn on **Accessory** mode. See owner's manual.
10. Confirm in Speaker setup menu:
 - a. Primary and secondary amplifiers are detected.
 - b. Software version (1.5.0.0).
11. Connect Digital Technician II (DT II) to the vehicle
 - a. Navigate to Vehicle Set up > IFCU Customization > IFCU Configuration
 - b. Confirm Primary and Secondary Amp software version is (1.5.0.0) in DT II IFCU configuration screen
 - c. Enable the appropriate speaker configuration that have been installed on the vehicle.
12. For a step-by-step process, refer to link: <https://serviceinfo.harley-davidson.com/sip/content/document/view?id=1921948860436412814>

NOTE

At this time, subwoofer Gain menu item will show in Sound Menu of the IFCU.

- a. Default Subwoofer Gain shown is level 5 but actual subwoofer output is at level 10 (maximum).
- b. Subwoofer Gain adjustment has no effect on audio output.

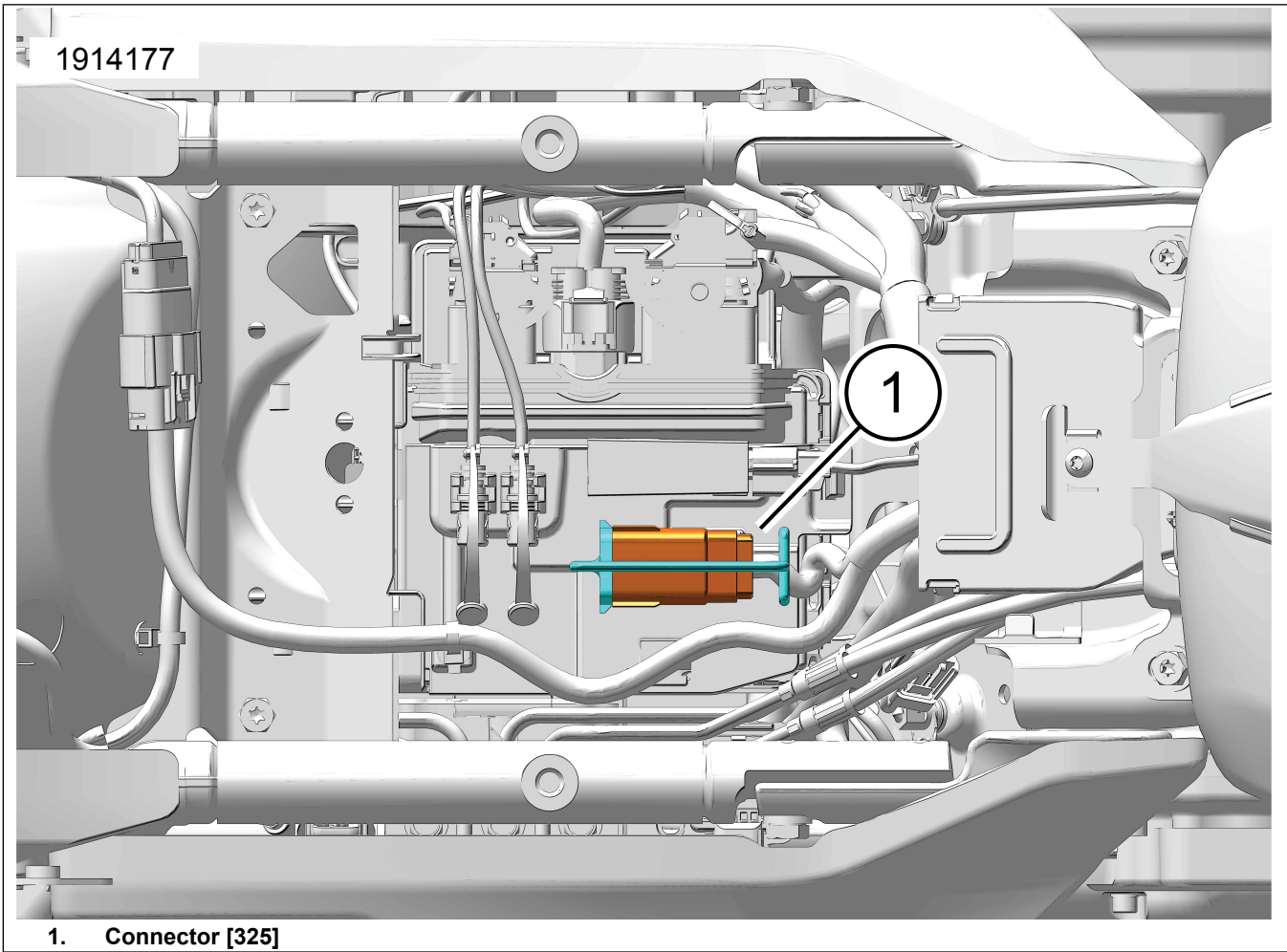

Figure 3. P&A Connector

Questions

Contact Technical Service with any concerns regarding application. Direct all other questions to the Dealer Services Representative.