

Extreme Insulation For Cascadia



What is it?

Extreme insulation is now available on Cascadia sleeper cabs. This package features thicker layers of THINSULATE™ and foam, as well as a layer of insulation on the halo panels between the lower bunk area and the roof of the sleeper.

Why is it important?

By utilizing THINSULATE™ materials, in addition to barrier foam and mylar foam, extreme insulation provides a generous amount of thermal and acoustic insulation on the front wall, flooring, roof, and along the side. In combination with a thicker floor pad to keep extreme heat and cold out of the cab, this insulation package allows the HVAC system to use 18.64% less energy than the premium insulation. Thermal performance is improved, meaning a comfortable temperature is easier to maintain, which increases driver comfort and productivity. This insulation package was designed to maximize driver comfort for customers who operate in environments where noise and temperatures are extreme.

Key Features:

- Improved thermal performance by 18.64%
- Improved acoustics
- Increased driver comfort

Resources: Highspot

Affected models: Cascadia, c/o 8/12/24

Data Code:

739-028: EXTREME CLIMATE THERMAL CAB AND SLEEPER INSULATION

Compatibility: Sleepers Only. See SpecPro for more information

Pre-requisite Options: See SpecPro for more information

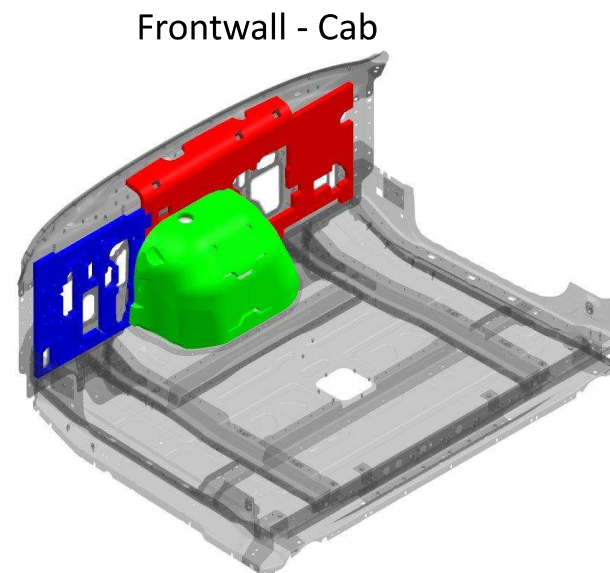

Red = 27mm (Thinsulate)
 Blue = 25.4mm (Foam-Barrier-Foam)
 Green = 25.4mm (Fiber Decoupler)

THINSULATE™: extremely fine microfibers that trap air and block radiant heat loss

Mylar: closed cell PVC foam

Barrier: thermal layer to prevent high temperatures

PSA: pressure sensitive adhesive – type of foam that uses a non-reactive adhesive to bond to a surface when applied

Fiber Decoupler: multiple single-mode fibers parallel to each other and enclosed

Extreme Insulation For Cascadia



Sleeper – Raised Roof

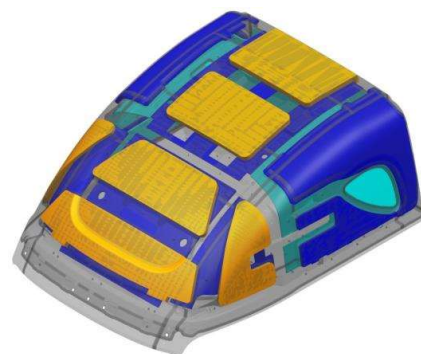
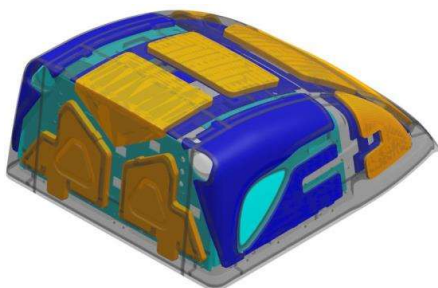

Blue/Light Blue = 27mm (Thinsulate)
Orange = 50mm (Thinsulate)

Sleeper – Mid Roof

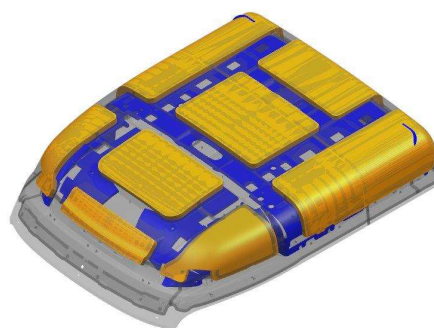
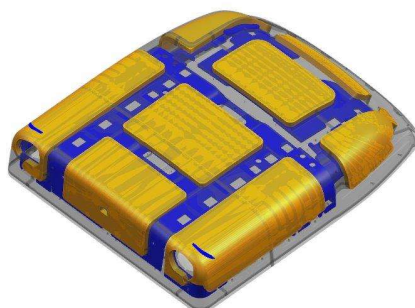

Orange = 50mm (Thinsulate)
Blue = 27mm (Thinsulate)

Sleeper – Cab

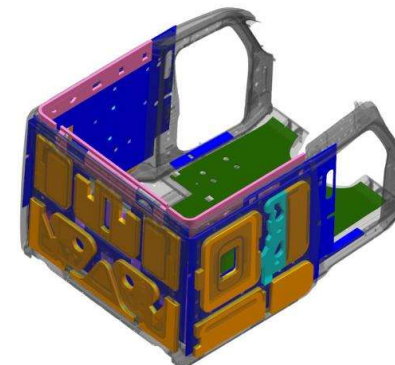
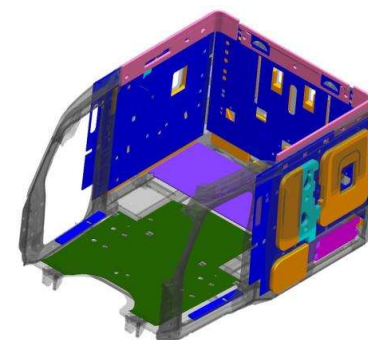

Purple = 6.3mm (Mylar-Foam-Mylar)
Dark Green = 12.7mm (Mylar-Foam-Mylar)
Magenta = 12.7mm (Foam-Pressure Sensitive Adhesives)
Orange/Light Blue = 50mm (Thinsulate)
Blue/Pink = 27mm (Thinsulate)