



# Service Bulletin

Bulletin No.: 24-NA-133

Date: July, 2024

## INFORMATION

**Subject: Wheel Drive Shaft Retention Snap Ring Design Change**

Brand:	Model:	Model Year:		Vehicle Build Date:		Engine:	Transmission:
		from	to	from	to		
BrightDrop	Zevo 600	2025	2025	-	-	All	All
Chevrolet	Silverado EV	2024	2024	August 19, 2024	EOP	All	All
GMC	HUMMER EV Pickup	2024	2024	April 17, 2024	EOP	All	All
	HUMMER EV SUV	2024	2024	April 17, 2024	EOP	All	All

<b>Involved Region or Country</b>	North America
-----------------------------------	---------------

### Information

**Important: Service agents must comply with all International, Federal, State, Provincial, and/or Local laws applicable to the activities it performs under this bulletin, including but not limited to handling, deploying, preparing, classifying, packaging, marking, labeling, and shipping dangerous goods. In the event of a conflict between the procedures set forth in this bulletin and the laws that apply to your dealership, you must follow those applicable laws.**

**Important:** This technical service bulletin (TSB) can only be completed by certified repair facilities who have met all specific training, tool and equipment requirements pertaining to the vehicle Brand and Model serviced. Repairs must be performed by a technician who has successfully completed the required training. The above vehicles starting using a newly designed 3-point snap ring that retains the wheel drive shaft to the drive unit output shaft.

The design change occurred to achieve greater retention forces between the wheel drive shaft and the drive unit output stub shaft.

The easiest way to know if the vehicle was built with a round snap ring vs. a 3-point oval snap ring is by looking for the presence of a service groove on the wheel drive shaft as shown below.

Service Groove (New Design)

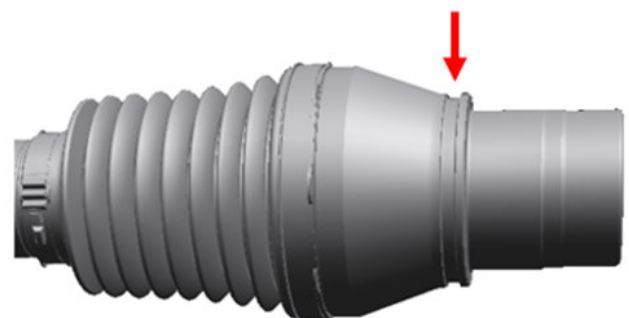

6690539

With the wheel drive shaft removed, the round style snap ring will fit loosely in the drive unit shaft groove. The 3-point style snap ring will fit very tightly in the drive unit shaft groove.

When servicing the vehicle, if the wheel drive shaft is removed or replaced, care must be taken to determine which snap ring is present. The round (silver) snap ring is considered the first design (Des 1), and the 3-point (black) oval snap ring is considered the second design (Des 2). Refer to the Electronic Parts Catalog for Design 1 and Design 2 designations.

**Important:** The snap ring MUST ALWAYS BE REPLACED when removing or replacing the wheel drive shaft.

With the snap ring removed, lay the snap ring on a flat surface, and look at the shape of the snap ring.

**Round Ring First Design: PN 24048716**



6690540

**3 Point Oval Ring Second Design: PN 24052327**



6690541

Additionally, the 3-point design wheel drive shaft is equipped with a service groove that requires the use of special tool CH-53441 - Half Shaft Slide Hammer Installer Adapter and VJ-6125-1B Slide Hammer. Refer to Service Information for removal and installation instructions.

**Service Groove design uses the 2nd design Oval Snap Ring PN 24052327**

Service Groove (New Design)

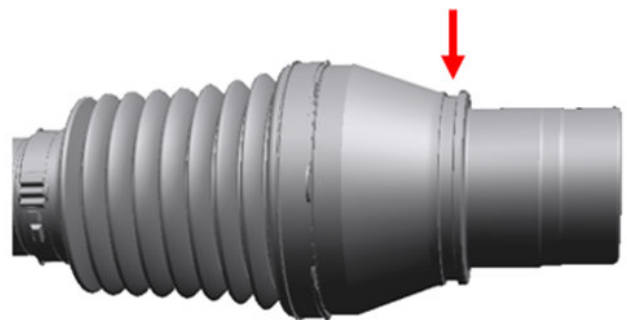

6690542

NO Service Groove design uses the 1st design  
Round Snap Ring PN 24048716

NO Service Groove (Old Design)

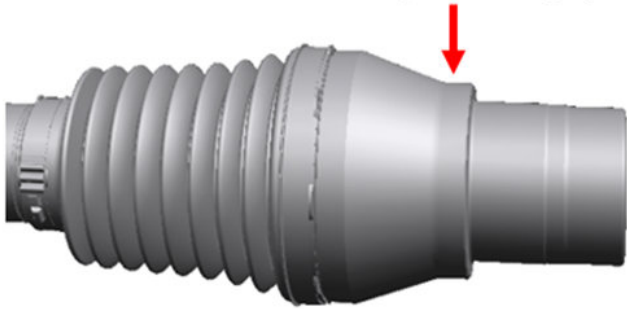

6690543

Version	1
Modified	Released July 18, 2024

