



## SIB 11 02 24

Service Action: Replace oil sump control piston

2024-07-18

This Service Information Bulletin replaces SIB 11 02 24 **dated July 17 2024**.

### What's New (Specific text highlighted):

- Typo found and corrected in Part Section

### MODEL

Model	Model Description	Model Code
KA1	R 1300 GS	0M23

The affected vehicles have been marked with campaign number **0011560000** in AIR.

In order to determine if a specific motorcycle is affected by this campaign, it will be necessary to verify the vehicle VIN in AIR (Aftersales Information Research). Based on the response of the system, either proceed with the repair or take no further action. Please note, open campaigns or vehicle stops may not appear in DCS Warranty Vehicle Inquiry or sales systems until 24-72 hours after they are announced, therefore AIR is always the recommended method for determining open campaigns and vehicle stops.

### SITUATION

A group of guide rings for the control piston in the oil sump were made with a different material. This can degrade the operation of the control piston over time and can cause engine damage due to insufficient oil supply.

### PROCEDURE

For vehicles that have not yet been delivered, the service action must be completed before vehicle handover. If the service action cannot be completed due to a parts shortage, the service action then must be performed during the next possible workshop visit when parts become available. In such instances, it is essential to inform the customer of the situation.

In all instances in which the vehicles have already been handed over to customers, the Technical Campaign must be performed at the next workshop visit.

The control piston must be replaced via the screw plug according to the repair instructions "00 60 444 – Replace the control piston."

If the repair is done during a service visit the oil change is then necessary; however, if the repair is carried out outside of a regular service visit the oil removed can be reused.

NOTE: Make sure to use a clean drain pan in order to avoid oil contamination.

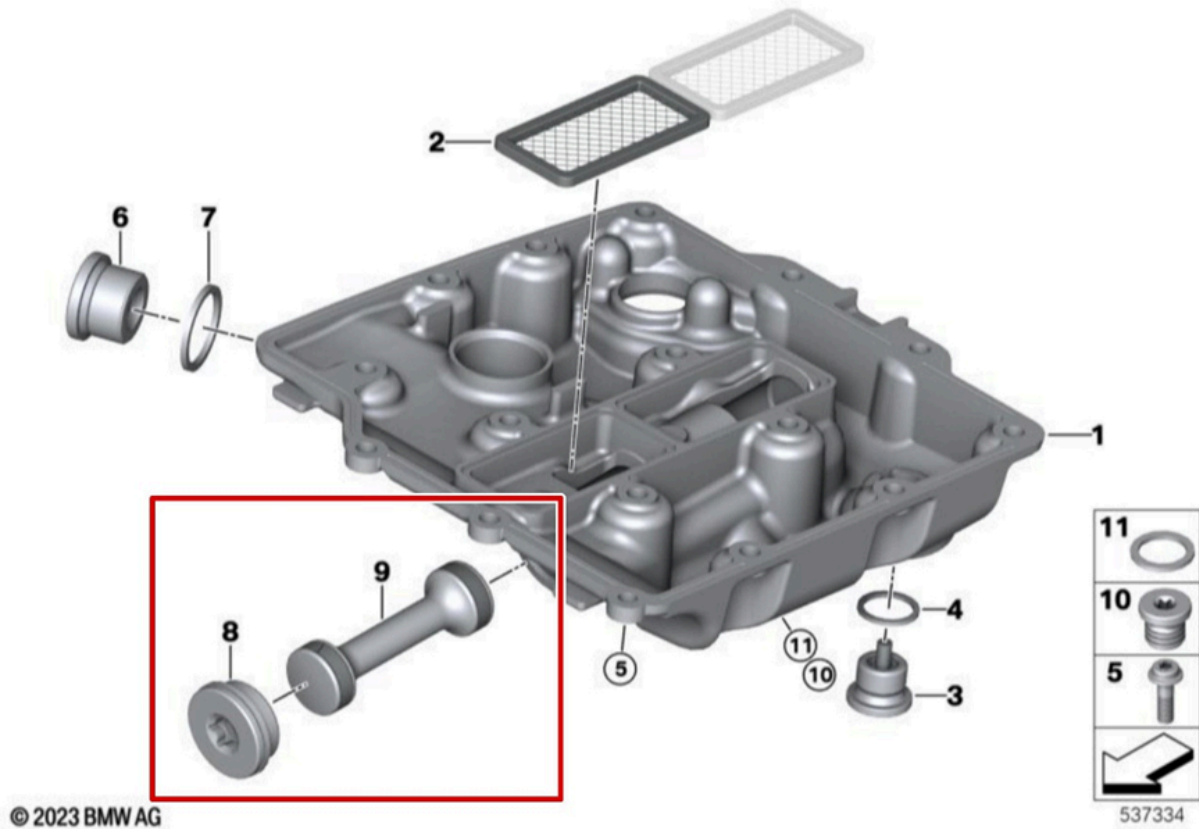

#### NOTICE's:

1. If there are other than normal oil contamination during draining e.g. noticeable metal chips, a TSARA case with detailed photos must be created, and a decision of further repair must be made by the TSARA team in the case for documentation.
1. On brand new vehicles, the rear silencer clamp can be reused.
1. Other consumables are already included in the flat rate unit and will not be compensated.

## PARTS INFORMATION

Obtain and confirm the part numbers for your specific vehicle by entering the chassis number in ETK which takes into account specific equipment and/or options.

Additional parts like gaskets, hardware and chemicals may be required for the complete repair.

#### Part Number

11 13 7 914 999	Control piston	QTY 1
07 14 7 914 740	Screw plug (M28×1.5)	QTY 1
07 11 9 963 073	Sealing ring	QTY 1
07 11 9 963 252	Sealing ring	QTY 1
18 51 9 445 093	Exhaust manifold seal	QTY 2
18 40 7 571 440	Hexagon nut (M8) - exhaust manifold	QTY 6
18 51 8 405 432	Rear silencer clamp	QTY 1

NOTE: Screw plug (07 14 7 914 740) is supplied with the required sealing plug.

Copyright ©2024 MOTORRAD USA, a division of BMW of North America, LLC. All Rights Reserved

## CLAIM INFORMATION

Please submit claims via the normal claim process using the information below:

### Defect code

00 11 56 00 00	Replacing the oil sump control piston
----------------	---------------------------------------

### Labor Operation

00 60 444	Replace control piston	Refer to AIR for FRU
+00 60 944	Replace control piston	Refer to AIR for FRU

FRUs includes all repair procedures to complete the task with allowance for necessary ancillary tasks (e.g., visual inspection, lubrication, cleaning parts etc.) and administrative tasks.

Labor operation code 00 60 444 is a Main labor operation. If you are using a Main labor code for another repair, use the Plus code labor operation instead.

## QUESTIONS REGARDING THIS BULLETIN

Technical inquiries	Contact the BMW Technical Support Group via TSARA
Warranty inquiries	Submit an IDS ticket to the Warranty Department
Parts inquiries	Submit an IDS ticket to the Motorrad Parts Department

### Supporting Materials

[picture\\_as\\_pdf 11 02 24 Service Action - Replace oil sump control piston.pdf](#)

[picture\\_as\\_pdf RM\\_0060444\\_0M21\\_EN \(2\).pdf](#)



# 0M21 - R 1300 GS

## 00 60 444 Replace control piston

### 1

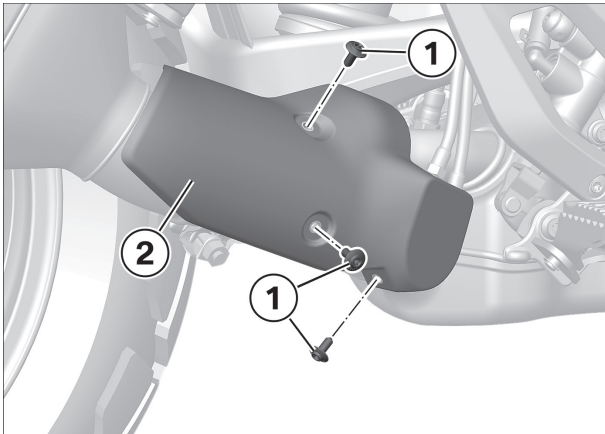

#### ► Removing silencer cover

- Remove screws (1).
- Remove silencer cover (2).



### 2

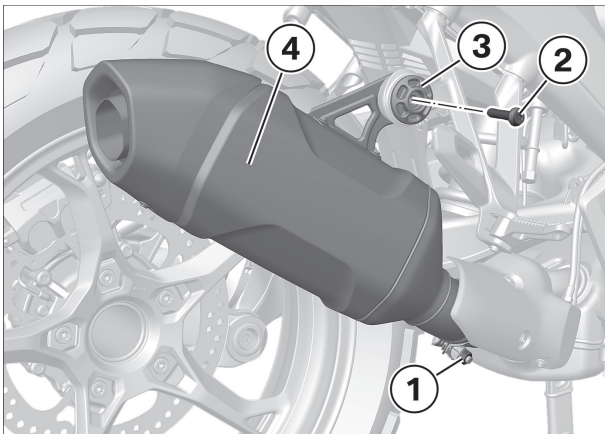

#### ► Removing silencer

- Slacken clamp (1).
- Remove screw (2) and shaped washer (3).
- Remove silencer (4).

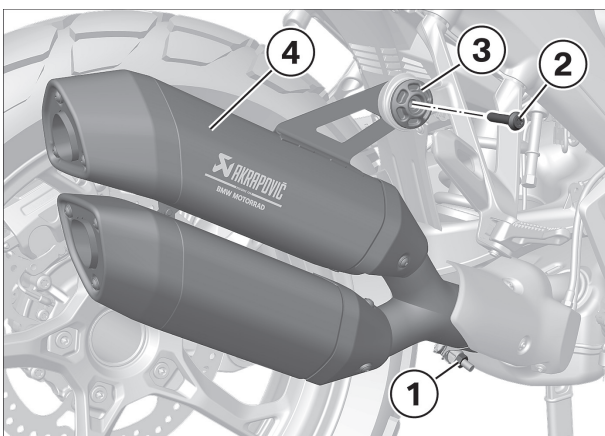

– with double silencer<sup>OE</sup> ()

- Slacken clamp (1).
- Remove screw (2) and shaped washer (3).
- Remove silencer (4).◇



**3**

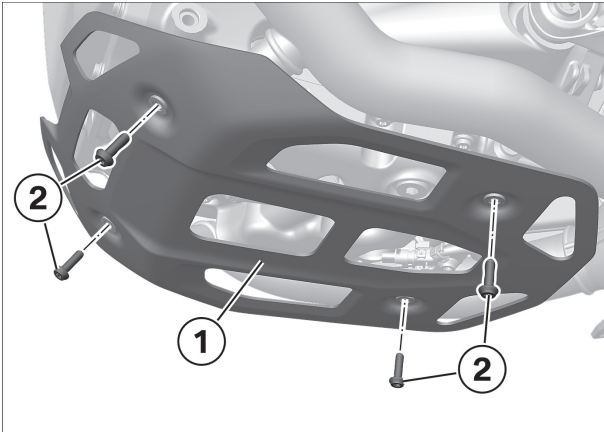

► **Removing engine guard**

- Remove screws **(2)** and take off engine guard **(1)**.

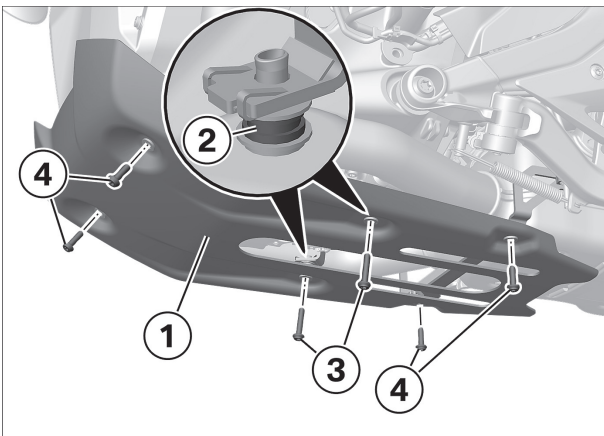

– with enduro package Pro<sup>OE</sup> (024A)

- Remove screws **(3)** and **(4)**.
- Take off engine guard **(1)** and bushes **(2)**.◇

**4**

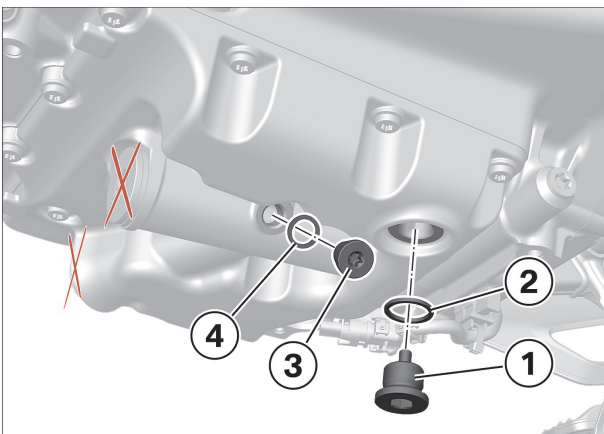

► **Draining engine oil**

- Remove the oil drain plug for the oil tank **(1)** and drain the oil.
- Remove sealing ring **(2)**.
- Remove the oil drain plug for the dry sump **(3)** and drain the oil.
- Remove sealing ring **(4)**.

5

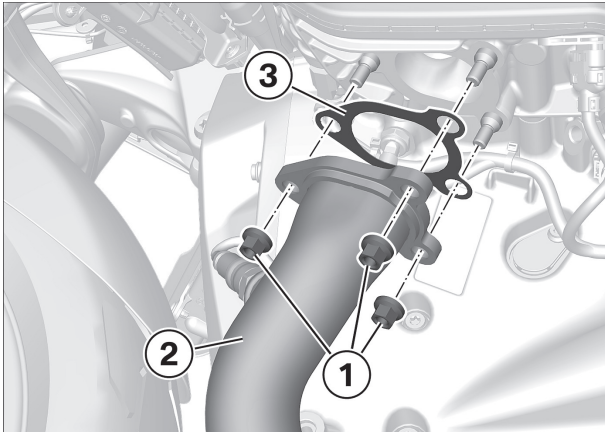

► Releasing exhaust manifold

**ATTENTION**

**Hard or sharp-edged components**  
Scratches and damage to paintwork

• Use a suitable soft cover or mask off the areas at risk.

- Remove the nuts **(1)** on the right and left.
  - Support exhaust manifold to prevent tilting.
- Loosen the exhaust manifold **(2)** and pull it down slightly.
- Remove seals **(3)**.

6

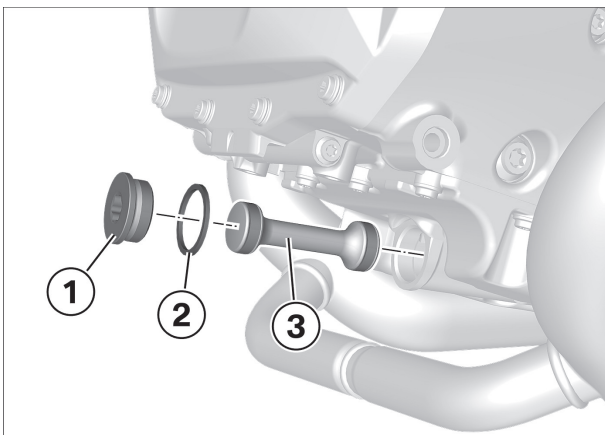

► Removing the control piston

- Remove screw **(1)**.
- Remove sealing ring **(2)**.
- Use a magnet to remove the control piston **(3)**.

7

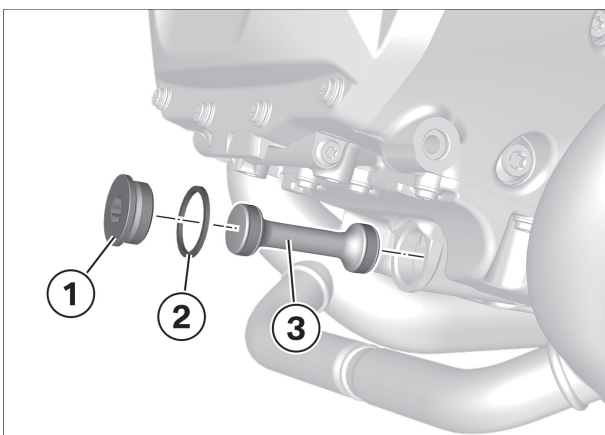

► Installing the control piston

- Clean the control piston channel with brake cleaner and remove all residual particles.

 <b>Cleaner</b>	
Brake cleaner	83 19 2 154 780

- Clean the threads
- Install a **new** control piston **(3)**.
- Use a **new** sealing ring **(2)**.
- Insert a **new** screw **(1)**.

 <b>Tightening torques</b>		
<b>Screw plug (control piston) in oil sump</b>		
M28 x 1.5, Renew screw Thread-locking compound (micro-encapsulated)	45 Nm	

**8**

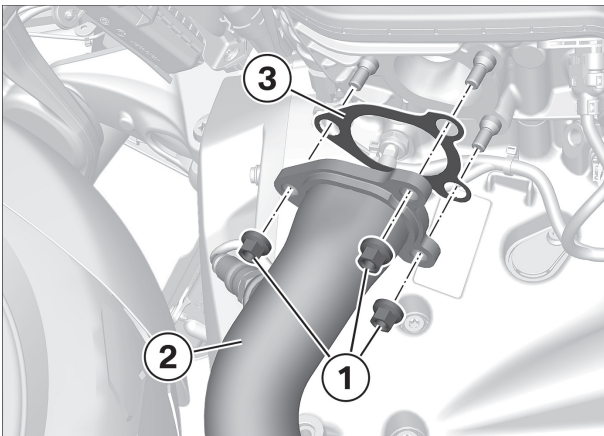

► **Securing exhaust header**

- Position **new** seals (3) on exhaust manifold (2).
- Position exhaust manifold (2).
- Install **new** nuts (1).

 <b>Tightening torques</b>		
<b>Manifold to cylinder head</b>		
M8, Replace nuts	21 Nm	

– Install nuts on right side the same way.

**9**

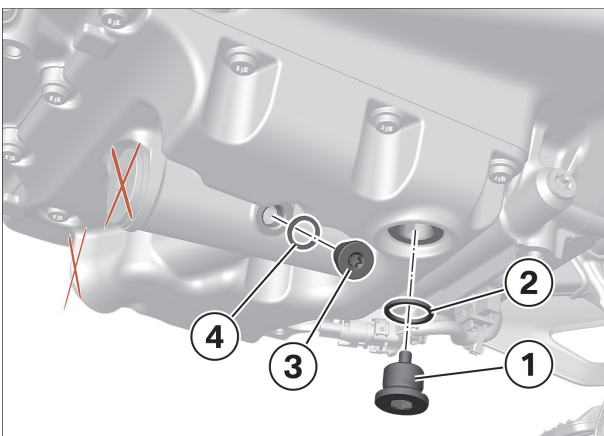

► **Pouring engine oil into engine**

- Install the oil drain plug for the oil tank (1) with a **new** sealing ring (2).

 <b>Tightening torques</b>		
<b>Oil drain plug for oil tank at oil sump</b>		
M16 x 1.5	28 Nm	

- Install the oil drain plug for the dry sump (3) with a **new** sealing ring (4).

 <b>Tightening torques</b>		
<b>Oil drain plug for dry sump at oil sump</b>		
M10 x 1	10 Nm	

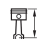

- Prepare the correct total quantity of engine oil.

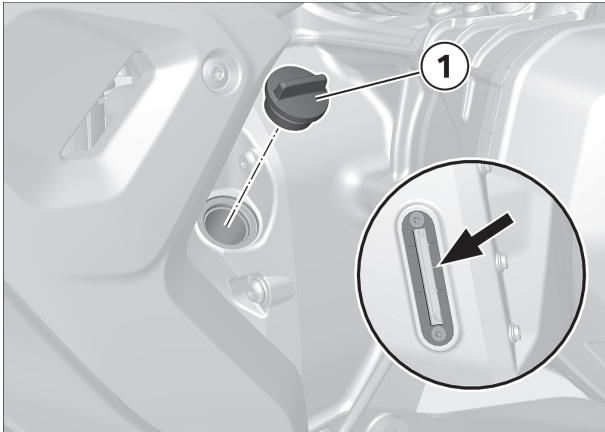
 <b>Technical data</b>			
Engine oil, capacity	with filter change	approx. 5 l	
	Viscosity class		



- Remove oil filler plug **(1)**.
- Pour the engine oil into the engine.
- Install oil filler plug **(1)**.

- Allow the engine to warm up until the fan starts.
- Turn off motor cycle on related reason.
- Wait for one minute to allow oil to collect in oil sump.
- Check engine oil level **with motorcycle standing on wheels** and correct, if necessary.

 <b>Technical data</b>			
Engine oil, specified level 			
		Between <b>MIN</b> and <b>MAX</b> mark	
Engine oil, quantity for topping up	Difference between <b>MIN</b> and <b>MAX</b>	max. 0.75 l	

– Motorcycle must not stand on centre stand!

 <b>Engine oil</b>	
Product recommended by BMW Motorrad: ADVANTEC Ultimate oil, SAE 5W-40, API SL / JASO MA2	83 12 2 405 887



10

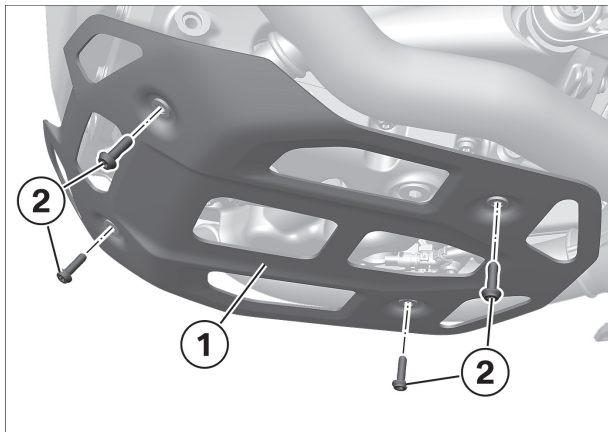

► **Installing engine guard**

- Position engine guard **(1)**.
- Install screws **(2)**.

🔧 <b>Tightening torques</b>		
<b>Engine guard to bracket</b>		
M6 x 20	8 Nm	
front/rear, M6 x 20	8 Nm	– with enduro package Pro <sup>OE</sup> (024A)
centre, M6 x 30	8 Nm	– with enduro package Pro <sup>OE</sup> (024A)

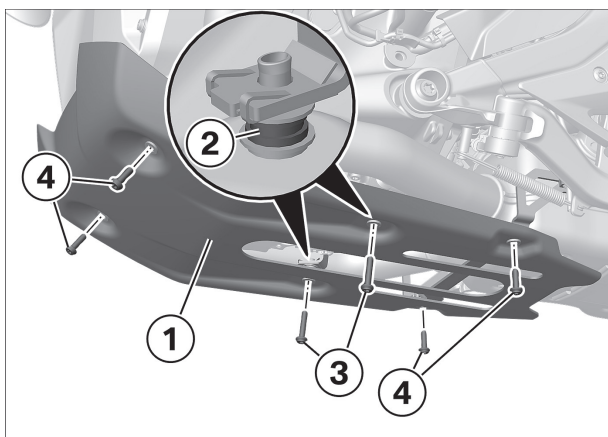

- with enduro package Pro<sup>OE</sup> (024A)
- Position engine guard **(1)** with bushes **(2)**.
- Bushes **(2)** only installed in centre (with long screws).
- Install screws **(3)** and **(4)**.

🔧 <b>Tightening torques</b>		
<b>Engine guard to bracket</b>		
M6 x 20	8 Nm	
front/rear, M6 x 20	8 Nm	– with enduro package Pro <sup>OE</sup> (024A)
centre, M6 x 30	8 Nm	– with enduro package Pro <sup>OE</sup> (024A)

11

► **Installing silencer**

**NOTICE**

The exhaust clamps must be installed lubricated to ensure the tightness of the exhaust system. Specifically, the area of the joint must be lubricated.

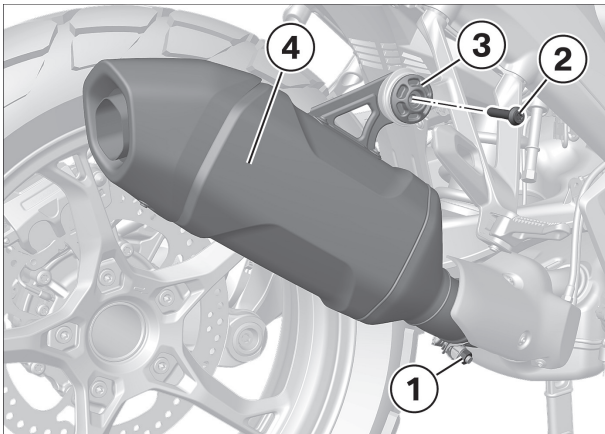

- Renew clamp (1) and lightly lubricate inside.

Lubricant	
Optimoly TA	18 21 9 062 599

- Slide the clamp (1) onto the silencer (4).
- Push silencer (4) to limit position.
- Install shaped washer (3) and screw (2).

Tightening torques		
Silencer to bracket		
M8 x 35	19 Nm	

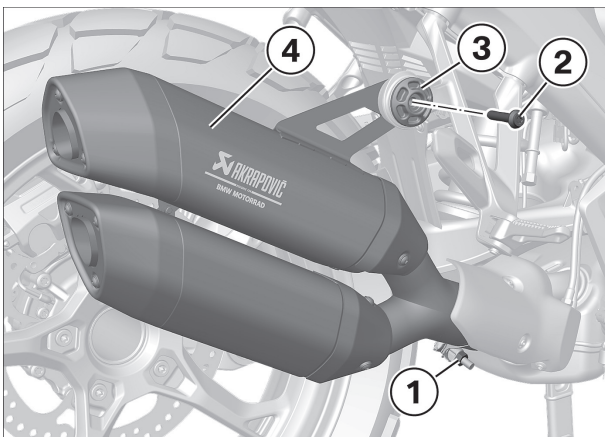

– with double silencer<sup>OE</sup> ()

- Renew clamp and lightly lubricate the inner face.

Lubricant	
Optimoly TA	18 21 9 062 599

- Slide the clamp (1) onto the silencer (4).
- Push silencer (4) to limit position.
- Install shaped washer (3) and screw (2).

Tightening torques		
Silencer to bracket		
M8 x 35	19 Nm	

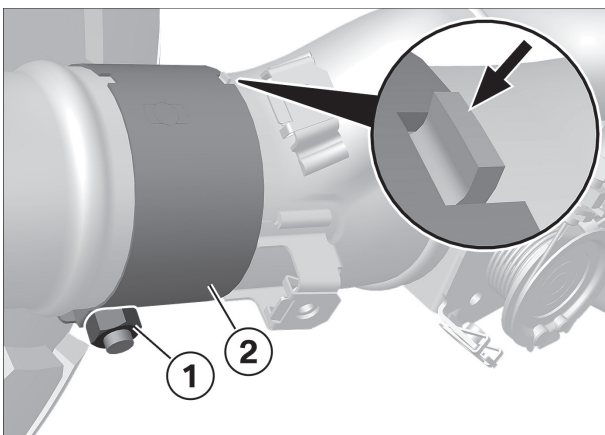

- Position clamp (2) with recess in lug (arrow).
- Tighten nut (1).

Tightening torques		
Clamp to silencer and exhaust manifold		
Renewing clamp	22 Nm	
Lubricating the inside of the clamp, Lubricant (Optimoly TA)		

12

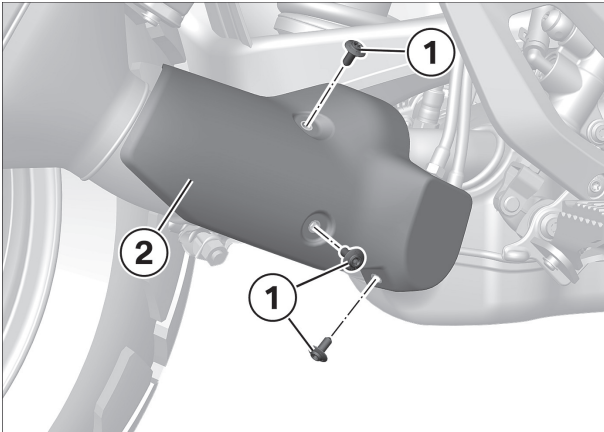

► **Install the silencer cover**

- Position silencer cover (2).
- Install screws (1).

13

► **Final inspection of completed work**

- Ensure the following:
  - The objective of the completed work was achieved.
  - All operating fluids have been filled in and the fluids are at the correct fill level.
  - All loosened screw connections have been retightened correctly.
  - The fuel system is free of leaks.
  - The lighting and signal system is functional and the vehicle is roadworthy.
  - The brake pads of the front and rear wheel brakes are resting against the brake disks.

▷ **Function test, engine start suppression**

**Check**

- Set kill switch to centred position.
- Select neutral.
- Switch on the ignition.
  - » Neutral indicator light "N" lights up.
- Select a gear.
  - » Neutral indicator light "N" goes out.
- Press the starter button.
  - » Starter does **not** operate.
- Extend the side stand.
- Pull the clutch lever.
- Press the starter button.
  - » Starter does **not** operate.
- Retract the side stand.
- Press the starter button without releasing the clutch lever.
  - » Starter operates.

**Result**

Not all test steps completed successfully.

**Measure**

- Check corresponding components with BMW Motorrad diagnosis system.

