

Head Unit Software Update Version 2170 (Panasonic)

Service Category Audio/Visual/Telematics

Section Audio/Video

Market USA

Toyota Supports ASE Certification 

Applicability

YEAR(S)	MODEL(S)	ADDITIONAL INFORMATION
2023 - 2024	Sequoia HV	
2022 - 2024	Tundra, Tundra HV	

REVISION NOTICE

June 12, 2024 Rev1:

- The Introduction, Software Update Information, and Software Update Procedures sections have been updated.

Any previous printed versions of this bulletin should be discarded.

SUPERSESSON NOTICE

The information contained in this bulletin supersedes Service Bulletins No. T-SB-0023-22 and T-SB-0010-23.

- The Introduction, Software Update Information, and Software Update Procedures sections have been updated.

Service Bulletins No. T-SB-0023-22 and T-SB-0010-23 are obsolete, and any printed versions should be discarded.

Head Unit Software Update Version 2170 (Panasonic)

Introduction

A head unit software update is now available for 2022 model year Tundra and Tundra Hybrid vehicles equipped with Toyota Multimedia (version 1020 or earlier). This software update provides improved performance and capability for the following:

- User Profile configuration and display.
- Cloud Navigation and Intelligent Voice Assistant.
- Mobile device connectivity.
- On-screen display and system settings/configuration.
- Security enhancements.

A head unit software update is now available for 2022 model year Tundra and Tundra Hybrid vehicles equipped with Toyota Multimedia (earlier than version 1040). This software update includes the following improvements:

- Cloud navigation.
- Intelligent assistant voice recognition.
- Showing and controlling explicit audio content.
- User interface.
- Bluetooth®.
- Bug fixes.

This software update removes the following feature:

- Hybrid radio.

A head unit software update is now available for 2023 model year Sequoia Hybrid, Tundra, and Tundra Hybrid, vehicles equipped with Toyota Multimedia (version 1040 or earlier). This software update provides improved performance and capability for the following:

- User Profile.
- Over-the-air (OTA) notifications.
- Ability to search during a call.
- Bug fixes settings/configuration.
- Security enhancements.

A head unit software update is now available for 2023 – 2024 Sequoia Hybrid, and 2022 – 2024 model year Tundra and Tundra Hybrid vehicles equipped with Toyota Multimedia (earlier than version 2050). This software update includes the following improvements:

- User interface design.
- Intelligent assistant.
- Navigation lane guidance.
- Phone book search.
- Bug fixes.

Head Unit Software Update Version 2170 (Panasonic)

Introduction (continued)

A head unit software update is now available for 2023 – 2024 Sequoia Hybrid, and 2022 – 2024 model year Tundra and Tundra Hybrid vehicles equipped with Toyota Multimedia (earlier than version 2170). This software update includes the following improvements:

- User Profile.
- User interface.
- Cloud navigation.
- Intelligent assistant voice recognition.
- Bug fixes.

Vehicle operators can perform this update directly by accepting the on-screen notification (see Figure 1), advising the software update is available, or by locating the software update from the Settings menu and initiating the available update (see Figure 2). The release notes text below will be displayed to the customer:

“This software update includes improvements for User Profile, Cloud Navigation, User Interface, Intelligent Assistant Voice Recognition, and bug fixes.”

Figure 1.

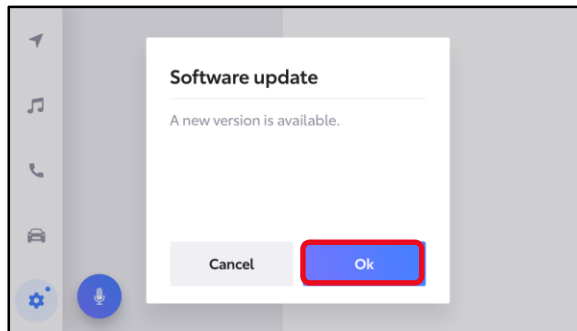
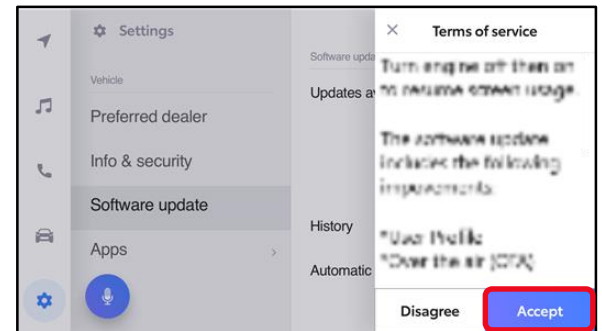

Figure 2.



If it is necessary to perform the software update for a customer, follow the software update procedures in this bulletin.

This is a phased rollout, which means that as time progresses, more vehicles will receive the update notification and ability to update the head unit. This timing will vary by location and may not display for every vehicle in one location at the same day/time.

Warranty Information

OP CODE	DESCRIPTION	TIME	OFP	T1	T2
N/A	Not Applicable to Warranty	—	—	—	—

Head Unit Software Update Version 2170 (Panasonic)

Software Update Information

The following conditions and performance improvements for Toyota Multimedia are addressed with this head unit software update for versions 1020 or earlier:

- Abnormal Apple CarPlay® operation when multiple phones are connected via Bluetooth®.
- Unable to switch users when not in Park, the button is not grayed out.
- Abnormal color palette operation when using illumination customization.
- The contact phone number is not displayed when using voice recognition.
- Error banner missing or abnormal operation.
- Audio mode will change when searching for genres in Sirius XM® with voice recognition.
- Unable to change volume using voice recognition.
- Inconsistent climate control adjustments when using voice recognition.
- Intermittent black or white screen after shifting out of Reverse or while driving.
- When using voice recognition to send a text message, the message is sent to a different number.
- Date labels do not align with the bar graphs in the trip information screen.
- Multiple degree “°” symbols displayed in the voice recognition screen.
- Unable to perform a system reset while listening to USB audio.
- “Profile not loaded” popup is shown through the startup animation.
- Intermittent rebooting.
- Abnormal operation when switching audio modes.
- Vehicle screen appears when requesting seat heater screen via voice recognition.
- Intermittent startup animation flickering.
- Poor appearance of the keyboard settings screen.
- Wi-Fi connection history is intermittently not retained.
- Wake word setting intermittently changes from OFF to ON.
- Multi-information Display (MID) incorrectly displays volume or mute changes.
- Intermittent Spanish text is displayed when the selected language is French, or vice versa.
- Abnormal USB audio playback when using voice recognition.
- Intermittent daytime display after IG-OFF.
- Two favorites added when one channel is selected.
- Some items are displayed in English instead of the system-selected language (other than English).
- The projection icon is displayed next to the phone not actively connected to projection mode.

Head Unit Software Update Version 2170 (Panasonic)

Software Update Information (continued)

- Voice recognition in Amazon Music™ is not consistent with other audio modes.
- When switching modes to Bluetooth® with no media files present an abnormal screen is displayed.
- Daylight savings time intermittently turns OFF.
- When switching audio mode to USB audio, the MID does NOT show USB text.
- Unable to start Remote Park while phone is connected to wireless CarPlay®.
- Display screen black.
- Display screen flickers.
- Display screen freezes.
- Display screen white after selecting USB music from phone screen.
- Head unit reboots.
- PIN prompt will not appear.
- User Profile inoperative.
- “Use for CarPlay®” toggle freezes.
- Apple CarPlay® connectivity performance.
- Apple CarPlay® projection screen does not appear after selecting “continue” on the phone.
- Apple Music® Home/For You screen 4th tile is non-responsive.
- Unable to switch to audio screen after ending Apple CarPlay® phone call.
- Volume does not adjust during Siri functions.
- Android Auto™ connectivity performance.
- Contact photo does not show.
- Contact sync error with 5000+ contact address book.
- Last message not read.
- No confirmation after selecting “yes” to send a text message.

The following conditions and performance improvements for Toyota Multimedia are addressed with this head unit software update for versions earlier than 1040:

- Phone number not displayed after text message is sent.
- Profile image not displayed.
- Automatic device connection fails.
- Bluetooth® connectivity performance.
- The display screen shows phone call ongoing after it has ended on the phone.
- Two Bluetooth® phone calls active at once.

Head Unit Software Update Version 2170 (Panasonic)

Software Update Information (continued)

- Combination meter does not show compass when Android Auto™ navigation is on.
- Combination meter does not show compass when Apple CarPlay® navigation is on.
- Date is incorrect when there is no GPS signal available.
- Incorrect navigation guidance is displayed.
- Map orientation resets.
- Map 2D/3D view resets.
- Map zoom level resets.
- Navigation announces crossing state borders incorrectly while driving.
- Navigation recalculation is stuck.
- Navigation route guidance is inoperative after remote engine start.
- Traffic flow not updating while zoomed out.
- Unable to launch navigation by tapping on icon.
- Voice recognition command improvements.
- Voice recognition inoperative during Sirius XM® playback.
- Voice recognition reply improvements.
- Remove hybrid radio messages.
- Saved radio stations will not display station names.
- Sirius XM® channel presets in non-Sirius XM® regions.
- Sirius XM® radio inoperative.
- Wi-Fi/DCM message appears in English instead of French (when French is selected).

The following conditions and performance improvements for Toyota Multimedia are addressed with this head unit software update for versions 1040 or earlier:

- User Profile.
- OTA notifications.
- Ability to search during a call.
- Bug fixes settings/configuration.
- Security enhancements.

The following conditions and performance improvements for Toyota Multimedia are addressed with this head unit software update for versions earlier than 2050:

- Apple CarPlay® freezes or reboots (this does not affect the backup camera).
- Navigation guidance in combination meter is missing during CarPlay.
- Combination meter keeps Apple CarPlay® navigation arrow after disconnection.
- Combination meter shows Apple CarPlay® call in progress even after it ends.

Head Unit Software Update Version 2170 (Panasonic)

Software Update Information (continued)

- Apple CarPlay® audio source does not resume after ACC cycle.
- Audio plays from device instead of vehicle during Apple CarPlay®.
- Apple CarPlay® audio plays instead of another last source.
- Unstable Apple CarPlay® call.
- Apple Music® Live Streaming Radio station descriptions incorrect.
- Explicit song playback is possible even if it is set to OFF in Apple Music®.
- Apple CarPlay® system enhancements and updates.
- Muted Android Auto™ call does not unmute.
- User Profile doesn't load using Android Bluetooth®.
- Android Auto™ disconnects after ending SOS call.
- Android Auto™ system enhancements and updates.
- Head unit reboots (this does not affect the backup camera).
- Load last saved User Profile.
- Passenger microphone inoperative.
- Assistant/microphone activates unintentionally.
- Assistant hint appears in Spanish or French instead of English (when English is selected).
- French voice command “What's my cruising range” displays in English (when French is selected).
- Virtual Assistant system enhancements and updates.
- Mode button does not mute Amazon Music™.
- Amazon Music™ does not resume after Microsoft Teams call.
- Navigation distance units do not reflect the selected units.
- Navigation system enhancements and updates.
- Steering wheel Push-To-Talk (PTT) button short press inoperative.
- Slow head unit response from steering pad switches.
- Bluetooth® connectivity performance.
- Parking Support Brake (PKSB) icon remains on screen (does not affect the backup camera).
- “Default Source” description not translated to French and Spanish (when selected).
- The “Audio Off” banner appears when adjusting ringtone setting while audio is off.
- HVAC menu does not go to the CLIMATE screen from the COMFORT screen.
- Sirius XM® Banner information is in English instead of Spanish (when Spanish is selected).
- Sirius XM® satellite radio system enhancements and updates.
- Destination assist system enhancements and updates.
- HMI enhancements and updates.

Head Unit Software Update Version 2170 (Panasonic)

Software Update Information (continued)

The following conditions and performance improvements for Toyota Multimedia are addressed with this head unit software update for versions earlier than 2170:

- Add Exit Apple CarPlay® HMI enhancement (a dynamic resize button that shows or hides the Toyota menu)
- Unable to connect to wired Apple CarPlay®.
- Unable to connect to wireless Apple CarPlay®.
- Combination meter compass and HUD compass freeze during Apple CarPlay®, Google Maps™ or Waze™.
- Combination meter does not show Apple CarPlay® navigation arrow guides.
- Apple CarPlay® screen closes when closing weather screen.
- Apple iPhone® to combination meter communication.
- Apple CarPlay® system enhancements and updates.
- Apple Music® error screen.
- Apple Music® create station inoperative.
- Text is cut off from Apple Music® screen.
- The previous screen is not retained when navigating through Apple Music®.
- Apple Music® artwork missing.
- Apple Music® user interface refresh ("Listen Now" instead of "For You").
- Apple Music® system enhancements and updates.
- Android Auto™ disconnects.
- Unable to end and accept phone call during Android Auto™ or Apple CarPlay® phone calls.
- Android Auto™ Call does not unmute.
- Message prompting to disconnect Android Auto™ is displayed during Wi-Fi set up even if Android Auto™ is already disconnected.
- Toyota App download link improvements.
- User Profile registration with numerical code instead of QR code.
- Black screen during destination assist call (does not affect backup camera display).
- Display screen blank (does not affect backup camera display).
- Display screen rebooting (does not affect backup camera display).
- Blank screen displayed after disconnecting Android Auto™ while making a Destination Assist call (does not affect backup camera display).
- Display screen flickers after responding to text message.
- Bluetooth® disconnects.
- Bluetooth® does not auto-connect.

Head Unit Software Update Version 2170 (Panasonic)

Software Update Information (continued)

- Bluetooth® system enhancements and updates.
- Incoming caller name stays on MID after call ends.
- No contacts shown in phonebook.
- Phonebook profile photos appear grainy.
- Phone call details are not displayed on the screen.
- Ringtone sound delayed or missing.
- Slow screen transition during handsfree call volume adjustment (does not affect backup camera display).
- Handsfree call system enhancements and updates.
- Compass always points north.
- Navigation system enhancements and updates.
- "Show my favorite contacts" voice command is inoperative.
- Virtual assistant HVAC related commands prompt "feature not available" message.
- Virtual assistant SMS message displays contact name incorrectly.
- Voice command system enhancements and updates.
- Removal of the "How can I help you" voice prompt.
- Virtual Assistant system enhancements and updates.
- Music streaming system enhancements and updates.
- Call banner stays on screen after SOS call has ended (does not affect backup camera display)
- Meter style setting descriptions not displayed.
- Song information is not displayed on the combination meter.
- HMI system enhancements and updates.
- Vehicle alert screen is covered by a vehicle image.
- Enhanced native navigation graphics and text.
- Gracenote database updates.
- Radio station categories are not translated to French or Spanish.
- Song love/like icon does not remain highlighted.
- Metadata for non-HD radio stations.
- OTA software update system enhancements and updates.
- Unable to perform OTA software update.
- Steering wheel switch advanced setting missing on models without winter gloves mode.
- Steering wheel switch customization improvements.
- Steering wheel switch volume adjustment not reflected on combination meter.
- Blank Sirius XM® satellite radio banner.

Head Unit Software Update Version 2170 (Panasonic)

Software Update Information (continued)

- Sirius XM® satellite radio TUNE banner stays on screen.
- Sirius XM® Satellite radio system enhancements and updates.
- Driver Support message improvements.
- Remote Park button not displayed on side of backup camera screen.
- HVAC blower motor minus button greyed out when blower is off (does not affect windshield defrost function).
- Rear HVAC control system enhancements and updates (does not affect windshield defrost function).
- Illumination settings menu enhancements and updates.
- The next charging schedule screen does not appear.
- Energy flow screen update.
- HDMI system enhancements and updates.
- Rear seat entertainment screen stays black.

The head unit (HU), virtual database (VD), and CAN (CA) update files may be accessed in the table below.

MODEL	MODEL YEAR	HEAD UNIT	TYPE	CALIBRATION ID
Sequoia HV	2023 – 2024	Entry	HU	rb_update_2024_SEQUOIA_NE_HU_D_02170.zip
			VD	rb_update_2024_SEQUOIA_NE_VD_D_02150.zip
		Premium	HU	rb_update_2024_SEQUOIA_NP_HU_D_02170.zip
			VD	rb_update_2024_SEQUOIA_NP_VD_D_02150.zip
Tundra, Tundra HV	2022	Entry	CA	rb_update_2022_TUNDRA_NE_CA_D_01040.zip
	2022 – 2024		HU	rb_update_2024_TUNDRA_NE_HU_D_02170.zip
			VD	rb_update_2024_TUNDRA_NE_VD_D_02150.zip
	2022	Premium	CA	rb_update_2022_TUNDRA_NP_CA_D_01040.zip
	2022 – 2024		HU	rb_update_2024_TUNDRA_NP_HU_D_02170.zip
			VD	rb_update_2024_TUNDRA_NP_VD_D_02150.zip

Head Unit Software Update Version 2170 (Panasonic)

Software Update Information (continued)

MULTIMEDIA SOFTWARE FILE DOWNLOAD

- The multimedia software update file may be downloaded directly from this Service Bulletin by clicking on the file name in the table above.
- Once downloaded, do NOT extract the files (unzip), the files need to be saved directly to a blank USB flash drive.
- Confirm there is no “(1)” or similar suffix on the file due to multiple downloads.
- Do NOT rename the file unless it is to remove “(1)” or similar.
- Multiple files can NOT be on the same USB flash drive; if there are two files on the USB flash drive beginning with “rb_update” the software installation will NOT begin.
- Use a blank USB flash drive from a trusted “name-brand” manufacturer with the following specifications:
 - Storage capacity: 4.0 – 32 GB.
 - USB flash drives larger than 32 GB that can be partitioned to smaller sizes will NOT work.
 - If a 32 GB USB flash drive is not working, try a smaller capacity USB flash drive.
 - Communication format: USB 2.0 or newer.
 - File format: FAT 32 (Windows®).
- USB-C vehicles will require a USB-C flash drive or adapter that is capable of transferring data (not just charging).

NOTE

The USB method should ONLY be used when the Wi-Fi/Cellular method of updating is unsuccessful.

NOTICE

- To prevent damaging the head unit, DO NOT put multiple files on the same USB flash drive at the same time.
- It is recommended to use one separate USB flash drive per file: For example, one for HU file, one for VD file (one for CA if applicable).

Head Unit Software Update Version 2170 (Panasonic)

Software Update Procedures

- [Wi-Fi Connection Procedure](#)12
- [OTA Update Procedure \(Wi-Fi and Cellular\)](#)14
- [USB Update Procedure](#).....19

Wi-Fi Connection Procedure

1. Turn ON the ignition.
2. Select the gear icon in the lower left corner of the radio screen.

Figure 3.

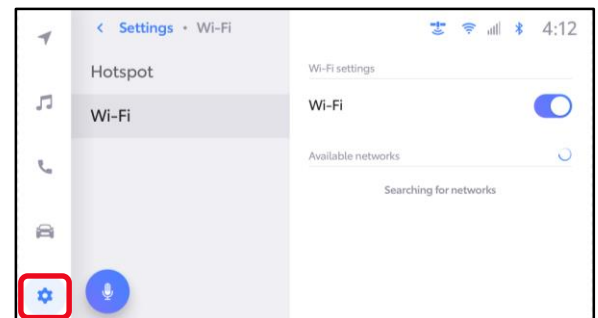

3. Select Data & Wi-Fi.

Figure 4.

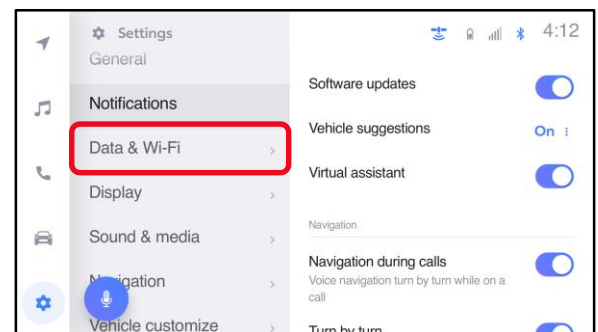

Head Unit Software Update Version 2170 (Panasonic)

Software Update Procedures (continued)

Wi-Fi Connection Procedure (continued)

4. Select Wi-Fi and turn the Wi-Fi toggle to ON.

HINT

- This step is used to connect the vehicle to an EXTERNAL Wi-Fi source.
- Wi-Fi connection is NOT required for updates that are delivered through DCM data.

Figure 5.

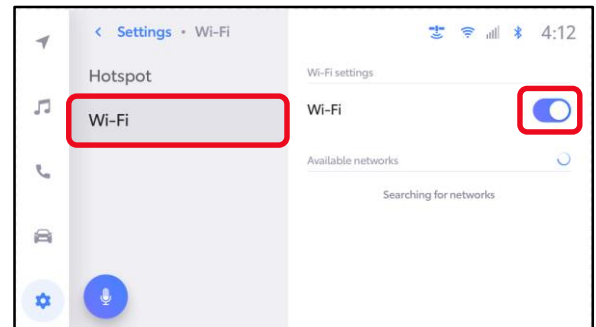

5. Select the Wi-Fi network desired to connect.

NOTE

It is NOT possible to connect to a Wi-Fi source that requires a username and password to be entered in a browser.

Figure 6.

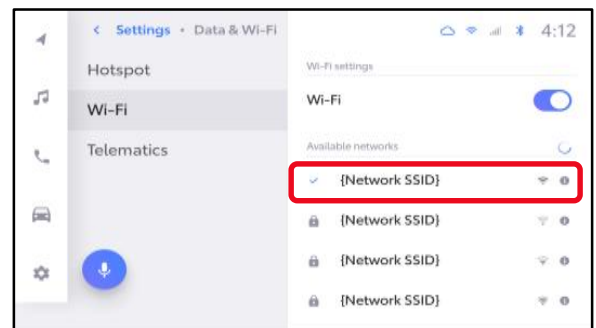

6. Follow the on-screen instructions. A message will appear confirming that the vehicle is successfully connected to the network.

Figure 7.

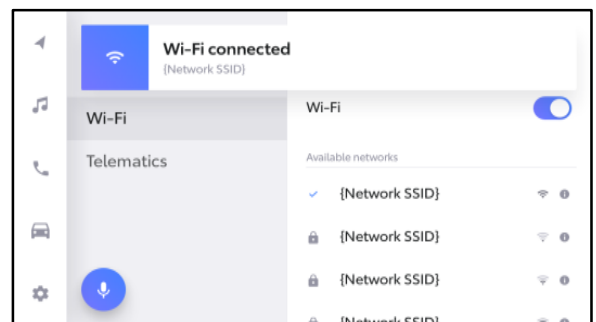

Head Unit Software Update Version 2170 (Panasonic)

Software Update Procedures (continued)

OTA Update Procedure (Wi-Fi and Cellular)

1. Select the gear icon, scroll down, and select Software update.

Figure 8.

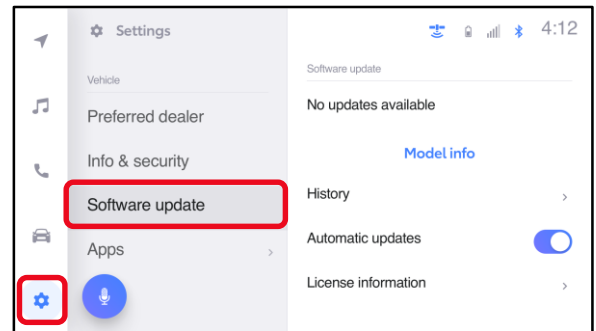

2. Are software updates available?
 - **YES** — Continue to step 3.
 - **NO** — This bulletin does NOT apply, continue diagnosis using the applicable Repair Manual.

Figure 9.

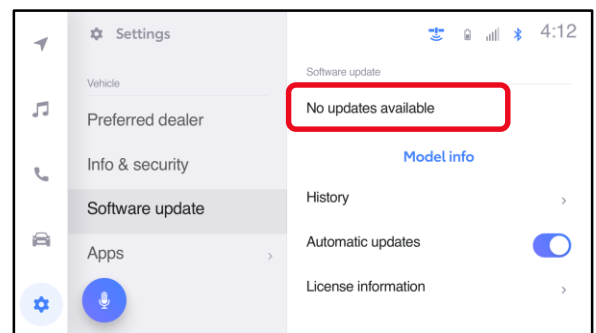
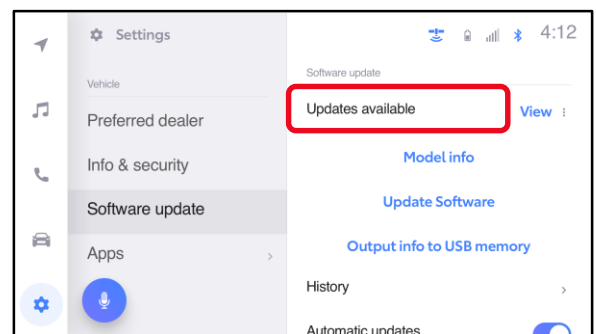

Figure 10.



Head Unit Software Update Version 2170 (Panasonic)

Software Update Procedures (continued)

OTA Update Procedure (Wi-Fi and Cellular) (continued)

3. Select Model info.

Figure 11.

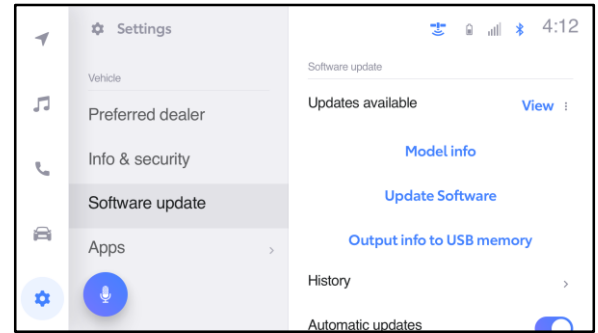

4. Is the software up to date?
(Refer to Table 1 below.)
- **YES** — This bulletin does NOT apply. Continue diagnosis using the applicable Repair Manual.
 - **NO** — Continue to step 5.

Figure 12.

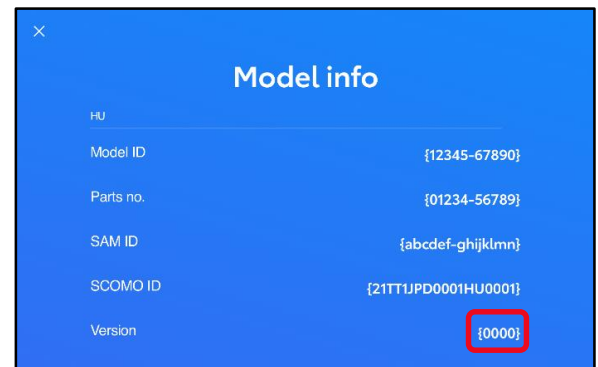
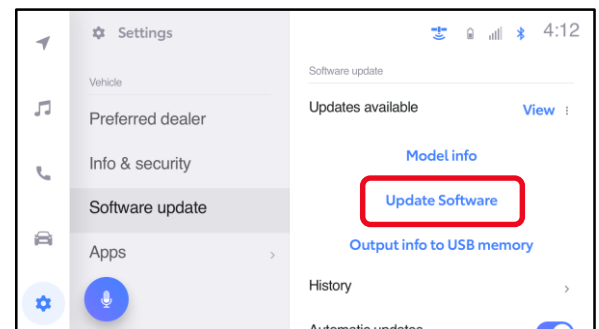

Table 1. Software Version Information

TYPE	PREVIOUS VERSION	CURRENT VERSION
HU Version	Earlier than 2170	2170
VD Version	Earlier than 2150	2150

5. Select Update Software.

Figure 13.



Head Unit Software Update Version 2170 (Panasonic)

Software Update Procedures (continued)

OTA Update Procedure (Wi-Fi and Cellular) (continued)

6. Select Accept on the Terms of service screen.

Figure 14.

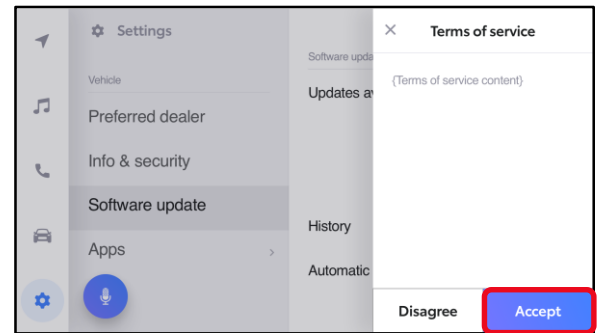

7. Wait for the update to download.

Figure 15.

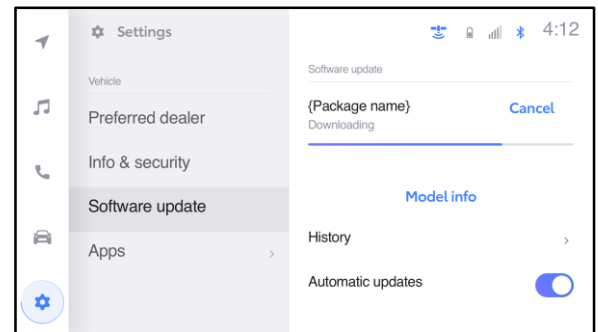

8. Select Accept on the Notice pop-up message if it appears.

Figure 16.

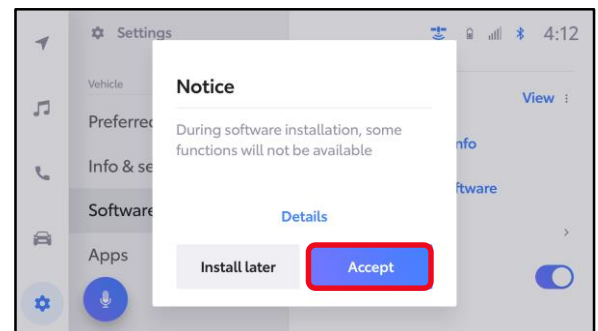

Head Unit Software Update Version 2170 (Panasonic)

Software Update Procedures (continued)

OTA Update Procedure (Wi-Fi and Cellular) (continued)

9. Wait for the update to download. Once the head unit begins installation, the update will take 10 minutes or less.

NOTE

- Do NOT turn OFF the engine or ACC BEFORE the software is ready for updating.
- Selecting Cancel will cancel the installation of the specific component, but it can be installed manually later.

Figure 17.

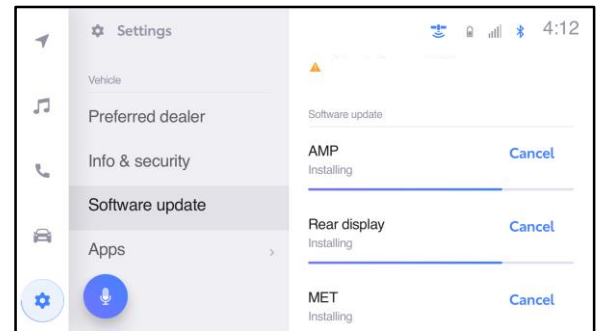

10. If a major update is being installed the message "Software update in progress" will be displayed.

NOTE

- Do NOT turn OFF the engine or ACC BEFORE the software has updated successfully.
- Selecting Cancel will cancel the installation of the specific component, but it can be installed manually later.

Figure 18.

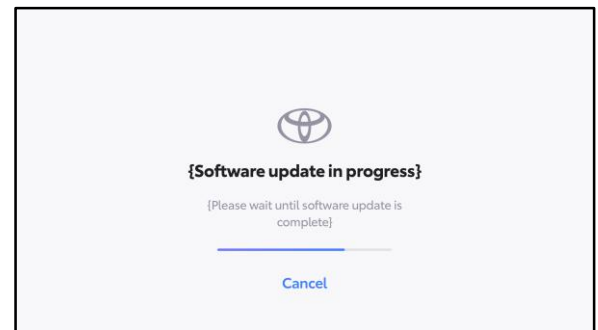

Head Unit Software Update Version 2170 (Panasonic)

Software Update Procedures (continued)

OTA Update Procedure (Wi-Fi and Cellular) (continued)

11. The software installation is complete when either a "Software installation complete" banner (Figure 19) or the "Software update complete" screen (Figure 20) is displayed.

NOTE

If the vehicle has installed a major update, and the "Software update complete" screen is displayed, then an IG-OFF/ON will need to be performed prior to attempting to operate any of the multimedia functions.

Figure 19.

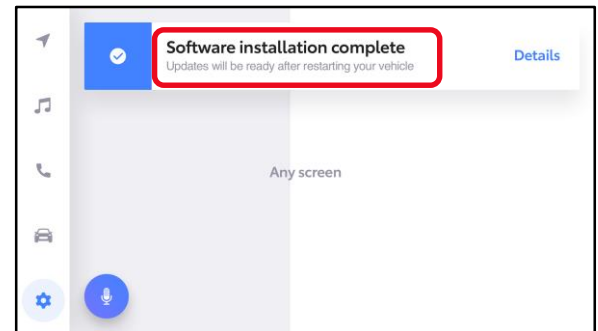
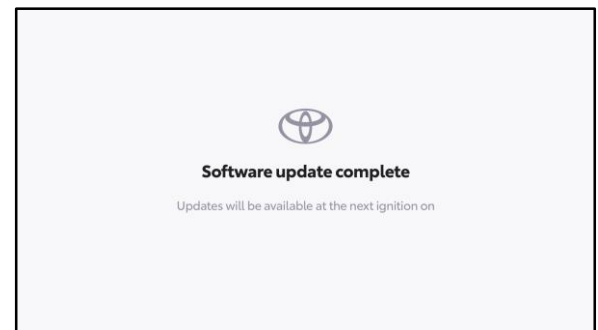

Figure 20.



12. If a restart is necessary, select Yes to restart the head unit.

NOTE

If No is selected or the vehicle is switched to IG-OFF, the installation will occur at the next IG-ON.

Figure 21.

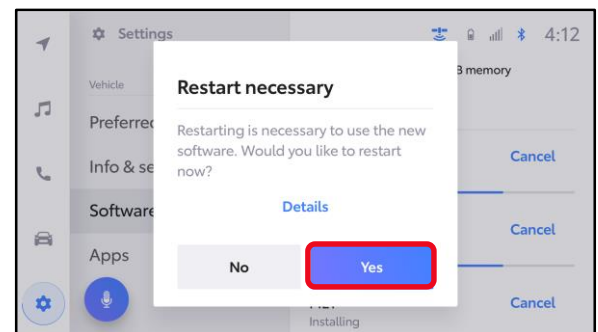

Head Unit Software Update Version 2170 (Panasonic)

Software Update Procedures (continued)

OTA Update Procedure (Wi-Fi and Cellular) (continued)

13. If after IG-OFF/ON a “Software could not be updated” banner appears, continue to the [USB Update Procedure](#) subsection.

Figure 22.

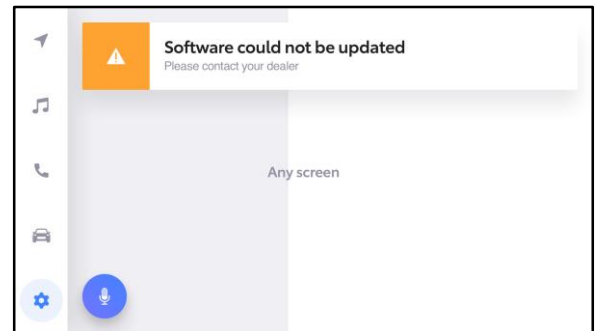

USB Update Procedure

1. Download the software from the Software Update Information section onto an empty USB flash drive.

NOTE

- The USB method should ONLY be used when the Wi-Fi/DCM method of updating is unsuccessful.
- Even for USB update, confirm one of the following signals is present for the head unit:
 - DCM (this function is NOT available in some countries or areas.)
 - Wi-Fi.

NOTICE

Possibility of damage to the components being repaired. This is a new procedure, different from previous multimedia software update bulletins. Please pay close attention to the following requirements as well as the notice on page 11 and 21.

2. Select the gear icon and scroll down to select Software update.

Figure 23.

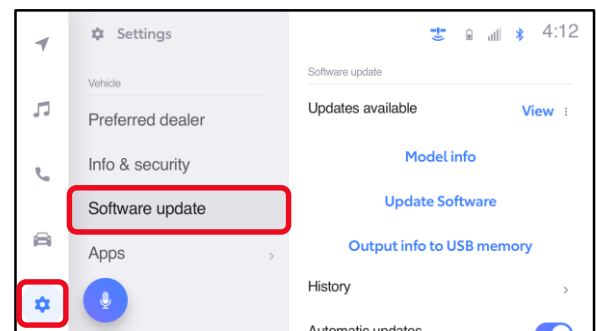

Head Unit Software Update Version 2170 (Panasonic)

Software Update Procedures (continued)

USB Update Procedure (continued)

3. Insert a prepared USB flash drive into the vehicle's data USB port. "Checking USB memory" message will display. Wait time can be up to 10 minutes.

NOTE

After inserting the USB flash drive, two banners may appear:

1. A blue "USB device connected" banner.
2. An orange "Device no response" banner. This is normal when there are no media files on the USB flash drive.

If the blue "USB device connected" banner does not appear, the USB flash drive may be formatted incorrectly or is inoperative.

Figure 24.

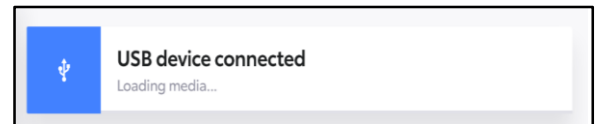
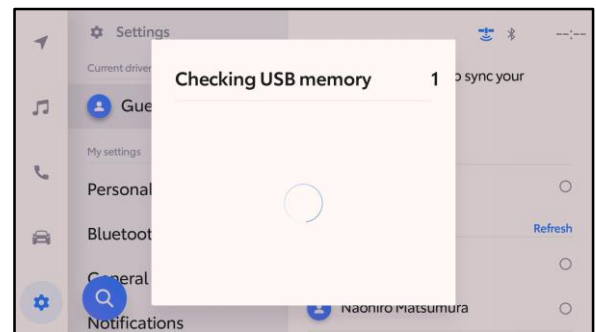

Figure 25.



For 2022 model year vehicles that have a CA version earlier than 1040, insert the USB flash drive with the CA file first. After CA is updated to 1040, repeat the USB update procedure to update the HU to 2170, then the VD to 2150.

For 2022 – 2024 model year vehicles that have CA version 1040 or later, insert the USB flash drive with the HU file first. After the HU is updated to 2170, repeat the USB update procedure to update the VD to 2150.

4. Select Continue when the message in Figure 26 appears.

Figure 26.

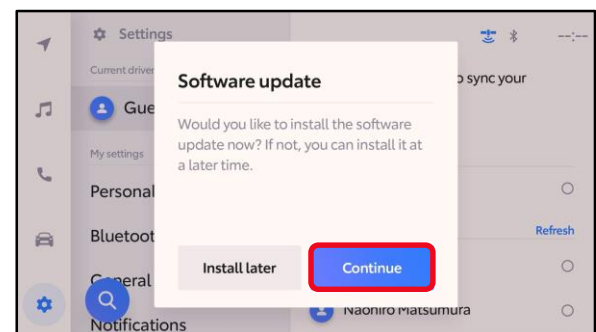

Head Unit Software Update Version 2170 (Panasonic)

Software Update Procedures (continued)

USB Update Procedure (continued)

5. Select Accept on the Terms of service screen.

Figure 27.

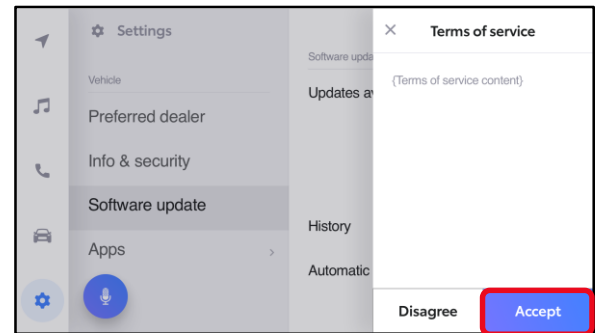

6. Wait for the update to download. Once the head unit software begins installation, the update will take up to 15 minutes per update file.

NOTICE

To prevent damaging the head unit, follow the four requirements below during this software update install step.

- Do NOT turn IG OFF.
- Do NOT turn ACC OFF.
- Do NOT press Cancel.
- Do NOT turn the head unit OFF.
- Do NOT remove the USB flash drive until instructed in step 9.

Figure 28.

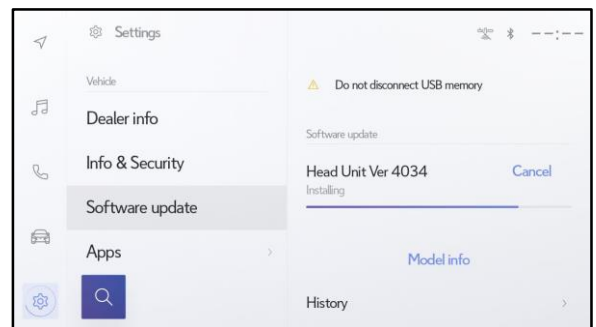

- A. When the update is complete, "Install Complete" will show on the head unit, as shown in Figure 29.

Figure 29.

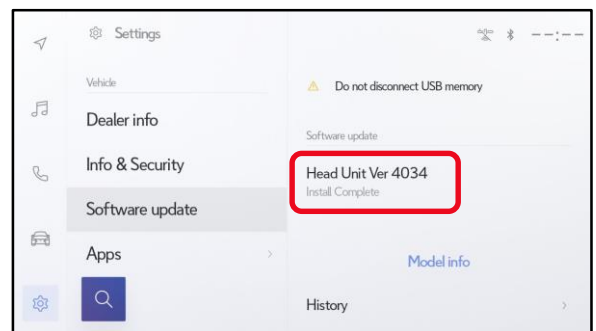

- B. The "Software installation complete" pop-up message may also appear, as shown in Figure 30.

Figure 30.

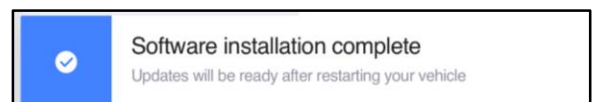

Head Unit Software Update Version 2170 (Panasonic)

Software Update Procedures (continued)

USB Update Procedure (continued)

7. Perform an ignition cycle.
8. Wait two minutes.
9. After the system has successfully booted up, remove the USB flash drive.
10. Perform steps 1 – 4 of [OTA Update Procedure \(Wi-Fi and Cellular\)](#) to verify the software version matches the table below.

Table 2. Software Version Information

TYPE	CURRENT VERSION
HU Version	2170
VD Version	2150
CA Version	1040 or later

NOTE

If you are prompted to upload a report as shown in Figure 31, insert a blank USB to remove the .JSON files. These files are NOT needed.

Figure 31.

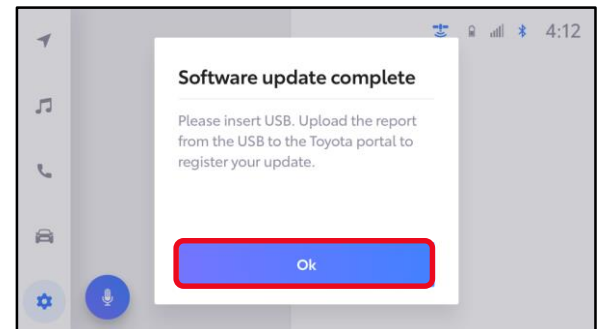

11. Perform steps 1 – 10 again for the remaining files as noted in step 3 of the [USB Update Procedure](#).