

Field campaign

Topic	Software update for the rear door control modules - 00BB and 00BC during PDI (SC23/24)
Market area	Australia E04 Bentley rest Asia and Australia (6E04),China 723 Volkswagen (Anhui) Automotive CO (6723),China 796 VW Import Comp. Ltd (Vico), Beijing (6796),Germany E02 Bentley rest Europe (6E02),Japan E03 Bentley Japan (6E03),Korea, (South) E08 Bentley South Korea (6E08),United Arab Emirates E06 Bentley Middle East and Africa (6E06),United Kingdom E01 Bentley UK (6E01),United States E05 Bentley USA and rest America (6E05)
Brand	Bentley
Transaction No.	2071260/24
Campaign number	EC89
Note	
Type	
US code	

Vehicle data

New Continental GT and New Continental GTC

Sales types

Type	MY	Brand	Designation	Engine code	Gearbox code	Final drive code
3S3*	2022	E		*	*	*
3S3*	2023	E		*	*	*
3S3*	2024	E		*	*	*
3S4*	2022	E		*	*	*
3S4*	2023	E		*	*	*
3S4*	2024	E		*	*	*

Chassis numbers

Manufacturer	Filler	Type	Filler	MY	Factory	From	To	Prod from	Prod to
SCB	*	*	*	N	C	096643	098461		
SCB	*	*	*	P	C	004980	012138		
SCB	*	*	*	R	C	012190	013506		
SCB	*	*	*	R	C	013892	016656		

Documents

Document name
master.xml
sc2324vinlistv290424.pdf

Notes



Technical background

Software update is available for the left and right hand rear door control modules - Diagnostic address 00BB Driver side and 00BC Passenger side

The software eliminates the rear window short drop function

Remedy

The instructions within the Work section must be conducted as detailed

Customer notification

Please ensure the instructions are conducted during the PDI process

Warranty accounting instructions

Warranty type 790

Damage service number EC89

Damage code 00 66

Criterion ID 01

Time to conduct the Software Version Management (SVM) update - Rear door control modules

Labour operation code 01 51 00 00

Time As per ODIS log Must not exceed 30 TU

Genuine parts

Not applicable

Parts supply

Not applicable

Parts despatch control

Not applicable

Repair instructions



Technical background

Software update is available for the left and right hand rear door control modules - Diagnostic address 00BB Driver side and 00BC Passenger side

The software eliminates the rear window short drop function

Check

If the vehicle is not already listed as repaired in "Repair history" (in Elsa pro), check for the presence of the blue paint completion mark as shown within the Identification section

If neither are evident please conduct the instructions within the Work section to completion

Genuine parts

Not applicable

Work

Software update to the rear door control modules 00BB and 00BC - Short drop function elimination



The following software update eliminates the rear window short drop function

- The closed-circuit voltage of the vehicle must be at least 12.5 V during the update. Connect a suitable battery charger to the vehicle. For further information refer to the Repair manual
- During the update switch off all unnecessary consumers (ventilation, seat heater, interior illumination etc) ensure the main light switch is set to 'off' and leave the driver's door open
- Because of the highest transmission stability you **MUST** use the diagnosis interface VAS 6154 (WiFi diagnostic tool) **ONLY** in USB operation or the cable-connected VAS 5055 for the reprogramming (updating) of control units. If these units are not available, the diagnosis interface VAS 5054 (A) can also be used in USB mode
- Do Not under any circumstances use a Bluetooth connection to conduct the reprogramming (updating) of any control units

1) Referring to Figure 1 - Within the Special functions tab - Select SVM - Code Input (Point A)

- Select Perform test (Point B)

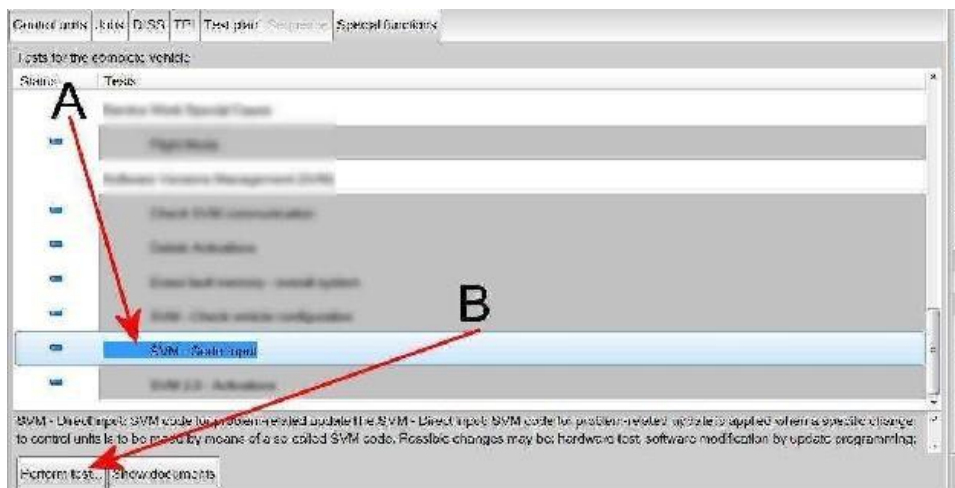

Figure 1

2) Referring to Figure 2 - Enter the SVM code 370WAD01

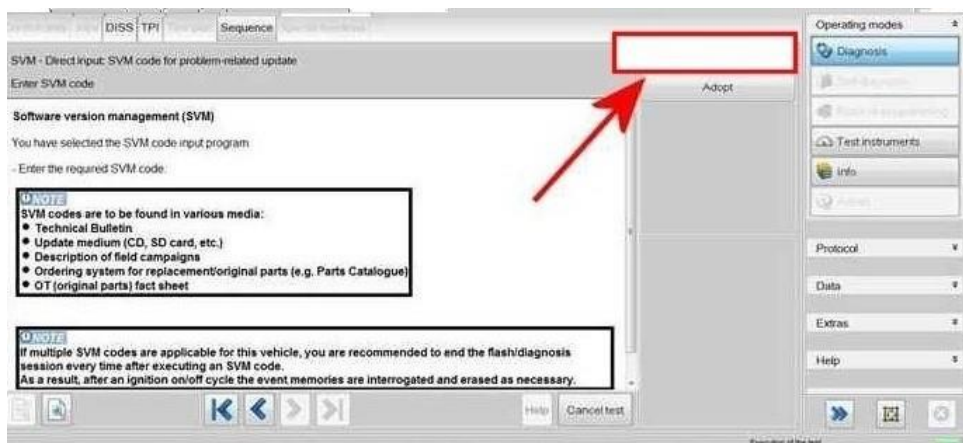

Figure 2

3) When prompted enter your global user ID and password

- Follow all on screen prompts to continue through the procedure, the identification data will be transferred

4) The control modules will automatically be updated one by one, starting with 00BB (Driver rear) and then 00BC (passenger rear)

5) On completion check the door control module versions against the Reference tables 3 and 4 (depending on Part number/Software version)

Reference table 3

Door control module	Part number	Software version	Target data container
00BB - Rear driver's door	4M1959955D	0189	V03935413CW
00BC - Rear passenger door	4M1959955D	0189	V03935413CX

Reference table 4

Door control module	Part number	Software version	Target data container
00BB - Rear driver's door	4M1959955J	0430	V03935405MS
00BC - Rear passenger door	4M1959955J	0430	V03935405MT

6) Switch off the ignition

- Remove the diagnostic interface from the OBD port
- Switch off and remove the battery charger from the vehicle
- Close the bonnet, boot and all doors
- Lock the vehicle
- Wait 5 minutes to allow the vehicle to go into bus silence
- When 5 minutes has elapsed, unlock the vehicle and open the driver's door
- Switch on the ignition

7) **VERY IMPORTANT** - Referring to Rep.Gr 64 - Side glass - To initialise

8) Referring to the Identification section - Apply a blue paint completion mark on the engine partition brace (Figure 3)

Identification

Blue paint completion mark on the engine partition brace



Figure 3