



GROUP	MODEL
BOD	2024MY Sorento (MQ4a)
NUMBER	DATE
328	May 2024

## TECHNICAL SERVICE BULLETIN

### SERVICE ACTION: FRONT DOOR HANDLE ANTENNA REPLACEMENT (SA575)

SUBJECT:

This bulletin provides information to replace both left and right front door outside handle antennas on certain 2024MY Sorento (MQ4a) vehicles produced from December 5, 2023 through February 12, 2024 equipped with capacitive touch/NFC type door handles. The affected vehicles may experience an inoperative capacitive touch handle caused by the antenna(s) not sensing the touch signal for locking/unlocking the door. Follow the procedure outlined in this publication to replace both left and right front door outside handle antennas on the applicable vehicle. Before conducting the procedure, verify that the vehicle is included in the list of affected VINs.

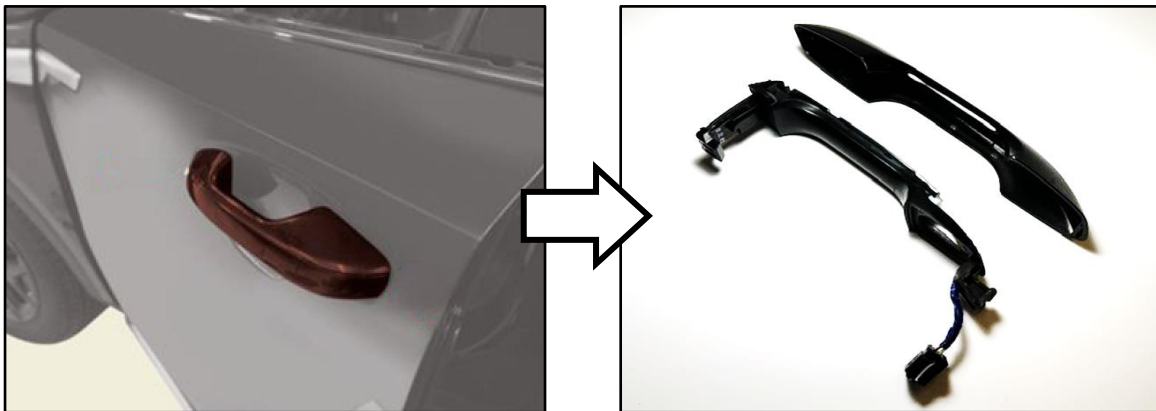

#### NOTICE

**A Service Action is a repair program without customer notification that is performed during the warranty period. Any dealer requesting to perform this repair outside the warranty period will require DPSM approval.**

Repair status for a VIN is provided on KDealer+ (Service → Warranty Coverage → Warranty Coverage Inquiry → Campaign Information). Not completed Recall / Service Action reports are available on KDealer+ (Consumer Affairs → Not Completed Recall → Recall VIN → Select Report), which includes a list of affected vehicles.

This issue number is SA575.

A printed copy is for reference only; publication information can be updated at any time. Always refer to KGIS for the latest information. After logging in kdealer.com, the newest technical publications are listed in 'Service Releases' and has the latest service information that has been released.

**Repair Procedure:**

1. Remove the Front Door Outside Handle (A) by referring to "Body (Interior and Exterior) → Door - Front → Front Door Outside Handle → Repair procedures" (**Steps 1 - 5 ONLY**) in the applicable Shop Manual on KGIS.

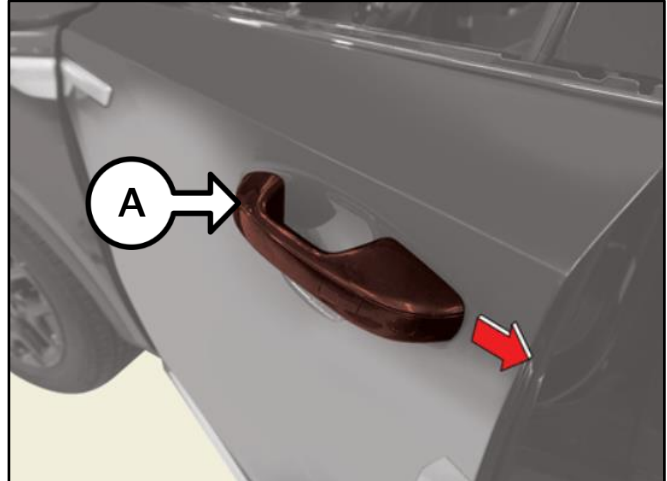

Tightening torque for bolt:  
5.8 - 8.7 lb.ft (7.8 - 11.8 N.m)

**TECH TIP**

Clip the door handle harness connector to the clip on the door handle pad to prevent the harness connector from dropping into the cavity between the door panel and door frame.



2. Using a Phillips screwdriver, loosen the door handle grip (B) screw.

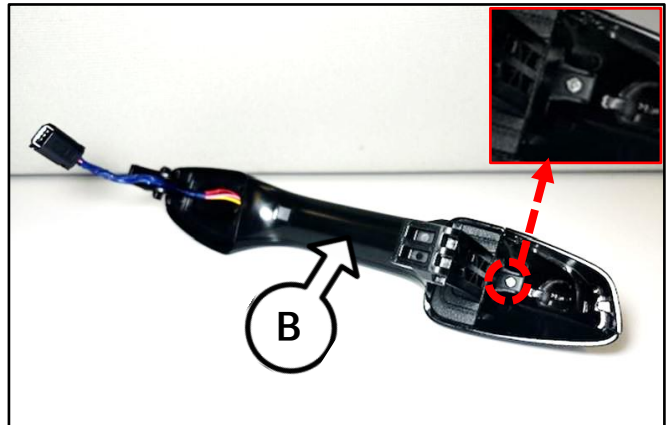

3. Detach the door handle grip (B) from the grip cover (C) by pulling the two pieces apart.

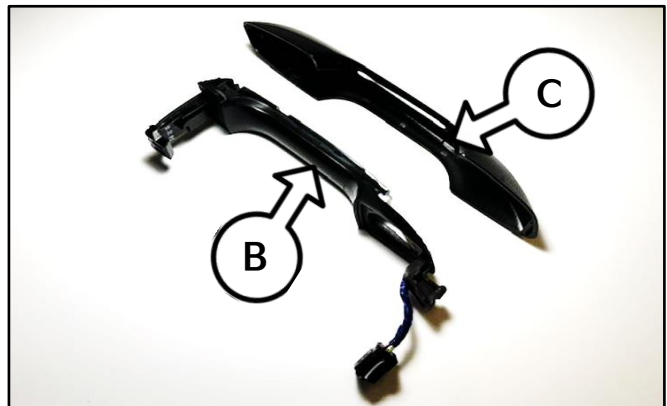

SUBJECT:

## FRONT DOOR HANDLE ANTENNA REPLACEMENT (SA575)

- 4a. To separate the antenna assembly (D) from the door handle grip (B), pull the two pieces apart.
- 4b. Install new antenna assembly (D).

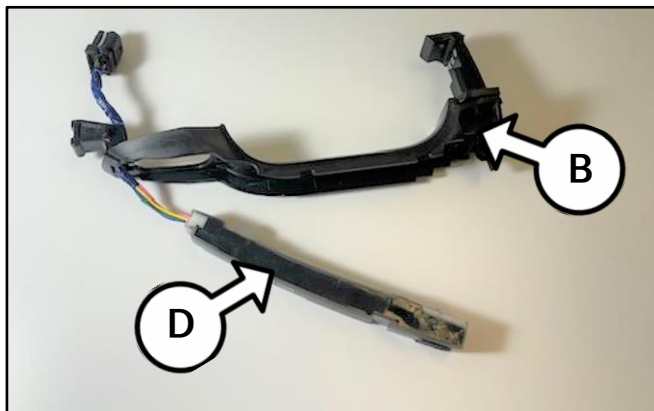
**TECH TIP**

Slide the antenna harness up to the untaped portion to remove/install the antenna, as shown.

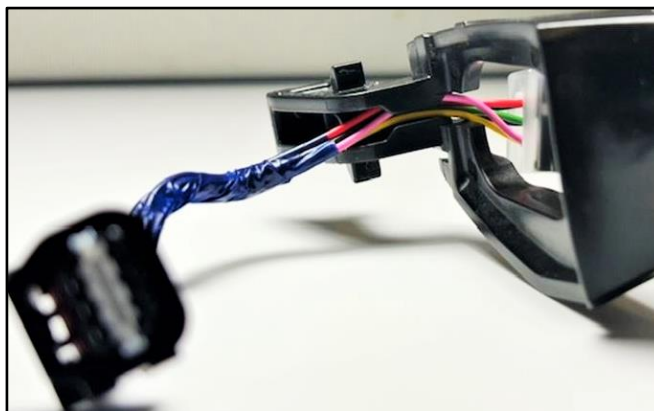

5. Reinstall all removed parts in reverse order of removal.
6. Repeat steps 1 - 5 for the opposite side.
7. Confirm normal operation.

SUBJECT:

**FRONT DOOR HANDLE ANTENNA REPLACEMENT (SA575)****AFFECTED VEHICLE RANGE:**

Model	Production Date Range
Sorento (MQ4a)	December 5, 2023 to February 12, 2024

**REQUIRED PART:**

Part Name	Part Number	Figure	Qty.
Front (LH) Antenna Assembly	82657 P2600QQK		1
Front (RH) Antenna Assembly	82667 P2600QQK		1

**Note:** The replacement part numbers will require a VIN entry for parts ordering. **DO NOT** order these parts for stocking purposes, related to this Campaign. Supply is very limited. Until supply stabilizes, please confirm part availability before scheduling customers. Please be sure to expedite warranty claim filing.

**WARRANTY INFORMATION:****N Code: N99 C Code: C99**

Claim Type	Causal P/N	Qty.	Repair Description	Labor Op Code	Op Time	Replacement P/N	Qty.
V	82651 P2720	0	(SA575) LH and RH Front Door Handle Antenna Replacement	240A10R1	0.4 M/H	82657 P2600QQK	1
						82667 P2600QQK	1

**NOTICE**

VIN inquiry data for this repair is provided for tracking purposes only. Kia retailers should reference **SA575** when accessing the KDealer+ system.