

2024 TX 350, TX 500h, and TX 550h+ Pre-Delivery Service (PDS)

Service Category General

Section Pre-Delivery Service

Market USA

Toyota Supports
ASE Certification 

Applicability

YEAR(S)	MODEL(S)	ADDITIONAL INFORMATION
2024	TX350, TX500H, TX550H+	

REVISION NOTICE

December 14, 2023 Rev1:

- Applicability has been updated to include 2024 model year TX 550h+ vehicles.
- The Introduction, Required Tools & Equipment, Tire Pressure Warning System (TPWS) Initialization, and Seating Position Control ECU Initialization sections have been updated.
- The Enable Hybrid Battery Thermal Keep Control Mode, Confirm Hybrid Battery Thermal Control Mode State, and Set Hybrid Battery Thermal Keep Control Mode sections have been added.

Any previous printed versions of this bulletin should be discarded.

2024 TX 350, TX 500h, and TX 550h+ Pre-Delivery Service (PDS)

Introduction

Pre-Delivery Service (PDS) is a critical step in satisfying our new car customers. Customer feedback indicates the following areas deserve special attention when performing PDS:

- Careful inspection for paint chips/scratches and body dents/dings.
- Proper operation of electrical accessories (including interior light, clock, and radio reset).
- Interior cleanliness.
- Proper function of mechanical systems.

Customer retention and proper maintenance of vehicles are, and have always been, a major focus for Lexus. To help remind customers that regular service is essential to the proper maintenance of the vehicle, dealers are required to input their dealer information and set the service reminder on the Navigation Screen before delivery. By doing this, customers will be reminded to return to your dealership for service. (See Page 2 of the TX 350/TX 500h/TX 550h+ PDS Check Sheet “Set Dealer and Service Reminder.”)

This bulletin contains the PDS procedures that apply specifically to the 2024 model year TX 350, TX 500h, and TX 550h+ vehicles. To properly perform a complete PDS, you must complete all procedures contained in this TSB as well as the TX350/500h/550h+ PDS [Check Sheet](#).

In addition, if the vehicle is stored for over 30 days, be sure to follow [Long-Term Vehicle Storage Guidelines](#).

2024 TX 350, TX 500h, and TX 550h+ Pre-Delivery Service (PDS)

Table of Contents

- [Warranty Information](#)..... 4
- [Required Tools & Equipment](#)..... 4
- [D/C Cut Fuse Installation](#) 5
- [Front License Plate and Mounting Bracket Installation*](#) 6
- [Power Back Door Initialization](#) 7
- [Tire Pressure Warning System \(TPWS\) Initialization](#)..... 7
- [Enable Hybrid Battery Thermal Keep Control Mode*](#) 8
 - [Confirm Hybrid Battery Thermal Control Mode State](#) 8
 - [Set Hybrid Battery Thermal Keep Control Mode](#) 9
- [Head Unit System Reset](#)..... 10
- [Navigation — Set Date & Time by GPS](#) 10
- [Seating Position Control ECU Initialization](#)..... 10
- [Customize ACC Function](#) 10

*If applicable.

2024 TX 350, TX 500h, and TX 550h+ Pre-Delivery Service (PDS)

Warranty Information

OP CODE	DESCRIPTION	TIME	OFF	T1	T2
N/A	Not Applicable to Warranty	-	-	-	-

Required Tools & Equipment

REQUIRED EQUIPMENT	SUPPLIER	PART NUMBER	QTY
Techstream ADVi*	ADE	TSADVUNIT	1
Techstream 2.0		TS2UNIT	
Techstream Lite		TSLITEPDLR01	
Techstream Lite (Green Cable)		TSLP2DLR01	

*Essential SST.

NOTE

- Only ONE of the Techstream units listed above is required.
- GTS+ software version 2023.04.003.02 or later is required.
- Additional Techstream units may be ordered by calling Approved Dealer Equipment (ADE) at 1-800-368-6787.

2024 TX 350, TX 500h, and TX 550h+ Pre-Delivery Service (PDS)

D/C Cut Fuse Installation

To minimize battery discharge during transportation and storage, the D/C cut fuse (20A) has been removed at the assembly plant and temporarily stored in the blank space of the relay block in the engine compartment. During PDS, reinstall the D/C cut fuse (20A) into its original location and clear ALL related Diagnostic Trouble Codes (DTCs).

Figure 1.

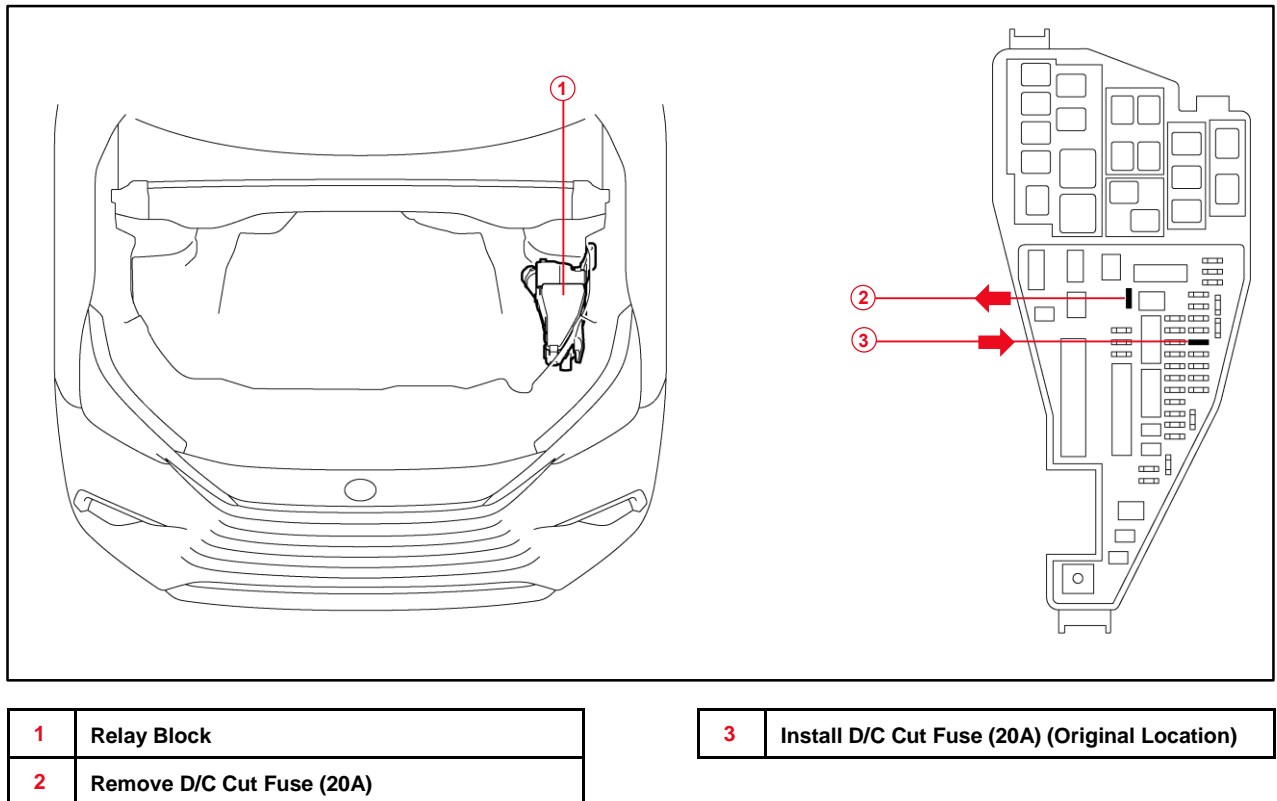

NOTE

- With the D/C cut fuse (20A) removed, if any DTCs are detected when the ignition is turned ON during transportation, use Global Techstream Software (GTS) to clear ALL DTCs AFTER ensuring that there are NO malfunctions.
- While the vehicle is stored at the dealership, disconnect the negative (-) battery terminal to prevent battery discharge. Refer to [L-SB-0016-23](#), *Battery Maintenance During PDS*, for battery maintenance information.

2024 TX 350, TX 500h, and TX 550h+ Pre-Delivery Service (PDS)

Front License Plate and Mounting Bracket Installation

The front license mounting plate bracket and two self-tapping screws are loaded in the vehicle at the assembly plant. Follow this procedure to install the front license plate mounting bracket and front license plate in states where it is required by law.

1. Temporarily install the front license plate mounting bracket to the front bumper so that the ribs and claws of the front license plate mounting bracket are in the indicated position.
2. Install the front license plate mounting bracket to the front bumper using two self-tapping screws.

NOTICE

Do NOT overtighten the self-tapping screws.

Figure 2.

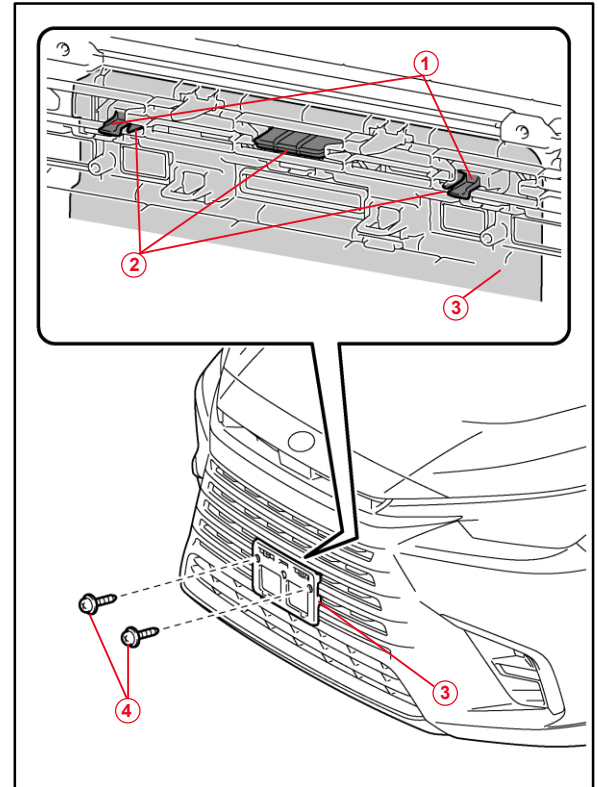

1	Claw
2	Rib
3	Mounting Bracket
4	Self-tapping Screws

2024 TX 350, TX 500h, and TX 550h+ Pre-Delivery Service (PDS)

Front License Plate and Mounting Bracket Installation (continued)

- Install the front license plate to the mounting bracket at holes “B” using two non-corroding bolts with the following dimensions:

Length: 15.0 mm (0.59 in.)

Diameter: 6.0 mm (0.24 in.)

Figure 3.

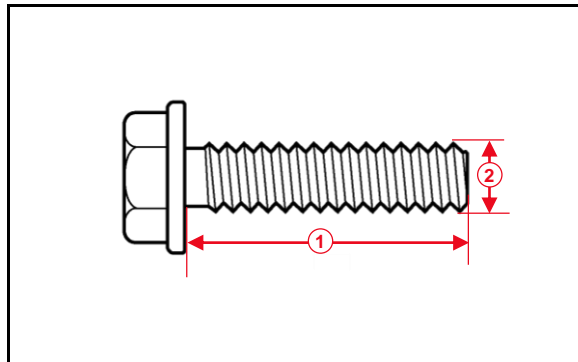

1	Length
2	Diameter

Figure 4.

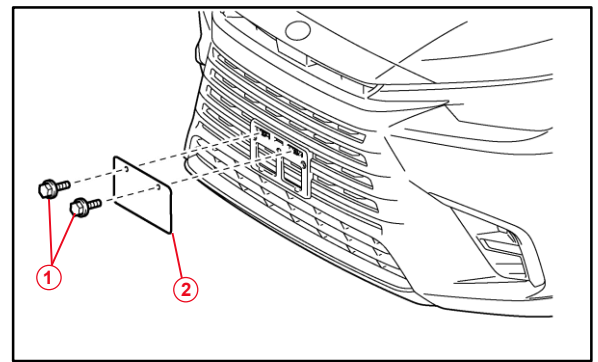

1	Bolts
2	Front License Plate

Power Back Door Initialization

As a result of the removal of the D/C cut fuse with the back door open, the “automatic open and close” function of the power back door will be inoperative due to loss of the back door position memory stored in the ECU. Refer to the applicable Repair Manual for the power back door [initialization procedure](#).

Tire Pressure Warning System (TPWS) Initialization

After adjusting all the tires to the correct air pressure, perform the initialization of the Tire Pressure Warning System. Refer to the applicable Repair Manual for the TPWS initialization procedure ([TX 350](#) / [TX 500h](#) / [TX 550h+](#)).

NOTE

To adjust the tire pressure correctly when the outside temperature is significantly colder than shop temperature, perform a Health Check using GTS+ and select the compensation tire pressure checkbox. Compensation pressures will display on the Health Check results screen. Adjust the tire pressure when the tires are cold.

2024 TX 350, TX 500h, and TX 550h+ Pre-Delivery Service (PDS)

Enable Hybrid Battery Thermal Keep Control Mode

The HV/BEV battery may be frozen in extremely cold areas. As a result, the HV/BEV battery may become excessively weak, and the system may NOT be able to be started. By enabling HV/BEV Battery Thermal Keep Control Mode, it is possible to warm the HV/BEV battery and maintain its current temperature in order to prevent it from becoming excessively weak.

When this mode is set to ON, the timer charging settings are canceled at temperatures of 14°F (-10°C) or lower. Charging will begin immediately when the charging cable is connected to the vehicle.

Table 1. HV/BEV Battery Thermal Keep Control Mode

PURPOSE	CONDITION	OPERATION
Prevent HV/BEV battery from freezing	<ul style="list-style-type: none"> Ambient temperature is 14°F (-10°C) or lower. 	<ul style="list-style-type: none"> Begins to warm the HV/BEV battery to maintain its current temperature when the ambient temperature drops to 14°F (-10°C) or lower when the charging cable is connected to the vehicle.
	<ul style="list-style-type: none"> Charging cable is connected to the vehicle. 	<ul style="list-style-type: none"> To prevent the HV/BEV battery from freezing when a charging start time is set, when the HV/BEV Battery Thermal Keep Mode is enabled, the charging timer will be disabled, and charging will begin immediately when the charging cable is connected to the vehicle.

To enable HV/BEV Battery Thermal Keep Control Mode, it is necessary to use GTS+ during PDS at the dealership.

Confirm Hybrid Battery Thermal Keep Control Mode State

1. Connect the Techstream to the DLC3.
2. Turn the power switch IG-ON.
3. According to the display on GTS, read the Data List.
4. Enter the following menus: *Powertrain – HV Battery – Data List – Hybrid Battery Thermal Keep Control Mode Status*.
5. Check the results by referring to the following table:

Table 2.

Tester Display	Measurement Item	Range	Normal Condition
Hybrid Battery Thermal Keep Control Mode Status	Hybrid Battery Thermal Keep Control Mode State	ON or OFF	ON: Enabled OFF: Disabled

2024 TX 350, TX 500h, and TX 550h+ Pre-Delivery Service (PDS)

Enable Hybrid Battery Thermal Keep Control Mode (continued)

Set Hybrid Battery Thermal Keep Control Mode

1. Connect the Techstream to the DLC3.
2. Turn the power switch to IG-ON.
3. Enter the following menus: *Powertrain – HV Battery – Utility – Hybrid Battery Thermal Keep Control Mode.*

Figure 5.

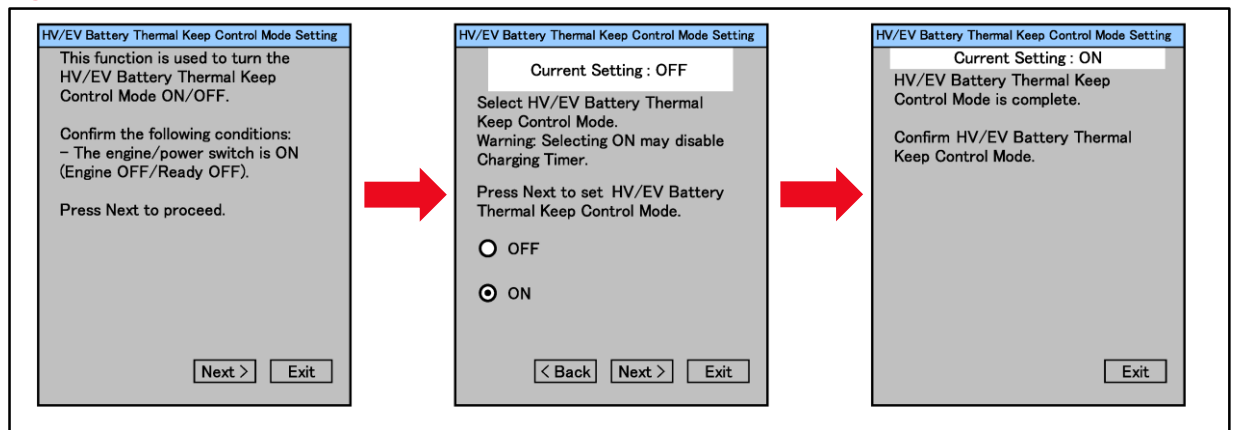

4. Confirm the following message is displayed:
“This function is used to turn the Hybrid Battery Thermal Keep Control Mode ON / OFF.”
5. Confirm that the conditions displayed on the screen are met, and then press Next.

NOTE

The power switch is ON (Ready OFF).

6. Confirm the following message is displayed:
“Select Hybrid Battery Thermal Keep Control Mode.”
7. Select ON and press Next.

NOTICE

Selecting ON may disable the charging timer.

8. Confirm the following message is displayed:
“Hybrid Battery Thermal Keep Control Mode is complete.”

2024 TX 350, TX 500h, and TX 550h+ Pre-Delivery Service (PDS)

Head Unit System Reset

Prior to vehicle delivery, confirm that the welcome screen with language options appears on the head unit display when the ignition is switched to the ON position. There may be instances where the welcome screen with language options may not properly appear on the head unit display.

If the welcome screen showing language options is NOT displayed, complete the following steps:

1. Select the Settings option (gear icon).
2. Scroll down and select the Info & Security option.
3. The System Reset dialogue box will appear. Select Reset to confirm the resetting of the system.
4. Confirm that the welcome screen with language options is now displayed.

Navigation — Set Date & Time by GPS

Prior to vehicle delivery, it is necessary to turn the Set Date & Time by GPS setting to the ON position.

1. Turn the engine switch (power switch) to the ON position (ON mode).
2. Navigate the following menus in the head unit: *Settings – General – Date & Time – Set date & time by GPS*.
3. Ensure the Set Date & Time by GPS function is set to the ON position.

Seating Position Control ECU Initialization

Initialization of the seating position control ECU is required after D/C cut fuse installation.

Refer to the applicable Repair Manual for the seating position control ECU initialization procedure ([TX 350](#) / [TX 500h](#) / [TX 550h+](#)) (procedure 2).

Customize ACC Function

The pre-startup function detects when a user enters the vehicle, and it energizes the audio head unit (+BA) so that the multimedia system can quickly be used. This function is not enabled at the factory to reduce parasitic current draw in transit and storage. To enable this function, it is necessary to set the ACC customization function in the navigation display to OFF.

1. Turn the engine switch (power switch) to the ON position (ON mode).
2. Enter the following menus: *Settings – Vehicle Customization – Utility – ACC Customize*.
3. Change the setting to OFF.