

2024 RC F, RC 300, and RC 350 Pre-Delivery Service (PDS)

Service Category General

Section Pre-Delivery Service

Market USA

Toyota Supports
ASE Certification 

Applicability

YEAR(S)	MODEL(S)	ADDITIONAL INFORMATION
2024	RC F, RC300, RC350	

Introduction

Pre-Delivery Service (PDS) is a critical step in satisfying our new car customers. Customer feedback indicates the following areas deserve special attention when performing PDS:

- Careful inspection for paint chips/scratches and body dents/dings.
- Proper operation of electrical accessories (including interior light, clock, and radio reset).
- Interior cleanliness.
- Proper function of mechanical systems.

Customer retention and proper maintenance of vehicles are and have always been a major focus for Lexus. To help remind customers that regular service is essential to the proper maintenance of the vehicle, dealers are required to input their dealer information and set the service reminder on the Navigation Screen before delivery. By doing this, customers will be reminded to return to your dealership for service. (See Page 2 of the RC F, RC 300, and RC 350 PDS [Check Sheet](#) “Set Dealer and Service Reminder.”)

This bulletin contains the PDS procedures that apply specifically to 2024 model year RC F, RC 300, and RC 350 vehicles. To properly perform a complete PDS, you must complete all procedures contained in this TSB as well as the RC F, RC 300, and RC 350 PDS [Check Sheet](#). In addition, if the vehicle is stored for over 30 days, be sure to follow [Long-Term Vehicle Storage Guidelines](#).

2024 RC F, RC 300, and RC 350 Pre-Delivery Service (PDS)

Table of Contents

- [Warranty Information](#)3
- [Required Tools & Equipment](#)3
- [D/C Cut Fuse Installation](#)4
- [Front License Plate and Mounting Bracket Installation*](#)5
 - [RC F and RC F Sport Model Vehicles*](#)5
 - [RC 300 and RC 350 Model Vehicles*](#)6
- [Front Spoiler Cover Installation*](#)8
- [Front and Rear Emergency Towing Eyelet Removal and Hole Cover Installation](#)9
- [Front Wheel Opening Extension Pad Installation](#)11
- [Installation of Rubber Body Plugs](#)12
- [Tire Pressure Warning System \(TPWS\) Initialization](#)13
- [Memorize Steering Angle Neutral Point](#)13
- [Seat Position Control ECU Initialization](#)13
- [Compass Calibration*](#)13
- [Deletion of Vehicle Alert History](#)14
- [Dealer Contact Information for Call Dealer Head Unit Function](#)14

*If applicable.

2024 RC F, RC 300, and RC 350 Pre-Delivery Service (PDS)

Warranty Information

OP CODE	DESCRIPTION	TIME	OFF	T1	T2
N/A	Not Applicable to Warranty	-	-	-	-

Required Tools & Equipment

REQUIRED EQUIPMENT	SUPPLIER	PART NUMBER	QTY
Techstream ADVi*	ADE	TSADVUNIT	1
Techstream 2.0		TS2UNIT	
Techstream Lite		TSLITEPDLR01	
Techstream Lite (Green Cable)		TSLP2DLR01	

*Essential SST.

NOTE

- Only ONE of the Techstream units listed above is required.
- GTS+ software version 2023.03.002.02 or later is required.
- Additional Techstream units may be ordered by calling Approved Dealer Equipment (ADE) at 1-800-368-6787.

2024 RC F, RC 300, and RC 350 Pre-Delivery Service (PDS)

D/C Cut Fuse Installation

To minimize battery discharge during transportation and storage, the D/C cut fuse has been removed at the assembly plant and temporarily stored in the blank space of the relay block in the engine compartment. During PDS, reinstall the D/C cut fuse into its original location and clear ALL related Diagnostic Trouble Codes (DTCs).

NOTICE

- RC 300 and RC 350 – D/C cut fuse (30A).
- RC F – D/C cut fuse (20A).

Figure 1.

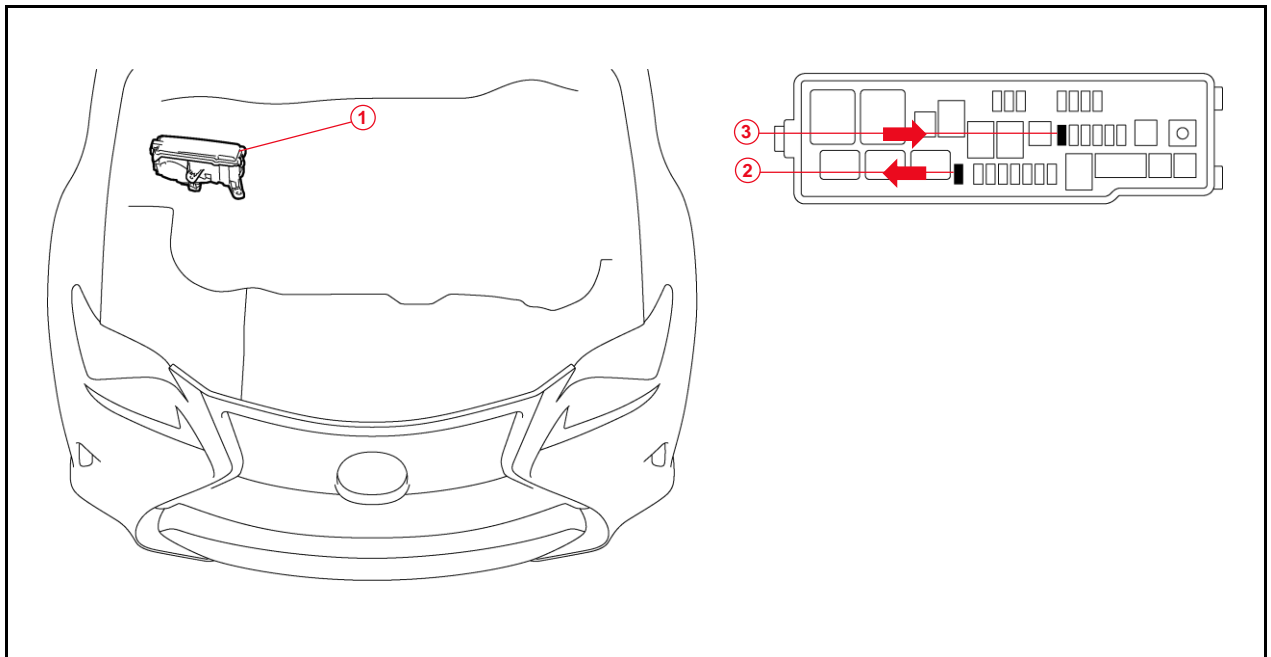

1	Relay Block
2	Remove the D/C Cut Fuse

3	Install the D/C Cut Fuse (Original Location)
----------	---

NOTE

- With the D/C cut fuse removed, if ANY DTCs are detected when the ignition is turned on during transportation, use Global Techstream Software (GTS+) to clear ALL DTCs AFTER ensuring that there are no malfunctions.
- While the vehicle is stored at the dealership, disconnect the negative (-) battery terminal to prevent battery discharge. Refer to [L-SB-0016-23](#), *Battery Maintenance During PDS*, for battery maintenance information.

2024 RC F, RC 300, and RC 350 Pre-Delivery Service (PDS)

Front License Plate and Mounting Bracket Installation

The front license plate mounting bracket and two self-tapping screws are stored in the vehicle. Follow this procedure to install the front license plate mounting bracket and front license plate in states where it is required by law.

RC F and RC F Sport Model Vehicles

1. Align the holes "A" of the mounting bracket with clips (RC F) or dimples (RC F Sport) on the radiator grille.

NOTE

- Holes "A" are used for installation of the mounting bracket to the radiator grille.
- Holes "B" are used for the installation of the front license plate to the mounting bracket.

2. Install the mounting bracket to the radiator grille using two self-tapping screws.

NOTICE

- Do NOT pre-drill holes into the bumper.
- Do NOT overtighten the self-tapping screws.

3. Install the front license plate onto the mounting bracket using two noncorroding bolts with the following dimensions:

Nominal Length: 15.0 mm (0.59 in.)

Diameter: 6.0 mm (0.24 in.)

Figure 3.

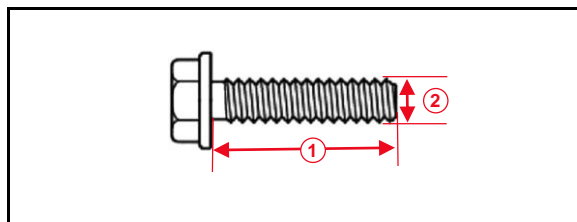

1	Nominal Length
2	Diameter

Figure 2.

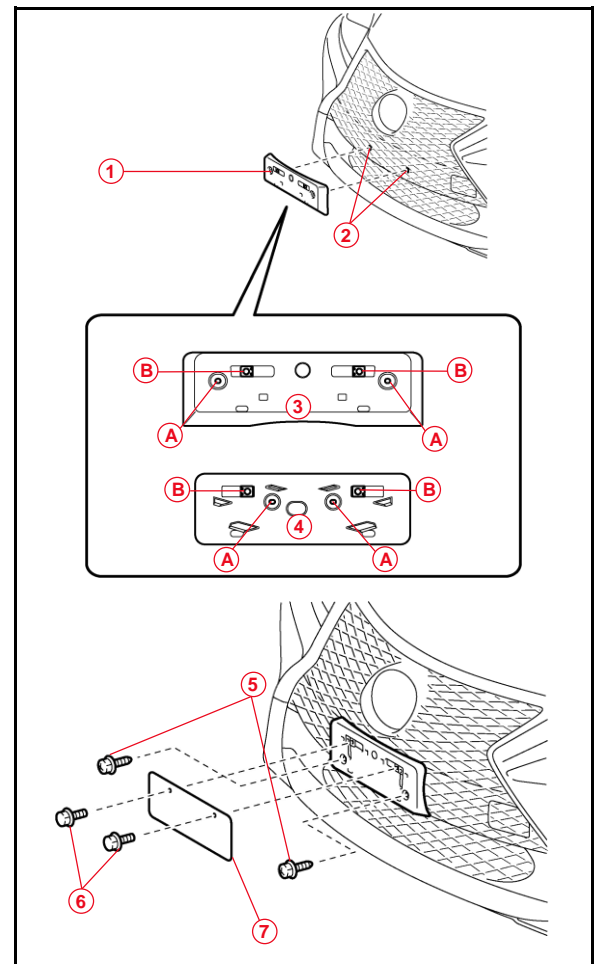

1	Front License Plate Mounting Bracket
2	Dimples (RC F Sport), Clips (RC F)
3	RC F Sport Mounting Bracket
4	RC F Mounting Bracket
5	Self-tapping Screws
6	Bolts
7	Front License Plate

2024 RC F, RC 300, and RC 350 Pre-Delivery Service (PDS)

Front License Plate and Mounting Bracket Installation (continued)

RC 300 and RC 350 Model Vehicles

1. Align holes "A" of the mounting bracket with the dimples on the radiator grille. Mark the location of holes "B" on the radiator grille.

NOTE

- Holes "A" are used for installation of the mounting bracket to the radiator grille.
- Holes "B" are used for the installation of the front license plate to the mounting bracket.

2. Drill two relief holes with a diameter of 11 mm (0.43 in.) at the hole "B" marks on the radiator grille to prevent the license plate retaining bolt end from contacting the radiator grille.

NOTICE

Do NOT pre-drill holes into the radiator grille.

Figure 4.

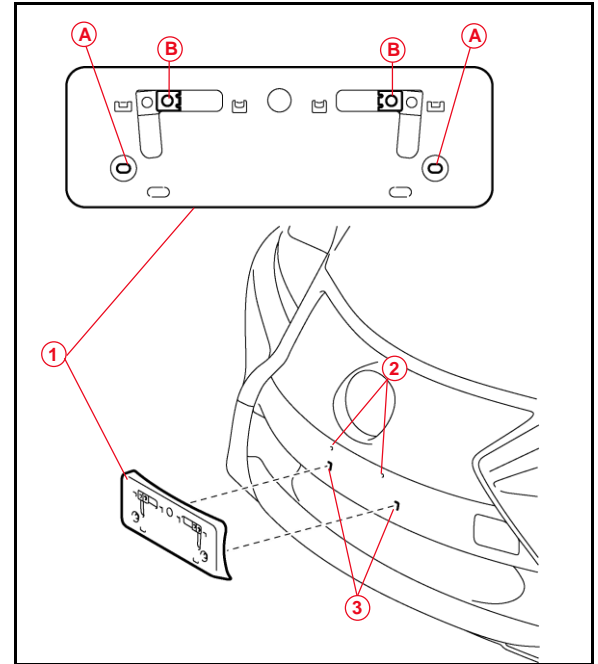

1	Mounting Bracket
2	Mark and Drill Hole
3	Dimples

3. Install the mounting bracket to the radiator grille by attaching the two self-tapping screws into the dimples.

NOTICE

Do NOT overtighten the self-tapping screws.

2024 RC F, RC 300, and RC 350 Pre-Delivery Service (PDS)

Front License Plate and Mounting Bracket Installation (continued)

RC 300 and RC 350 Model Vehicles (continued)

- Install the front license plate onto the mounting bracket using two noncorroding bolts with the following dimensions:

Nominal Length: 15.0 mm (0.59 in.)

Diameter: 6.0 mm (0.24 in.)

Figure 5.

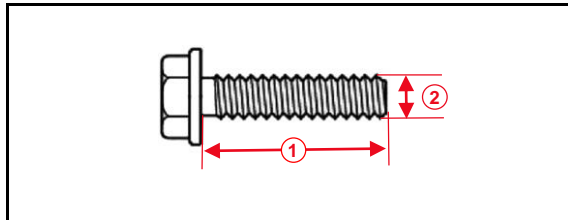

1	Nominal Length
2	Diameter

Figure 6.

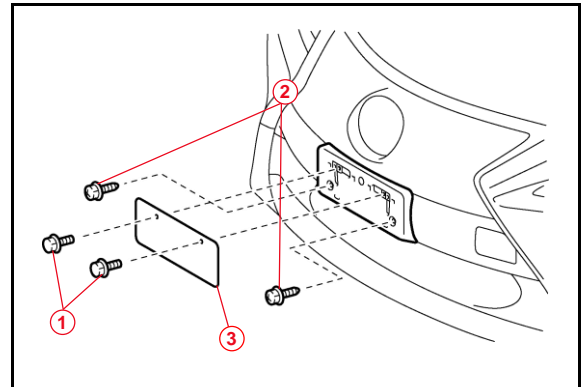

1	Bolts
2	Self-tapping Screws
3	Front License Plate

2024 RC F, RC 300, and RC 350 Pre-Delivery Service (PDS)

Front Spoiler Cover Installation (RC F models only)

The front spoiler cover set (front spoiler cover, eight screw grommets, and eight screws) is loaded in the luggage compartment at the assembly plant to avoid damage in transit.

1. Attach the eight screw grommets to the front bumper guard.

2. Align the front spoiler cover and secure it with the eight screws.

NOTICE

- **AFTER installation, check that the installation has been completed successfully.**
- **Check that the vehicle is NOT damaged.**

NOTE

AFTER securing the front spoiler cover at its datum (circular hole), secure it outward (in the direction of the arrows).

Figure 7.

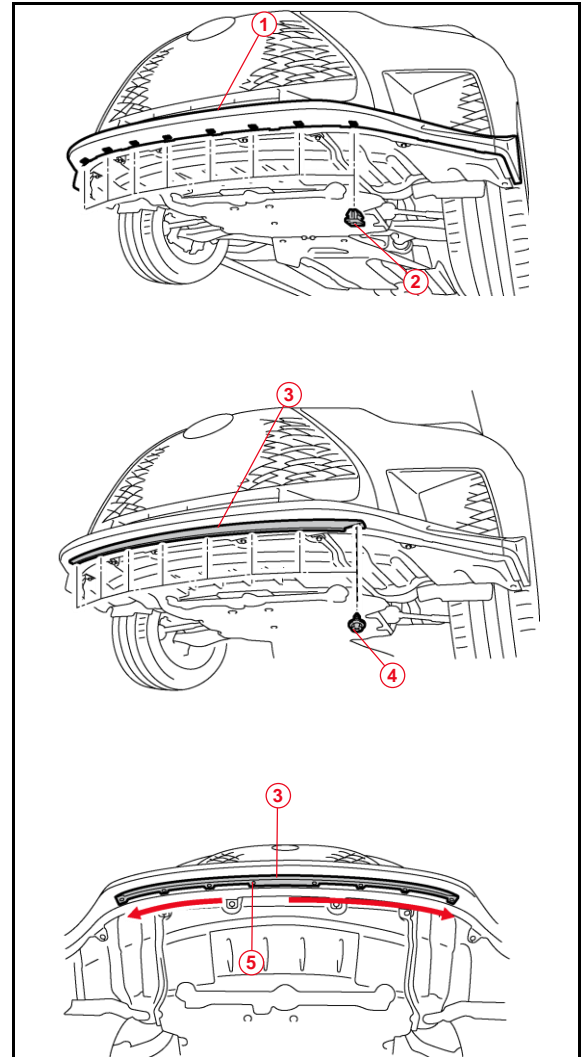

1	Front Bumper Guard
2	Screw Grommet
3	Front Spoiler Cover
4	Screw
5	Datum (Circular Hole)

2024 RC F, RC 300, and RC 350 Pre-Delivery Service (PDS)

Front and Rear Emergency Towing Eyelet Removal and Hole Cover Installation

1. Remove the front and rear emergency towing eyelets from the front AND rear bumpers by turning them counterclockwise.

NOTE

If it is difficult to loosen the emergency towing eyelets, use a steel bar.

Figure 8.

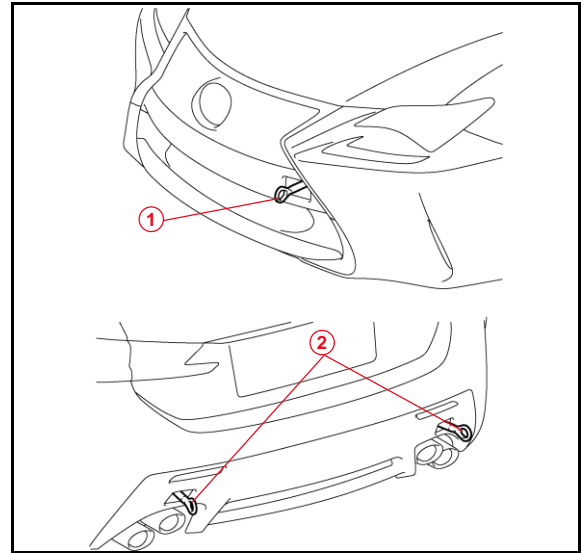

1	Front Emergency Towing Eyelet
2	Rear Emergency Towing Eyelets

2. Place one of the removed emergency towing eyelets into the luggage tray or tool bag (if equipped) in the luggage compartment.

NOTE

Dispose of the other removed emergency towing eyelets.

Figure 9.

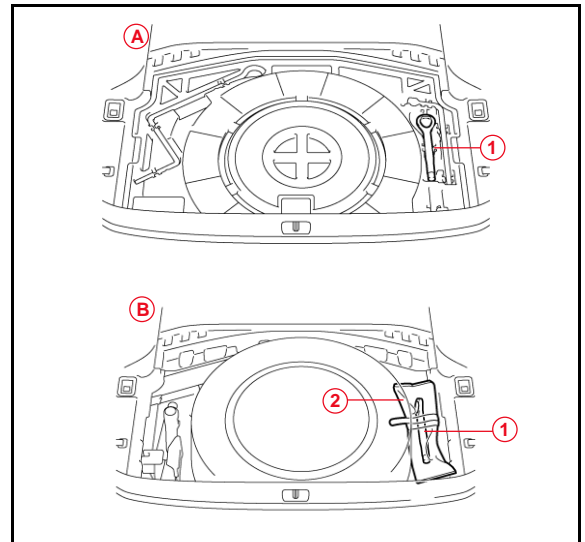

A	Type A
B	Type B
1	Emergency Towing Eyelet
2	Tool Bag

2024 RC F, RC 300, and RC 350 Pre-Delivery Service (PDS)

Front and Rear Emergency Towing Eyelet Removal and Hole Cover Installation (continued)

3. Install the front AND rear emergency towing eyelet hole covers, which are stored in the glove box, onto the front and rear bumpers.
 - A. Insert the arrow-shaped part "A" of the front emergency towing eyelet hole cover into the eyelet hole tab "B" as shown.
 - B. Install the emergency towing eyelet hole cover to the hole in the front bumper.

NOTE

Make sure the front emergency towing eyelet hole cover is installed in the front, and the rear emergency towing eyelet hole cover is installed in the rear.

Figure 10.

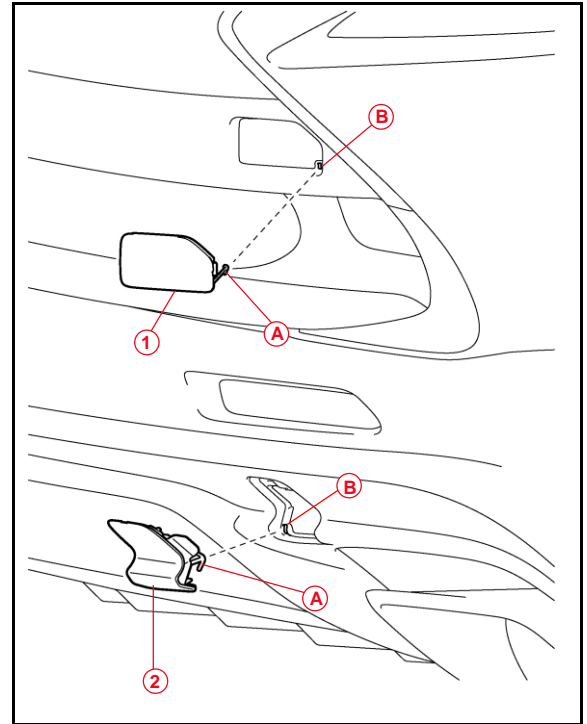

A	Arrow-shaped Tab
B	Eyelet Hole Tab
1	Front Emergency Towing Eyelet Hole Cover
2	Rear Emergency Towing Eyelet Hole Cover

2024 RC F, RC 300, and RC 350 Pre-Delivery Service (PDS)

Front Wheel Opening Extension Pad Installation

The front wheel opening extension pad set (right and left front wheel opening extension pads and six self-tapping screws) is located in the luggage compartment at the assembly plant to avoid damage in transit.

NOTE

- Use the same procedure for the right-hand side and the left-hand side.
- The procedure listed below is for the left-hand side.
- There is a distinguishable mark on each front wheel opening extension pad.

1. Place the left front wheel opening extension pad on the installation position as shown and tighten the three self-tapping screws.
2. Repeat step 1 for the right-hand side.

Figure 11.

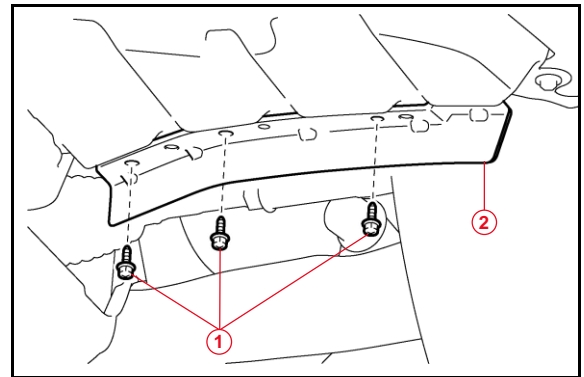

1	Self-tapping Screws
2	Front Wheel Opening Extension Pad

2024 RC F, RC 300, and RC 350 Pre-Delivery Service (PDS)

Installation of Rubber Body Plugs

1. Confirm the number of plugs in the glove box. If two plugs are present, perform substep 2A ONLY. If four plugs are present, perform substep 2A AND substep 2B.
2. Install plugs according to the instructions below by confirming the number of plugs in the glove box.
 - A. Install two plugs in the rear side member hole or rocker inner hole (see below).
 - B. Install two plugs in the torque box hole or rocker inner hole (see below).

Figure 12.

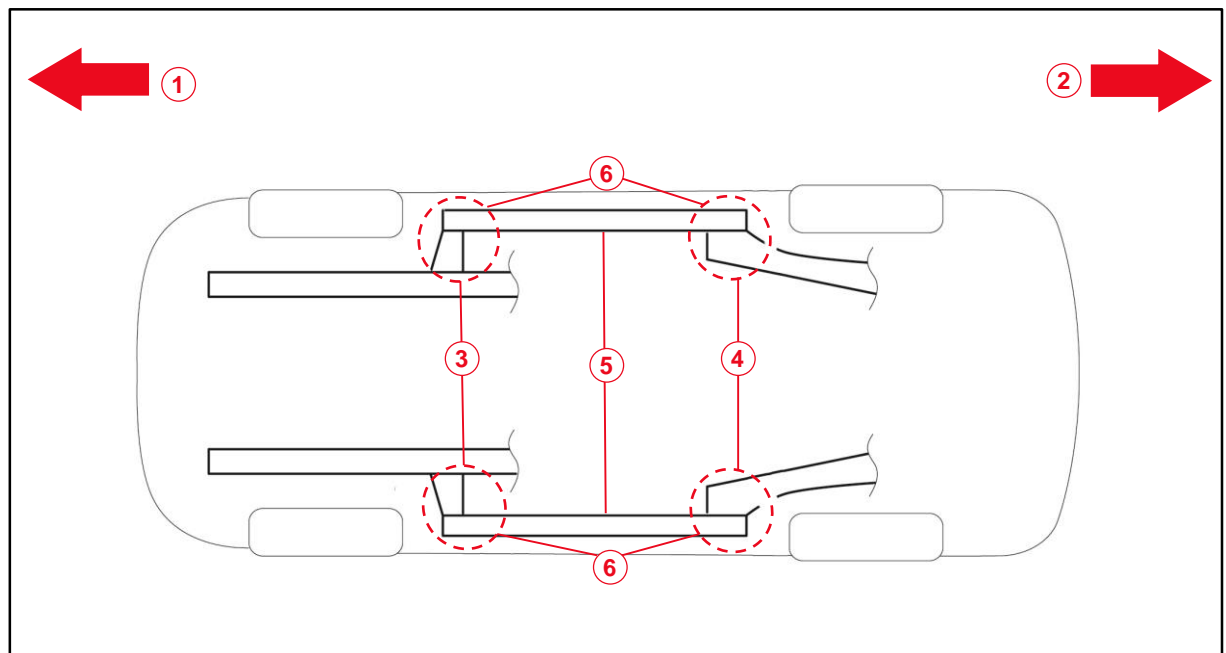

1	Front Side
2	Rear Side
3	Torque Box Hole or Rocker Inner Hole
4	Rear Side Member Hole or Rocker Inner Hole
5	Rocker Inner
6	Install Plug Here (if Applicable)

NOTICE

- The installation of these plugs is required to prevent rust.
- These plugs are stored in the glove box.
- The number of plugs may vary according to production locations in the same vehicle model.

2024 RC F, RC 300, and RC 350 Pre-Delivery Service (PDS)

Tire Pressure Warning System (TPWS) Initialization

Refer to the applicable Repair Manual for the TPWS initialization procedure ([RC F](#) / [RC 300](#) / [RC 350](#)). Note the spare tire does NOT have a TPWS sensor.

NOTE

To adjust the tire pressure correctly when the outside temperature is significantly colder than shop temperature, perform a Health Check using GTS+ and select the compensation tire pressure checkbox. Compensation pressures will display on the Health Check results screen. Adjust the tire pressure when the tires are cold.

Memorize Steering Angle Neutral Point

As a result of the removal of the D/C cut fuse, the power source to the steering angle sensor is cut off. When the D/C cut fuse is reinstalled, the parking assist monitor system/panoramic view monitor will be operative, but it cannot display guidelines to assist parking operation because the center position recognized by the steering angle sensor may not be in an initial position. Therefore, perform steering angle neutral point initialization AFTER installing the D/C cut fuse during PDS.

Refer to the applicable Repair Manual for the steering angle neutral point initialization procedure ([RC F](#) / [RC 300](#) / [RC 350](#)).

Seat Position Control ECU Initialization

Refer to the applicable Repair Manual for the seating position control ECU initialization procedure ([RC F](#) / [RC 300](#) / [RC 350](#)) (procedure 2).

Compass Calibration

Refer to the applicable Repair Manual for the calibration procedure for vehicles equipped with a compass in the inner rear-view mirror. ([RC F](#) / [RC 300](#) / [RC 350](#)).

NOTE

- Do NOT perform calibration of the compass in a place where the Earth's magnetic field is subject to interference (underground parking, under a steel tower, between buildings, roof parking, near a railroad crossing, near a large vehicle, etc.).
- During calibration, do NOT operate electric systems (moonroof, power windows, etc.), as they may interfere with the calibration.
- The dot on the compass display disappears when calibration is completed.

2024 RC F, RC 300, and RC 350 Pre-Delivery Service (PDS)

Deletion of Vehicle Alert History

As the D/C cut fuse is removed, the communication between the various ECUs is interrupted. When the D/C cut fuse is reinstalled, the communication status is restored, but Lexus Enform Service Connect may store malfunction history in the form of vehicle alert history. Therefore, it is necessary to operate the multi-display and delete the vehicle alert history AFTER installing the D/C cut fuse during PDS at the dealership.

1. Turn the engine switch (power switch) to the ON position (ON mode).
2. Push the Menu switch on the remote touch device.
3. On the multi-display, enter the following menus: *Info – Vehicle Alert History*.
4. If there is vehicle alert history stored, perform the Delete History operation.

HINT

If there is no vehicle alert history stored, the system will display a message stating "There is no vehicle alert history."

5. When the vehicle alert history deletion confirmation screen is displayed, select Yes.
6. Turn the engine switch (power switch) to the OFF position (OFF mode).

Dealer Contact Information for Call Dealer Head Unit Function

Refer to the Multimedia System Owner's Manual to add [dealer contact information](#). See section 2-4 *Basic function – Other settings – Vehicle settings*.