

Subject: ACTIVE DRIVING DISPLAY NOT DISPLAYING TURN BY TURN (TBT) TRAVEL DIRECTION OR NAVIGATION INFORMATION	Service Alert No.: SA-042/23 Last Issued : 10/06/2023
--	--

BULLETIN NOTES

This SA supersedes the previously issued SA(s) listed below. The changes are noted in Red.

Previous SAs:	Date(s) Issued:
SA-042/23	07/21/23

APPLICABLE MODEL(S)/VINS

2019-2024 Mazda3**	2021-2024 CX-5**	2022-2023 MX-30**	2024 CX-90**
2020-2023 CX-30**	2021-2023 CX-9**	2023-2024 CX-50**	

**equipped with Active Driving Display and Navigation Map SD Card

DESCRIPTION

Some customers may complain about the Active Driving Display not displaying turn by turn (TBT) travel direction or navigation information.

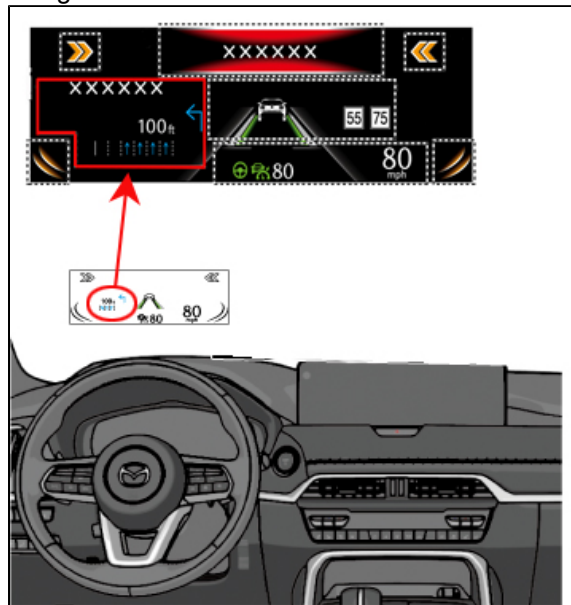

CONSUMER NOTICE: The information and instructions in this bulletin are intended for use by skilled technicians. Mazda technicians utilize the proper tools/ equipment and take training to correctly and safely maintain Mazda vehicles. These instructions should not be performed by "do-it-yourselfers." Customers should not assume this bulletin applies to their vehicle or that their vehicle will develop the described concern. To determine if the information applies, customers should contact their nearest authorized Mazda dealership. Mazda North American Operations reserves the right to alter the specifications and contents of this bulletin without obligation or advance notice. All rights reserved. No part of this bulletin may be reproduced in any form or by any means, electronic or mechanical---including photocopying and recording and the use of any kind of information storage and retrieval system ---without permission in writing.

Function Requirement:

Compatibility

Gen 7 infotainment equipped with Navi SD Card

- Compatible with Mazda Connect Navigation



2024 CX-90
2024 Mazda3

- Compatible with Apple Carplay
 - Apple Maps



2024 CX-90
2024 Mazda3

- Compatible with Android Auto
 - Google Maps
 - Waze

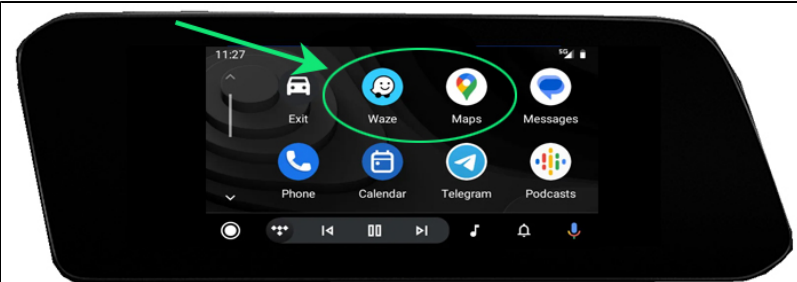

2023 and older vehicles are not compatible with:

- Apple Carplay
- Android Auto

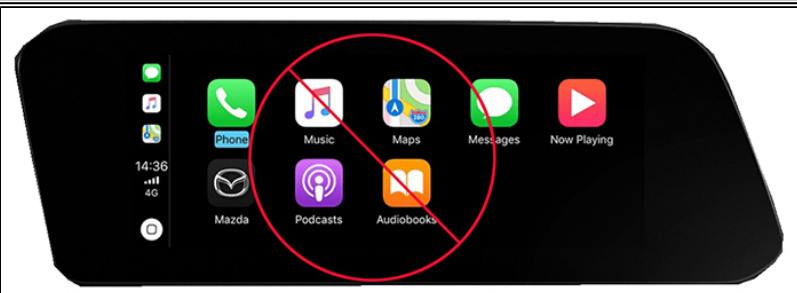

CONSUMER NOTICE: The information and instructions in this bulletin are intended for use by skilled technicians. Mazda technicians utilize the proper tools/ equipment and take training to correctly and safely maintain Mazda vehicles. These instructions should not be performed by "do-it-yourselfers." Customers should not assume this bulletin applies to their vehicle or that their vehicle will develop the described concern. To determine if the information applies, customers should contact their nearest authorized Mazda dealership. Mazda North American Operations reserves the right to alter the specifications and contents of this bulletin without obligation or advance notice. All rights reserved. No part of this bulletin may be reproduced in any form or by any means, electronic or mechanical--including photocopying and recording and the use of any kind of information storage and retrieval system ---without permission in writing.

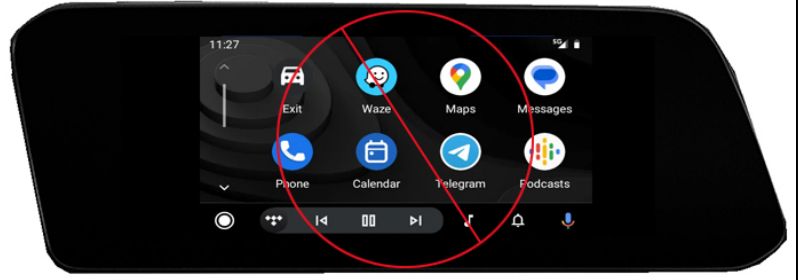

CONSUMER NOTICE: The information and instructions in this bulletin are intended for use by skilled technicians. Mazda technicians utilize the proper tools/ equipment and take training to correctly and safely maintain Mazda vehicles. These instructions should not be performed by "do-it-yourselfers." Customers should not assume this bulletin applies to their vehicle or that their vehicle will develop the described concern. To determine if the information applies, customers should contact their nearest authorized Mazda dealership. Mazda North American Operations reserves the right to alter the specifications and contents of this bulletin without obligation or advance notice. All rights reserved. No part of this bulletin may be reproduced in any form or by any means, electronic or mechanical---including photocopying and recording and the use of any kind of information storage and retrieval system ---without permission in writing.