



## Checking Surface Wear on the Front Brake Caliper Connection Hose

Multistrada 1200 MY 2010-2014 (all versions)

Multistrada 1200 MY 2015-2018 (all versions)

Multistrada 1260 MY 2018-2020 (all versions)

Service Repair Bulletin SRV-SRB-23-040

Date: September 15, 2023

To: Dealer Principal, General Manager, Service Manager, North American Dealer Network

From: Richard Kenton, Technical Director  
Dan Schwartz, Service Area Manager

Dear Dealers,

We have received some reports of front brake hose surface wear. After careful analysis of these cases, we found the wear was caused by incorrect repositioning of hoses. For example, after tire replacement procedures or when the front mud guard is removed.

Due to possible unknown service history of the vehicles listed above, we ask you, on all models in question, during each Annual Service and Oil Service, to check the surface wear status of the sheath on **Brake Hose (A) connecting the front brake calipers**.

If wear is found, the hose in question must be replaced.

We also ask you to pay special attention during positioning of the above-mentioned brake hose during all the operations involving removal and subsequent refitting of **Front Mudguard Extension (B)**. For any further details about the assembly instructions of the extension, refer to the specific bulletin [SRV-SRB-19-027](#) ([link ↗](#)).

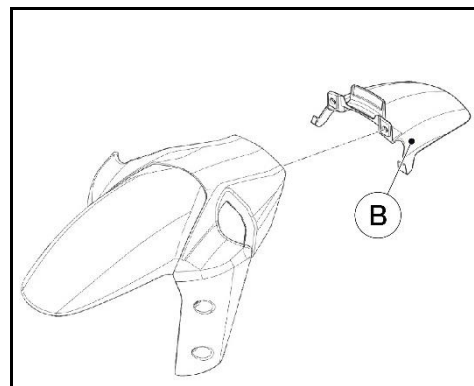
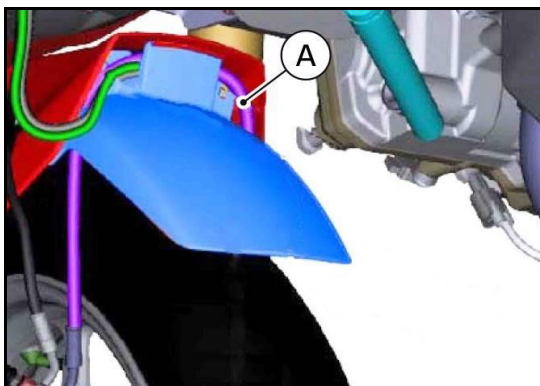



## Checking Surface Wear on the Front Brake Caliper Connection Hose

Multistrada 1200 MY 2010-2014 (all versions)

Multistrada 1200 MY 2015-2018 (all versions)

Multistrada 1260 MY 2018-2020 (all versions)

Service Repair Bulletin SRV-SRB-23-040

A dedicated operation has been added to the maintenance check list (attached), directly related to this item:

Performed	Replaced	Annual Service *			
		DESMO Service *			12
		OIL Service *			
		OIL Service 1000*			
<input type="checkbox"/>	<input type="checkbox"/>	Visual check of brake hose connecting front brake callipers	•	•	

The additional visual inspection of possible wear on front brake caliper connection hose is required at the two areas shown in the figure:



### NOTE

The visual inspection must be carried out regardless of whether the front mudguard extension is present or not.



## Checking Surface Wear on the Front Brake Caliper Connection Hose

Multistrada 1200 MY 2010-2014 (all versions)

Multistrada 1200 MY 2015-2018 (all versions)

Multistrada 1260 MY 2018-2020 (all versions)

Service Repair Bulletin SRV-SRB-23-040

To check for possible wear on the brake hose connecting the front brake calipers, the hose must be moved as shown in the figure:

### 1. Vehicle left-hand side



### 2. Vehicle right-hand side

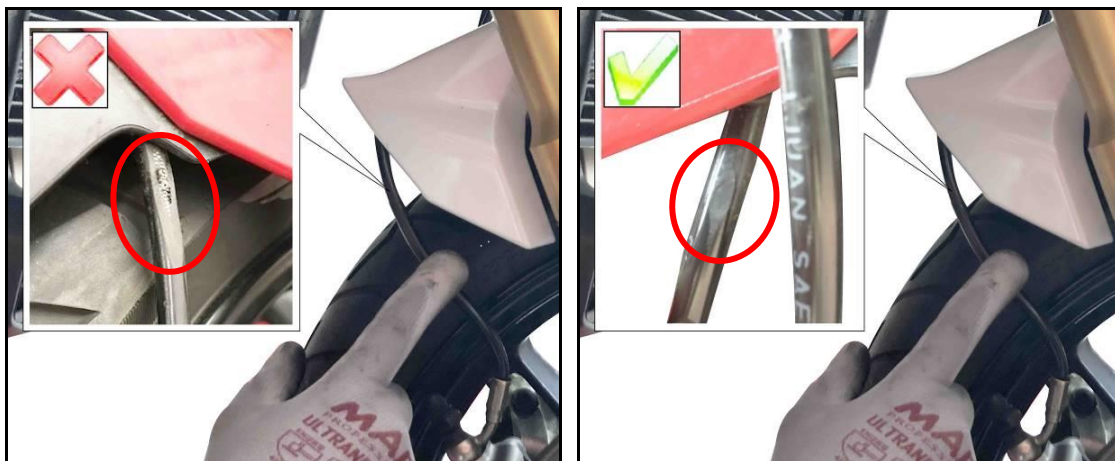

For questions about this Service Bulletin,  
please contact your Service Area Manager.