



INSTRUCTION TO SERVICE

ITS60791		August 18, 2023
SECTION:	241-Fuel Systems	
WRITTEN BY:	Aditya Gadepalli	
SUBJECT:	Fuel Level Sensor Replacement	
ISSUE:	Some customers are complaining of the fuel level sensor being stuck to the baffle and showing wrong readings on the dash	
SUMMARY:	Replace the existing fuel level sensor with a shortened one to avoid it getting stuck to the baffle	

ITS60791

Ref. NHTSA Recall No.	Ref. Transport Canada Recall No.
Not Applicable	Not Applicable

THIS ITS DOCUMENT SHOULD BE RETAINED AND REFERRED TO FOR FUTURE MAINTENANCE UNTIL THE PARTS AND/OR SERVICE MANUAL IS UPDATED TO REFLECT WORK DONE AS A RESULT OF THIS DOCUMENT. ENSURE THAT THIS DOCUMENT IS AVAILABLE FOR PARTS AND MAINTENANCE STAFF GOING FORWARD.

PROCEDURE:

1. Set park brake and chock wheels.
2. Turn the main battery disconnect switch to the "OFF" position.
3. Open the fuel tank access door and remove the two bolts securing the fuel door. Save the bolts for later use.

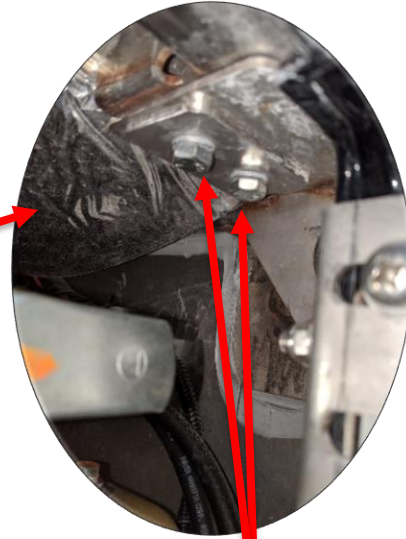

Remove and save the two bolts.

4. Open the DEF access door and remove the two bolts securing the fuel door. Save the bolts for later use.



Remove and save the two bolts.

5. Take the fuel door out.
6. Remove and save the bolts securing the level sensor. Discard the gasket and sensor.

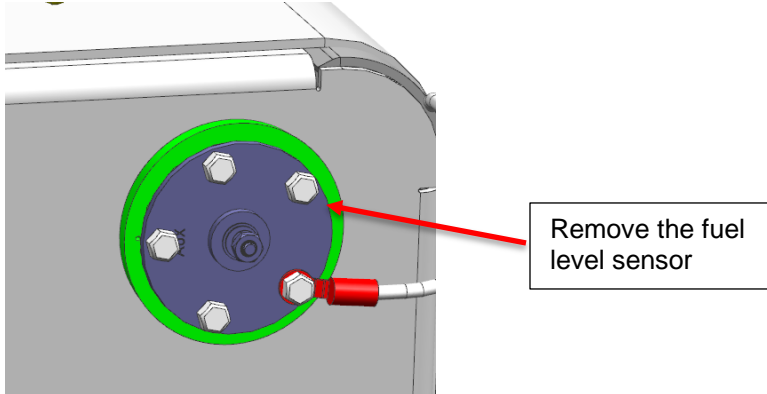

7. Save the ground terminal wire.
8. Apply thread sealant to the existing bolts and install new level sensor, PN: 1031519, and gasket, P/N: 9A-6-90.

NOTE: Install the ground wire at the location shown.

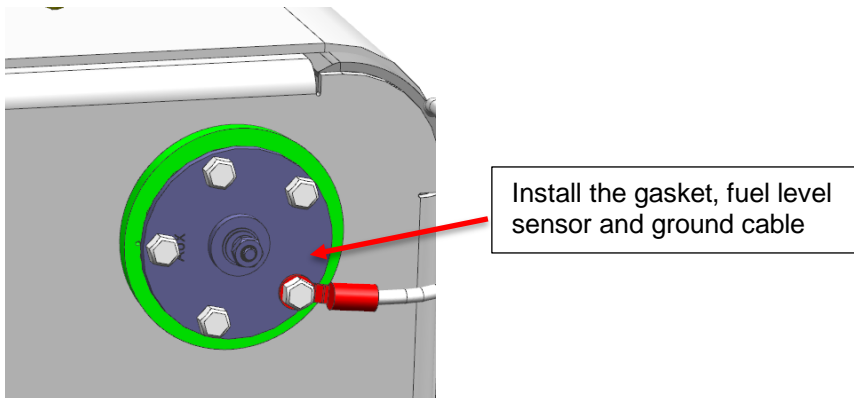

9. Torque the bolts to 23-27 In-Lbs.
10. Secure the fuel panel using the existing hardware.





LABOUR ESTIMATE				
	Operation	Number of Technician(s)	Hours	Labor Time T X HR
1	Fuel Level Sensor Replacement	1	.5	.5

PARTS REQUIRED					
Item	Part Number	Description	Qty. per Coach	Units	Notes
1	1031519	Arm-Fuel Level Sensor	1	EA	
2	9A-6-90	Gasket	1	EA	

SPECIAL TOOLS REQUIRED					
Item	Part Number	Description	Qty.	Units	Notes
1	21-7112-48	Thread Sealant			