

REFERENCE:	Nova Bus Manuals	APPLICATION DEADLINES: 2024NO15 CLAIM REFERENCE NUMBER: WB5424
SECTION:	08: Pneumatic System 09: Engine and Cooling	
RS N°:	MQR 7621-2412	
EFFECTIVE IN PROD.:	2022DE	

SUBJECT:	Brake and Accelerator Pedals
JUSTIFICATION:	Hardware and/or thread locker might be missing.

LEVEL	DESCRIPTION	DIRECT CHARGES		TIME
		LABOUR	MATERIAL	
1	Remove the brake and the accelerator pedals, clean and reinstall with new hardware.	Nova Bus	Nova Bus	30 min
2	–	–	–	–

## MATERIAL REQUIRED PER VEHICLE

QTY	PART N°	REV.	DESCRIPTION
<b>LEVEL 1</b>			
6	10568958	–	WASHER FLAT 1/4 NYLON (Prv #N87506)
6	N17565	X	WASHER FLAT OVS M6 SS DIN9021
6	N20779	X	WASHER FLAT OVS M6 ZP DIN9021
3	N31991	A	BOLT M6 X 50 SS GR.A2 DIN 931
6	N64492	A	BUSHING NYLON M6X25
3	N45812	A	SCREW M6X50 SSA2 CL70 D933
<b>LEVEL 1 SHOP SUPPLIES*</b>			
50 ml	N35535-01	–	SIKAFLEX 552 AEROGRAY DARK/400 (sausage of 400 ml)
4.5 ml	N97665	A	THREADLOCKER LOCTITE 243 (bottle of 50 ml)
4.5 gr	R085023	–	SEALANT LUB NEVER SEEZE (container of 454 gr)
*WHEN YOU ORDER, SPECIFY THE NUMBER OF VEHICLES TO REPAIR.			
<b>LEVEL 2</b>			
–	–	–	–

Materials will be available within 42 days once your order has been placed. To order, please contact novabus.parts@volvo.com or by phone for CANADA 1-800-771-6682, for USA 1-877-999-8808

Specify document number, quantity of parts required and shipping address.

## DISPOSAL OF PARTS

REMOVED PARTS ARE:	DISCARDED *	RETAINED	* Dispose of the unused parts and the defective parts in accordance with local environmental standards in effect.
	Yes	–	

## REVISION HISTORY

REV.	DATE	CHANGE DESCRIPTION	WRITTEN BY
NR	2023SE05	Initial release	Annie St-Jacques

APPROVED BY:

Irina

Signature numérique  
de Irina Negoescu

PAGE 1 OF 6

NQF772001 version 5

Negoescu

Date : 2023.09.06

12:35:06 -04'00'

CLIENT	ORDER	ROAD NUMBER		VIN (2NVY/4RKY...)		QTY
		FROM	TO	FROM	TO	
Chicago Transit Authority - CTA - Illinois	LE87	8477	8496	L82J3N97786 [REDACTED]	L82J0P97787 [REDACTED]	20
Chicago Transit Authority - CTA - Illinois	LE87	8502	8502	L82J1P97787 [REDACTED]	L82J1P97787 [REDACTED]	1
Chicago Transit Authority - CTA - Illinois	LE87	8510	8510	L82J2P97787 [REDACTED]	L82J2P97787 [REDACTED]	1

**WARNING**

FOLLOW YOUR INTERNAL SAFETY PROCEDURES.

## PROCEDURE

- 1.1. Park the vehicle on an even surface with the transmission on neutral.
- 1.2. Apply the parking brake and set the master control switch to the **stop** position.
- 1.3. Set the battery disconnect switch in the battery compartment to the **off** position.
- 1.4. Raise the vehicle.
- 1.5. In the vehicle, locate the brake and accelerator pedals. Underneath the vehicle, behind the front dust pan, locate the brake valve (Figure 1).

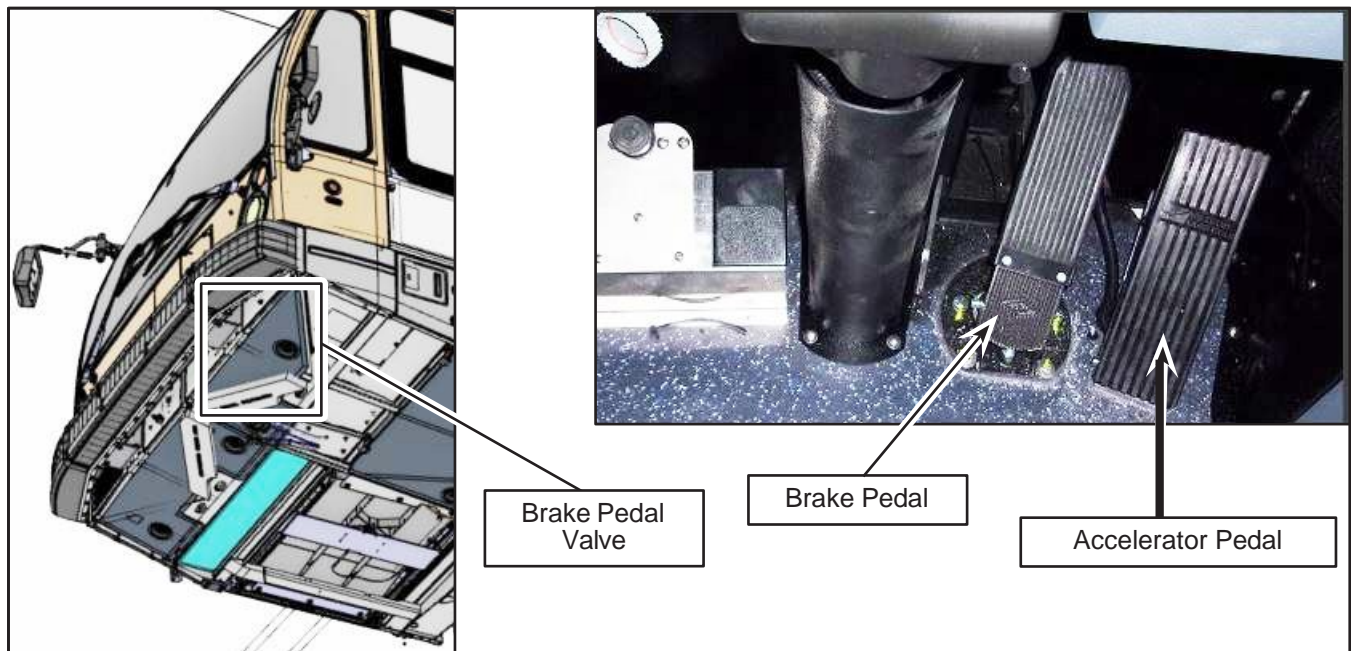

Figure 1 - Brake Valve - Brake and Accelerator Pedals

## PEDALS REMOVAL

- 1.6. Disconnect the accelerator pedal connectors from the vehicle electrical harness (Figure 2).
- 1.7. Unscrew the 3 screws fixing the accelerator pedal to the floor. Set aside the pedal and discard all hardware and bushings inserted in the floor.
- 1.8. Unscrew the 2 screws fixing the brake pedal to its valve (the valve is underneath the vehicle's floor). The valve will be free but still retained by the pneumatic hoses. Keep the 2 screws and the 2 washers for later reinstallation.
- 1.9. Unscrew the 3 screws fixing the brake pedal to the floor and remove the pedal. Discard all hardware and bushings inserted in the floor.

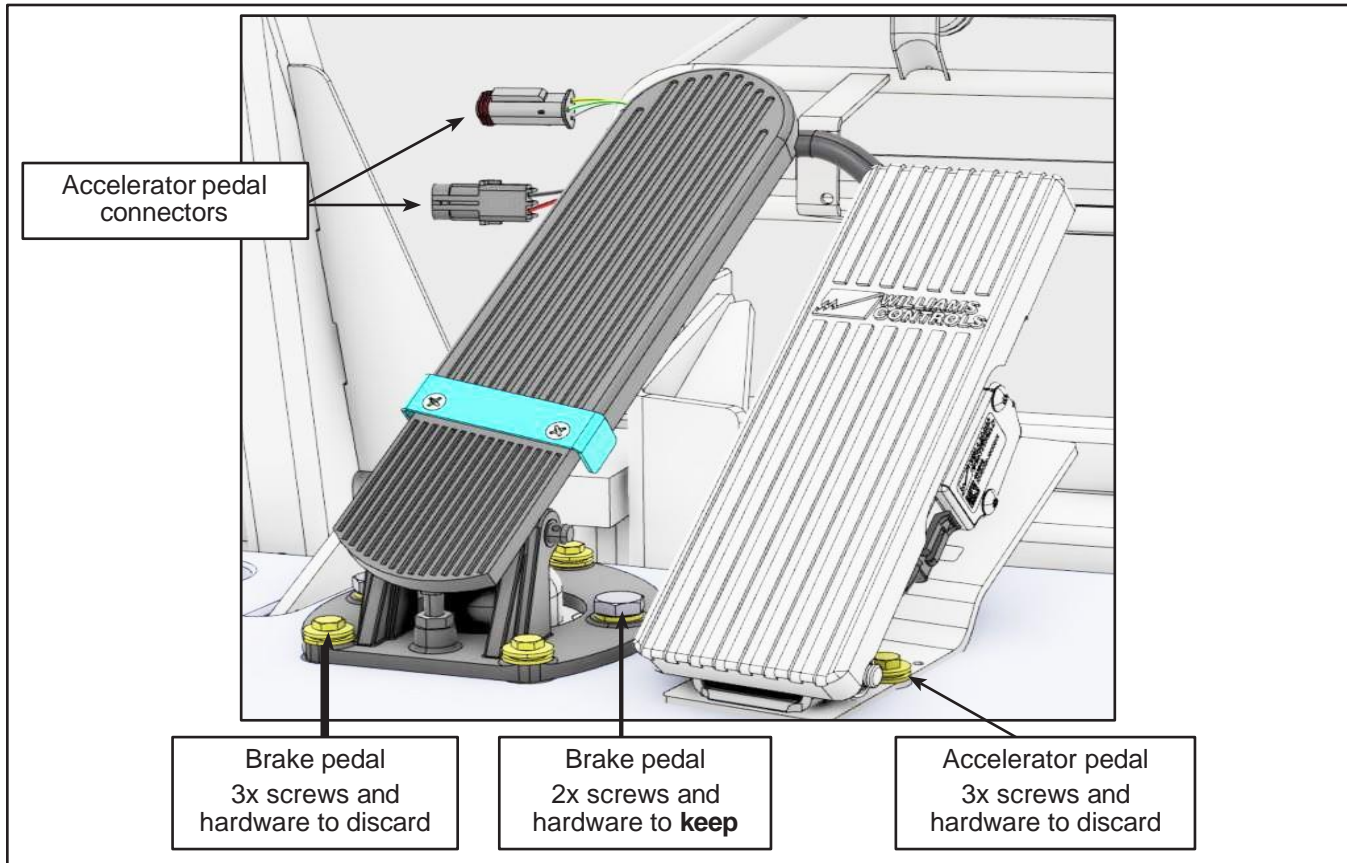

Figure 2 - Brake and Accelerator Pedals

## CLEANING

- 1.10. Gently scrape and clean the surface of the floor where the pedals were resting to remove any residue of sealant, dirt or dust.
- 1.11. Clean also the 6 bushing holes to remove any residue of sealant, dirt or dust.
- 1.12. Clean the underneath surface of both pedals. Put aside.

## PEDALS INSTALLATION

- 1.13. Insert into the floor the 6 new bushings N64492, 3 for each pedal.
- 1.14. Underneath the brake pedal apply anti-seize lubricant Never-Seeze R085023 (Figure 3).
- 1.15. Put back the pedal in place. Apply medium thread locker Loctite 243 on the 3 new screws N31991 and install with the required hardware (Figure 4). Torque at 7 lb-ft ( $9 \pm 1$  N•m).
- 1.16. Fix the brake valve (underneath the vehicle) to the brake pedal with the 2 removed screws and washers. Torque the screws at  $35 \pm 3$  lb-ft ( $47 \pm 4$  N•m).
- 1.17. Underneath the accelerator pedal apply anti-seize lubricant Never-Seeze R085023.
- 1.18. Put back the pedal in place. Apply medium thread locker Loctite 243 on the 3 new screws N45812 and install with the required hardware (Figure 5). Tighten only by hand.

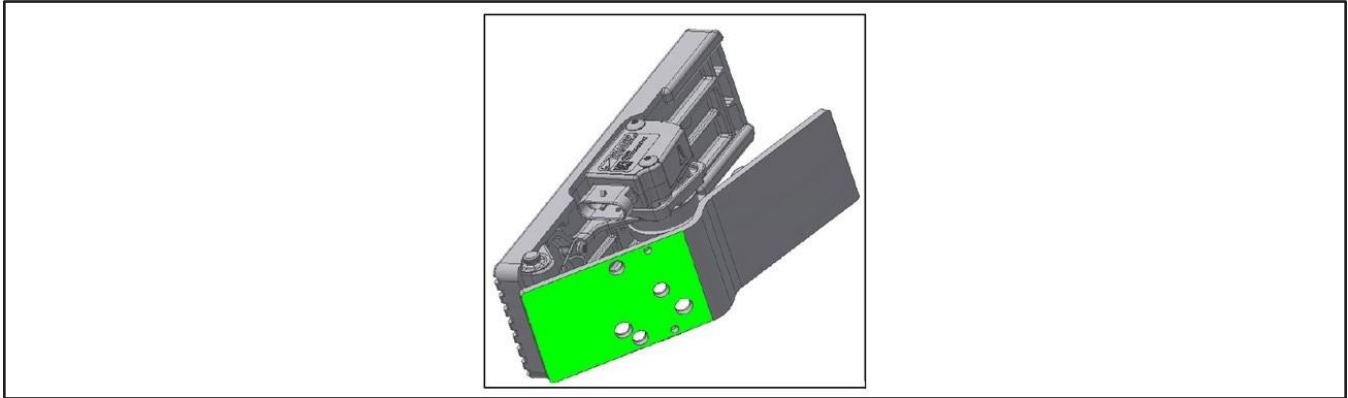

Figure 3 - Pedal Underneath Surface (Typical for all Pedals)

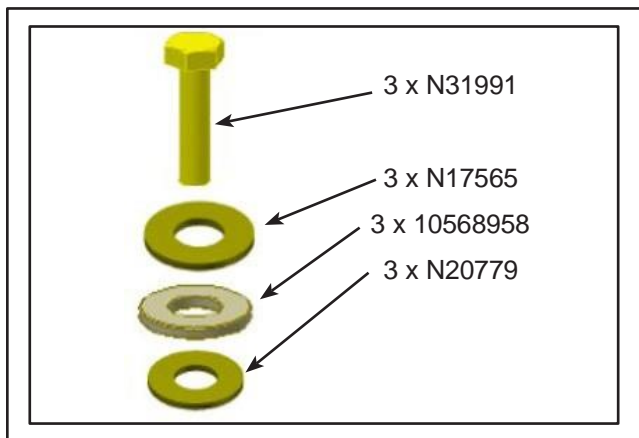

Figure 4 - Brake Pedal Hardware

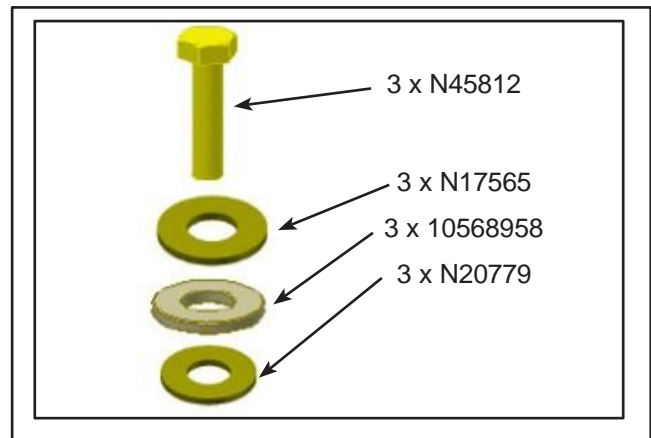

Figure 5 - Accelerator Pedal Hardware

- 1.19. Adjust the distance between the 2 pedals to be at least 2 in. (50 mm) (Figure 6).
- 1.20. Tighten the 3 screws to a torque value of 7 lb-ft ( $9 \pm 1$  N•m).
- 1.21. Check that the distance between the 2 pedals is still at least 2 in. (50 mm).
- 1.22. Apply Torque Seal on the 5 brake pedal screw heads and the 3 accelerator pedal screw heads.
- 1.23. Apply Sikaflex 552 N35535-01 all around the pedals and in any floor opening to seal properly (Figure 7).
- 1.24. Connect the pedal connectors to the vehicle electrical harness.
- 1.25. The vehicle can return in service. ❖

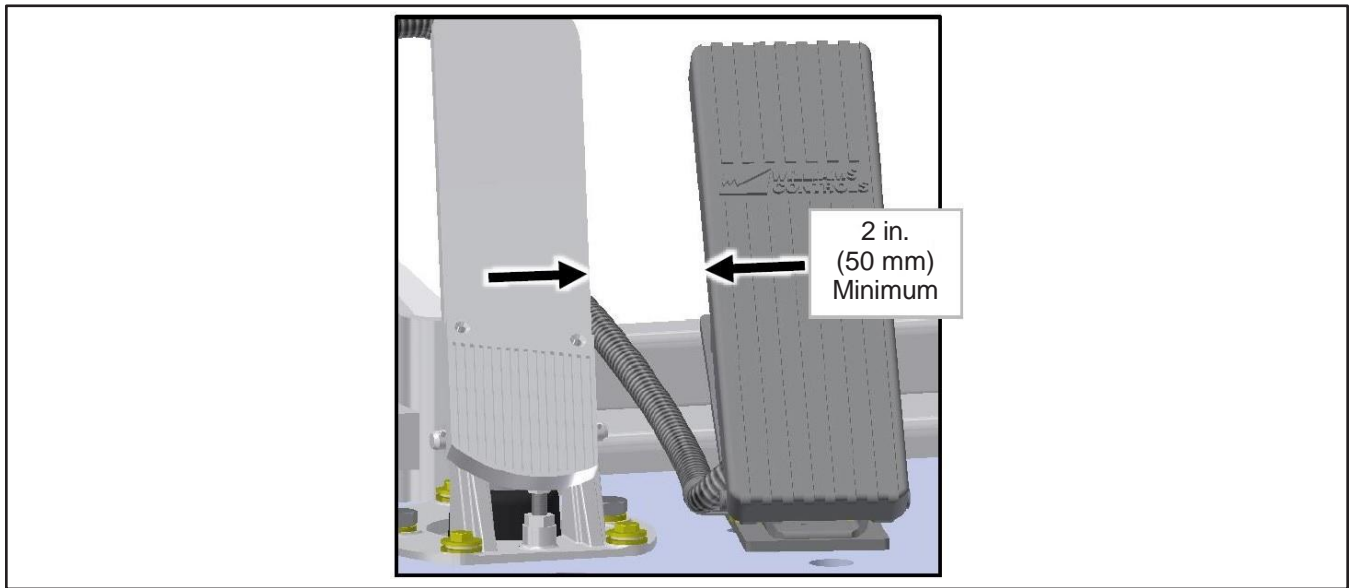

Figure 6 - Minimum Distance Between Brake and Accelerator Pedals

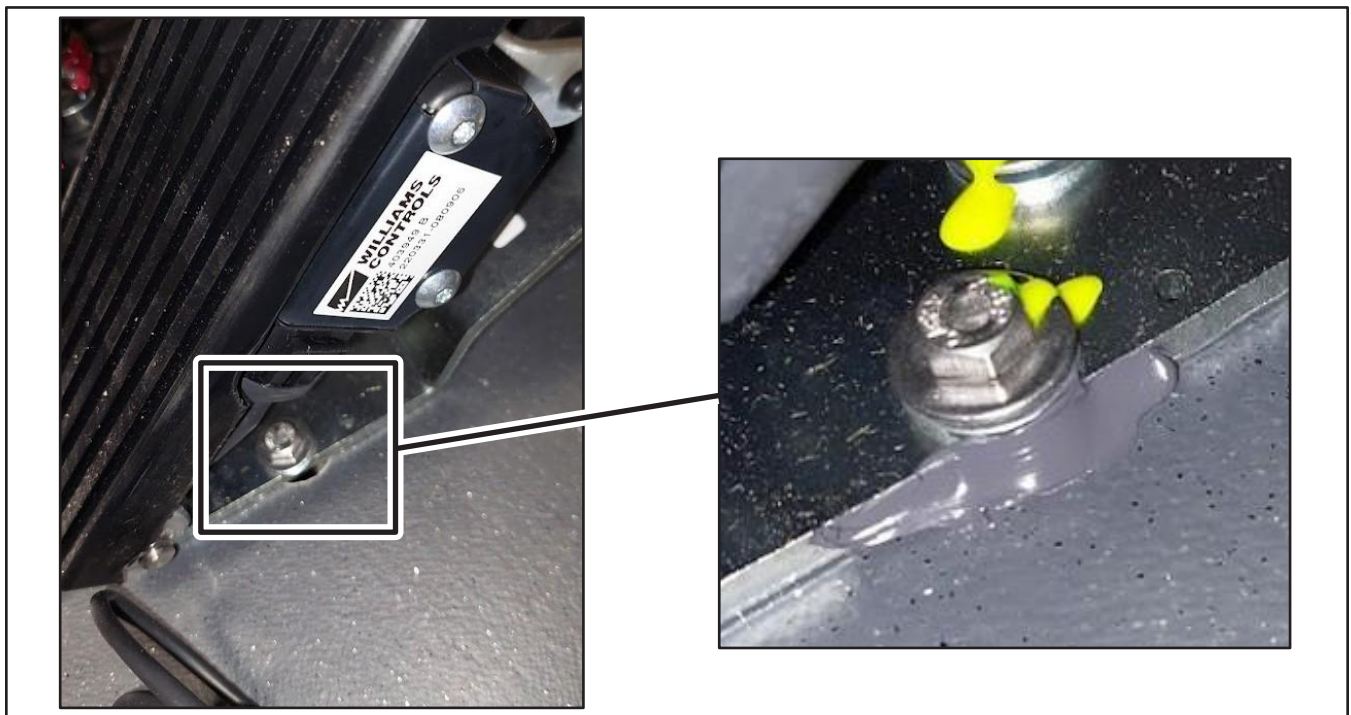

Figure 7 - Seal any Floor Opening and Around Pedals (Typical)