



STAR ONLINE PUBLICATION



Case Number: S2308000093

Release Date: July 2023

Symptom/Vehicle Issue: Electric Start-Stop (ESS) Inoperative, Instrument Panel Cluster (IPC) Displays a Warning Message “ESS Not Available”

Owner Complaint/Technician Observation: The owner complains the vehicle’s start-stop system does not operate. The IPC displays a message “ESS Not available”. The technician viewed the vehicle is setting Diagnostic Trouble Code (DTC) P152F Hood Switch 2 / Hood Switch 1 Correlation.

Discussion: Inspect the hood switch and striker location as shown below for a missing or mispositioned striker. Replace the striker as needed, test the operation, and clear the Diagnostic Trouble Code (DTC) once stored Pg 1 and 2.

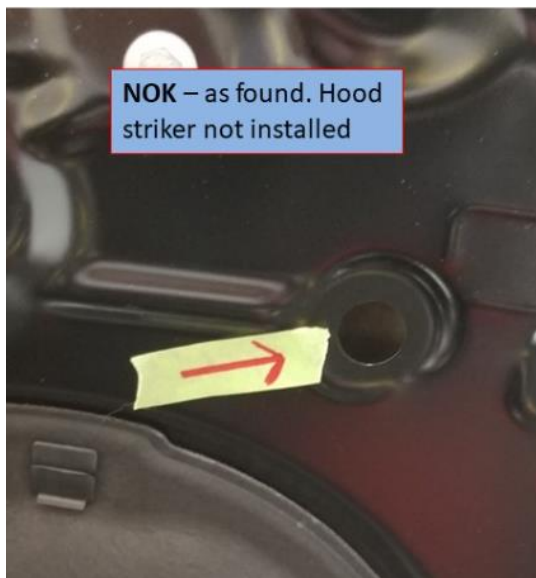

Pg 1

This document does not authorize warranty repairs. This communication documents a record of past experiences. STAR Online does not provide any conclusions about what is wrong with the vehicle. Rather, it captures all previous cases known that appear to be similar or related to the vehicle symptom / condition. You are the expert, and you are responsible for deciding on the appropriate course of action.

Contact STAR Center, or your Technical Assistance Center Via TechCONNECT or eCONTACT ticket if no solution is found



STAR ONLINE PUBLICATION

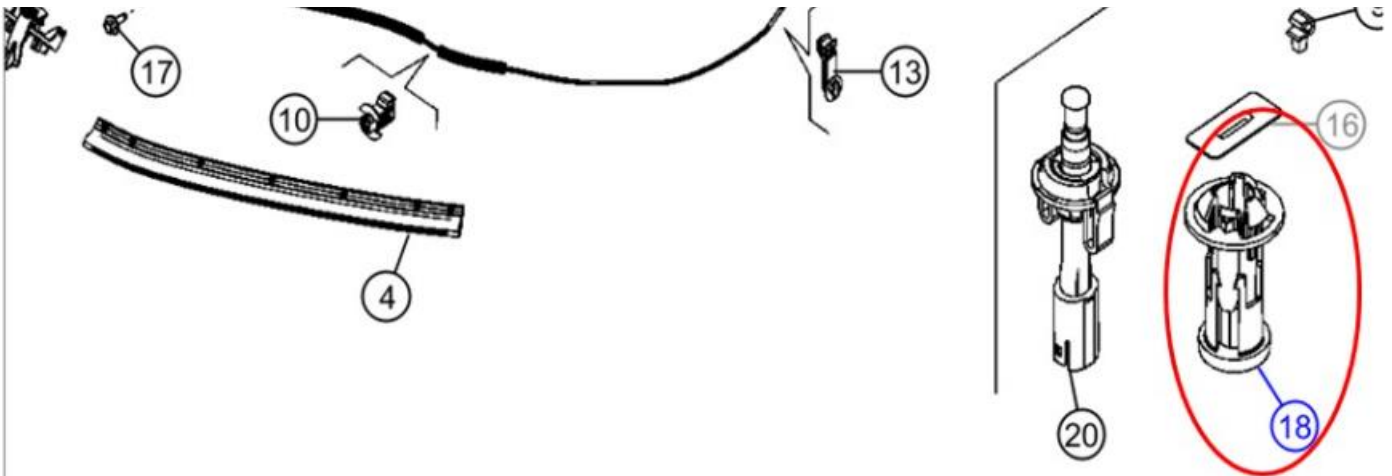

Item	Description (Double Click to add part to Exchange List)	Part Number	Notes	Qty	Super	Tech	Info	Media
10	CLIP, Attaching	04779913AA	<input type="checkbox"/>	1	<input checked="" type="checkbox"/>			
11	CLIP, Attaching	68303810AA	<input type="checkbox"/>	7				
12	PUSH PIN	68201741AA	<input type="checkbox"/>	2				
13	RETAINER, Cable	68320199AA	<input type="checkbox"/>	1				
14	CABLE, Hood Release	68607294AA	<input type="checkbox"/>	1				
15	STRIKER, Hood Latch	68607047AA	<input type="checkbox"/>	1				
16	PLUG, (NOT SERVICED)		<input type="checkbox"/>					
17	SCREW	06509275AA	<input type="checkbox"/>	3				
18	STRIKER, Hood Ajar Switch	68417561AA	<input type="checkbox"/>	1				

This document does not authorize warranty repairs. This communication documents a record of past experiences. STAR Online does not provide any conclusions about what is wrong with the vehicle. Rather, it captures all previous cases known that appear to be similar or related to the vehicle symptom / condition. You are the expert, and you are responsible for deciding on the appropriate course of action.

Contact STAR Center, or your Technical Assistance Center Via TechCONNECT or eCONTACT ticket if no solution is found