



STAR ONLINE PUBLICATION



Case Number: S2323000054

Release Date: July 2023

Symptom/Vehicle Issue: Buzz Squeak Rattle (BSR) Noise While Driving From Upper Forward Dash Area.

Discussion: Noise from the upper dash area could be from either side of the front cowl bulkhead. Be sure to check fastener torque on the strut tower brace in addition to inspecting the interior dash items.

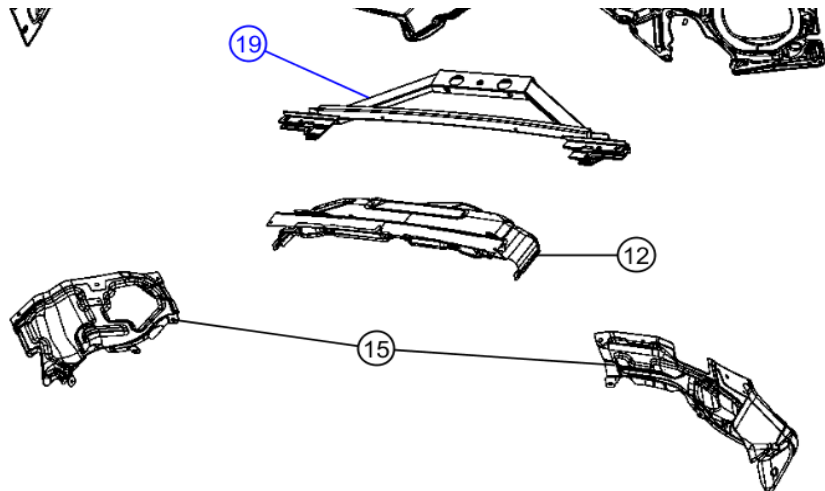

Item	Description (Double Click to add part to Exchange List)	Part Number	Notes	Q
19	BRACE, Shock Tower	68448162AA		
		68448162AA		

This document does not authorize warranty repairs. This communication documents a record of past experiences. STAR Online does not provide any conclusions about what is wrong with the vehicle. Rather, it captures all previous cases known that appear to be similar or related to the vehicle symptom / condition. You are the expert, and you are responsible for deciding on the appropriate course of action.

Contact STAR Center, or your Technical Assistance Center Via TechConnect, eCONTACT or Service Library entry if no solution is found.



STAR ONLINE PUBLICATION



Tip: Use chassis ears to aid in regionalizing the source of a noise. Spread the sensor ears out across a wide area of the suspect noise. Then move the ears closer and closer to the loudest signal. In the event your chassis ears are damaged or missing it may be possible to use a stethoscope or even a heater hose length of tubing held to your ear to help narrow down location. In addition, BSR noises can also transmit through bulkheads or panels. Investigate fasteners on both sides of a panel if noise is detected near a separation such as interior and engine compartment or interior to under chassis.

This document does not authorize warranty repairs. This communication documents a record of past experiences. STAR Online does not provide any conclusions about what is wrong with the vehicle. Rather, it captures all previous cases known that appear to be similar or related to the vehicle symptom / condition. You are the expert, and you are responsible for deciding on the appropriate course of action.

Contact STAR Center, or your Technical Assistance Center Via TechConnect, eCONTACT or Service Library entry if no solution is found.