



INSTRUCTION TO SERVICE

ITS: 60778		DATE 8/9/2023
SECTION:	549U – MCC Cable Installation	
WRITTEN BY:	Daniel Tice	
SUBJECT:	MCC Cable and Bracket Rework	
ISSUE:	MCC Cable Rubs Bracket at Side Screens	
SUMMARY:	Replace Bracket and Apply Self Fusing Tape to Damaged Cable Areas	

ITS60778

Ref. NHTSA Recall No.	Ref. Transport Canada Recall No.
Not Applicable	Not Applicable

THIS ITS DOCUMENT SHOULD BE RETAINED AND REFERRED TO FOR FUTURE MAINTENANCE UNTIL THE NEW FLYER PARTS AND/OR SERVICE MANUAL IS UPDATED TO REFLECT WORK DONE AS A RESULT OF THIS DOCUMENT. ENSURE THAT THIS DOCUMENT IS AVAILABLE FOR PARTS AND MAINTENANCE STAFF GOING FORWARD.

PROCEDURE:

1. Ensure to apply the parking brake.
2. Turn the main battery disconnect switch to the “OFF” position.
3. Ensure to wear the proper PPE and fall protection while work is performed.
4. Gain access to the roof MCC unit. See Figure 1.
5. Locate the existing MCC cable cover/bracket . See Figure 1.
6. Remove the exiting MCC cable cover/bracket hardware and set aside for re-installation. See Figure 1.
7. Discard existing bracket after removal.

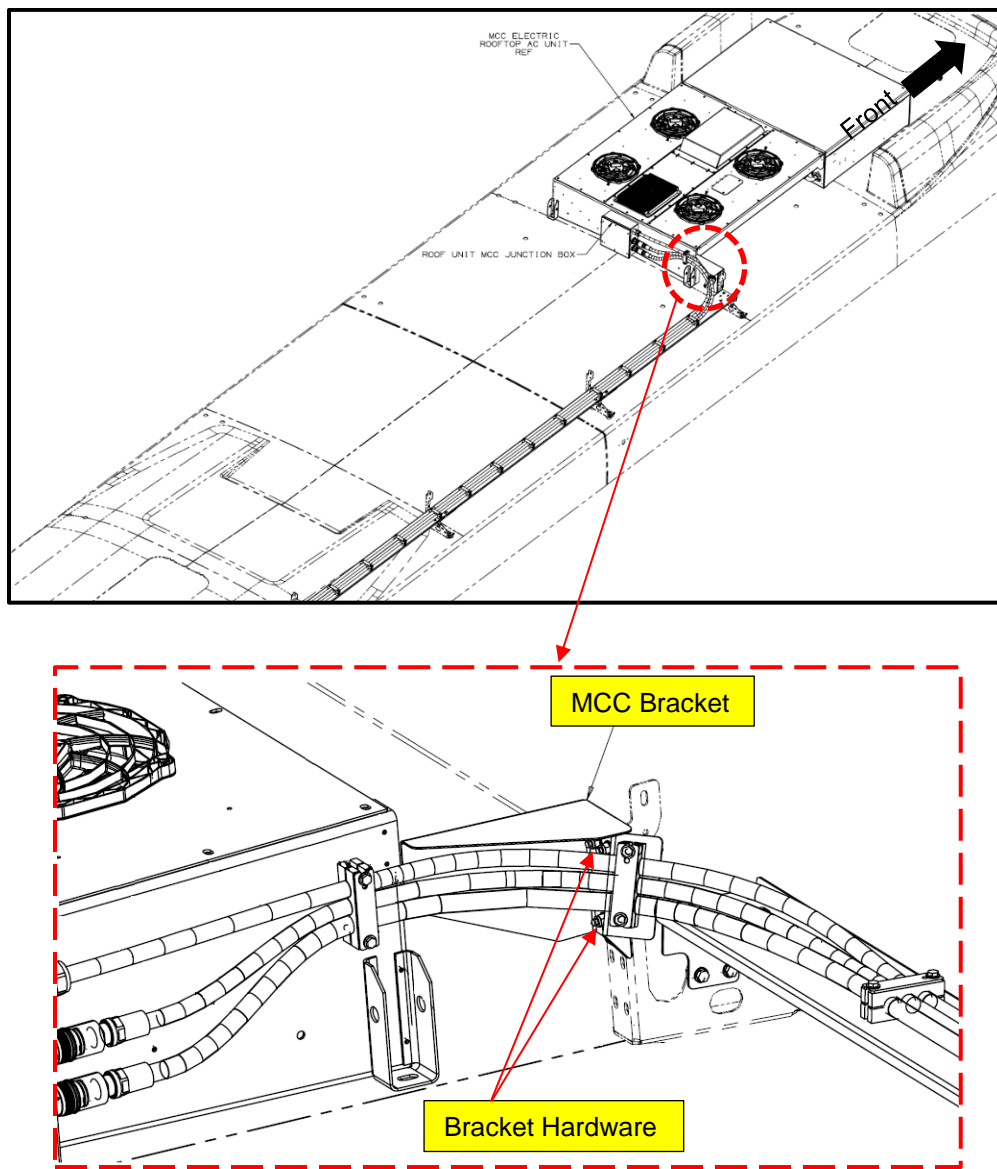

Figure 1: MCC cable cover bracket location reference.

8. Inspect the upper cable for damage or chafing to the cable sheathing surface. See photos below to determine if chafing is present and at what level. See Figure 2.
9. If no chafing or damage has occurred move to step 13 bracket replacement steps in this ITS.
10. If more than surface chafing is present as shown below report the bus number to your RPSM. See Figure 2.

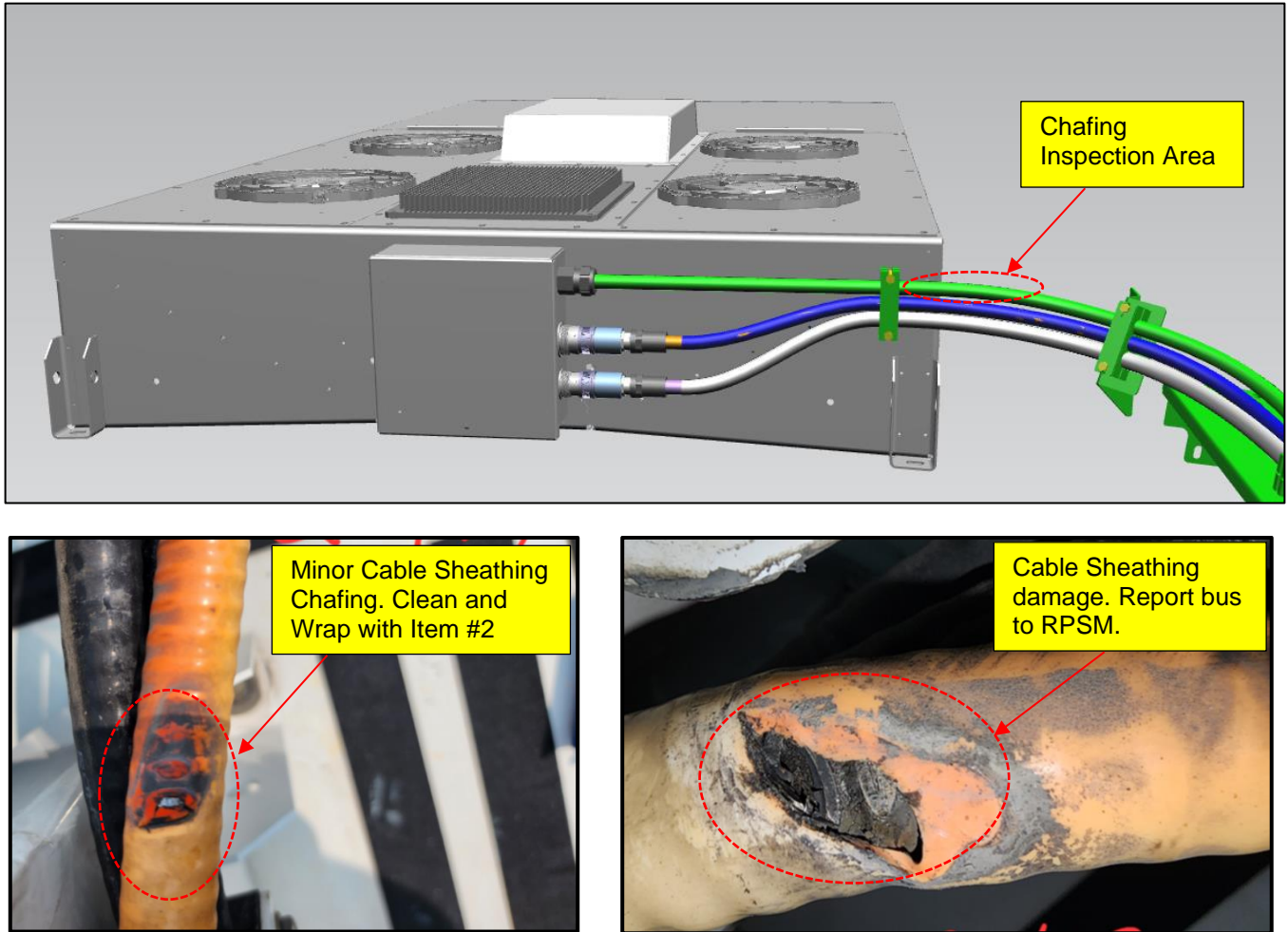

Figure 2: MCC cable cover chafing inspection location reference.

11. If minimal surface chafing is present clean the section of cable where surface chafing has occurred about four inches on each side of the damaged area using electrical contact cleaner item #1 and a lint free dry cloth. See Figure 3.
12. Starting four inches away from the area with chaffing wrap self-fusing tape item #2 over the area ending four inches on the other side. See Figure 3.



Item	Part Number	Description
1	3824510-101	Contact cleaner
2	947924	Tape Self-Fusing 1"

Figure 3: MCC cable chafing repair location reference.

13. Install the MCC cable cover/bracket item #3 with the existing hardware. See Figure 4.
14. Remove all tools and debris.
15. Turn the main battery disconnect switch to the "ON" position and return to service.

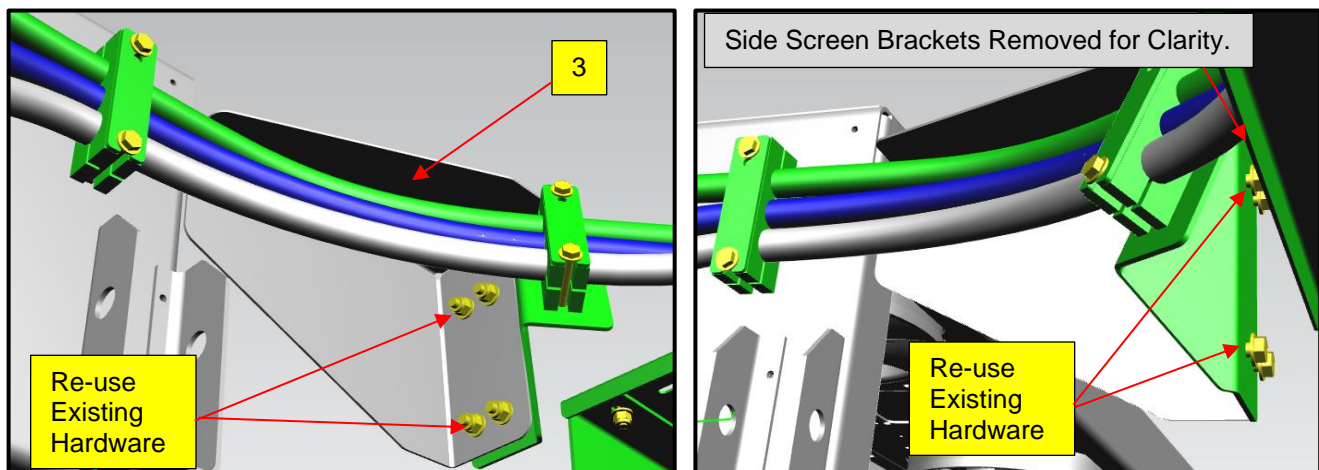

Item	Part Number	Description
3	1039881	Cover HV Cable

Figure 4: New MCC cable cover bracket location reference.



LABOUR ESTIMATE				
	Operation	Number of Technician(s)	Hours	Labor Time T X HR
1	Replace MCC Bracket and Apply Self Fusing Tape	1	.5	.5

PARTS REQUIRED					
Item	Part Number	Description	Qty. per Coach	Units	Notes
1	3824510-101	Contact cleaner	0.010	EA	
2	947924	Tape Self-Fusing 1"	3	FT	
3	1039881	Cover HV Cable	1	EA	

SPECIAL TOOLS REQUIRED					
Item	Part Number	Description	Qty.	Units	Notes