



FIELD KIT

Vermeer Corporation

Environmental
Pella, Iowa 50219 USA

FIELD CAMPAIGN KIT #:	IK004348	DATE:	22 August 2023
For Dealer Reference: Service Bulletin #: SVC2023-099			

Axle Components Incremental Improvement to Life

CAMPAIGN TYPE:	Customer Choice/Enhancements
CAMPAIGN CATEGORY:	Kit and Bulletin

MACHINE/ ATTACHMENT MODEL(S):	SERIAL NUMBERS:		
	Included	Excluded	Kit version
BC1000XL	5001 – 27195 Narrow Axles only	5001 – 27195 Wide Axle Machines	IK01

Purpose: Update axle components for incremental improvement to component life (IK004348).

This kit includes parts and instructions to add spacers on axle mounting.

Special tools and conditions:

- None

Shutdown procedure: BC1000XL



WARNING: Raised load can shift or fall. Death or serious injury could be possible if struck or crushed by falling load. Never allow anyone under a raised load unless load is securely supported to prevent it from shifting or falling.

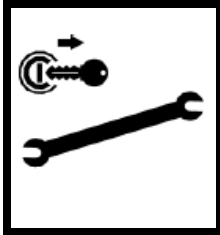

WARNING: Failure to use shutdown procedure can result in unexpected hazard(s). Death or serious injury could result due to entanglement, crushing, cutting, or other hazardous contact. Follow shutdown procedure after operating, before performing any service or maintenance, and before transporting.

Stopping the machine

NOTICE: For your safety and the safety of others, use the shutdown procedure before working on the machine for any reason, including servicing, cleaning, unclogging, inspecting or transporting the chipper.

A variation of this procedure may be used if so instructed within this manual, or if an emergency requires it.

1. Return upper feed control bar to top stop position.
2. Slow the engine speed to low idle.

NOTICE: Whenever practical and safe, allow engine to idle for one to five minutes before shutting down after operating at full power. Please consult machine's engine manual for details.

3. Wait for cutter drum to slow.
4. Place clutch lever in the disengaged position.
5. Turn ignition key to off position.
6. Wait for cutter drum and belt to stop.

NOTICE: Cutter drum rotation can be checked by looking at the end of the shaft (1) on the left side of the cutter wheel housing. The cutter drum will continue to turn for a short time after the engine has stopped.

7. Remove ignition key.
8. Close and latch feed table.



Unless indicated, new parts from kit have callouts with numbers. Callouts with letters indicate existing parts or general items.

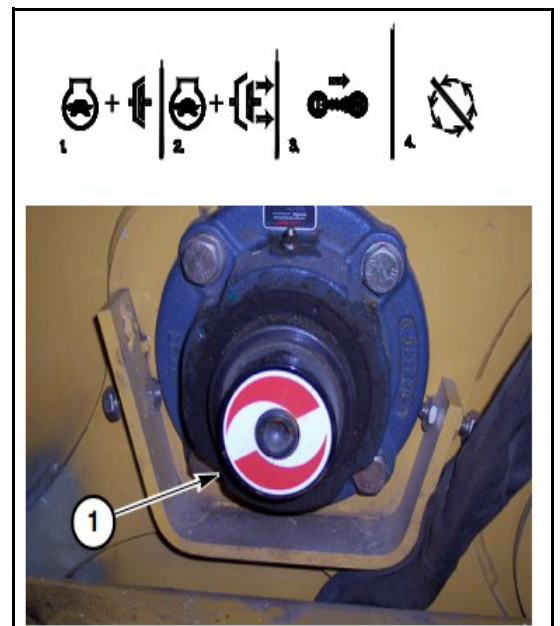

Procedure 1:

1. Remove and discard four screws **(A)** and four nuts **(B)** that fasten axle to mainframe. Repeat on other side of mainframe assembly.

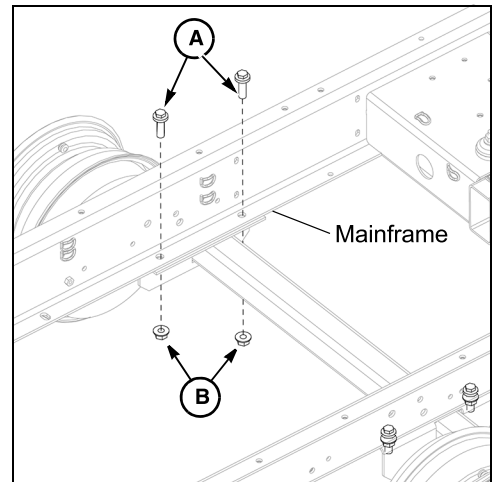

2. Add one support frame mount **(1)** to top of mainframe. Repeat on other side of mainframe assembly.

Note orientation of holes to frame. These spacers are mounted on top of the mainframe z-channel.

3. Add two chamfered spacers **(2)** to bottom of axle hanger. Repeat on other side of mainframe assembly.

Note which side chamfer is on. This is for clearance in the radii of the axle hanger.

4. Add two new screws **(3)** to reattach axle to mainframe. Repeat on other side of mainframe with the other two screws.
5. Fasten each screw with four washers **(4)** and four nuts **(5)** and torque bolts to 196 ft-lbs (266 Nm).
6. Remove Figure 1 and attach to invoice or place in manual storage box so unit owner can place with existing parts manual.

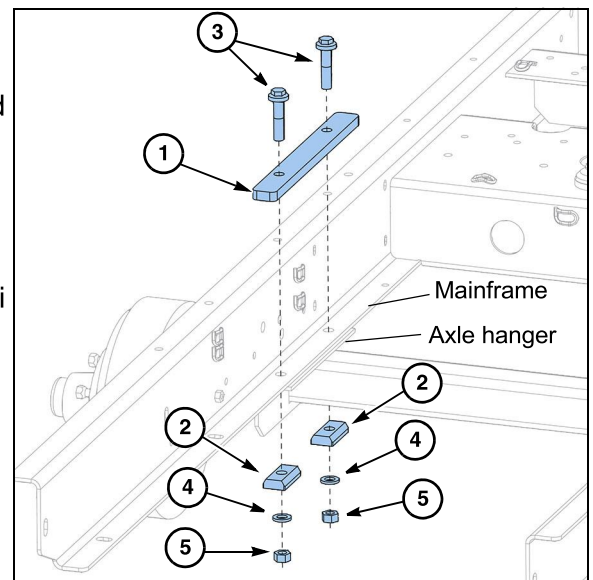

UNIT OWNER COPY
 Insert into parts manual
 for future reference.

Figure 1

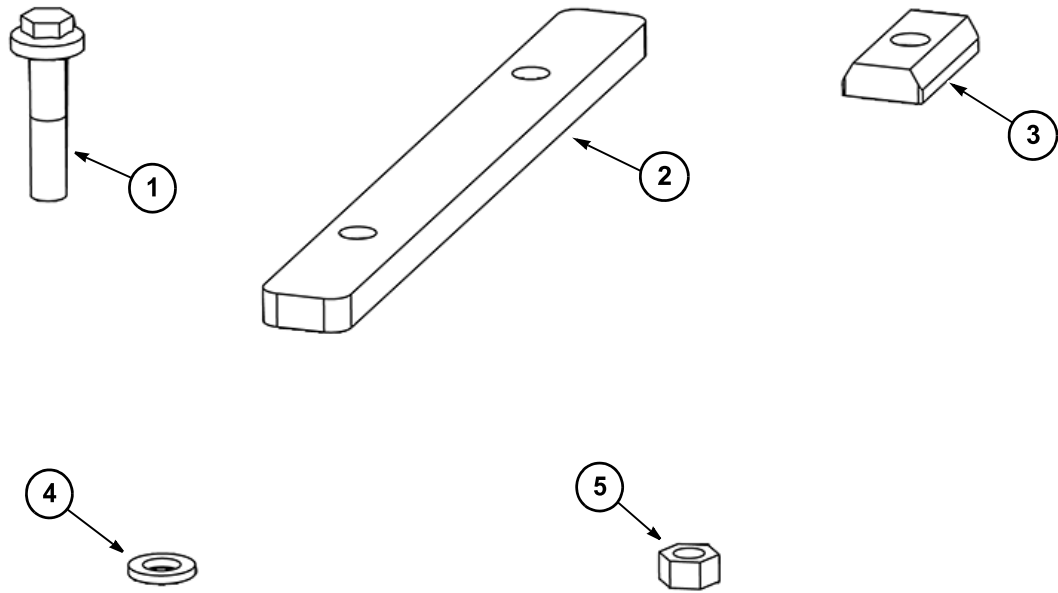

Figure 1 parts list

<u>REF. NO.</u>	<u>PART NO.</u>	<u>DESCRIPTION</u>	<u>IK01 QTY.</u>
1	507614070	SCREW-HFS-M16-2.00X70-10.9	4
2	163709837	SUPPORT FRAME MOUNT	2
3	163835121	SUPPORT FRAME MOUNT SPACER - CHAMFERED	4
4	508486016	WASHER-FLATHARD-M16-17.0X30.0-4.0-D6916	4
5	507090016	NUT-HEX-M16-2.00-10	4
		Kit includes all items in Figure 1 parts list.	