

Symptom in Grey Cast Disc Brakes - Scrapping Noises from the Front Axle Area (SY 46/23)

Vehicle Type: **Taycan (Y1A) / Taycan 4S (Y1A) / Taycan GTS (Y1A)
Taycan 4 (Y1B) / Taycan 4S (Y1B)
Taycan (Y1C) / Taycan 4S (Y1C) / Taycan GTS (Y1C)**

Model Year: **As of 2020**

Equipment: Front disc brakes, standard (M-No. 1LS/1LR)

Concerns: **Front disc brakes (grey cast iron)**

Symptom: The customer complains about a scrubbing noise coming from the front axle area, particularly at low speed and when the brake is not pressed.

Cause: A slight tolerance deviation in the contact pattern and/or a slight lateral runout of the brake discs results in sound transmission via the steering column into the vehicle passenger compartment.

Remedial Action: Retrofit a balance weight on the universal joint of the steering column in order to dampen sound transmission. Also check brake discs on the front axle for tolerance deviations, lateral runout and hotspots and replace them if necessary.

Required tools

- Tools:
- V.A.G 1783 - Torque wrench 2-10 Nm (1.5-7.5 ftlb.)
 - V.A.G 1332A - Torque wrench, 40-200 Nm (30-148 ftlb.)
 - 9510/1 - 9510/1 - Adapter plate
 - VAS 6079 - Dial gauge
 - VAS 6079/1 - Dial Gauge Holder for Brake Discs

Required parts and materials

Parts Info:	Part No.	Designation – Location	Quantity
	9J1419647B	⇒ Balance weight (half bodyshell) – Intermediate steering shaft	1 piece
	9J1419647C	⇒ Balance weight (half bodyshell) – Intermediate steering shaft	1 piece

PAF104882	⇒ Internal hexagon round/oval-head screw (M5 x 20) – Balance weights	2 pieces
9Y0615301Q	⇒ Brake disc – Left front axle, 18-inch (M-No. A8F, 1LR, 1LS, EOW)	1 piece
9Y0615302Q	⇒ Brake disc – Right front axle, 18-inch (M-No. A8F, 1LR, 1LS, EOW)	1 piece
	or	
9J1615301A	⇒ Brake disc – Left front axle, 17-inch (M-No. A8C, 1LS)	1 piece
9J1615302A	⇒ Brake disc – Right front axle, 17-inch (M-No. A8C, 1LS)	1 piece
9J1698151J	⇒ 1 set of brake pads for disc brakes – Front axle	1 piece
PAF004571	⇒ Collared cheese head bolt with multiple-tooth head, M14 x 1.5 x 115 – Brake calliper, 17-inch (M-No. A8C, 1LS)	2 pieces
	or	
PAF004572	⇒ Collared cheese head bolt with multiple-tooth head, M14 x 1.5 x 135 – Brake calliper, 18-inch (M-No. A8F, 1LR, 1LS)	2 pieces
9A769826900	⇒ Retainer spring – Brake pads	1 piece
N 90799102	⇒ Countersunk screw with internal serration, self-locking (M18 x 1.5 x 18) – Steering wheel	1 piece
WHT004955A	⇒ Internal hexagon round-head cheese head bolt – Brake discs	2 pieces
	additional parts only required in certain cases	
971907253	⇒ Sender wire – Brake pads	

Material: **Required materials** (usually already available at the Porsche Center):

Part No.	Designation	Quantity
00004330508	⇒ Mounting paste (100 gram tube)	4 grams

Preparatory work

Work Procedure: 1 Remove front wheels.
⇒ *Workshop Manual '440519 Removing and fitting wheel'*

Check front brake discs and replace brake discs and pads if necessary

Work Procedure: 1 Check contact pattern and lateral runout of front brake discs.
For instructions, see: ⇒ *Workshop Manual '465002 Checking front brake discs'*

Assessment	Action
Contact pattern and lateral runout of the brake disc OK	Retrofitting balance weight ⇒ <i>Technical Information '465002 Retrofitting balance weight'</i>
Contact pattern and/or lateral runout of the brake disc not OK	Replace brake discs and brake pads. For work procedure, see: ⇒ <i>Workshop Manual '465019 Removing and installing front brake disc'</i> and Retrofit balance weight. ⇒ <i>Technical Information '465019 Retrofitting balance weight'</i>

Retrofitting balance weight



Information

When installing the balance weights, the steering must necessarily be in the straight-ahead position.

Work Procedure: 1 Disconnect steering column from universal joint.
For instructions, see: ⇒ *Workshop Manual '481519 Removing and installing steering column'*



Information

When screwing on the balance weights, first screw in both screws and then tighten them to prevent the half shells from tilting.

2 Install balance weights on the steering wheel side ⇒ *Assembling balance weight -1-* at the universal joint and tighten screws.

Tightening torque 6 Nm (4.4 ftlb.)

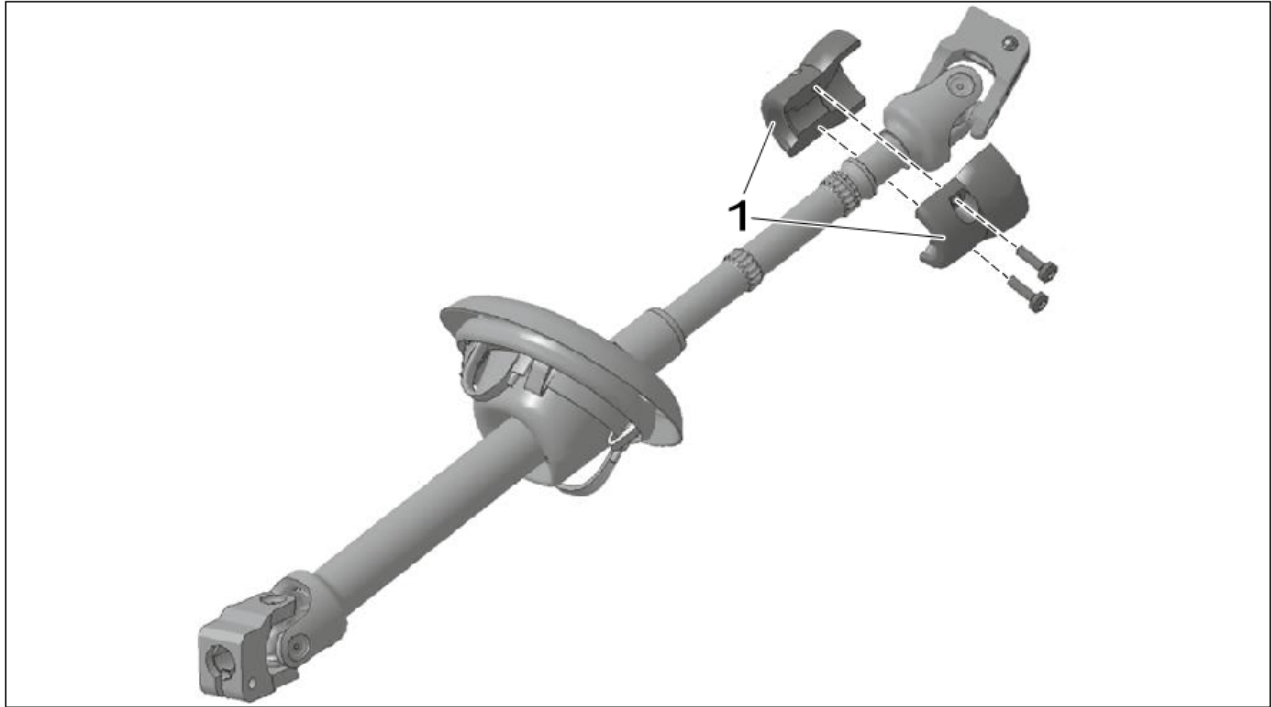

Assembling balance weight

Follow-up actions

- Work Procedure: 1 Install steering column.
For instructions, see: ⇒ *Workshop Manual '481519 Removing and installing steering column'*
- 2 Install front wheels.
⇒ *Workshop Manual '440519 Removing and fitting wheel'*

Labor position and PCSS encryption

Labor position:

APOS	Labor operation	I No.
46505048	Reworking disc brake	
46505049	Reworking disc brake	

PCSS encryption:

Location (FES5)	46500	Front brake disc
Damage type (SA4)	1316	rubbing

Important Notice: Technical Bulletins issued by Porsche Cars North America, Inc. are intended only for use by professional automotive technicians who have attended Porsche service training courses. They are written to inform those technicians of conditions that may occur on some Porsche vehicles, or to provide information that could assist in the proper servicing of a vehicle. Porsche special tools may be necessary in order to perform certain operations identified in these bulletins. Use of tools and procedures other than those Porsche recommends in these bulletins may be detrimental to the safe operation of your vehicle, and may endanger the people working on it. Properly trained Porsche technicians have the equipment, tools, safety instructions, and know-how to do the job properly and safely. Part numbers listed in these bulletins are for reference only. The work procedures updated electronically in the Porsche PIWIS diagnostic and testing device take precedence and, in the event of a discrepancy, the work procedures in the PIWIS Tester are the ones that must be followed.

© 2023 Porsche Cars North America, Inc.