

REFERENCE:	TSB: 07-004-23 GROUP 07 - Cooling	Date:	May 2, 2023	REVISION:	-
VEHICLES AFFECTED:	2022 - 2023 (JL) Jeep Wrangler This bulletin applies to vehicles built on or after August 01, 2022 (MDH 0801XX) and on and before November 07, 2022 (MDH 1107XX) equipped with a 6.4L V8 SRT Hemi MDS Engine (Sales Code ESG).	MARKET APPLICABILITY:			
		<input checked="" type="checkbox"/> NA		<input checked="" type="checkbox"/> MEA	
		<input type="checkbox"/> SA		<input type="checkbox"/> IAP	
		<input type="checkbox"/> EE		<input type="checkbox"/> CH	
CUSTOMER SYMPTOM:	Coolant Leak.				
CAUSE:	Weak seam in the overflow coolant bottle.				

This Technical Service Bulletin (TSB) has also been released as a Rapid Service Update (RSU) 23-121, date of issue May 02, 2023. All applicable RSU VINs have been loaded. To verify this RSU service action is applicable to the vehicle, use VIP or perform a VIN search in DealerCONNECT/Service Library. All repairs are reimbursable within the provisions of warranty. This RSU will expire 18 months after the date of issue.

REPAIR SUMMARY:

This bulletin involves inspection the overflow coolant bottle for leaks and replacing it if needed.

CLAIMS DATA:

Labor Operation No:	Labor Description	Skill Category	Labor Time
07-30-45-9C	Reservoir/Tank, Coolant Overflow - Inspect (0 – Introduction)	07 - Cooling	0.2 Hrs.
07-30-45-9D	Reservoir/Tank, Coolant Overflow - Inspect and Replace (0 – Introduction)	07 - Cooling	0.5 Hrs.
Failure Code	ZZ	Service Action	

SPARE PARTS:

Qty	Part No.	Description	Notes
1 (AR)	68519243AA	Reservoir/Tank, Coolant Overflow	
(AR)	68163848AB	Engine Coolant	

DIAGNOSIS:

Using a Scan Tool (wiTECH) with the appropriate Diagnostic Procedures available in DealerCONNECT/Service Library, verify all related systems are functioning as designed. If DTCs or symptom conditions, other than the ones listed above are present, record the issues on the repair order and repair as necessary before proceeding further with this bulletin.

If a customer's VIN is listed in VIP or your RSU VIN list, perform the Inspection Procedure. **This RSU only applies to vehicles on the RSU VIN list.**

1. **For Unsold vehicles:** Proceed to [Step 1](#) of the Repair Procedure..
2. **For Sold vehicles:** Pressure test the cooling system and check for leaks around the seam of the overflow bottle. Refer to the detailed service procedures available in DealerCONNECT> Service Library under: 09 - Engine, 6.4L / Cooling System / Engine Cooling / Diagnosis and Testing, ([Fig. 1](#)) and ([Fig. 2](#)) .



Fig. 1
Coolant Leak Area



Fig. 2
Tight Seam, No Leaks

3. Is coolant leaking from the overflow bottle?
 - YES>>> Proceed to [Step 1](#) of the Repair Procedure.
 - NO>>> This bulletin has been completed. Use inspect LOP (07-30-45-9C) to close the active RSU.

REPAIR PROCEDURE:

1. Drain only the coolant overflow tank and reuse as much coolant as possible.

NOTE: It is not necessary to drain and fill coolant system, the overflow bottle can be drained only by the lower hose at the tank.

2. Replace the coolant bottle ([Fig. 3](#)) . Refer to the detailed service procedures available in DealerCONNECT> Service Library under: 09 - Engine, 6.4L / Cooling System / Engine Cooling / Bottle, Pressurized Coolant / Removal and Installation. **For reference only.**

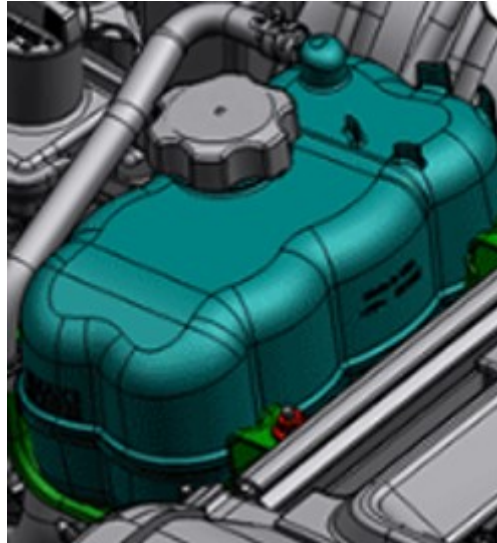

Fig. 3
Overflow Coolant Tank

3. Disconnect the coolant vent hose from the pressurized coolant bottle and detach the hose retainer.
4. Disconnect the lower coolant hose from the pressurized coolant bottle.
5. Remove the vacuum hose retainer from the pressurized coolant bottle bracket.
6. Remove the nuts and the pressurized coolant bottle.
7. If necessary, remove the bolt and the pressurized coolant bottle from the bracket.
8. Install the new coolant tank into position by connecting the lower coolant hose to the bottle first and then install the pressurized coolant bottle ([Fig. 3](#)) .
9. Install the nuts. Tighten to 10 N·m (89 In. lbs.).
10. Install the vacuum hose retainer to the pressurized coolant bottle bracket.
11. Reconnect the coolant vent hose to the pressurized coolant bottle and attach the hose retainer.
12. Fill the coolant overflow tank with the coolant saved and than top off as needed to specifications ([Fig. 3](#)) .

POLICY:

Reimbursable within the provisions of the warranty.

This bulletin is supplied as technical information only and is not an authorization for repair. No part of this publication may be reproduced, stored in a retrieval system, or transmitted, in any form or by any means, electronic, mechanical, photocopying, or otherwise, without written permission of FCA US LLC.