

REFERENCE:	Nova Bus Manuals
SECTION:	16: Electrical system
RS N°:	MQR 7621-2619
EFFECTIVE IN PROD.:	LF46 (2023JL)

APPLICATION DEADLINES: 2024AU01
CLAIM REFERENCE NUMBER: WB5432

SUBJECT:	Battery tray
JUSTIFICATION:	Battery tray may crack, new battery hold down required.

LEVEL	DESCRIPTION	DIRECT CHARGES		TIME
		LABOUR	MATERIAL	
1	Inspect the battery tray. Replace the battery holddown.	Nova Bus	Nova Bus	30 min
2	If required, readjust the tray support and retorque loose mounting bolts and apply medium strength thread adhesive.	Nova Bus	Client*	30 min

* The cost of the material will be reimbursed when claiming for this service document.

MATERIAL REQUIRED PER VEHICLE

QTY	PART N°	REV.	DESCRIPTION
LEVEL 1			
3	N108682	–	Block Battery Holddown
LEVEL 2 (only if required**)			
–	–	–	–

Materials will be available within 37 days once your order has been placed.

To order, please contact novabus.parts@volvo.com

Or by phone for CANADA 1-800-771-6682, for USA 1-877-999-8808

Specify document number, quantity of parts required and shipping address.

**The material identified in Level 2 is to be ordered only for vehicles that meet the criteria defined in Level 1.

DISPOSAL OF PARTS

REMOVED PARTS ARE:	DISCARDED	RETAINED	* Dispose of the unused parts and the defective parts in accordance with local environmental standards in effect.
	*		
	Yes	–	

REVISION HISTORY

REV.	DATE	CHANGE DESCRIPTION	WRITTEN BY
NR	2023JN14	Initial release	André Pelletier

APPROVED BY:

PAGE 1 OF 8

CLIENT	ORDER	ROAD NUMBER		VIN (2NVY/4RKY...)		QTY
		FROM	TO	FROM	TO	
Maryland Transit Administration - MTA	LE53	22001	22070	L82JXN9778526	L82J4N9778604	70



WARNING

FOLLOW YOUR INTERNAL SAFETY PROCEDURES.



#1 Inspection

- Inspect bottom of battery tray for cracks
- If cracked, contact Nova rep
- If not cracked, continue procedure

#2 Torque hinge bolts

- Add blue Loctite to threads
- Torque all 4 bolts to 33Nm
- Add torque seal to bolt heads

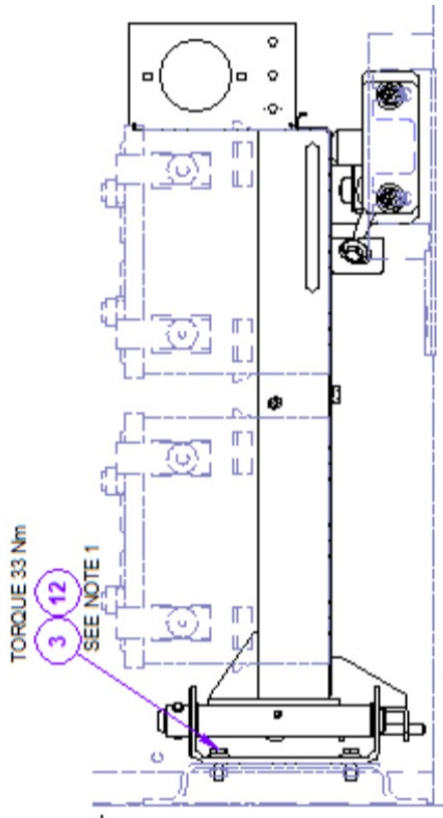

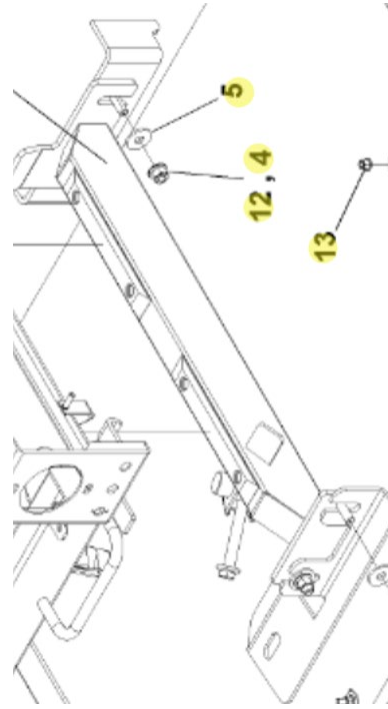

#3 Inspect Support Arm

- Ensure support arm is contacting bottom of battery tray
- Adjust, if necessary
- Torque bolts to 33Nm
- Add torque seal to nuts



**Ensure support arm is contacting
bottom of battery tray**

- Remove existing hold downs
- Inspect battery cables and posts for damage
- Replace if damaged



#4 Inspect Battery cables and posts



#5 Replace hold downs



- Install new hold downs
- Torque to 7Nm
- Add torque seal