



SAFETY RECALL BULLETIN

SUBJECT: LANCER PASSENGER SIDE FRONTAL AIR BAG INFLATOR - SAFETY RECALL CAMPAIGN - REVISED			No: SR-16-002REV2
			DATE: June 2023
			MODEL: 2006-07 Lancer
CIRCULATE TO:	<input checked="" type="checkbox"/> GENERAL MANAGER	<input checked="" type="checkbox"/> PARTS MANAGER	<input checked="" type="checkbox"/> TECHNICIAN
<input checked="" type="checkbox"/> SERVICE ADVISOR	<input checked="" type="checkbox"/> SERVICE MANAGER	<input checked="" type="checkbox"/> WARRANTY PROCESSOR	<input checked="" type="checkbox"/> SALES MANAGER

This Safety Recall bulletin supersedes SR-16-002REV, issued November 2018, to update the inflator returns section. Changes are italicized and indicated by ◀.

PURPOSE

This campaign bulletin instructs dealers to replace the passenger side frontal air bag inflator with a desiccated one, and return the subject air bag inflator per the instructions at the end of this bulletin.

BACKGROUND

Based upon a Defect Information Report submitted to the National Highway Traffic Safety Administration by TK Holdings (Takata), MMNA is recalling certain 2006-2007 Lancer vehicles.

Affected vehicles are equipped with a specific type of passenger side frontal air bag inflator provided by Takata that could be susceptible to rupture, due to excessive internal pressure, during a normal air bag deployment event. This condition is more likely to occur if the vehicle has been exposed to high levels of absolute humidity for an extended period of time.

AFFECTED VEHICLES

2006 - 2007 Lancer

IMPORTANT

Affected new or used inventory vehicles must be repaired before the vehicle is delivered. Dealers must check their inventory vehicles' VINs on the Warranty Superscreen to verify whether the vehicle is involved in this recall campaign. It is a violation of Federal law for a dealer to deliver a new motor vehicle or any new or used item of motor vehicle equipment (including a tire) covered by the notification under a sale or lease until the defect or noncompliance is remedied.

REQUIRED OPERATIONS

Before starting this campaign procedure, **CHECK THE WARRANTY SUPERSCREEN** to verify if the vehicle is an affected VIN for this campaign and that this campaign procedure has not already been completed.

The information contained in this bulletin is subject to change. For the latest version of this document, go to the Mitsubishi Dealer Link, MEDIC, or the Mitsubishi Service Information website (www.mitsubishitechinfo.com).

REQUIRED EQUIPMENT

- VCI (Vehicle Communication Interface) or VCI Lite - MB991824 or MB992744V.
- MEDIC Laptop/Tablet with A/C power adapter - MIT540031 or FZG1MK2.
- MUT-III main harness 'A' (blue connector at the DLC end) or MUT-III main harness 'B' (black connector at the DLC end) - MB991910V or MB992745V.
- USB 2.0 cable - MB991827V or RRAR1MBR108GL.

REMOVAL PROCEDURE

CAUTION Before starting work, and periodically while working on the vehicle, touch a metallic part of the vehicle to discharge static electricity.

WARNING Never attempt to disassemble or repair the air bag modules or clock spring. If faulty, replace it.

WARNING Do not drop the air bag modules or clock spring or allow contact with water, grease or oil. Replace it if a dent, crack, deformation or rust is detected.

WARNING The air bag modules should be stored on a flat surface and facing upward. Do not place anything on top of it.

WARNING Do not expose the air bag modules to temperatures over 93° C (200° F).

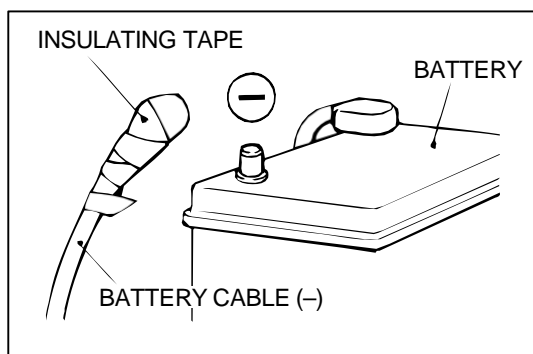

1. Record the radio station presets. Disconnect the negative (-) battery terminal and insulate the terminal with electrical tape.

WARNING Wait at least 60 seconds after disconnecting the battery cable before doing any further work to prevent accidental air bag deployment.

WARNING Battery posts, terminals, and related accessories contain lead and lead compounds. WASH HANDS AFTER HANDLING.



2. Remove the front left and right A-pillar trims.

3. Remove the instrument panel.

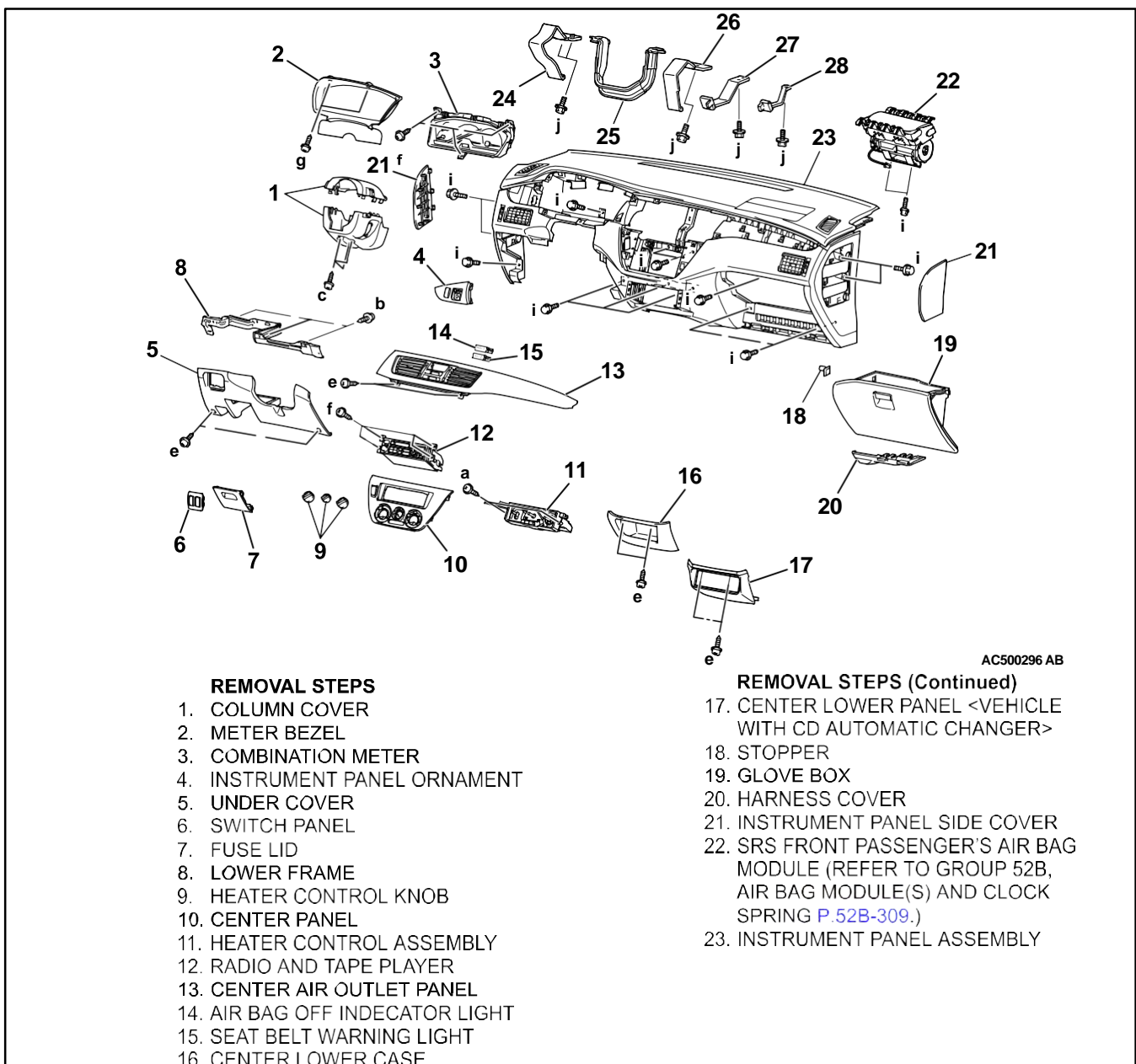

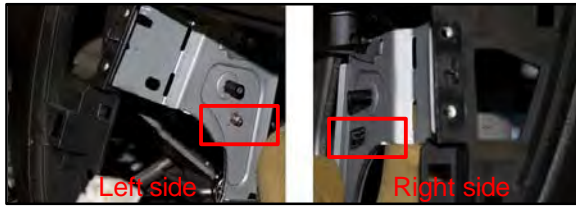

NOTE: Make sure the left and right wire harness clips, behind the radio, are disconnected prior to dash removal.



NOTE: Unbolt the ECM/PCM prior to dash removal.

CLIP AND CLAW POSITION

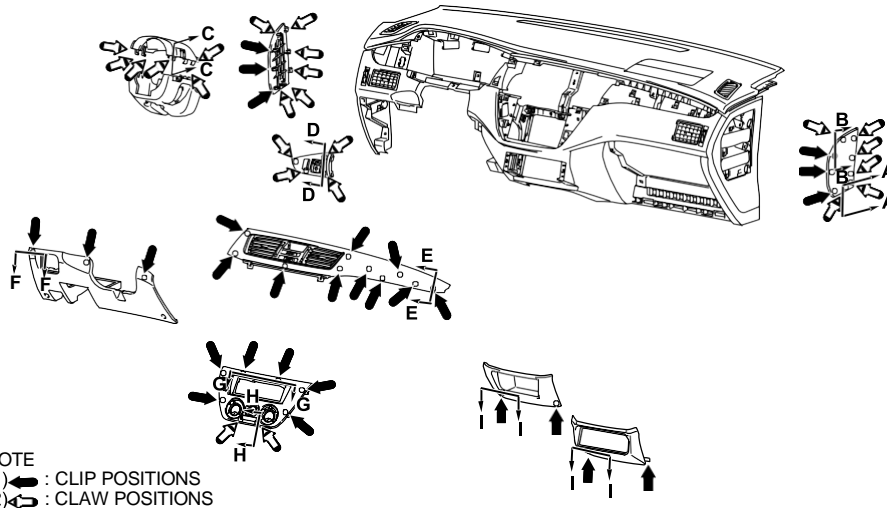

NOTE
 (1) : CLIP POSITIONS
 (2) : CLAW POSITIONS

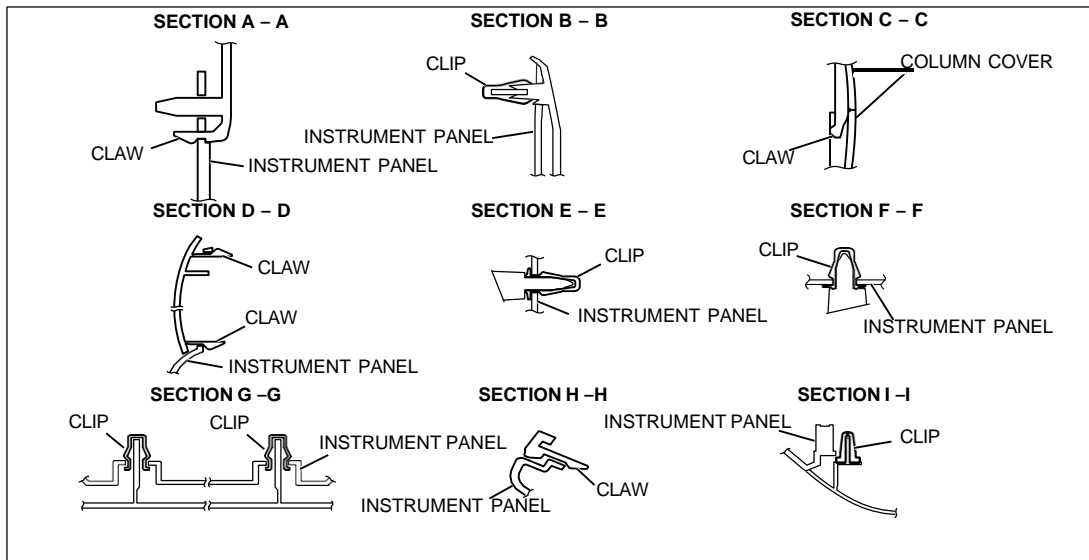

4. Remove the distribution duct from the instrument panel.

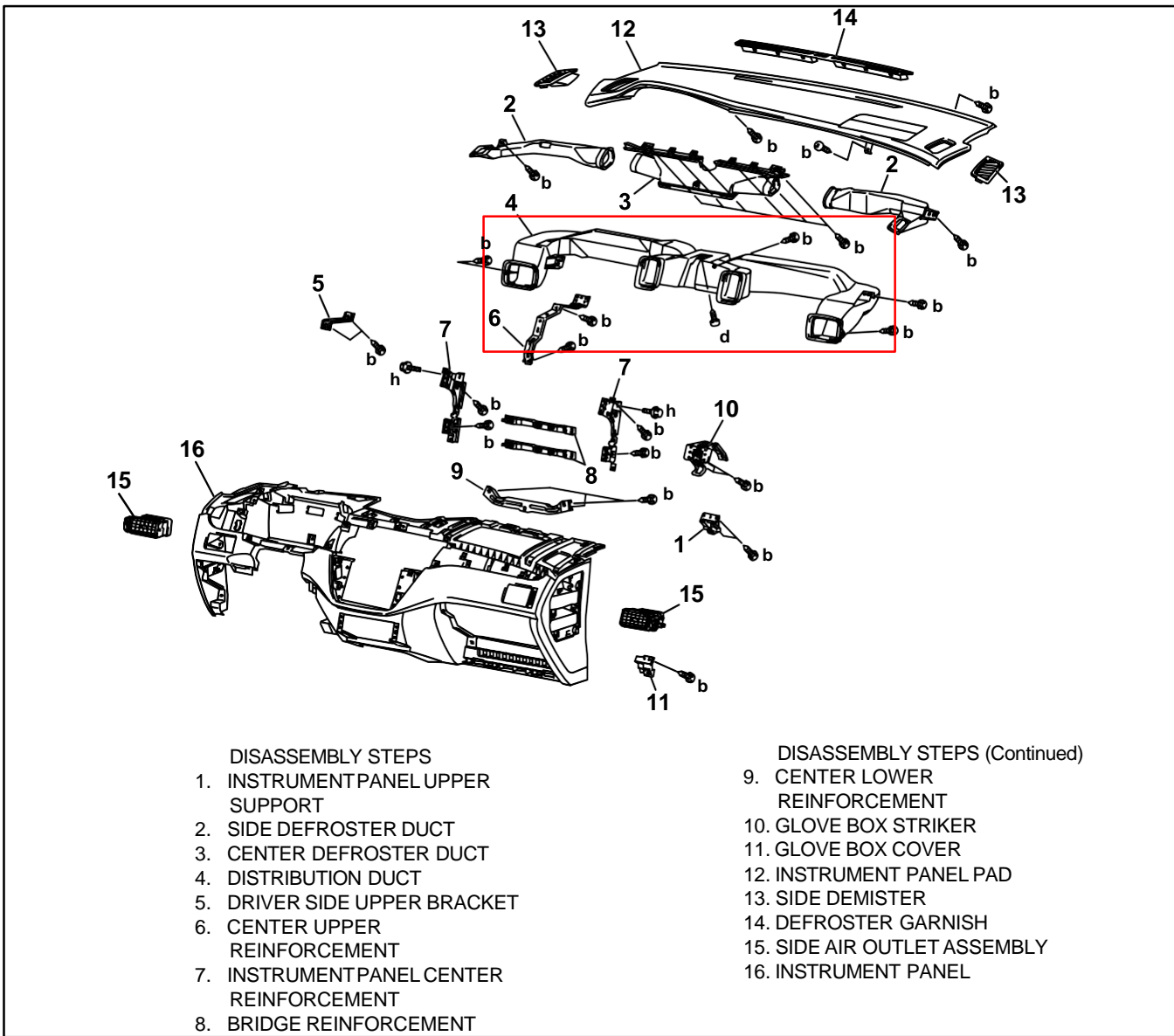

CAUTION

Do NOT damage the air bag or the instrument panel during air bag module removal.

INFLATOR REMOVAL



CAUTION: ELIMINATE STATIC ELECTRICITY
Before starting work, and periodically while working on the vehicle, touch a metallic part of the vehicle to discharge static electricity.

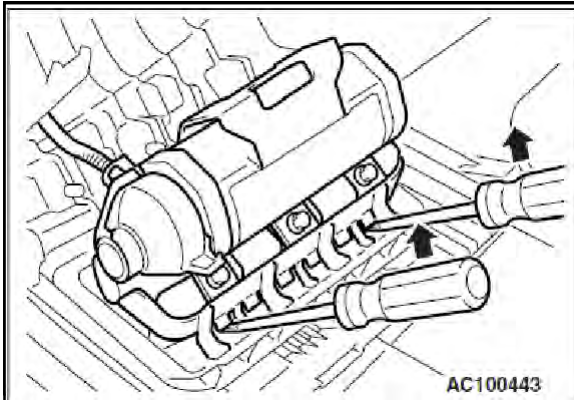

1. The front passenger side air bag module is secured to the instrument panel in a flexible plastic enclosure. Insert a flat head screwdriver and disengage the mounting hooks to dislodge the module from the enclosure.



2. Place the air bag module on a clean work bench covered with a new, clean, static-free cloth/sheet with the air bag facing down.

CAUTION

The air bag module, and especially the air bag component, must be protected from adhesive, dirt, dust and sharp items. The protective foam on the air bag module may be brittle. Ensure foam debris is immediately removed from the work area to maintain a contaminant-free work environment.



Prepare Air bag Inflator Kit Part No.: 7030A977

3. Confirm that the following contents are included in the Air bag Inflator Kit:
 - a. (1) *Replacement desiccated inflator*
 - b. (4) Replacement Nuts M5
 - c. (1) *Replacement Stopper Plate*
 - d. (1) Electro tap
 - e. (1) Caution Label
 - f. (6) *Felt tapes*
 - g. (1) Replacement Wiring Harness

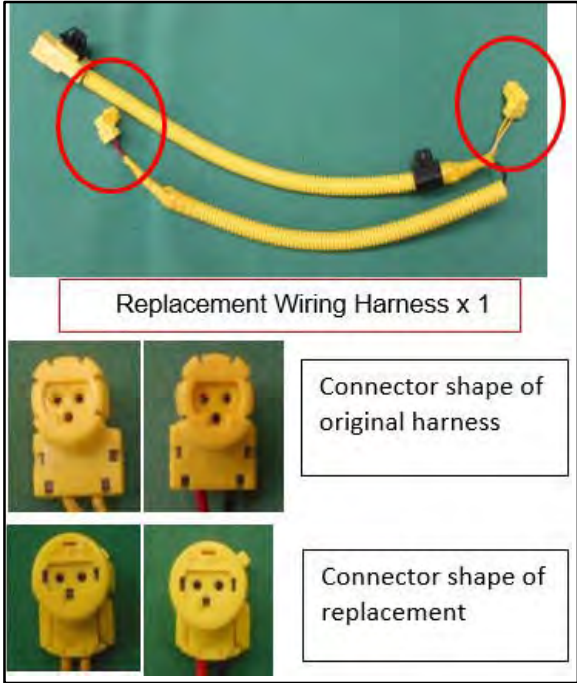

NOTE: The replacement wiring harness' connector is different from the original connector. However, the two are compatible. The replacement wiring harness has the same function and performance as the original.

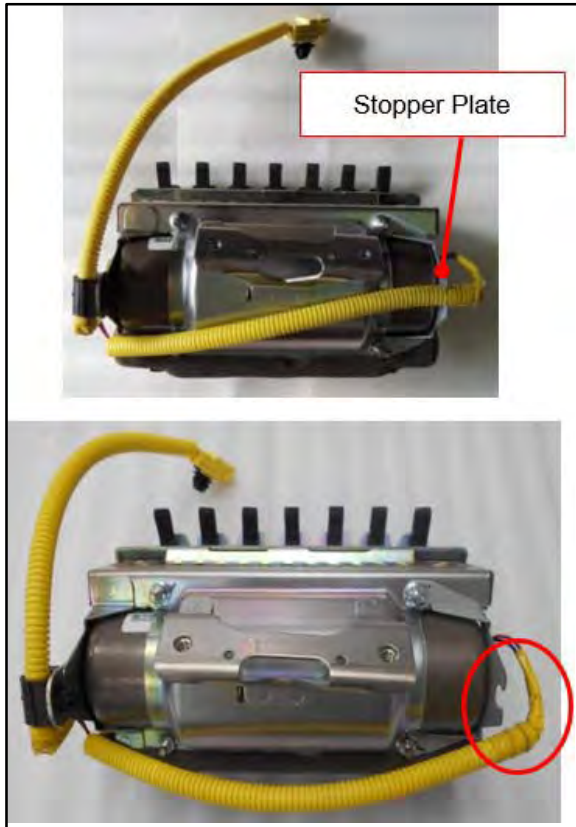

4. Unhook the corrugated tube from the Stopper Plate.

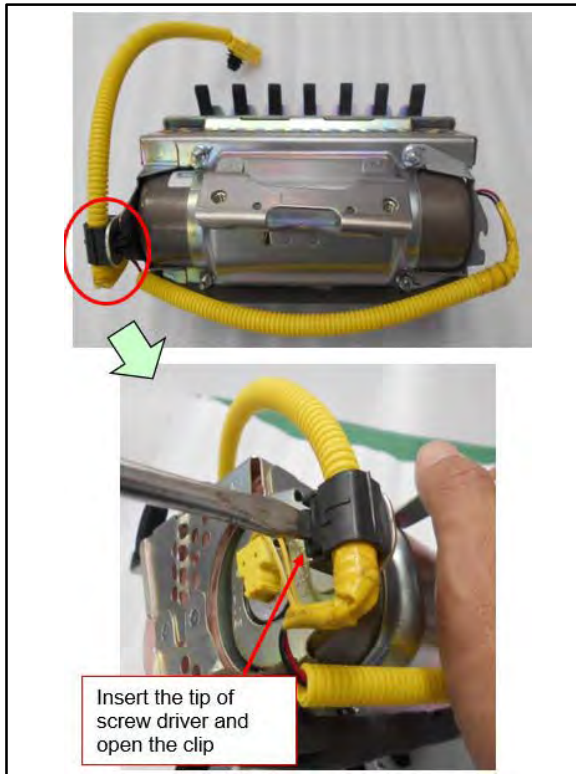

5. Insert the tip of a flat head screwdriver and open the clip.

CAUTION: Do NOT damage the harness or air bag with the screwdriver.

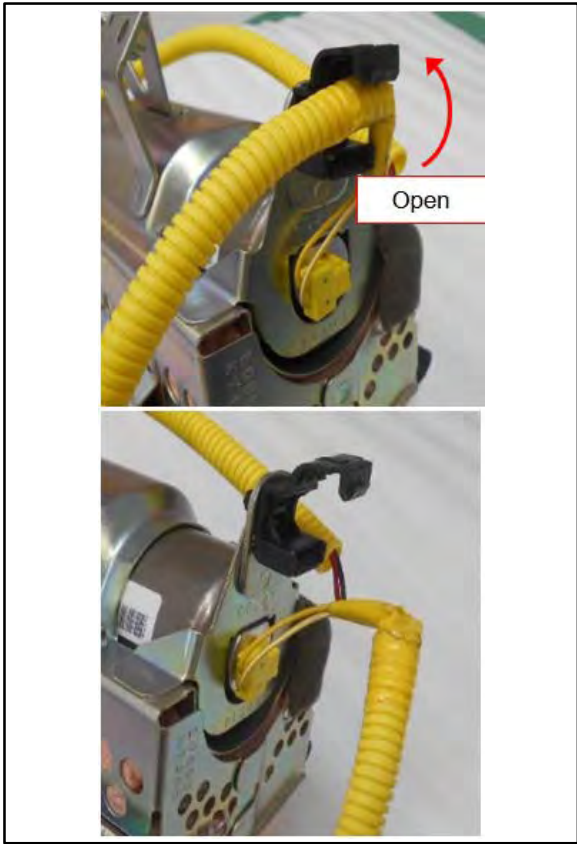

6. Open the clip and remove the harness.

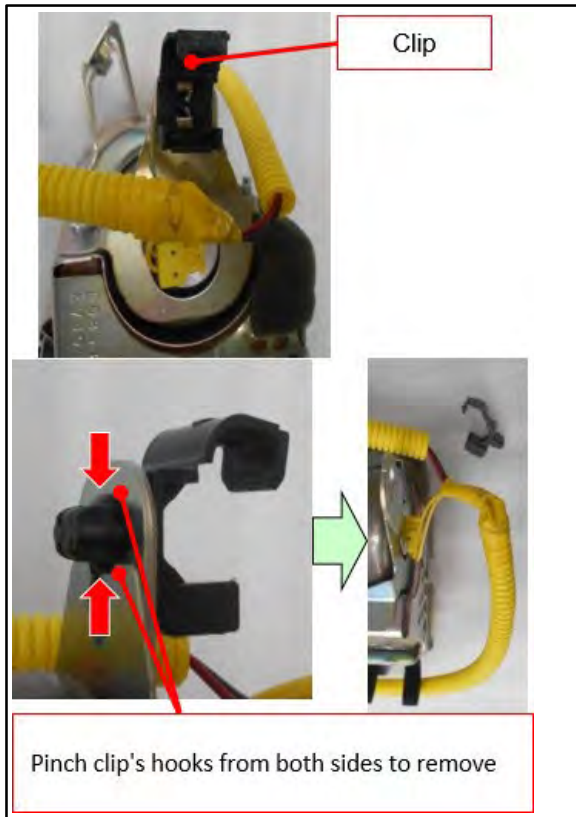

7. Use a pliers to remove wiring clip from the bracket.

NOTE: Since the wiring will not be reused, the clip is not required to be undamaged during removal.

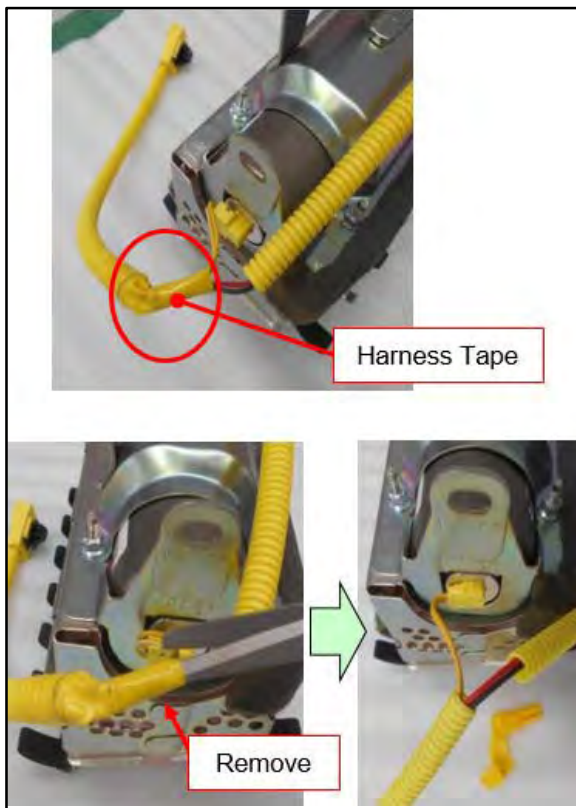

WARNING:
Strictly follow all instructions to avoid accidental air bag deployment.

8. Remove the harness tape as illustrated.

CAUTION: Use only scissors to cut the tape. Do NOT damage the wire.

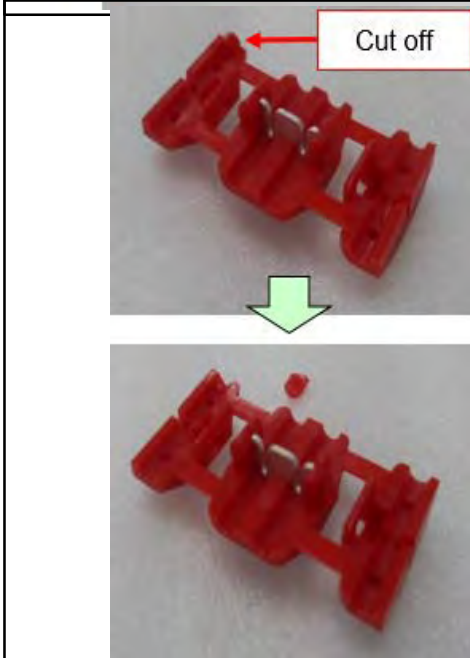
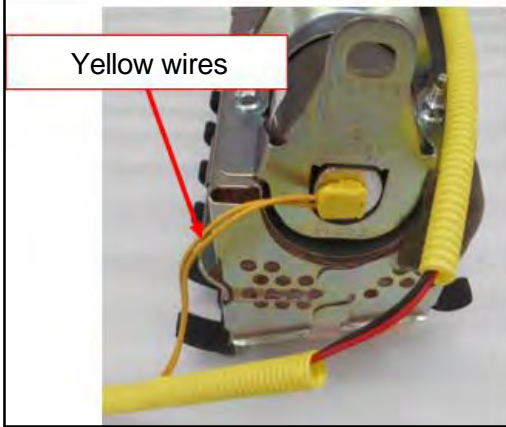
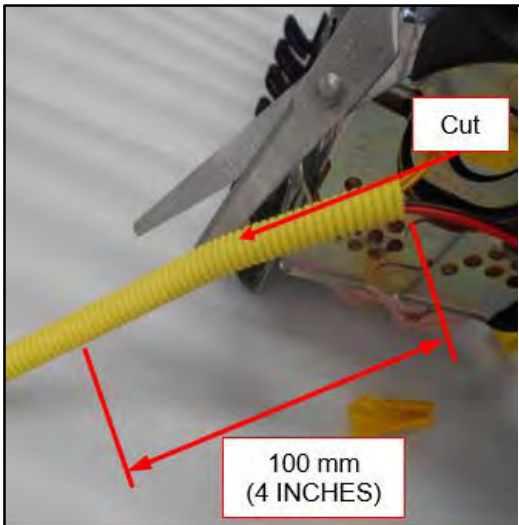

WARNING:

Strictly follow all instructions to avoid accidental air bag deployment.

9. Use an appropriately-sized scissor to cut approximately 4 inches (100 mm) of the corrugated tube from one end as illustrated.

CAUTION: Only use scissors to cut the corrugated tube.

10. Take the yellow wires (or blue and yellow wires) out of the corrugated tube. Do not damage the yellow wires during this process.

11. Using a nipper or pliers, cut the tab off of the Electro tap as illustrated.

IMPORTANT: *If the tab is not cut off the electro tap, the tap will not lock properly. If the tap is not locked properly a short in the wire may occur and cause the inflator to explode.*

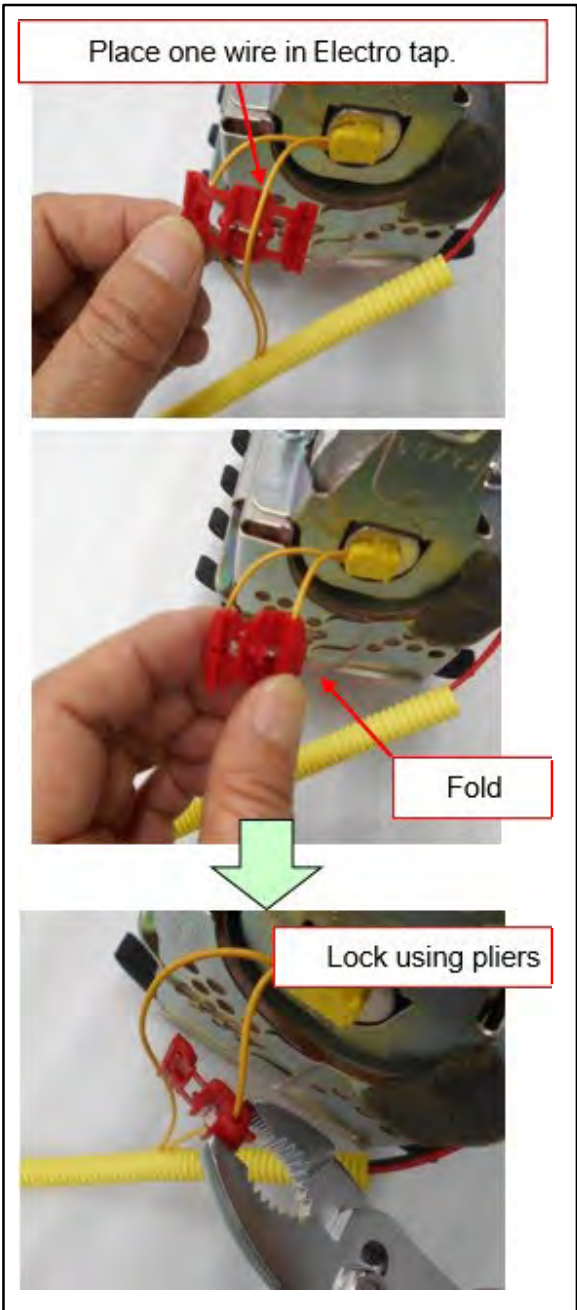

12. Place one yellow wire in the Electro tap.

13. Hold the wire by folding the Electro tap.

14. Lock the wire in the Electro tap with a pliers.

Place other wire in electro tap

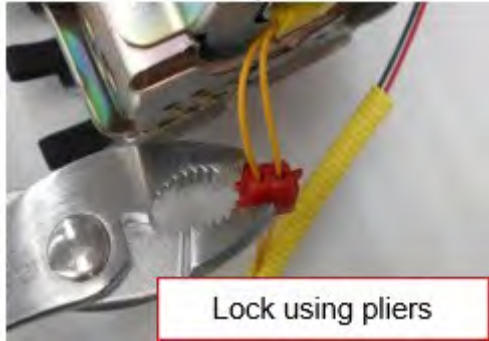
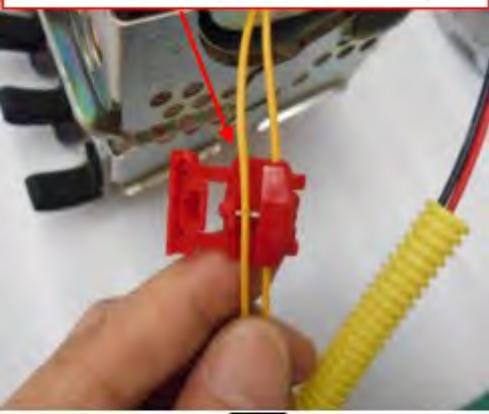

Lock using pliers

15. Lock the other yellow wire using the same procedures.

Check both sides

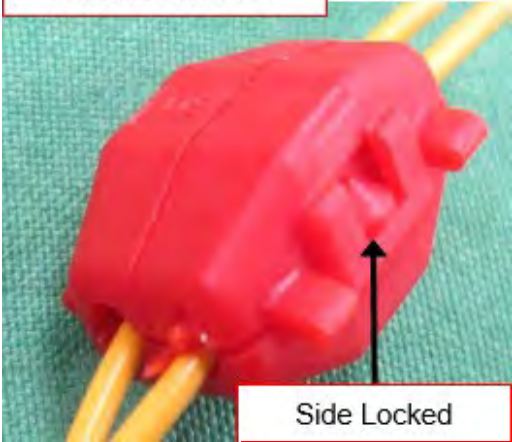

Side Locked

16. Confirm that both yellow wires are locked.

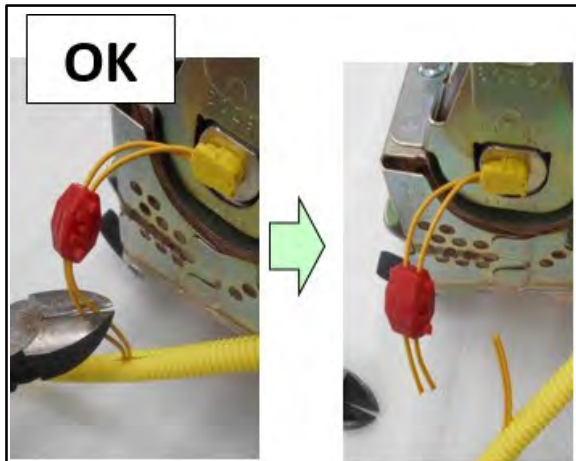

17. Cut the yellow wires on the side opposite of the inflator, as illustrated.

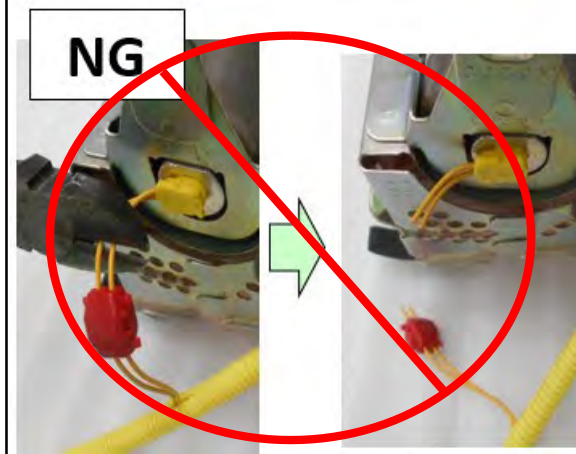

WARNING: Do not cut the side closest to the inflator. Do not cut the red and black wire.

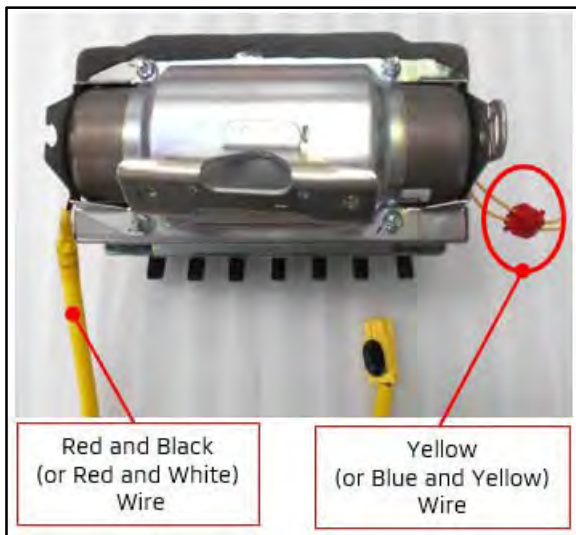

18. Confirm that the yellow wires have been shorted and cut.

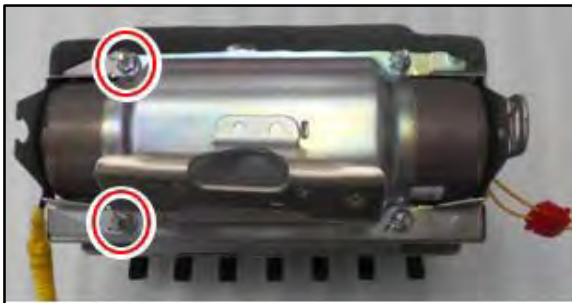

19. Loosen, remove, and dispose the (2) nuts as illustrated.

CAUTION: Do NOT remove any other nuts at this time, to avoid risk of dropping the air bag. Do NOT reuse the removed nuts.



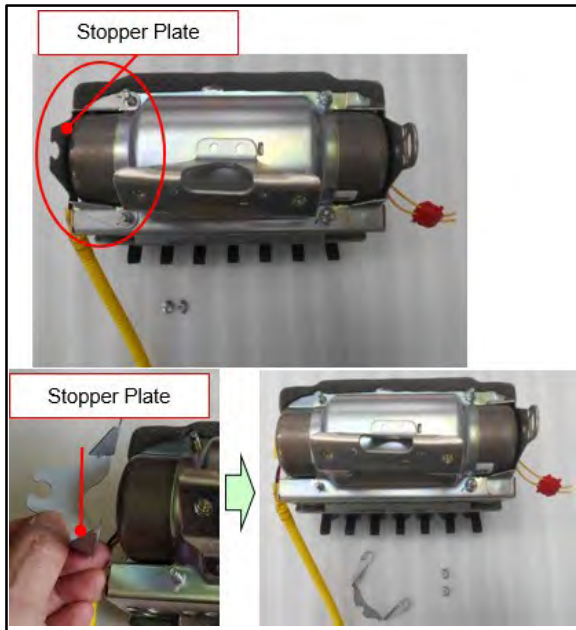

20. Remove the Stopper Plate.

NOTE: The Stopper Plate will be reused. Do not dispose.

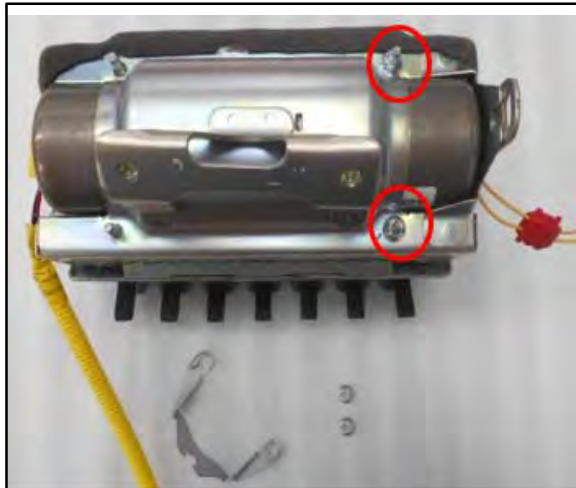

21. Loosen, **but do not remove**, the (2) nuts as illustrated.

CAUTION: Do NOT remove these nuts to avoid dropping the air bag during this process.

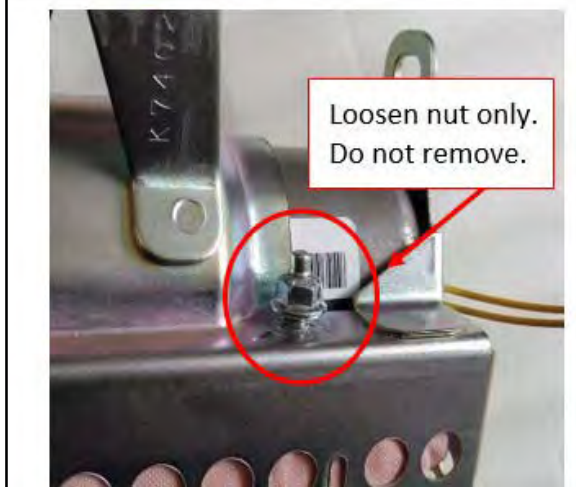



22. **Gently** pull on and straighten the yellow wires so that it is in line with the inflator. This will prevent the wire from contacting the edges of the inflator housing during removal.
23. Continue pulling on the harness while gently pushing the inflator with your finger in the illustrated direction until the inflator is completely separated from the housing.

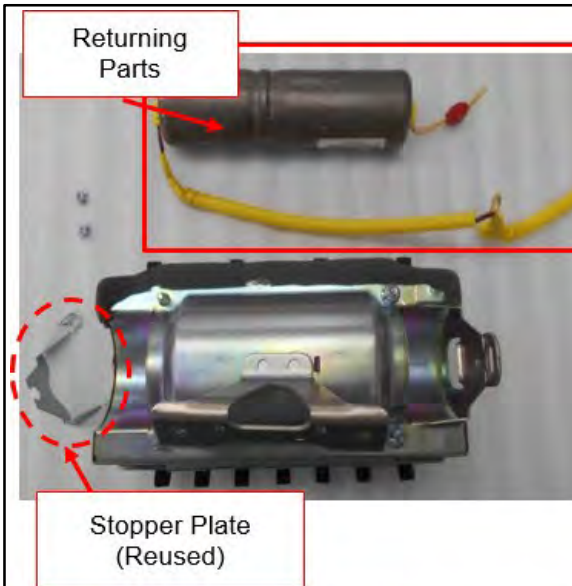

24. Place the removed inflator into the empty box that the new inflator kit contents were previously held in.
25. Package the removed inflator in the Repair Kit box, for returning to Takata.

CAUTION: Do NOT replace box with another inflator box for tracking purposes.

CAUTION:
Do NOT disconnect any wires from the removed inflator.

NOTE: Stopper Plate will be reused.
Dispose the nuts that have been removed.



INFLATOR INSTALLATION



1. Verify that you have all of the following parts ready for installation:
 - a. (1) *Replacement dessicated inflator*
 - b. (4) *Replacement Nuts M5*
 - c. (1) *Replacement Stopper Plate*
 - d. (1) *Caution Label*
 - e. (6) *Felt Tapes*
 - f. (1) *Replacement Wiring Harness*

NOTE: The Connector of the replacement wiring harness looks different from original connector installation in the vehicle, however they are compatible. The wiring harness in the repair kit box had the same function and performance as the one in the vehicle.

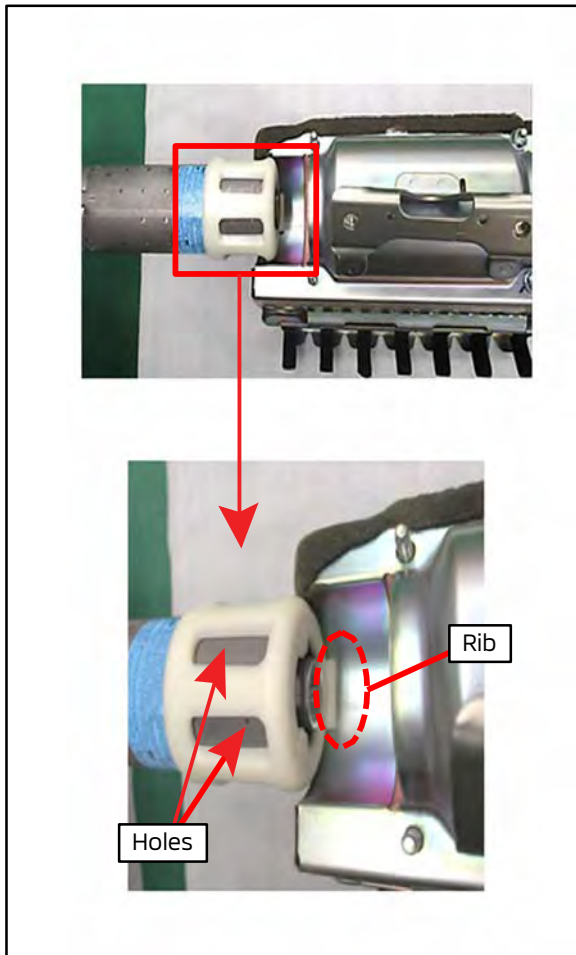

2. *Insert the inflator into the airbag module from the resin open hole side.*
3. *Insert the inflator with the one rib pointing the same direction as what is shown in the photograph.*

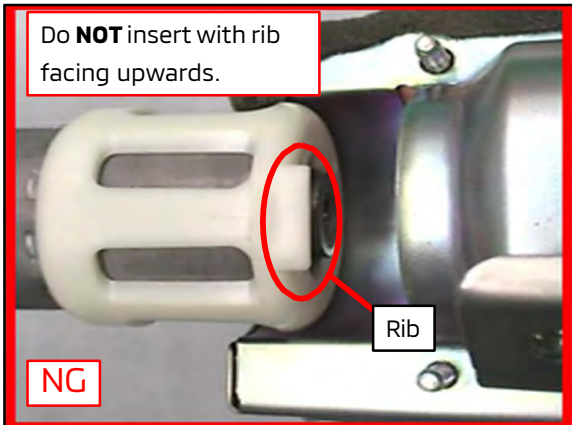

CAUTION: Do *NOT* insert with rib facing upwards.

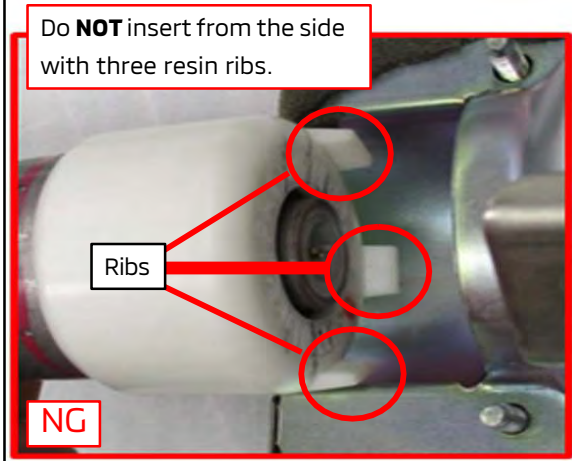

CAUTION: Do *NOT* insert the side with three resin ribs.

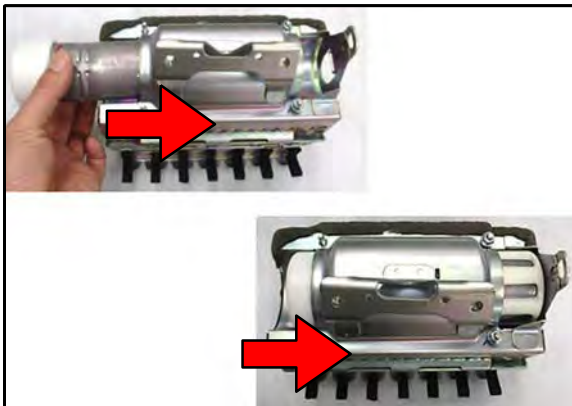

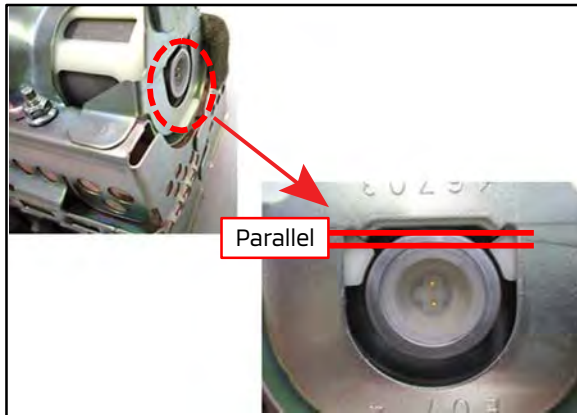

5. *Rotate inflator until the linear shape of the inflator tip and the straight part of the housing becomes parallel.*

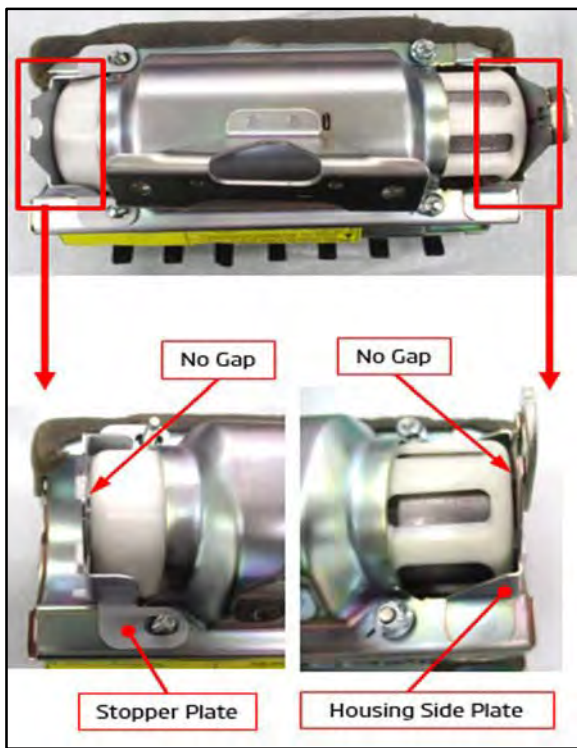

6. *Ensure that there are NO gaps between the inflator and the Housing Side Plate, and that the inflator is fully seated.*
7. *Install, and if necessary, adjust the Stopper Plate, and confirm there are NO gaps between the inflator and the Housing Side Plate, and there are NO gaps between the inflator and the Stopper Plate.*

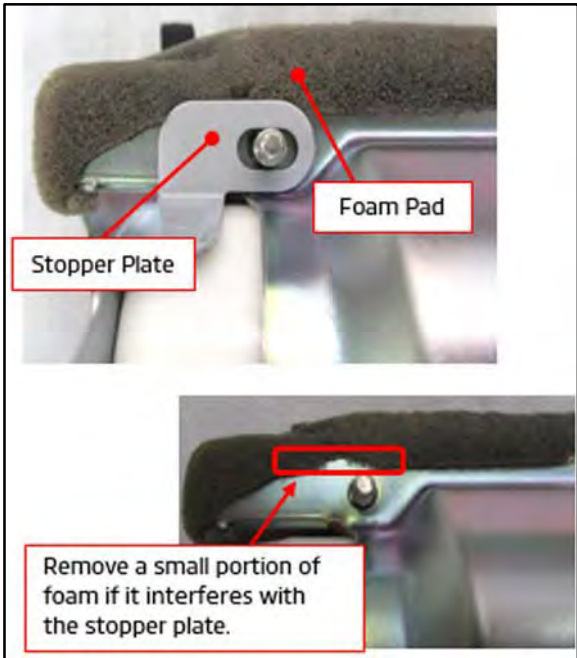

8. *If the foam pad interferes with the installation of the Stopper Plate, a small portion of the foam pad may be removed as illustrated.*

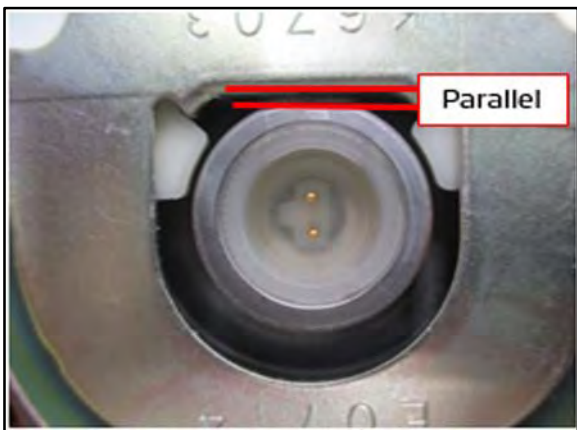

IMPORTANT: *Verify that the linear shape of the inflator tip and the straight part of the housing are still parallel.*

CAUTION: *Angle cannot be corrected after tightening the nut. The nut will lose effectiveness if it is loosened then re-tightened after the inflator is set.*

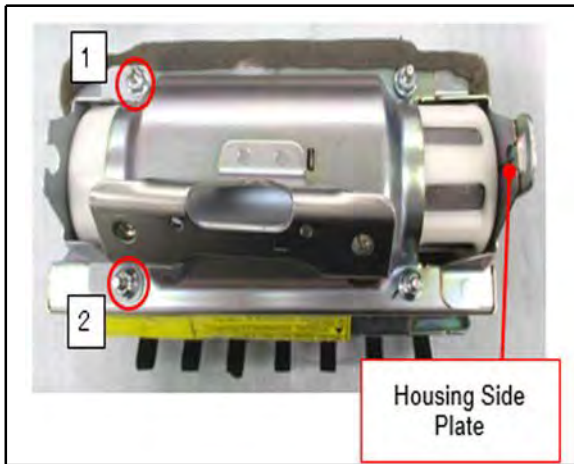

9. Attach the Stopper Plate using the (2) new nuts. Do not tighten the nuts yet.

CAUTION: Old nuts must NOT be reused. Use new, replacement nuts supplied in the repair kit.

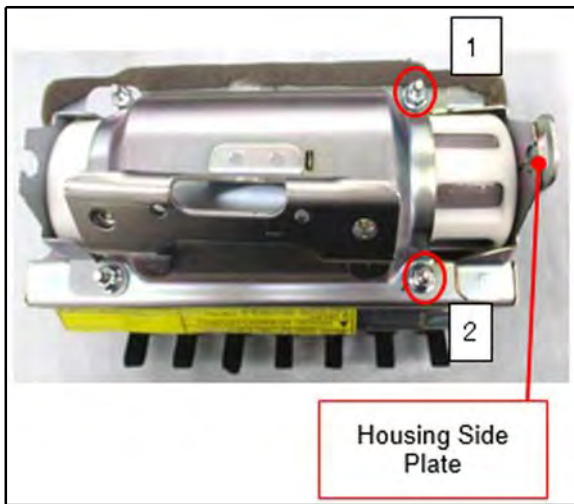

10. Remove and discard the (2) nuts that were loosened but not removed during the Inflator Removal process.

11. Loosely install (2) new nuts from the repair kit.

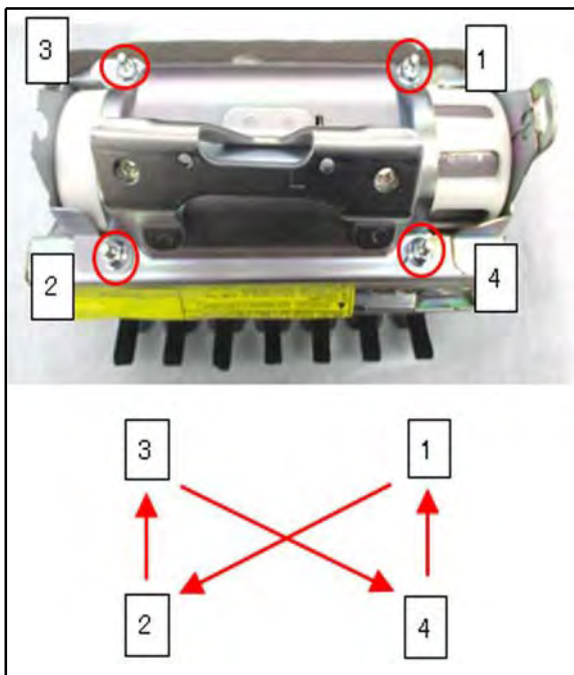

12. Tighten all (4) nuts in the specified order, and torque down to the specified torque.

Specified Torque:
The nuts (silver finish) are properly torqued to 34.5 ± 3.5 in-lb (3.9 ± 0.4 Nm).

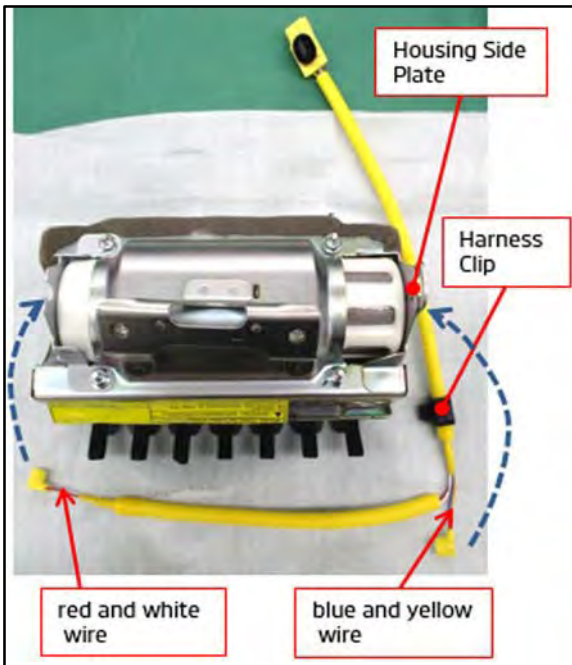

13. *Orient the air bag module and harness position as illustrated.*

NOTE: Use the new wire harness in the repair kit.

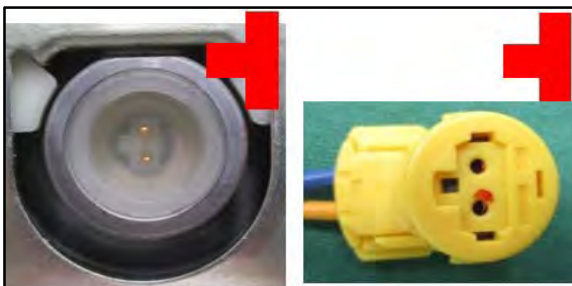

14. *Connect the yellow and blue wire harness to the "T" shape side of the inflator head.*

- a. *Match the "T" shapes on the connector and inflator head.*
- b. *Confirm position of coupler and wiring as shown on left photo.*

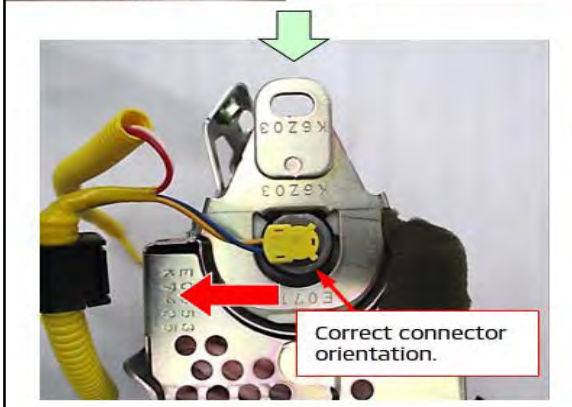

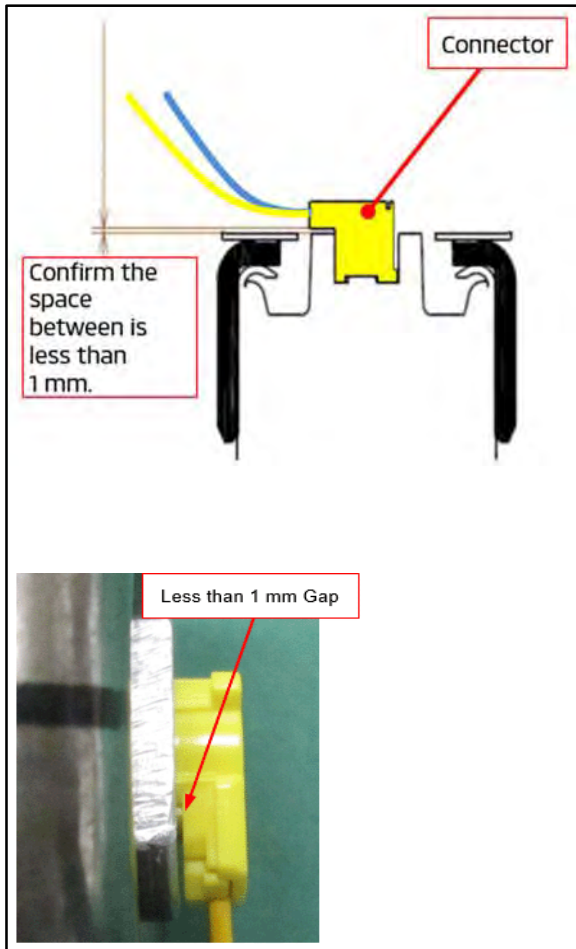

15. *Push the connector into position, until the space between the connector and inflator is less than 1 mm.*
16. *Lightly pull on the connector and confirm that it is locked into position.*

NOTE: *If coupling orientation is incorrect, the connector will not securely lock into position. Reorient the coupling and try again.*

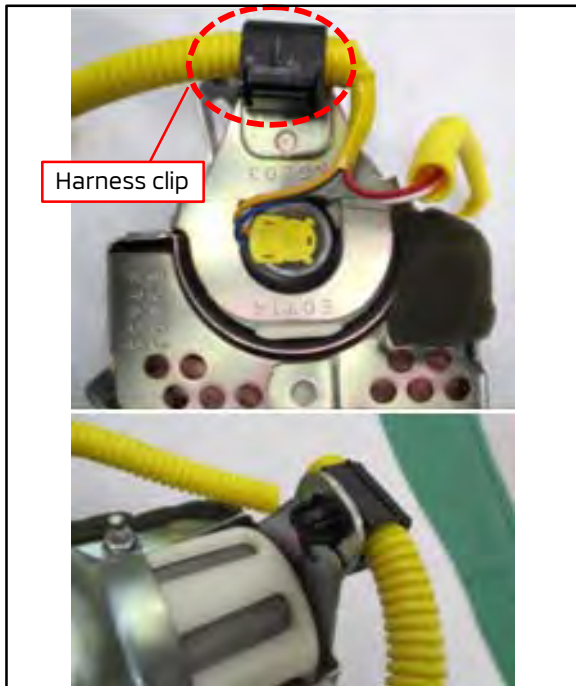

17. *Position the harness as illustrated.*
18. *Insert the harness clip into the Housing Side Plate.*



19. *Connect the red and white wire to the inflator's Stopper Plate side.*
- a. *Align the "T" shape on the connector and inflator.*
 - b. *Confirm connector and harness position is as illustrated.*

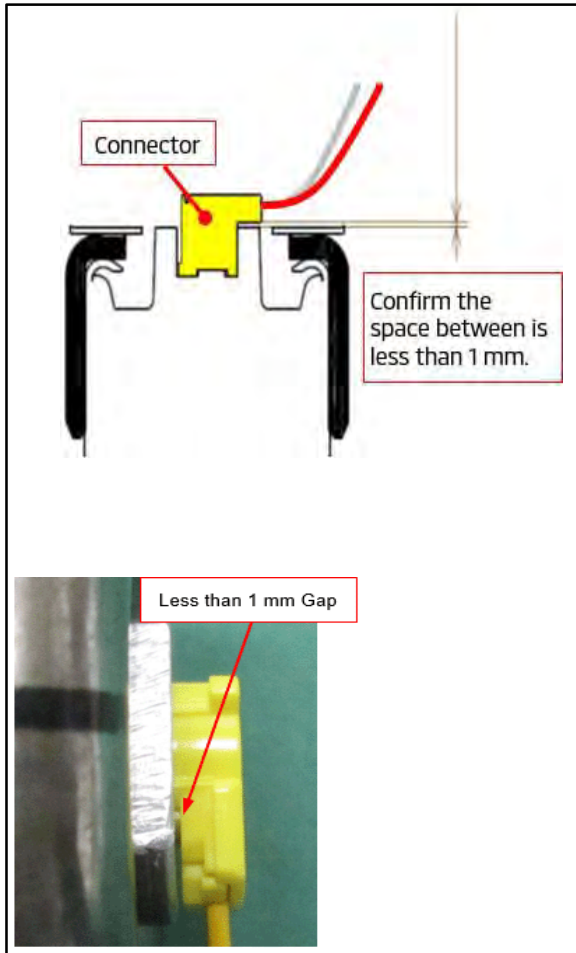

20. *Push the connector into position until the space between connector and inflator is less than 1mm.*

21. *Lightly pull on the connector and confirm that it is locked into position.*

NOTE: *If coupling orientation is incorrect, the connector will not securely lock into position. Reorient the coupling and try again.*

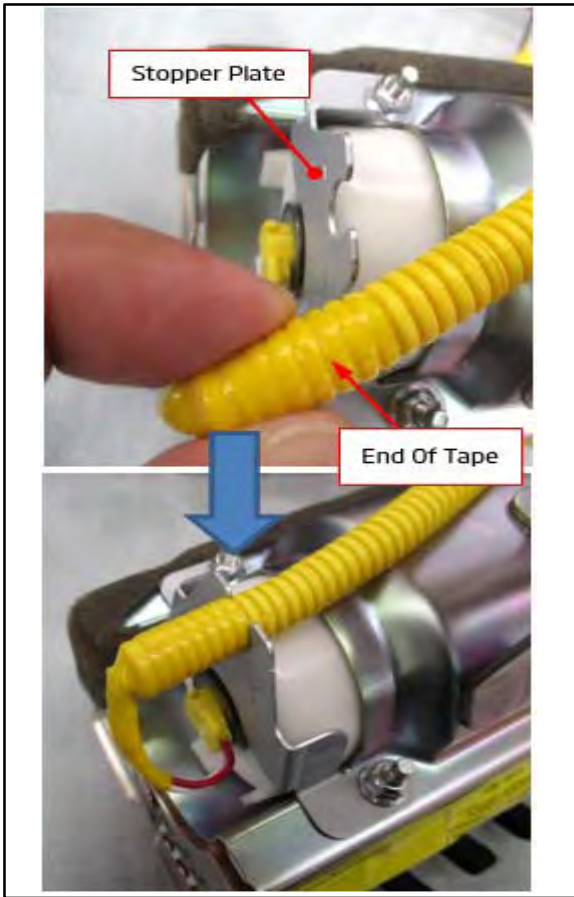

22. *Set the end of the corrugated tube onto the Stopper Plate.*



23. Wipe original Caution Label with dry, clean rag or cloth.
- CAUTION: Do not use any detergents or chemicals.**
24. Paste the new Caution Label directly on top of the original Caution Label
 25. Wipe and press with a dry, clean rag or cloth.

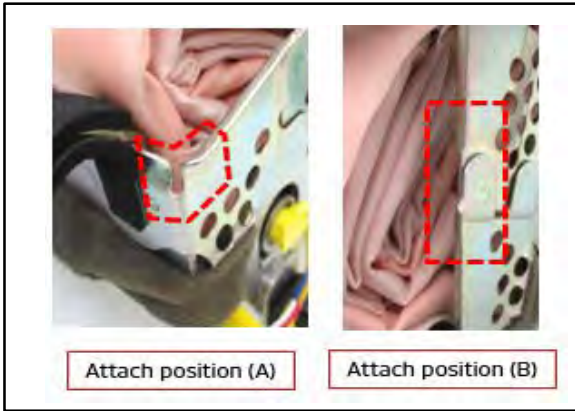

26. *Wipe all 6 felt tape attach positions with dry, clean rag or cloth.*

CAUTION: *Do not use any detergents or chemicals.*

27. *Prepare the felt tapes.*

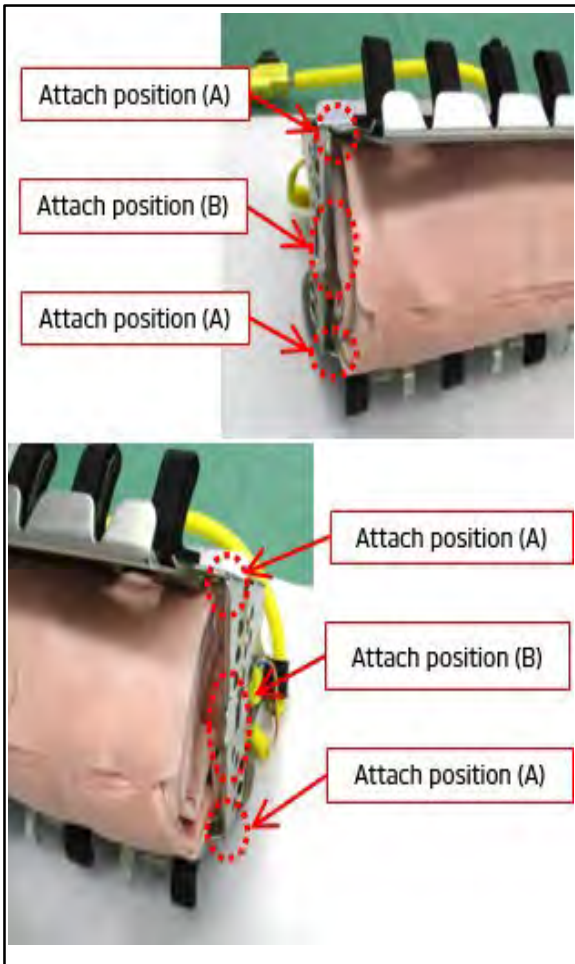



Attach half of the tape inside to cover the notch.

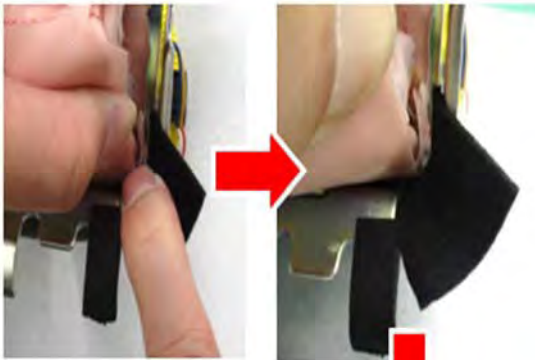

28. *Attach half of one piece of felt tape inside the corner of the housing to cover the notch. (Position (A))*

29. *Fold the remaining half of the felt tape to the outside of the housing.*

CAUTION: *Careful when handling the bag. Make sure not to dirty or damage the bag.*

NOTE: *Make sure to attach all four corners of the felt tape to the housing of Position (A).*

30. *Repeat steps 28 - 29 for each remaining Attach Position (A).*

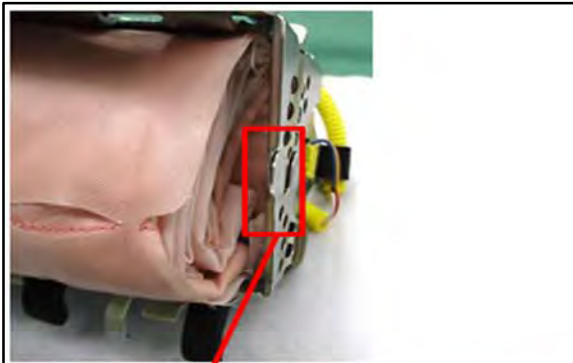

31. *Attach half of one piece of felt tape to the inside of Position (B).*
32. *Fold the remaining half of the tape to the outside of Position (B).*
33. *Repeat steps 31 – 32 for the other side of the housing.*



Use the felt tape to cover where the housing flange connects.

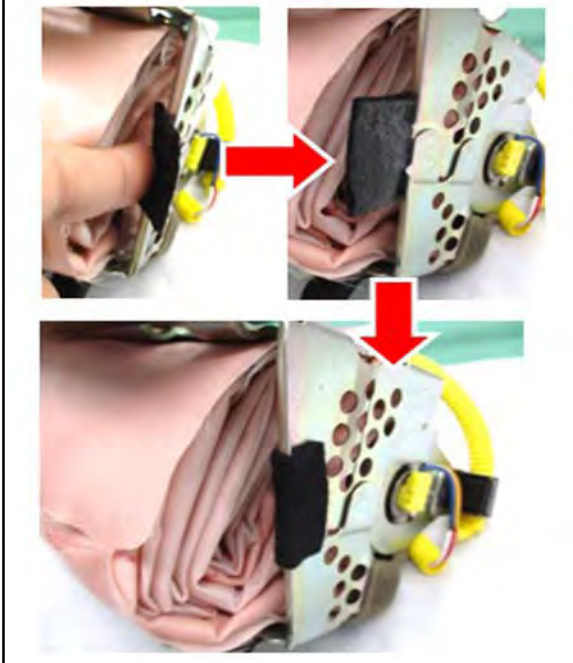

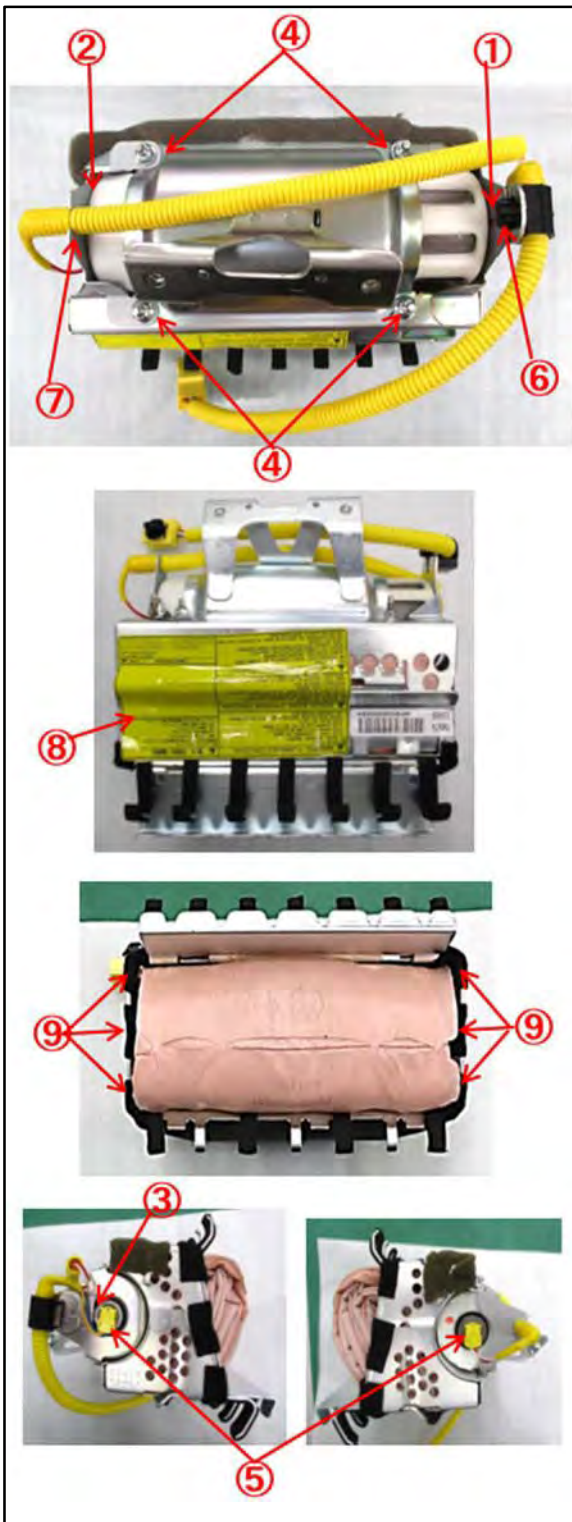

Final verification:

1. *Is there NO gap between the inflator and Housing Plate?*
2. *Is there NO gap between inflator and Stopper Plate?*
3. *Is the position and angle correct on the inflator?*
4. *Are all nuts tightened to specified torque?*
5. *Are harness connectors securely locked?*
6. *Is the harness clip securely locked?*
7. *Is the harness assembled as illustrated?*
8. *Is the new Caution Label attached?*
9. *Are all six pieces of felt tapes affixed correctly?*
10. *Verify the bag and cloth are free of dirt, debris and damage.*

REINSTALLATION PROCEDURE

1. Reinstall the passenger air bag module to the instrument panel.
2. Reinstall the distribution duct to the instrument panel.
NOTE: Reinstall the center bolts first to align the distribution duct.
3. Reinstall the instrument panel.
4. Remove the electrical tape and reconnect the negative (-) battery terminal. Tighten the clamp nut securely.
5. Turn the ignition switch to the "ON" position. If the "SRS" warning light illuminates continuously (does not extinguish after seven seconds), troubleshoot per the applicable service manual, Group 52B - Supplemental Restraint System (SRS) > SRS Air Bag Diagnosis > SRS Warning Light Check.
6. Input radio station presets and set the clock, if applicable.

ERASE AND READ DTCs FROM ALL ECUs

1. Connect the equipment as follows:
 - Turn the laptop computer/tablet on.
 - Connect the USB cable to the VCI/VCI Lite.
 - When the laptop displays the MUT-III main screen, connect the USB cable to the laptop.
 - Connect the MUT-III main harness 'B' with the red or black DLC connector to the VCI/VCI Lite.
 - Connect the red or black connector of the MUT-III main harness 'B' to the vehicle's data link connector.

NOTE: VCI and laptop shown for illustration purposes only.

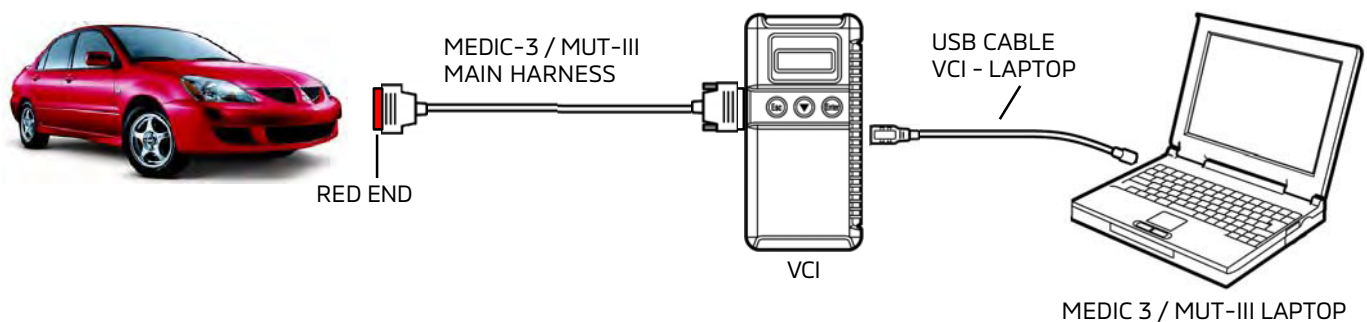

2. Turn the ignition switch to the "ON" position.
NOTE: Ensure all accessories are off (e.g. lights, heating and AC system, audio/navi unit, etc...).
3. From the MEDIC main page:
 - a. Click on MUT-III.
 - b. Select "Special Function."
 - c. Select "All DTCs."
 - d. Select "Erase and read all DTCs." DTC 21 and 24 should appear. If any DTCs other than 21 or 24 appear, troubleshoot per the applicable service manual.

INFLATOR RETURNS

!! IMPORTANT !! Do NOT deploy any inflator.

Fill out the form on **page 36** and contact the appropriate Takata USA representatives below to obtain return shipping documents.

US - 48 Contiguous States

RXO Logistics Customer Service Rep
Email: SCFieldaction.14305@rxo.com

Hawaii, Alaska, US Virgin Islands, Puerto Rico and Other US Territories

RXO Logistics Representative
Email: SCTakataRestrains_International@rxo.com

If a response is **not** received within 2 to 3 days, call 210-317-6436 to escalate. In most cases, the replaced Takata air bag inflators will be picked up within 3 business days.

The removed air bag inflator modules must be returned to Takata. If you have NOT accumulated inflator modules after two weeks, follow the return procedures on **page 34**. If you have accumulated **7 or more inflator modules** after two weeks, follow the inflator return procedures on **page 35**.

There will not be a system generated airtel return request. Regardless, the campaign claim is subject to chargeback if the replaced air bag inflator is not returned to Takata. Please make sure you keep a copy of proof of shipment with the repair order.

As the shipper, you are responsible for proper packing and document completion. The person packaging the inflator must have received hazardous material training per 49 CFR 172.702, and the training records must be on file at your dealership. The US Department of Transportation will impose substantial fines and/or penalties on the shipper if either packaging, labeling or documentation is not properly prepared and Customer Copy of OP 900PRP form is not kept on file for a minimum of 2 years.

RXO LOGISTICS RETURN POLICY ON TAKATA AIRBAGS/INFLATORS

1. Begin to stack the pallet, ensuring **NOTHING** exceeds the edges of the pallet and less than 5 ft high so the pallet will be structurally safe for transport.
2. **Keep a count of how many Driver and Passenger side airbags/inflators you have on that pallet (THIS IS REQUIRED TO SCHEDULE YOUR PICKUP).** You can also send back multiple pallets if you have the capacity and ability to do so.
3. Once the pallet is ready and secure (**WRAPPED OR TIED DOWN**), you can email your request to RXO Logistics to schedule the LTL pickup.

After all the above is completed, RXO Logistics will contact and schedule the appropriate carrier for your pickup. They will request the pickup for the next business day but may take up to 72 business hours depending on truck availability.

At this point, RXO Logistics will email you five documents:

- a) Bill of Lading
- b) Overpack
- c) ERG 171
- d) TK Holdings address label
- e) these return instructions

DO NOT SHIP REPLACED INFLATORS TO MMNA. SHIP ONLY TO RXO LOGISTICS/TAKATA.

!! IMPORTANT !!

Use these instructions if there are **LESS THAN 7** inflators being returned.

48 STATE FEDEX PRP SHIPMENT PREPARATION

1. Shipping Instructions

If 7 Kits have not been accumulated within a week, please follow the instructions below

a) Email RXO Logistics for direction at SCFieldAction.14305@rxo.com

1.a Shipping Documents

OP 900PRP Hazardous Materials Certification Form



FedEx Ground Shipping Label



FedEx Ground Shipping Envelope



4. Shipping Documentation Instructions

a) Separate the bottom 4 labels (OP 900PRP form), place them in the FedEx Ground envelope, remove the backing and firmly place on bottom side of box.



b) Peel off the Box Copy of the OP 900PRP form and firmly apply to the front side of the box.

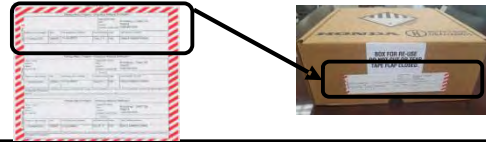

5. Shipping Documentation Instructions (Cont.)

a) Peel off the SHIPPER RECEIPT from the top of the FedEx Ground PRP Shipping label, place it in the Tracking ID box on the Customer Copy of the OP 900PRP form. **3)**

b) Peel off the RECEIPT & SHIPPER NUMBER from the top of the FedEx Ground PRP Shipping label, and place it in the Tracking ID box on the FedEx copy. **4)**

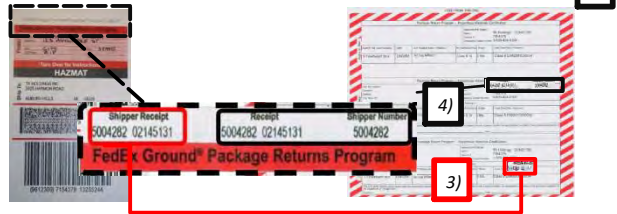

2. Packing Instructions

a) Confirm box is in acceptable condition. If a new box is needed, follow the New Box instructions located on the next page.

b) Place the un-deployed air bag inflator in the box.



3. Closure Instructions

a) Close the top box flap, per box closure instructions located on front panel of box.



6. Shipping Documentation Instructions (Cont.)

a) Separate the FedEx Copy and Customer Copy of the OP 900PRP form. Keep the FedEx copy with the box. Attach the Customer Copy to the Repair Order.

Note: Dealers must retain the Customer Copy of OP 900PRP form in their records for 2 years.

Dealership Copy



7. FedEx Ground PRP Shipping label

a) Fill in Shipper Name & Address in the upper section of the FedEx Ground Shipping label. Note: (RMA# is not required). **1)**

b) Peel off the backing of the FedEx Ground PRP Shipping label and affix to the back side of the box. **2)**

c) Provide the package and the FedEx Copy of The OP 900PRP form to the FedEx Ground Driver. **1)**

Note: If you don't receive regular pickups from Fed-Ex, call 800-463-3339 to schedule a pickup of the package.

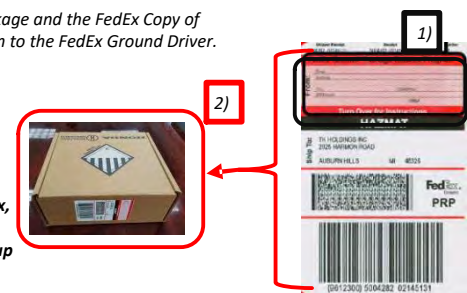

INFLATOR RETURNS

International Shipping Return Instructions

NOTE: ALL International Locations outside of the United States (APAC, EMEA, Hawaii, Alaska, Puerto Rico, and US Virgin Islands dealers) please follow below shipping instructions. Dealerships in these locations MUST contact the following Takata / RXO representative directly for shipping instructions primarily via

New Email at: SCTakataRestrains_International@rxo.com

Escalation Contact: Miguel Prigadaa Phone: 210-317-6436

If dealers are in need of additional boxes, please send your request to the same email address: SCTakataRestrains_International@rxo.com and make sure to indicate how many boxes you need, as well as the model, part number and include pictures if possible. (please consider that shipping additional boxes will take a few weeks to get process depending in the area/country you are located)

1. Shipping Documents

a) Box Label

- Supplied with each Kit
- To be affixed to each box



b) Over-pack Label

- To be supplied by RXO
- To be affixed to the outside of each pallet

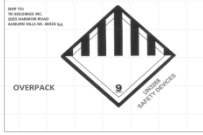

c) Bill of Lading

- To be supplied by the local carrier.
- Print 2 copies: 1 for Dealer Records, 1 for the local pickup Driver



d) Commercial Invoice

- To be dealer provided by the if possible.

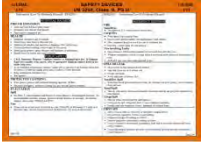

3. Shipping Instructions – Prepare the Pallet

a) Accumulate and palletize Kits

b) Arrange Kits on Pallet

- A minimum of 25 boxes and maximum of 200 boxes per pallet .

c) Shrink-wrap Kits to Pallet

d) Prepare to ship per IATA International regulations

e) Affix Over-pack Label and Pallet Label on (1) side of Pallet

f) (Not Please on Top)hold as many Airbags as possible in order to accumulate as many as possible and limit the number of pickups to at least 1 per month.



2. Packing Instructions

****DO NOT DEPLOY THE INFLATOR****

Confirm box is in acceptable condition.

Box should be in good condition with no visible signs of damage and should be capable of withstanding additional transportation.

- d) Place the un-deployed air bag inflator in the "cradle" of the box insert.



4. Shipping Instructions – Schedule Intl Pickup

a) When ready to ship

- Email RXO at SCTakataRestrains_International@rxo.com
- EXCALATION PURPOSES Contact: Miguel Prigadaa Phone: 210-317-6436
- b) Fill out the International Pickup Template with all details:
- Dealer/Pickup contact Information including hours of operations
- Quantity of boxes/Pallets
- Weight and Dimensions
- Email Address

5. Shipping Instructions – Ship

- a) Give 1 Copy of BOL and 1 Copy of ERG to Driver
- b) Retain 1 Copy of BOL for Dealership records and archive for 2 Years

2.1 Closure Instructions

- a) Close the top box flap, per box closure instructions located on front panel of box using a 2" wide by 4" long piece of tape to securely Close the box.

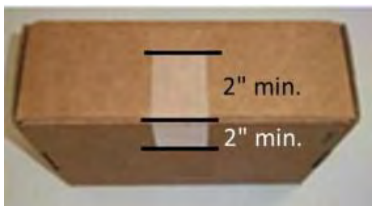

6. Requesting a New Box

If a new box or replacement boxes are needed, please contact the representative listed below by phone or email to request replacement materials.

E-Mail: SCTakataRestrains_International@rxo.com

To help expedite your request, please be prepared to provide the following information:

- a) What Type of shipping material needed
 - Number of Replacement Boxes needed
 - Part Return Label
 - Airbag Model
 - Pictures (of the airbag if possible)
- b) Dealer Shipping Information
 - Contact name
 - Dealer Address
 - Phone Number

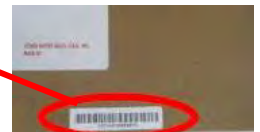



PALLET (S) MUST BE READY BEFORE SENDING IN THE TEMPLATE. ALL FIELDS PERTAINING TO YOUR LOAD MUST BE FILLED IN AND SENT TO SCFIELDACTION.14305@RXO.COM ESCALATION PHONE NUMBER 210-317-6436 MIGUEL PRIGAADA

Dealer Code

Dealer or Business Name

Pickup Address

City, State & Zip

Physical Address (if different from pickup address)

City, State & Zip

YOUR Name & Phone #

Hours Available for Pickup

Days/hours pickup is not allowed
(lunch hour if shut down)

Email address for BOL

Do you need a truck with lift gate and pallet jack? YES NO

Where can the driver expect to find pallet on property? Please give clear directions

Special instructions or notes that will help driver locate pallet on site

LTL	Pallet #1	Pallet #2	Pallet #3	Pallet #4	Pallet #5	Pallet #6	Pallet #7	Pallet #8	Pallet #9	Pallet #10	Pallet #11	Pallet #12	Pallet #13	Pallet #14	Total Boxes
Driver Side Count															
Passenger Side Count															
Total															

WARRANTY INFORMATION

There is one repair scenario for this campaign.

#	Repair Procedure	Campaign Operation	Labor Time Allowance	Part Number
1	<i>Replace air bag inflator kit</i>	<i>C1603A03</i>	<i>1.7 hours</i>	<i>7030A977</i>

WARRANTY / RECALL CAMPAIGN CLAIM INFORMATION

Enter all claims as claim type 'C' - Recall/Campaign Claims

Please follow the campaign instructions when entering each claim in order to select the applicable operation codes that correctly match up with the work that was actually performed. A claim example is provided below.

Required Operation to be performed by model year **Labor Operation** **Labor Time**

2006-2007 MY Lancer – Replace Air Bag Inflator Kit (7030A977) C1603A03 1.7 hrs.

Claim Header Section: Air Bag Inflator Replacement

MITSUBISHI DEALER LINK Service Warranty Warranty Claim Help

Claim Entry Vehicle Information face PQR/VQR

Campaign Information

Campaign Operation No: Enter As TSP

Miles/Km:

VIN:

Service Technician: Emp No: Service Advisor: Emp No:

Spec Value *: Duplicate Recall *:

Dealer: 99320 Ref No: VIN:

Claim No: Adj: Claim Status: Incomplete Model and Year:

Enter in the first 6 characters of this campaign labor operation: **C1603A.**

This campaign is for the replacement of the air bag inflator on certain 2006 and 2007 MY Lancers. Check the Open Campaign area of the Superscreen each time to be certain of a vehicle's eligibility. Only VINs showing **C1603A** as open are involved.

After entering the required customer data, vehicle information and applicable campaign operation number, hitting the **"Save and Continue"** button will automatically fill-in several fields. Please note that there is only 1 possible repair scenario for this campaign.

CAMPAIGN INFORMATION

Campaign Operation No: 2006-07MY Lancer

Miles / KM: VIN: JA3AD29F84U039122

Repair Date In: Repair Date Out:

Repair Order No: EX12345

Repair Performed: C1603A Replace Air Bag Inflator

Enter As Sublet: TSB:

Recall Campaign Claim Example:

Follow these instructions for claim for performing the replacement of the air bag inflator.

PARTS:

There is one possible repair scenario and it requires the replacement of the air bag inflator.

*Scenario - 2006-07MY Lancer vehicles - replace the air bag inflator kit. **Part# 7030A977.***

Labors Information			Parts Information		
Labor Op	Description	Car Line	Lab Time	Part No	Part Desc
C1603A03	REPLACE THE PASS SIDE AIR BAG INFLATOR (7030A977)		1.7	7030A977	INFLATOR KIT,AIR BAG PASS

RENTAL CARS:

If there is a need to provide the owner with a rental car, claim the applicable charges in this section of the claim on the lower portion of the labor entry screen.

Select	Labor Operation	Labor Operation Description	Amount
<input type="checkbox"/>	SHO	SPECIAL HANDLING ORDER	
<input type="checkbox"/>	RENTACAR	RENTAL CAR CHARGES	
<input type="checkbox"/>	95300040	FREIGHT CHARGES	
<input type="checkbox"/>	95200040	TOWING CHARGES	

PARTS RETURN:

Follow the instructions in this TSB in regards to returning replaced air bag inflators. DO NOT return the replaced parts to MMNA. Failure to return a replaced inflator to Takata may result in a chargeback of the campaign claim.