



GROUP	MODEL
ELE	2016-2018MY Sorento (UMa)
NUMBER	DATE
297	May 2023

## TECHNICAL SERVICE BULLETIN

SUBJECT:

## MULTIFUNCTION SWITCH REPAIR

This bulletin provides information associated with the 'Multifunction Switch Warranty Extension Program' (WTY031) to repair the multifunction switch knob on 2016-2018MY Sorento (UMa) vehicles, produced at Kia Georgia from October 27, 2014 through March 7, 2018, which may exhibit an intermittent headlamp flickering. The vehicle's warranty for this issue will be extended from 5 years/60,000 miles to 15 years/150,000 miles, whichever comes first, starting from the date the vehicle was first put into service. Follow the procedure outlined in this publication to replace the multifunction switch moving block and outer cover with the new improved part.

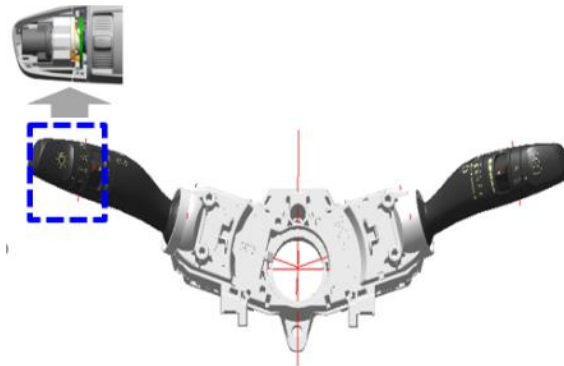

**Inspection Procedure:**

1. Perform a visual inspection of the bulb.
  - If the bulb is **(OK)**, continue to step 2.
  - If the bulb is **(NG)**, this TSB does not apply. Claim Diagnosis Op Code **232A10IO**.
  
2. Ensure the 50A B+5 and 60A B+3 headlamp fuses are not blown.
  - If the fuses are not blown **(OK)**, proceed to step 3.
  - If the fuses are blown **(NG)**, this TSB does not apply. Claim Diagnosis Op Code **232A10IO**.

Note: The multi-fuse does not need to be removed to inspect the 50A B+5 and 60A B+3 fuses.

3. Ensure the headlamp connector is properly seated.
  - If the connector is properly seated **(OK)**, proceed to the 'Repair Procedure'.
  - If the connector is not properly seated **(NG)**, remove connector and properly install. No further action required. Claim Diagnosis Op Code **232A10IO**.

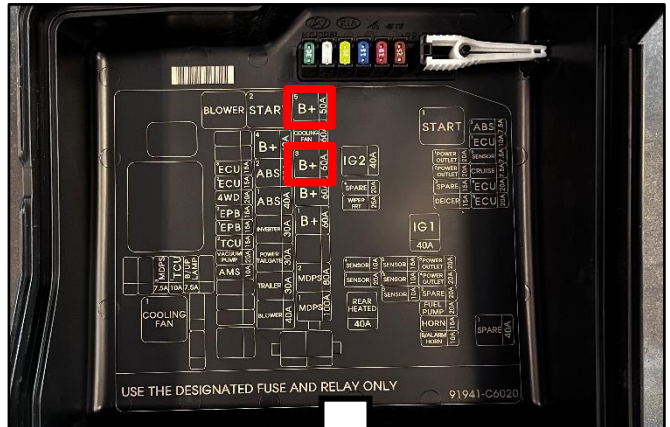

SUBJECT:

## MULTIFUNCTION SWITCH REPAIR

**Repair Procedure:**

1. Remove the lamp multi-function switch knob cover (A) by pulling away using a set of pliers.

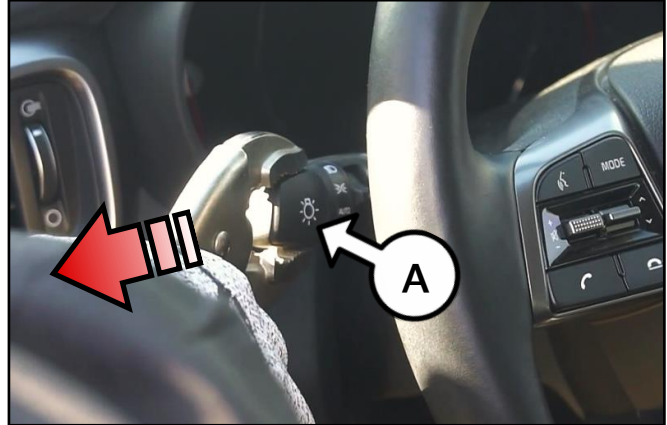

2. Cut the locking pin off by using a set of nipper pliers.



3. Remove the moving block (B) shown on the right.

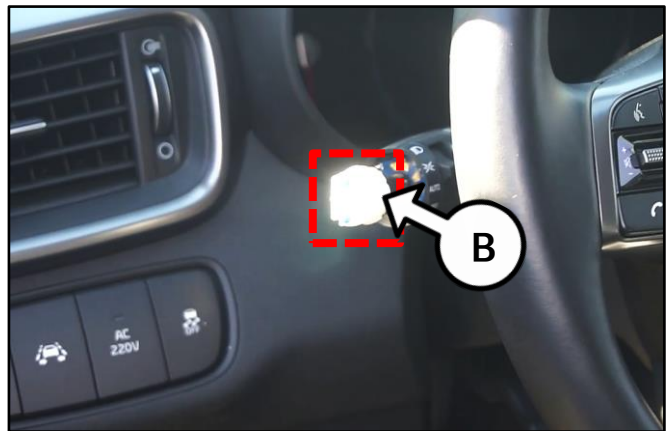

4. Apply grease to the printed circuit board (PCB) using the supplied grease PD20K-2 (2 grams).

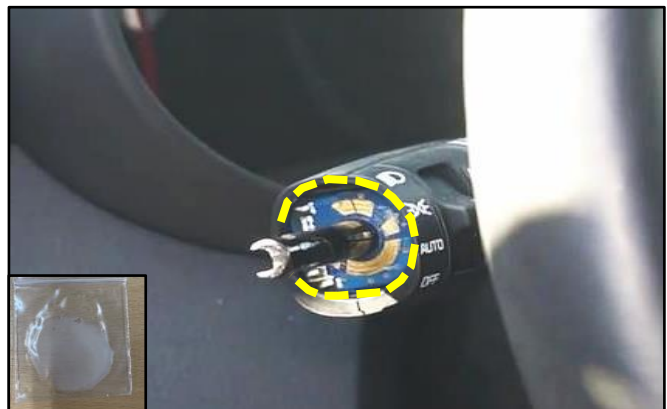

SUBJECT: MULTIFUNCTION SWITCH REPAIR

5. Insert/lock the new moving block and knob cover and secure it to the multifunction switch handle as shown.

- A. Knob Cover
- B. Moving Block

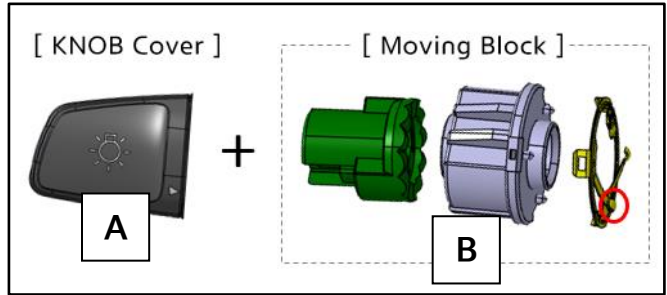

6. Ensure to secure the knob cover (A) using the locking pin shown.

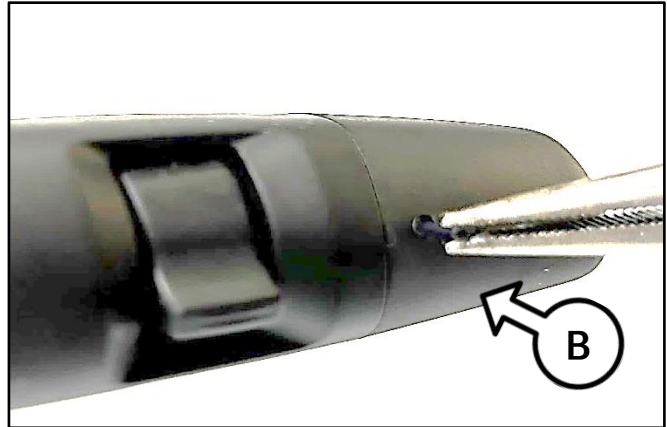

SUBJECT:

**MULTIFUNCTION SWITCH REPAIR****AFFECTED VEHICLE RANGE:**

Model	Production Date Range
Sorento (UMa)	October 27, 2014 to March 7, 2018

**REQUIRED PART:**

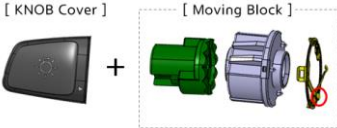
Part Name	Lighting Switch	Part Number	Figure	Qty.
Knob Cover and Moving Block	Automatic Type	93400 C6769QQK		1
	Manual Type	93400 C6770QQK		

**WARRANTY INFORMATION:****N Code: I14 C Code: ZZ3**

Claim Type	Causal P/N	Qty.	Repair Description	Labor Op Code	Op Time	Replacement P/N	Qty.
W	93400 C5050 or 93400 C5751	0	Headlight Flickering Diagnosis	232A10I0	0.2 M/H	N/A	0
			Multifunction Switch Repair	232A10R0	0.3 M/H	93400 C6769QQK or 93400 C6770QQK	1