



Service Bulletin

Bulletin No.: 23-NA-079

Date: May, 2023

TECHNICAL

Subject: Front License Plate Mounting Bracket Installation

Brand:	Model:	Model Year:		VIN:		Engine:	Transmission:
		from	to	from	to		
Chevrolet	Silverado EV	2024	2024			All	All

Involved Region or Country	North America
Condition	During PDI it may be necessary to install the front license plate bracket.

Service Procedure

Important: Service agents must comply with all International, Federal, State, Provincial, and/or Local laws applicable to the activities it performs under this bulletin, including but not limited to handling, deploying, preparing, classifying, packaging, marking, labeling, and shipping dangerous goods. In the event of a conflict between the procedures set forth in this bulletin and the laws that apply to your dealership, you must follow those applicable laws.

Note: This installation procedure should only be completed when the front license plate is ready to be installed.

1. Locate the front license plate bracket and rivets from the dealer pack that came with the vehicle.

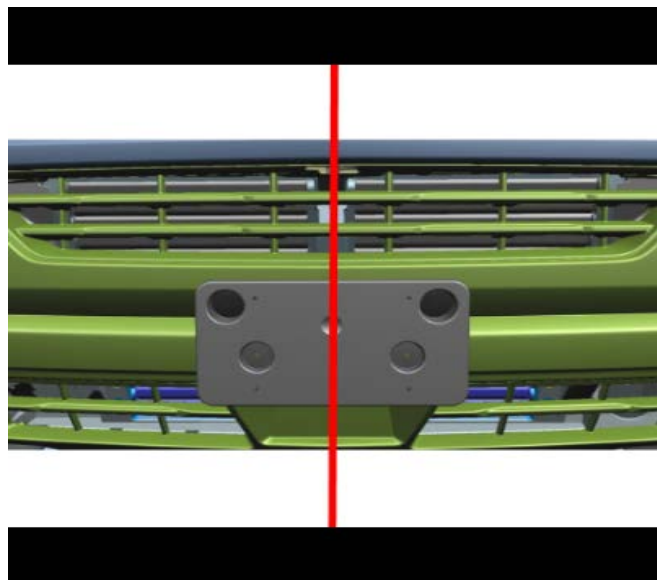

2. Align the front license plate bracket on the front fascia surface where the license plate will be installed. The license plate bracket should be centered on the front fascia.

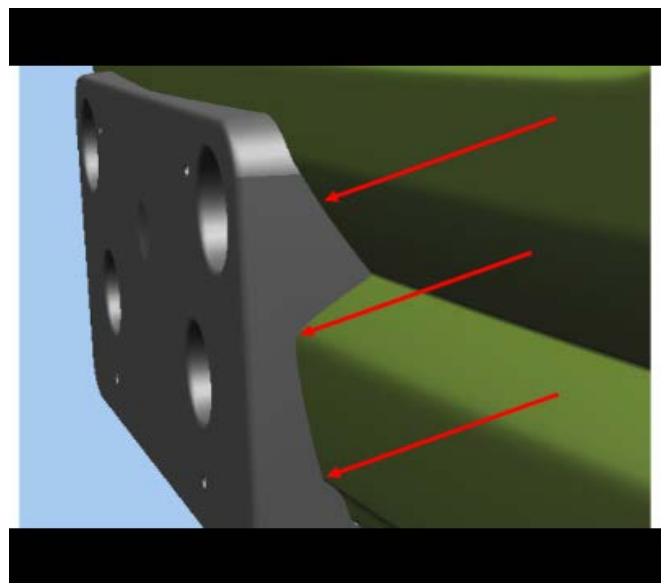

6329434

3. The front license plate bracket should sit flush to the contours of the front fascia.

6329433



6329435

- 4. Mark each of the 4 mounting locations.
- 5. Remove the license plate bracket and set aside temporarily.
- 6. Using a 3/16" (5.0mm) drill bit, drill holes through the front fascia in each of the 4 marked mounting locations.
- 7. Reposition the front license plate bracket in place over the 4 mounting holes and install the 4 rivets included, firmly securing the front license plate bracket in place to the front fascia.

Warranty Information

The labor time for installing the front license plate is included in the PDI time.

Version	1
Modified	Released May 01, 2023

