



# FIELD KIT

## Vermeer Corporation

Environmental  
Pella, Iowa 50219 USA

<b>FIELD CAMPAIGN KIT #:</b>	<b>IK004309</b>	<b>DATE:</b>	<b>20 February 2023</b>
<b>For Dealer Reference: Service Bulletin #: SVC2023-023</b>			

### Fender Conversion

<b>CAMPAIGN TYPE:</b>	<b>Recommended</b>
<b>CAMPAIGN CATEGORY:</b>	<b>Kit and Bulletin</b>

<b>MACHINE/ ATTACHMENT MODEL(S):</b>	<b>SERIAL NUMBERS:</b>		
	<b>Included</b>	<b>Excluded</b>	<b>Kit version</b>
<b>BC1000XL</b>	<b>27196 – 51582</b>	<b>None</b>	<b>IK01 (Yellow Paint – 7000 lb and 5200 lb axle)</b>
<b>BC1000XL</b>	<b>27196 – 51582</b>	<b>None</b>	<b>IK02 (Chevy White, Wright Tree White or Nelson White Paint – 7000 lb and 5200 lb axle)</b>
<b>BC1000XL</b>	<b>27196 – 51582</b>	<b>None</b>	<b>IK03 (Asplundh Paint – 7000 lb and 5200 lb axle)</b>
<b>BC1000XL</b>	<b>27196 – 51582</b>	<b>None</b>	<b>IK04 (Sunbelt Green Paint – 7000 lb and 5200 lb axle)</b>
<b>BC1000XL</b>	<b>27196 – 51582</b>	<b>None</b>	<b>IK05 (Misc Special Paint – 7000 lb and 5200 lb axle)</b>
<b>BC1000XL</b>	<b>27196 – 51582</b>	<b>None</b>	<b>IK06 (Yellow Paint – 7000 lb and 5200 lb axle)</b>
<b>BC1000XL</b>	<b>27196 – 51582</b>	<b>None</b>	<b>IK07 (Chevy White, Wright Tree White or Nelson White Paint – 7000 lb and 5200 lb axle)</b>

<b>BC1000XL</b>	<b>27196 – 51582</b>	<b>None</b>	<b>IK08 (Asplundh Paint – 7000 lb and 5200 lb axle)</b>
<b>BC1000XL</b>	<b>27196 – 51582</b>	<b>None</b>	<b>IK09 (Sunbelt Green Paint – 7000 lb and 5200 lb axle)</b>
<b>BC1000XL</b>	<b>27196 – 51582</b>	<b>None</b>	<b>IK10 (Misc Special Paint – 7000 lb and 5200 lb axle)</b>
<b>BC1000XL</b>	<b>27196 – 51582</b>	<b>None</b>	<b>IK11 (Yellow Paint – 7000 lb axle)</b>
<b>BC1000XL</b>	<b>27196 – 51582</b>	<b>None</b>	<b>IK12 (Chevy White, Wright Tree White or Nelson White Paint – 7000 lb axle)</b>
<b>BC1000XL</b>	<b>27196 – 51582</b>	<b>None</b>	<b>IK13 (Asplundh Paint – 7000 lb axle)</b>
<b>BC1000XL</b>	<b>27196 – 51582</b>	<b>None</b>	<b>IK14 (Sunbelt Green Paint – 7000 lb axle)</b>
<b>BC1000XL</b>	<b>27196 – 51582</b>	<b>None</b>	<b>IK15 (Misc Special Paint – 7000 lb axle)</b>
<b>BC1000XL</b>	<b>27196 – 51582</b>	<b>None</b>	<b>IK16 (Yellow Paint – 7000 lb axle)</b>
<b>BC1000XL</b>	<b>27196 – 51582</b>	<b>None</b>	<b>IK17 (Chevy White, Wright Tree White or Nelson White Paint – 7000 lb axle)</b>
<b>BC1000XL</b>	<b>27196 – 51582</b>	<b>None</b>	<b>IK18 (Asplundh Paint – 7000 lb axle)</b>
<b>BC1000XL</b>	<b>27196 – 51582</b>	<b>None</b>	<b>IK19 (Sunbelt Green Paint – 7000 lb axle)</b>
<b>BC1000XL</b>	<b>27196 – 51582</b>	<b>None</b>	<b>IK20 (Misc Special Paint – 7000 lb axle)</b>

**Purpose:** This kit includes parts and instructions to replace left-hand and right-hand fenders. IK01-IK10 are for units that have 5200-lb axles or 7000-lb axles that have flange nuts holding the rims on the axle. IK11-IK20 are for units that have 7000-lb axles that have cone style nuts holding the rims on the axle.

**Special tools and conditions:**

- None

**Shutdown procedure: BC1000XL**

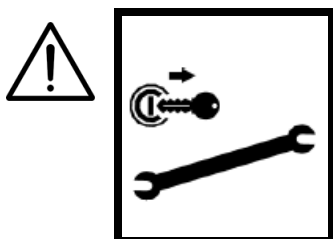

**WARNING:** Failure to use shutdown procedure can result in unexpected hazard(s). Death or serious injury could result due to entanglement, crushing, cutting or other hazardous contact. Follow shutdown procedure after operating, before performing any service or maintenance and before transporting.

**NOTICE:** For your safety and the safety of others, use the shutdown procedure before working on the machine for any reason including servicing, cleaning, unclogging, inspecting.

A variation of this procedure may be used if so instructed within this manual, or if an emergency requires it.



1. Return upper feed control bar to center stop position.
2. Slow the engine speed to low idle.

**NOTICE:** Whenever practical and safe, allow engine to idle for one to five minutes before shutting down after operating at full power. Please consult machine's engine manual for details.

3. Wait for cutter drum to slow.
4. Place cutter engage lever in the disengaged position.
5. Turn ignition key to off position.
6. Wait for the cutter drum and belt to stop.

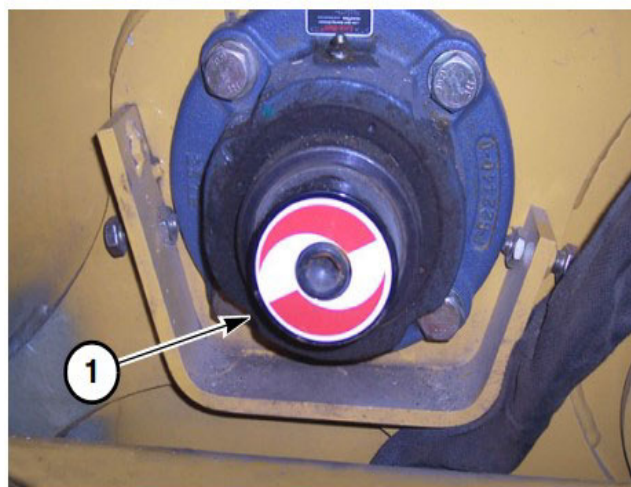

**NOTICE:** Cutter drum rotation can be checked by looking at the end of the shaft (1) on the left side of the cutter wheel housing. The cutter drum will continue to turn for a short time after the engine has stopped.

7. Remove ignition key.
8. Close and latch feed table.



Unless indicated, new parts from kit have callouts with numbers. Callouts with letters indicate existing parts or general items.



**WARNING:** Raised load can shift or fall. Death or serious injury could be possible if struck or crushed by falling load. Never allow anyone under a raised load unless load is securely supported to prevent it from shifting or falling.

**Procedure 1:Fender removal IK01, IK02, IK03, IK04 and IK05**

1. If machine is equipped with flag mount **(A)** and screws **(A)**, remove and retain from left fender.

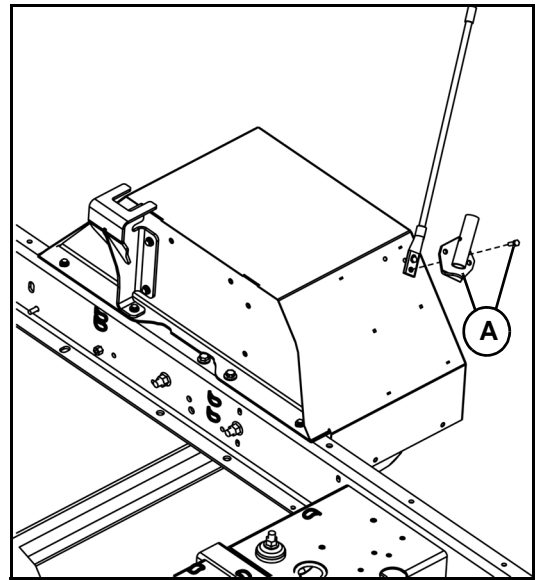

2. If machine is equipped with marker whip **(B)** and screws **(B)**, remove and retain from left fender.

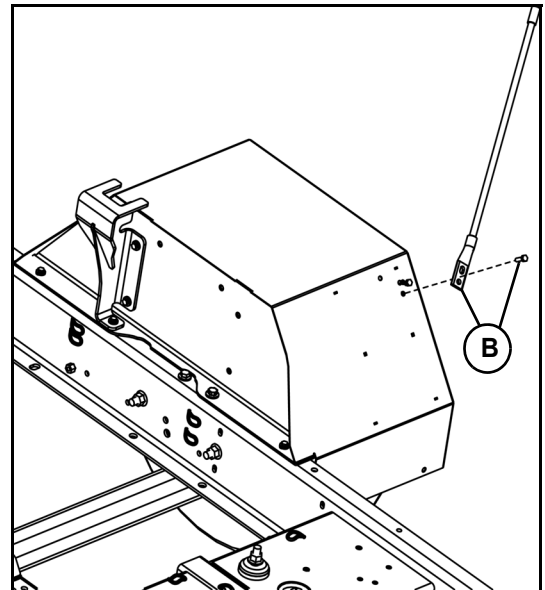

3. Remove and discard four screws that attach the left fender to frame on back side.

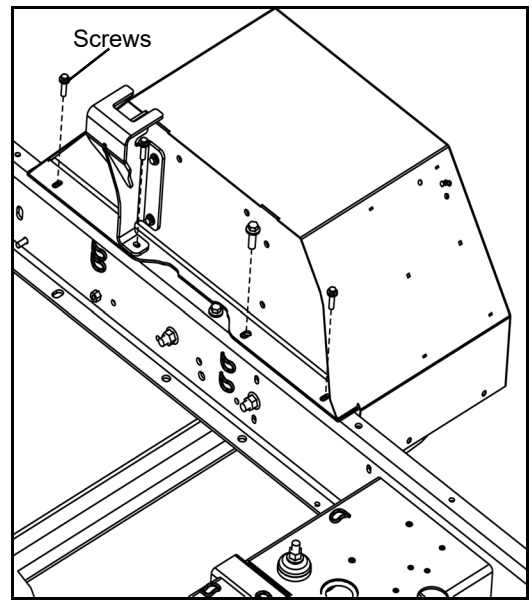

4. Remove and discard screws, nuts and washer that attach the left fender to the frame.

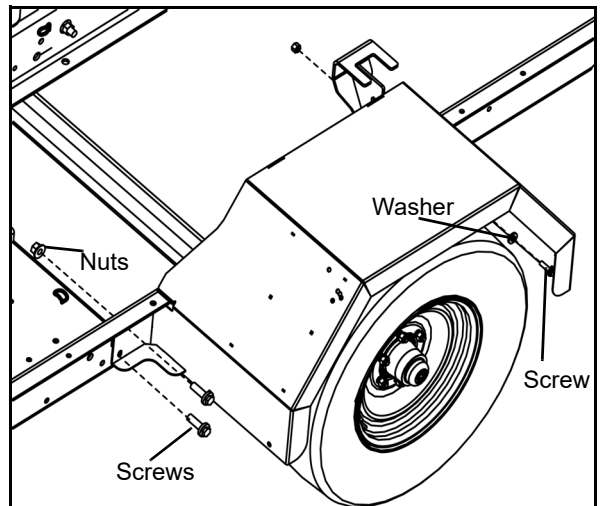

5. Remove and discard left fender and feed roller jack stand.

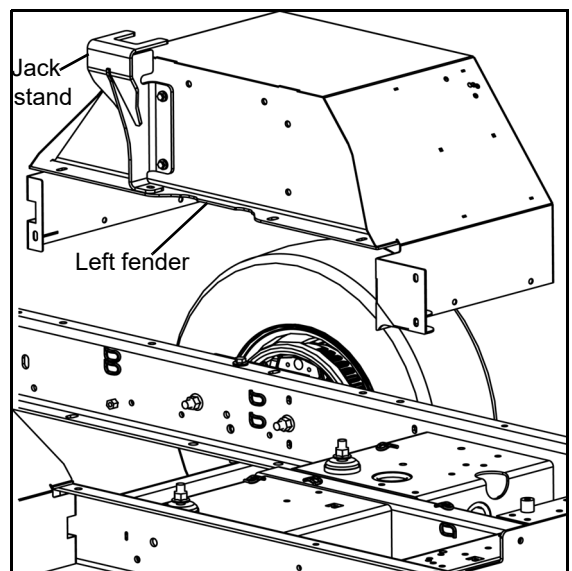

6. If machine is equipped with cone storage (C) and screws (C), remove and retain from right fender.

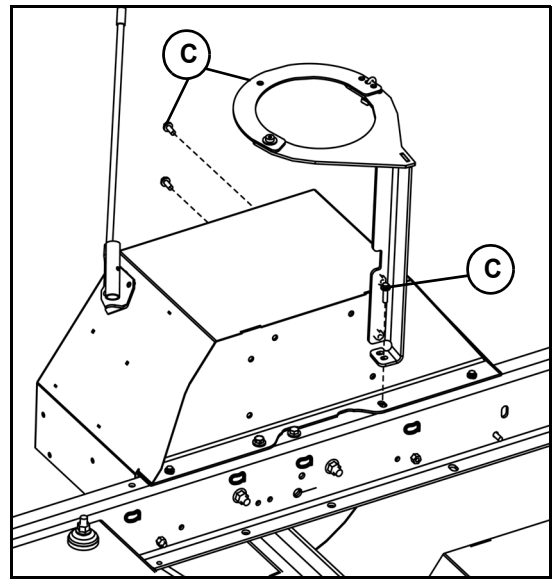

7. If machine is equipped with flag mount (D) and screws (D), remove and retain from right fender

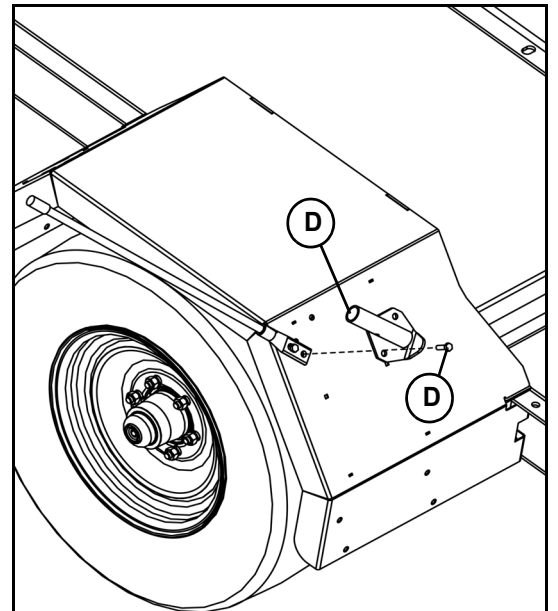

8. If machine is equipped with marker whip (E) and screws (E), remove and retain from right fender.

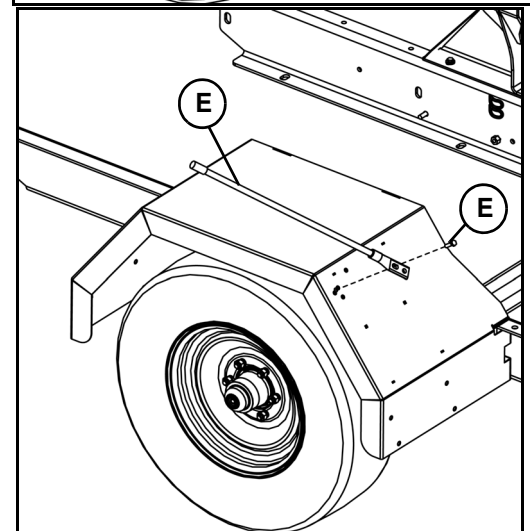

9. Remove and discard four screws that attach the right fender to frame on back side.

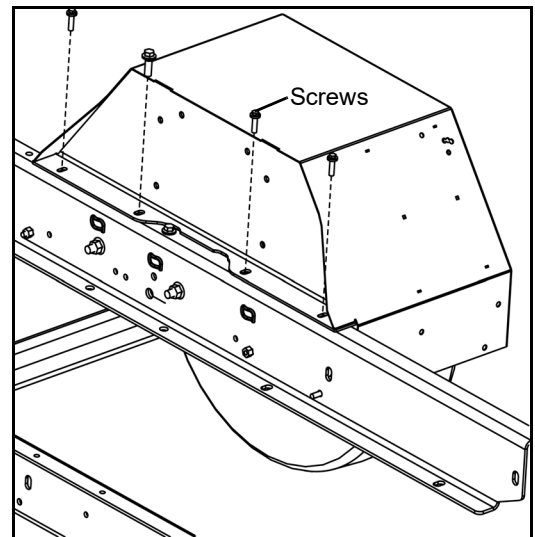

10. Remove and discard two screws, two washers and two nuts that attach the right fender to the frame on the inside of the fender.

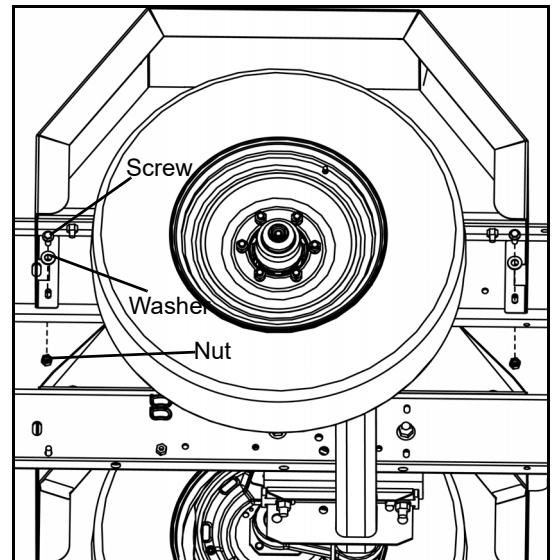

11. Remove and discard right fender

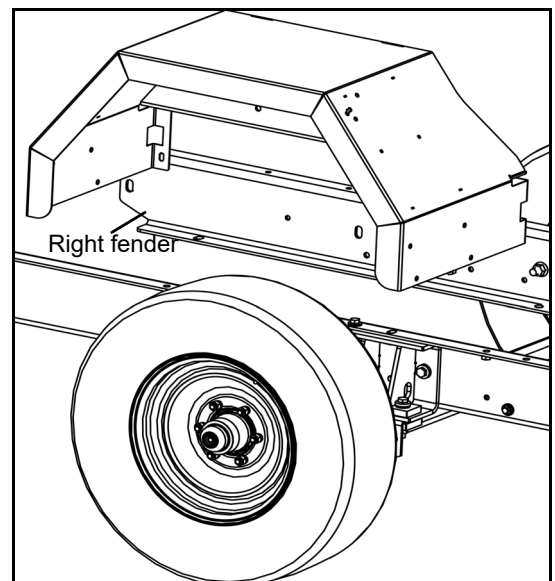

## Procedure 2:Fender replacement IK01, IK02, IK03, IK04 and IK05

1. Clean mounting surface on frame before attaching new left fender (1).
2. Align new left fender (1) up with holes on mainframe.

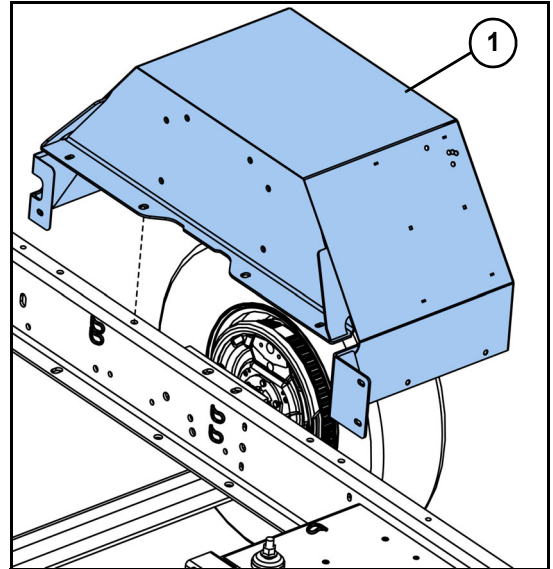

Install new left fender loosely. Once all hardware is installed, make sure fender is square and flat to mainframe before tightening.

3. Attach new left fender (1) on mainframe using three screws (2), two washers (3), one screw (4) and one nut (5). Torque screws (2) to 53 ft-lb (72 Nm). Torque screw (4) to 148 ft-lb (201 Nm).

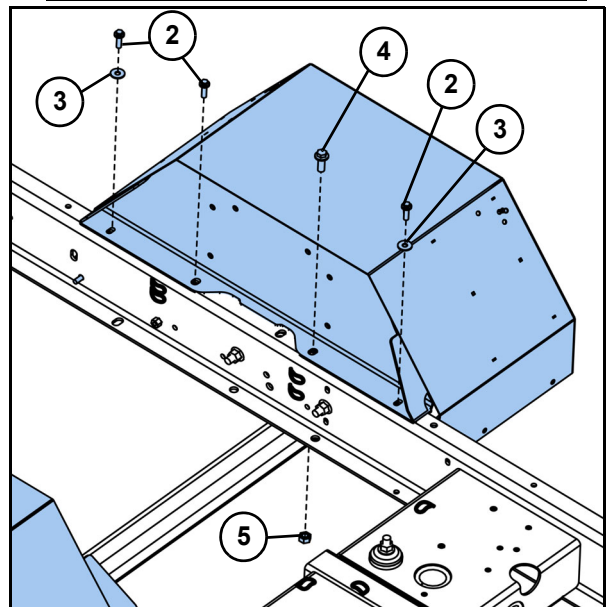

4. Attach the sides of left fender (1) on mainframe using three screws (2), one washer (3) and three nuts (6). Torque screws (2) to 53 ft-lb (72 Nm).

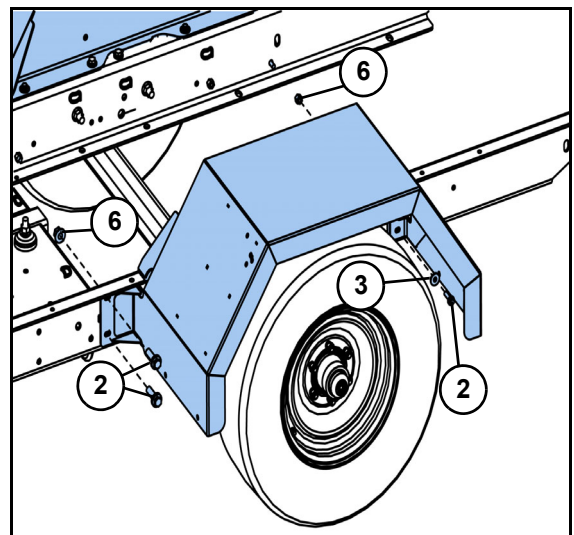

5. Attach new feed roller jack stand (7) on left fender (1) using two screws (8), two nuts (3) and screw (2). Torque screws (2 and 8) to 53 ft-lb (72 Nm).

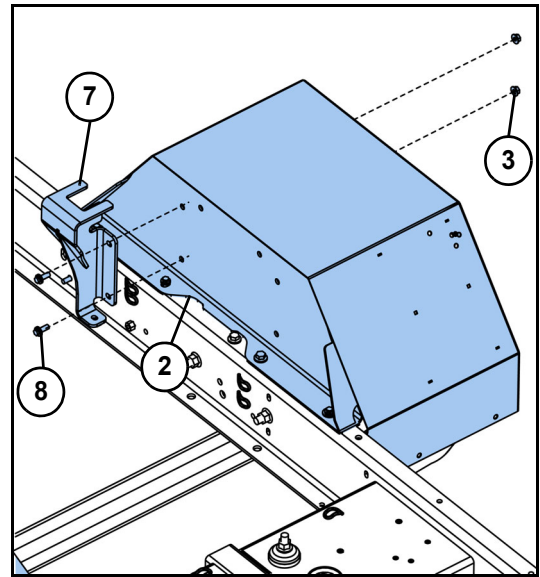

6. If machine was equipped with marker whip (B) and screws (B), reattach on left fender.

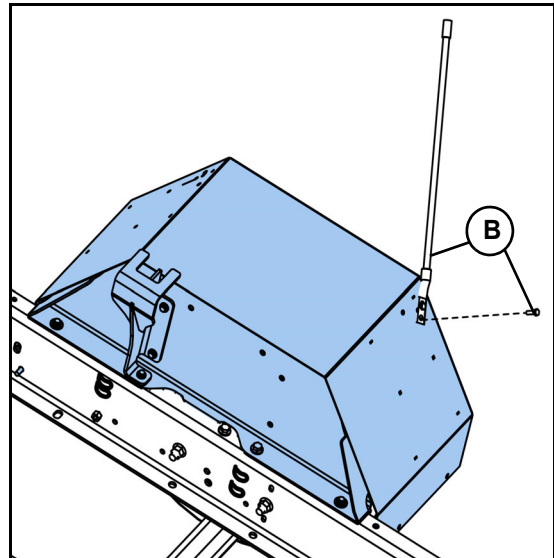

7. If machine was equipped with flag mount (A) and screws (A), reattach on left fender.

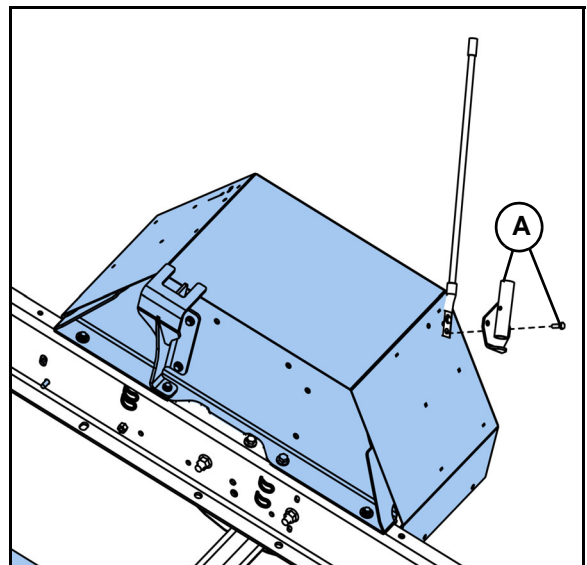

Install new right fender loosely. Once all hardware is installed, make sure fender is square and flat to mainframe before tightening.

- 8. Clean mounting surface on frame before attaching right fender (9).
- 9. Align new right fender (9) up with holes on mainframe.

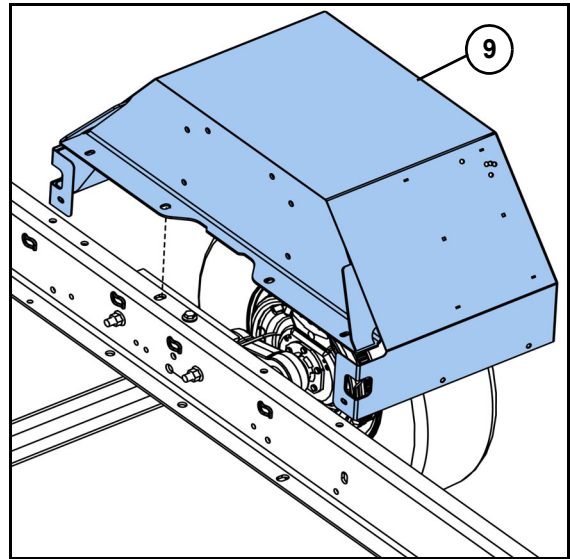

- 10. Attach new right fender (9) on mainframe using three screws (2), three washers (3), one screw (4) and one nut (5). Torque screws (2) to 53 ft-lb (72 Nm). Torque screw (4) to 148 ft-lb (201 Nm).

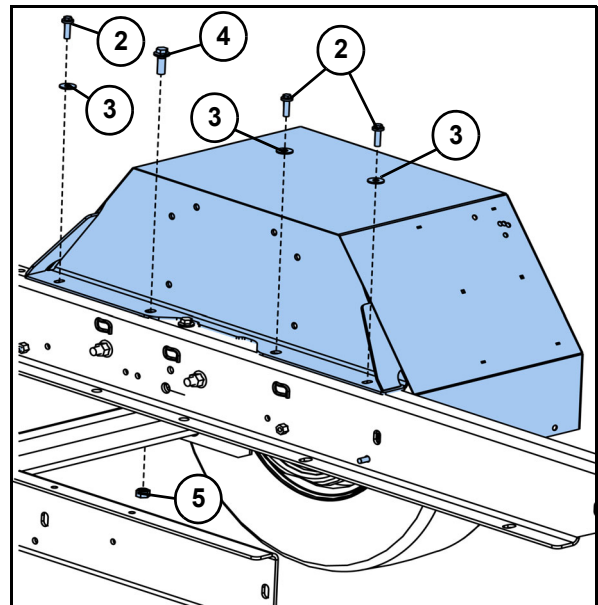

- 11. Attach the sides of right fender (9) on mainframe using two screws (2), two washers (3) and two nuts (6). Torque screws (2) to 53 ft-lb (72 Nm).

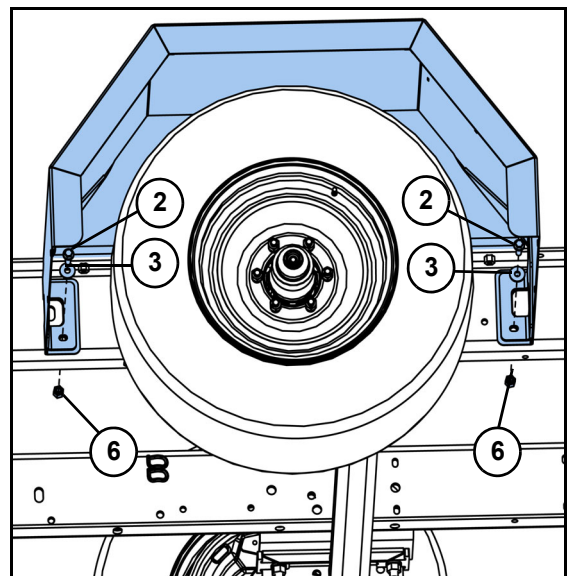

12. If machine was equipped with marker whip (E) and screws (E), reattach on right fender.

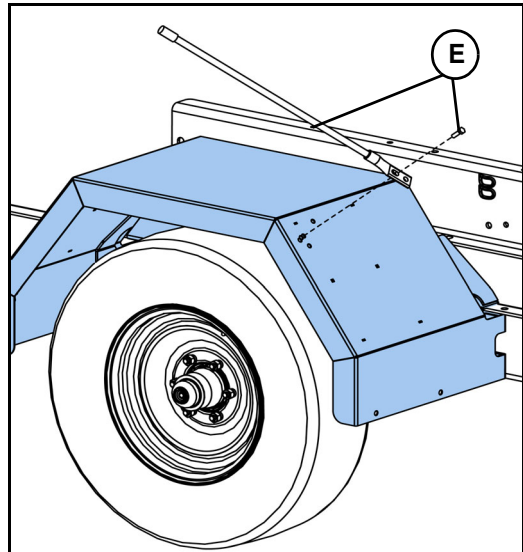

13. If machine was equipped with flag mount (D) and screws (D), reattach on right fender.

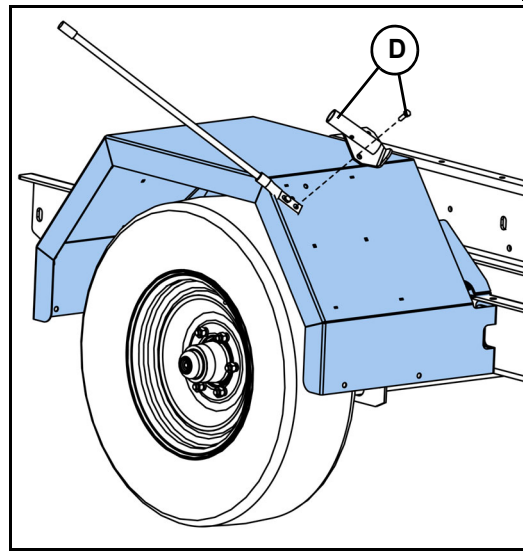

14. If machine was equipped with cone storage (C) and screws (C), reattach on right fender.

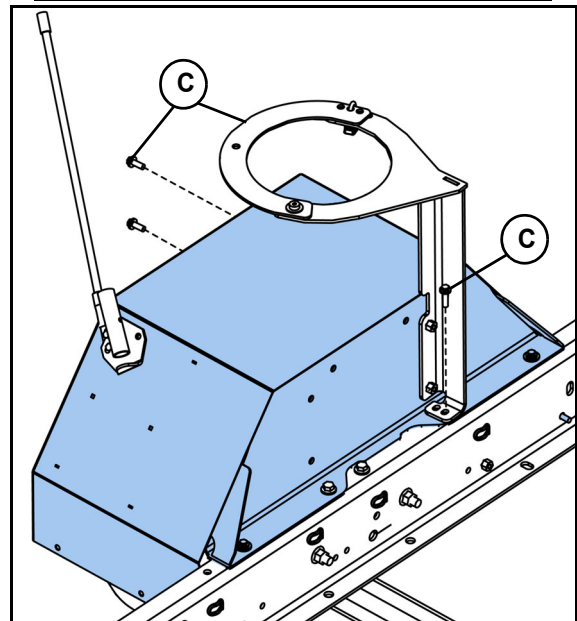

15. Attach one new warning decal (10) on the left and right fender.

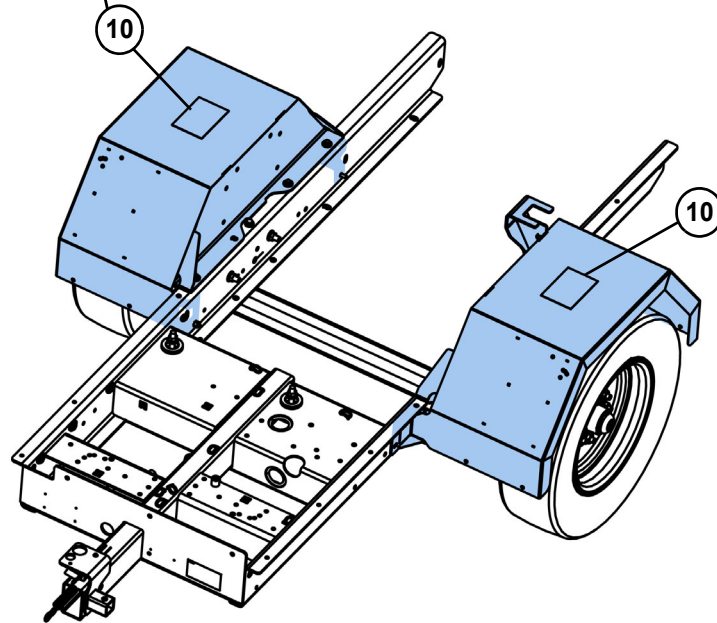
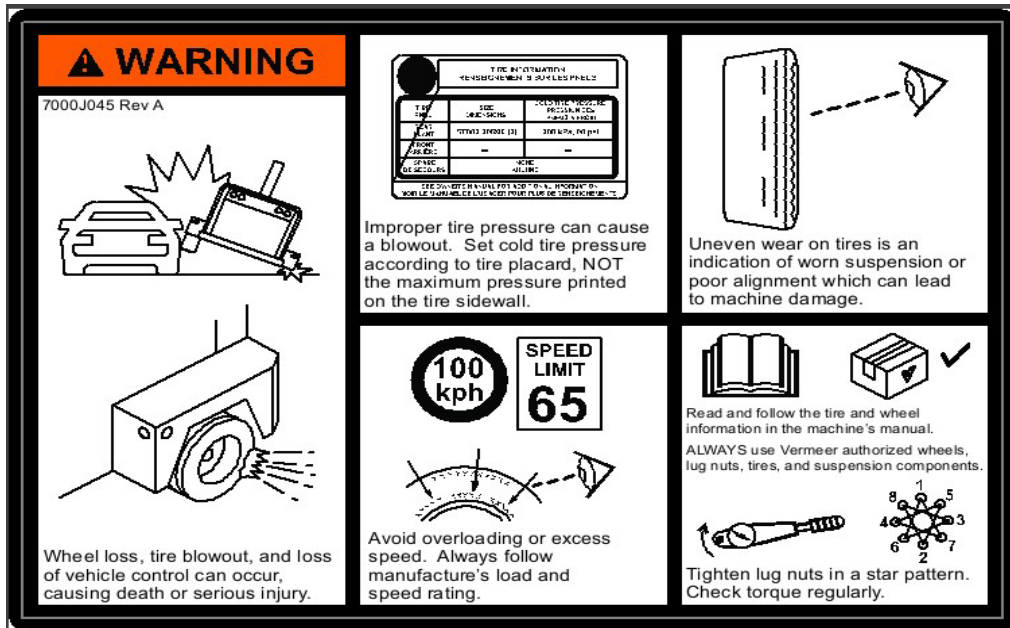

16. Remove Figure 1 and attach to the invoice or place in the manual storage box so unit owner can place with existing parts manual.



**WARNING:** Raised load can shift or fall. Death or serious injury could be possible if struck or crushed by falling load. Never allow anyone under a raised load unless load is securely supported to prevent it from shifting or falling.

**Procedure 1:Fender removal IK06, IK07, IK08, IK09 and IK10**

1. If machine is equipped with flag mount **(A)** and screws **(A)**, remove and retain from left fender.

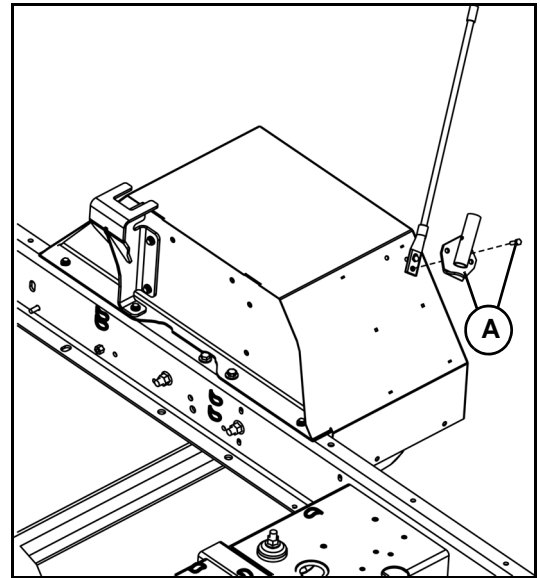

2. If machine is equipped with marker whip **(B)** and screws **(B)**, remove and retain from left fender.

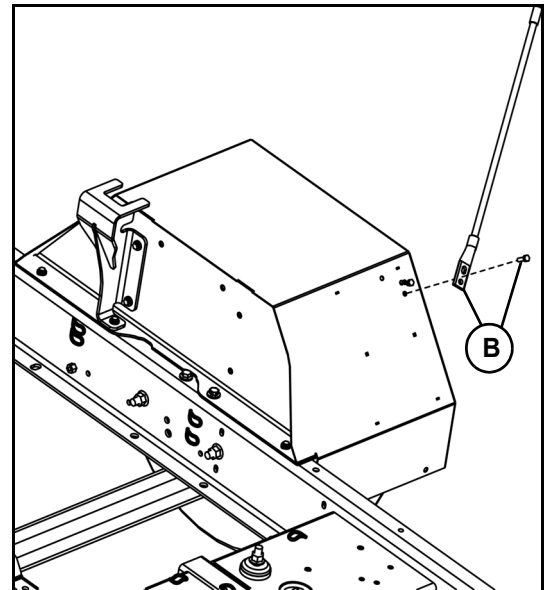

3. Remove and discard four screws that attach the left fender to frame on back side.

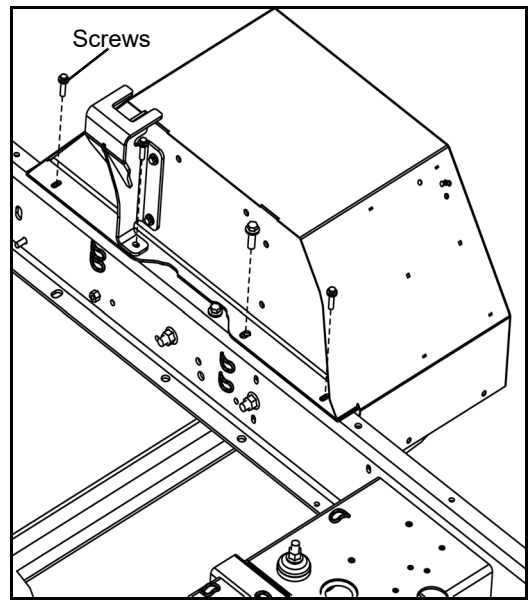

4. Remove and discard screws, nuts and washer that attach the left fender to the frame.

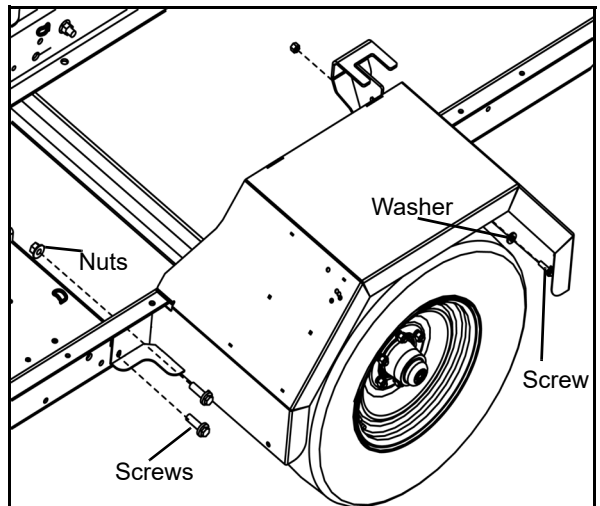

5. Remove and discard left fender and feed roller jack stand.

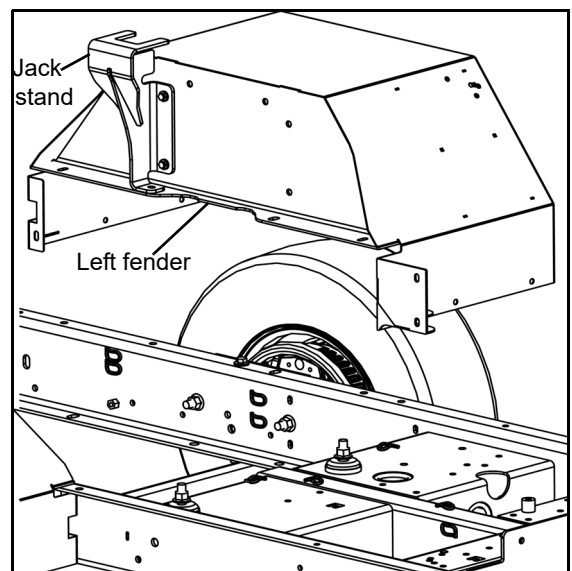

6. If machine is equipped with cone storage (C) and screws (C), remove and retain from right fender.

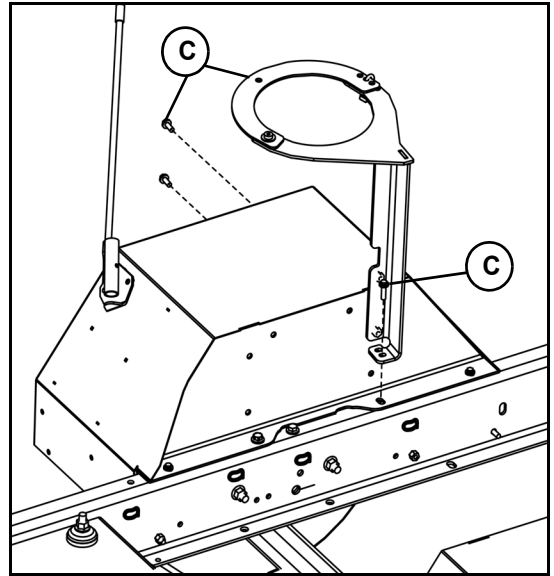

7. If machine is equipped with flag mount (D) and screws (D), remove and retain from right fender.

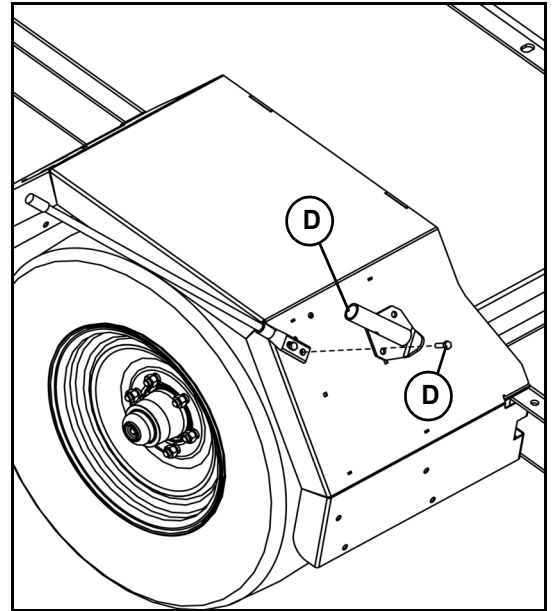

8. If machine is equipped with marker whip (E) and screws (E), remove and retain from right fender.

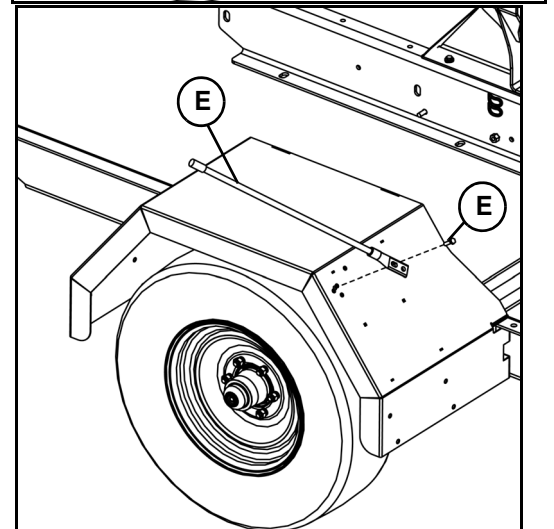

9. Remove and discard four screws that attach the right fender to frame on back side.

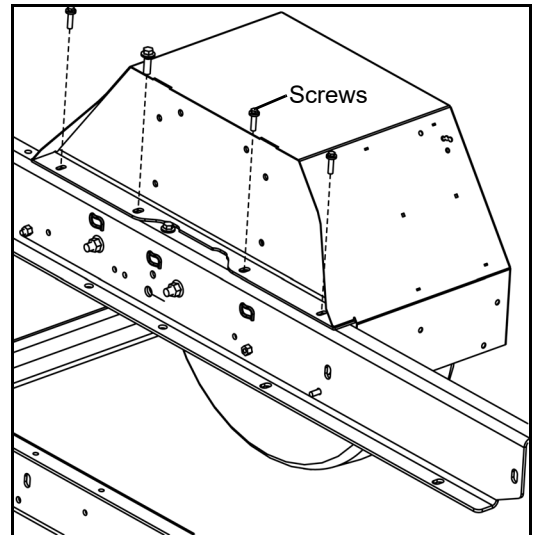

10. Remove and discard two screws, two washers and two nuts that attach the right fender to the frame on the inside of the fender.

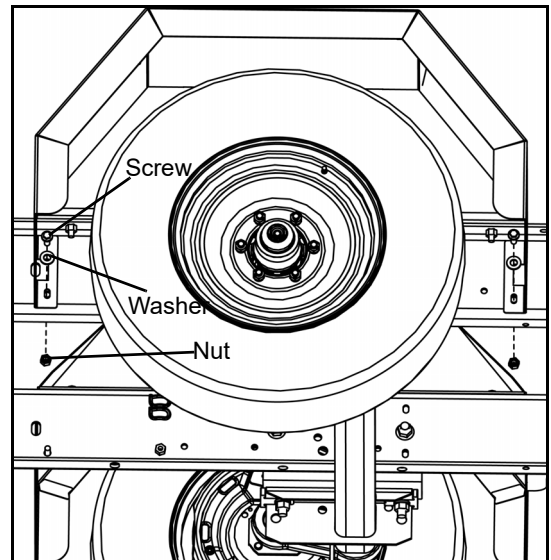

11. Remove and discard right fender.

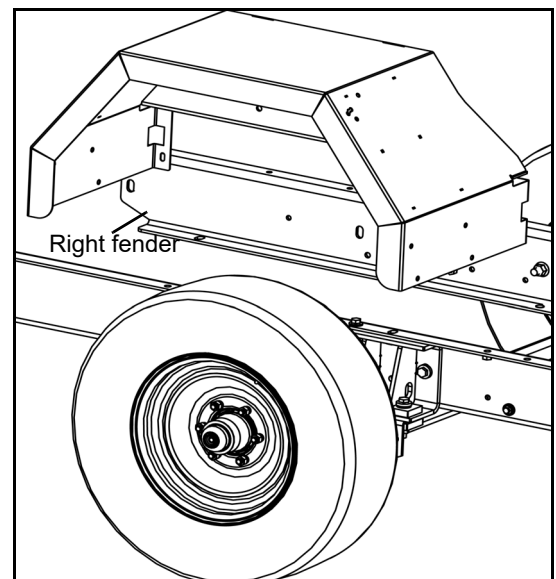

## Procedure 2:Fender replacement IK06, IK07, IK08, IK09 and IK10

1. Clean mounting surface on frame before attaching new left fender (1).
2. Align new left fender (1) up with holes on mainframe.

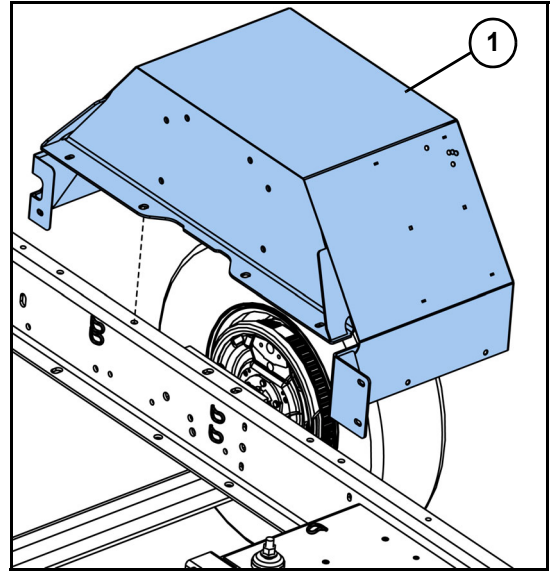

Install new left fender loosely. Once all hardware is installed, make sure fender is square and flat to mainframe before tightening.

3. Attach new left fender (1) on mainframe using three screws (2), two washers (3), one screw (4) and one nut (5). Torque screws (2) to 53 ft-lb (72 Nm). Torque screw (4) to 148 ft-lb (201 Nm).

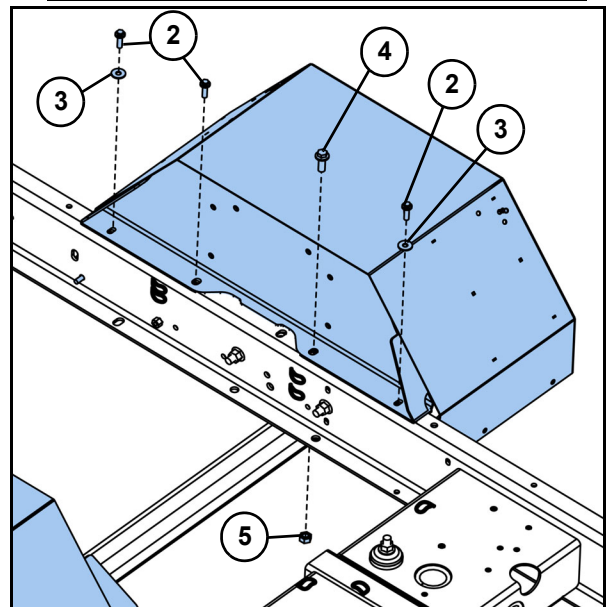

4. Attach the sides of left fender (1) on mainframe using three screws (2), one washer (3) and three nuts (6). Torque screws (2) to 53 ft-lb (72 Nm).

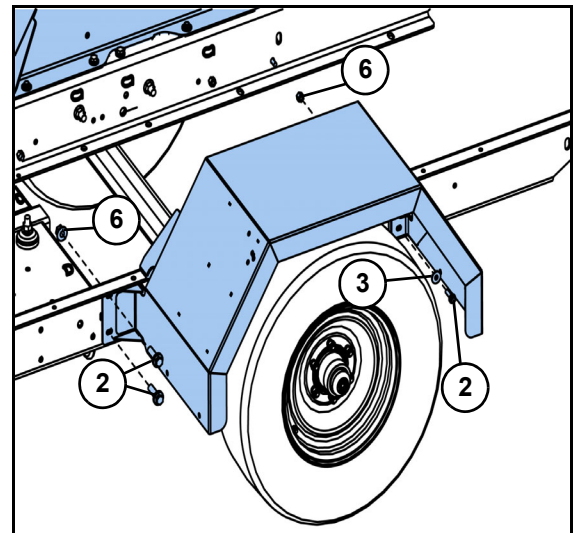

5. Attach new feed roller jack stand (7) on left fender (1) using two screws (8), two nuts (3) and screw (2). Torque screws (2 and 8) to 53 ft-lb (72 Nm).

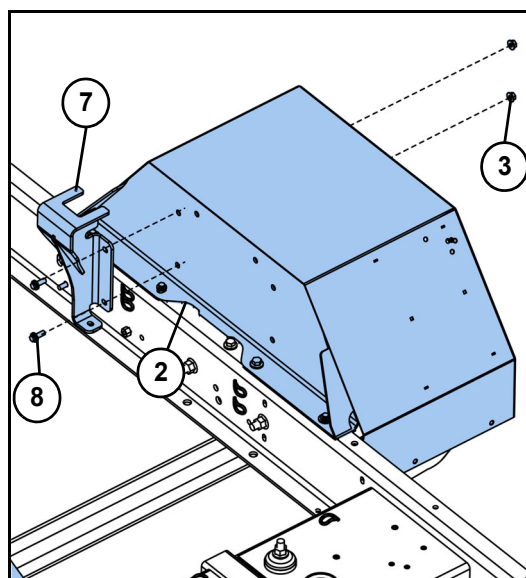

6. If machine was equipped with marker whip (B) and screws (B), reattach on left fender.

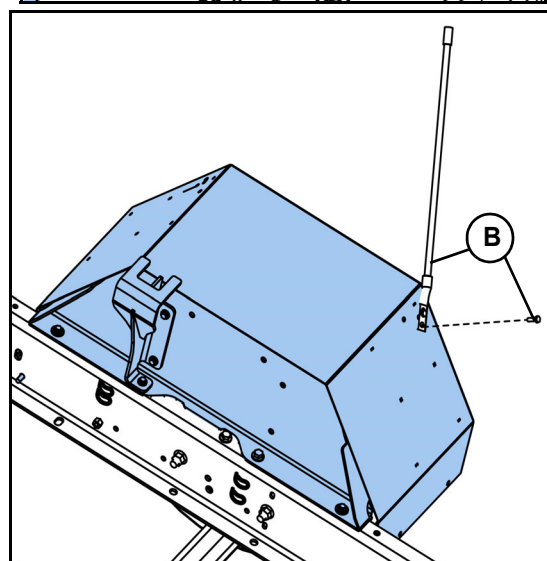

7. If machine was equipped with flag mount (A) and screws (A), reattach on left fender.

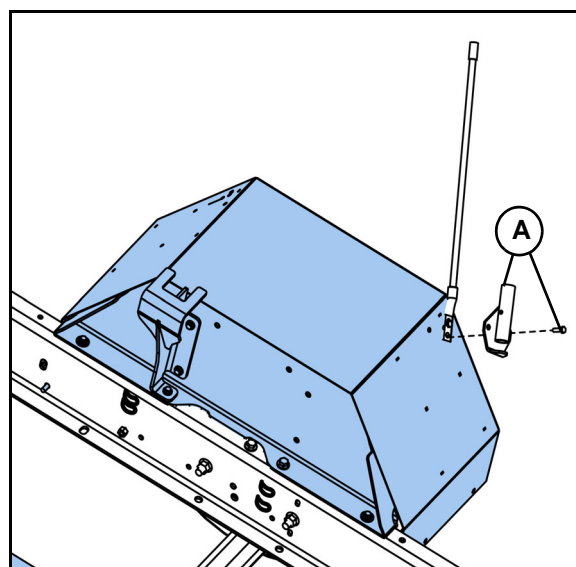

Install new right fender loosely. Once all hardware is installed, make sure fender is square and flat to mainframe before tightening.

- 8. Clean mounting surface on frame before attaching right fender (9).
- 9. Align new right fender (9) up with holes on mainframe.

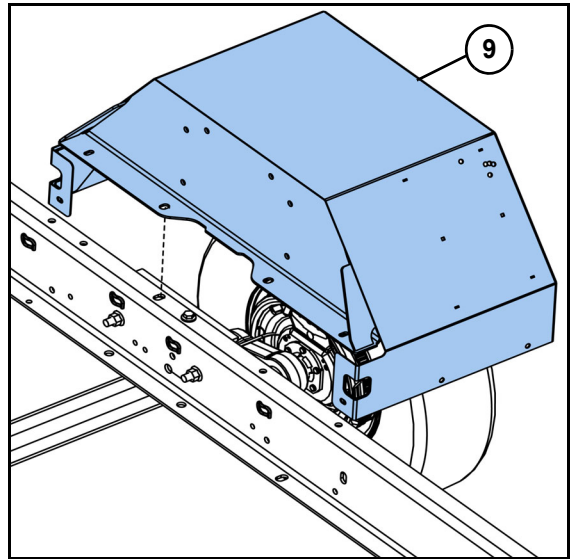

- 10. Attach new right fender (9) on mainframe using three screws (2), three washers (3), one screw (4) and one nut (5). Torque screws (2) to 53 ft-lb (72 Nm). Torque screw (4) to 148 ft-lb (201 Nm).

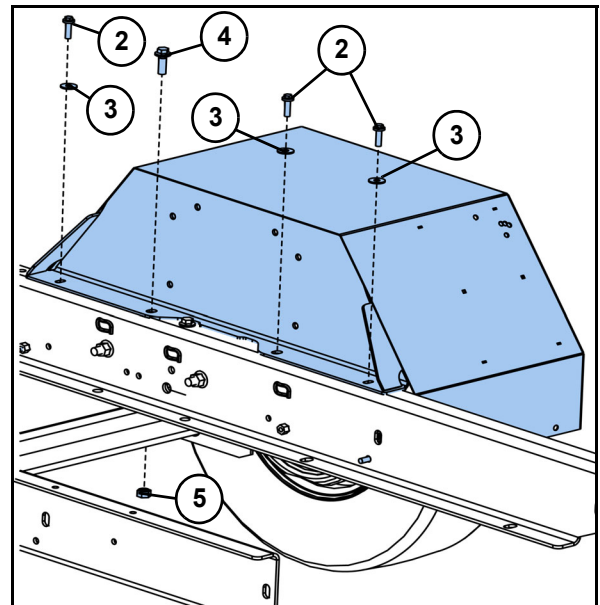

- 11. Attach the sides of right fender (9) on mainframe using two screws (2), two washers (3) and two nuts (6). Torque screws (2) to 53 ft-lb (72 Nm).

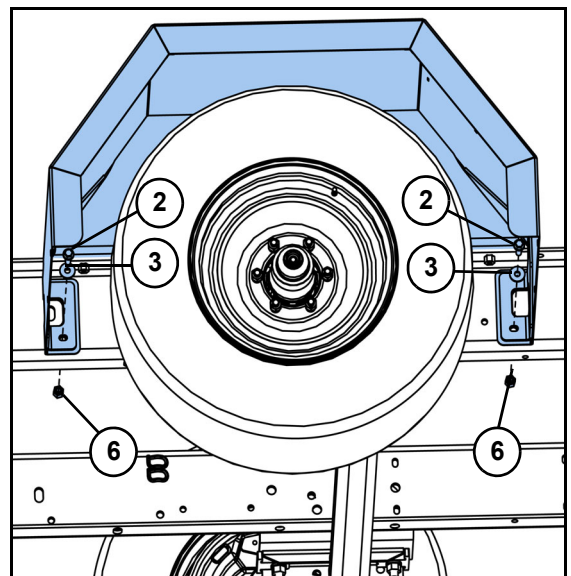

12. If machine was equipped with marker whip (E) and screws (E), reattach on right fender.

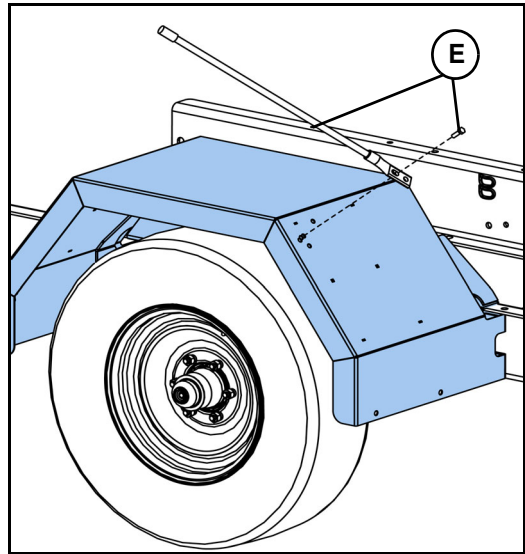

13. If machine was equipped with flag mount (D) and screws (D), reattach on right fender.

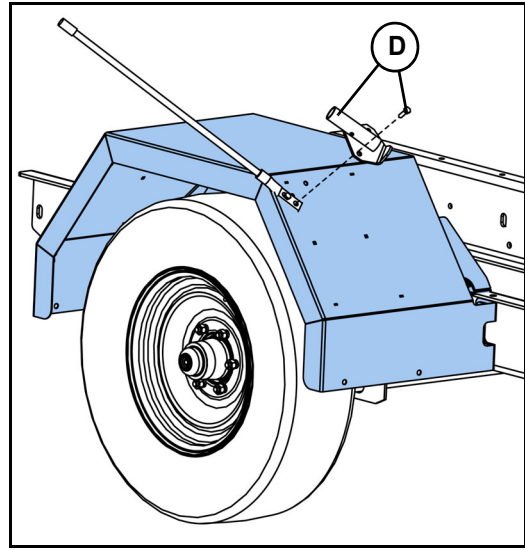

14. If machine was equipped with cone storage (C) and screws (C), reattach on right fender.

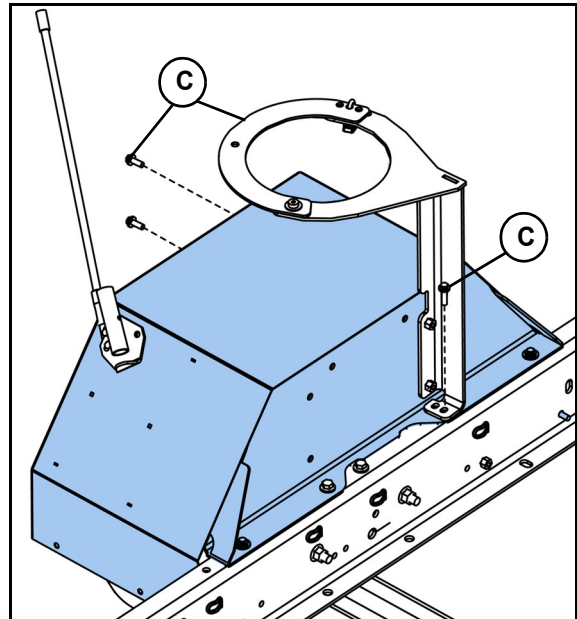

15. Attach one new warning decal (10) on the left and right fender.

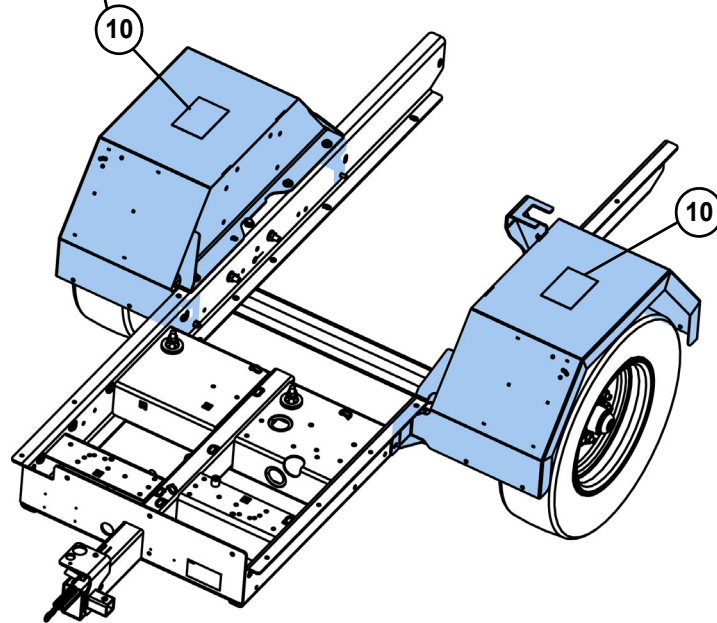
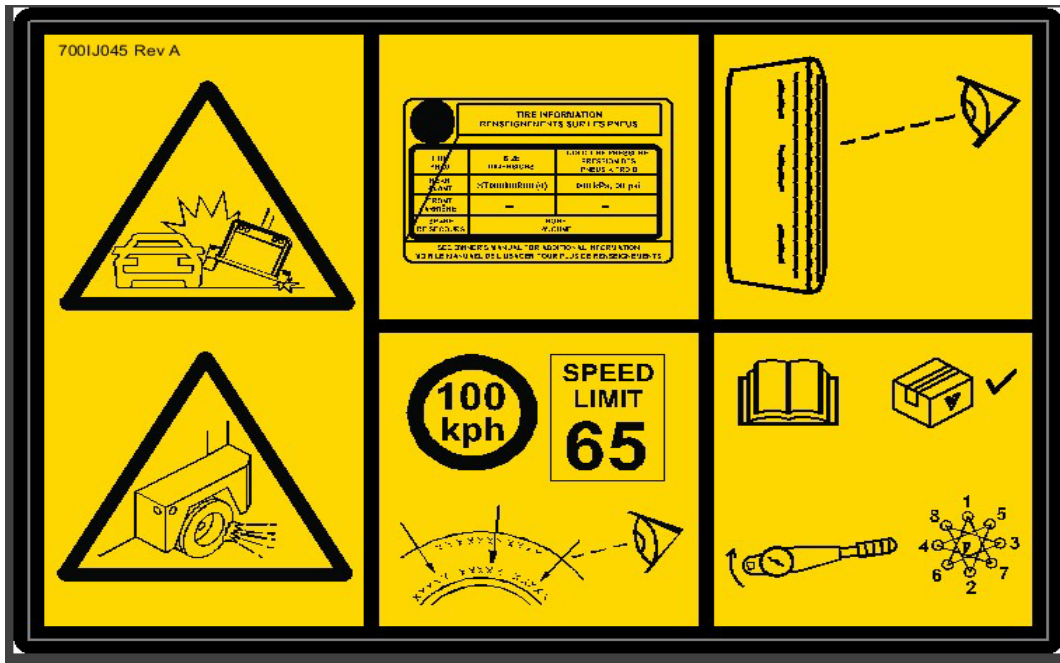

16. Remove Figure 2 and attach to the invoice or place in the manual storage box so unit owner can place with existing parts manual.



**WARNING:** Raised load can shift or fall. Death or serious injury could be possible if struck or crushed by falling load. Never allow anyone under a raised load unless load is securely supported to prevent it from shifting or falling.

**Procedure 1:Fender removal IK11, IK12, IK33, IK14 and IK15**

1. If machine is equipped with flag mount **(A)** and screws **(A)**, remove and retain from left fender.

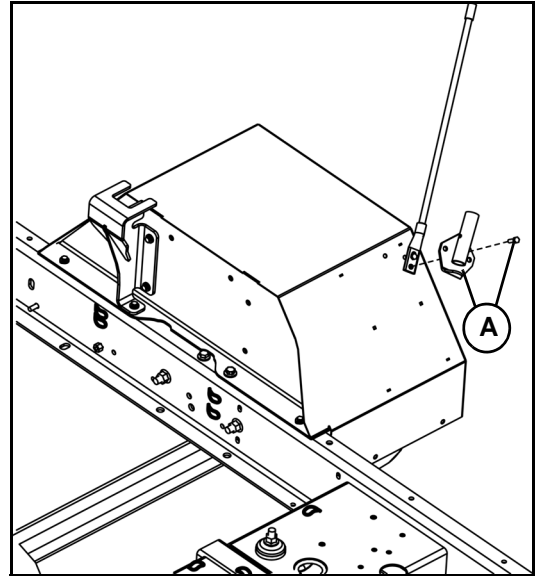

2. If machine is equipped with marker whip **(B)** and screws **(B)**, remove and retain from left fender.

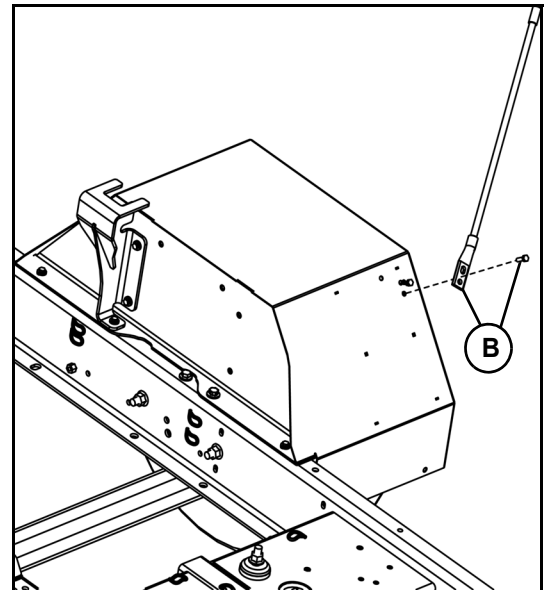

3. Remove and discard four screws that attach the left fender to frame on back side.

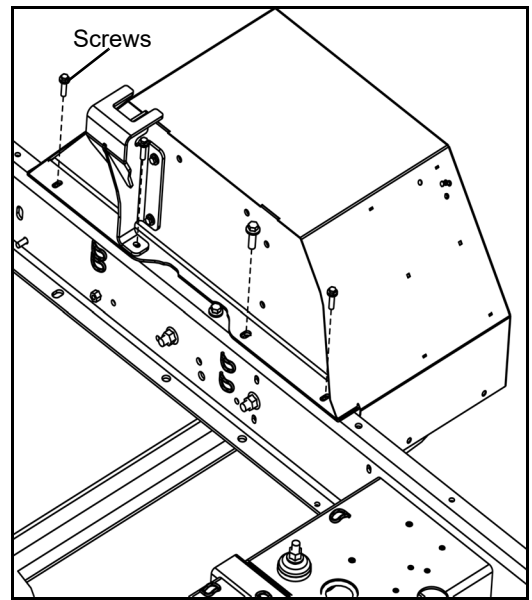

4. Remove and discard screws, nuts and washer that attach the left fender to the frame.

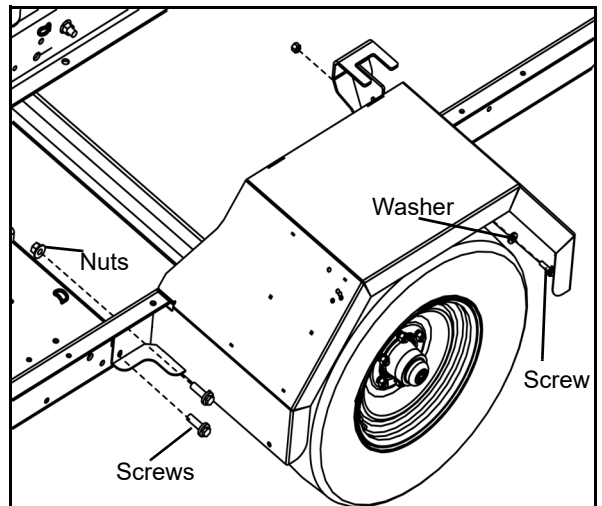

5. Remove and discard left fender and feed roller jack stand.

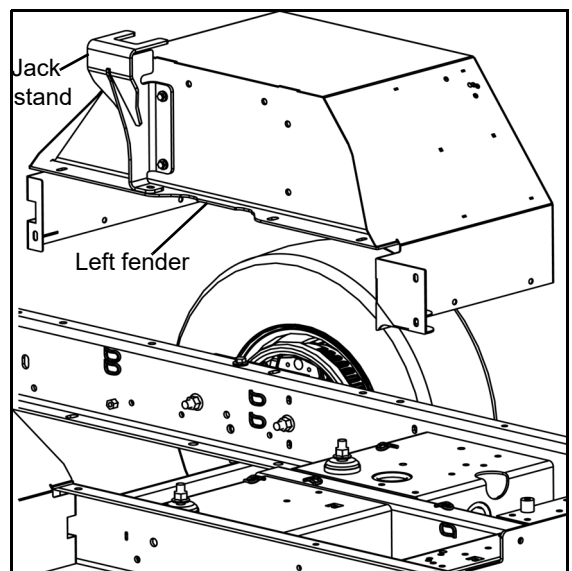

6. If machine is equipped with cone storage (C) and screws (C), remove and retain from right fender.

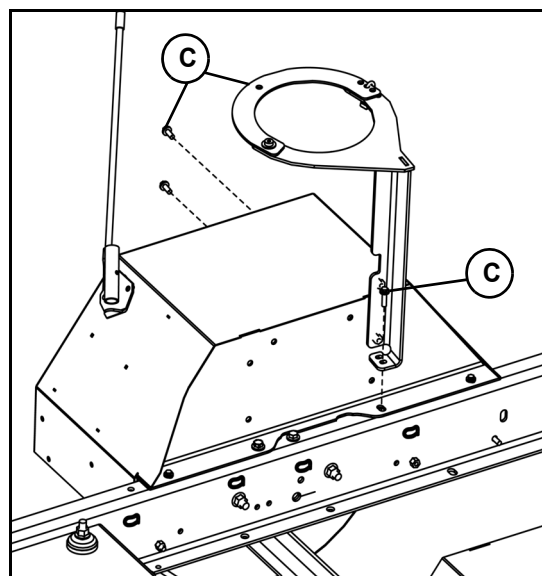

7. If machine is equipped with flag mount (D) and screws (D), remove and retain from right fender.

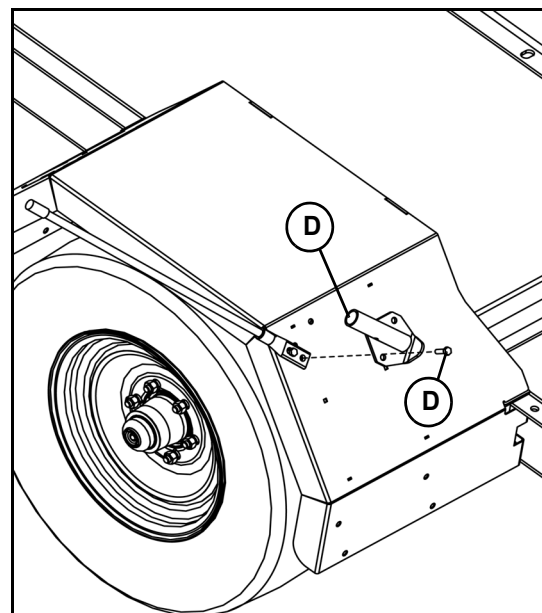

8. If machine is equipped with marker whip (E) and screws (E), remove and retain from right fender.

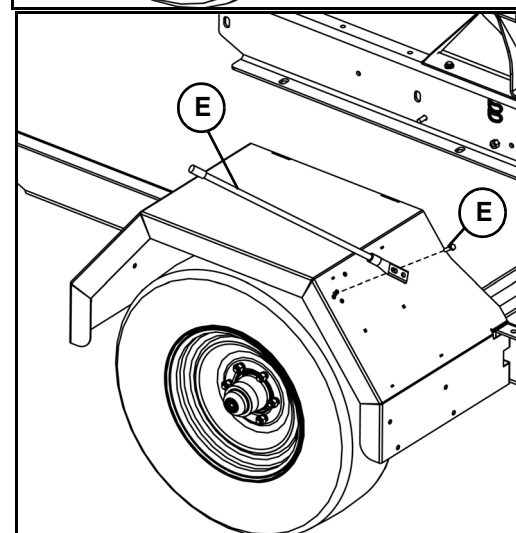

9. Remove and discard four screws that attach the right fender to frame on back side.

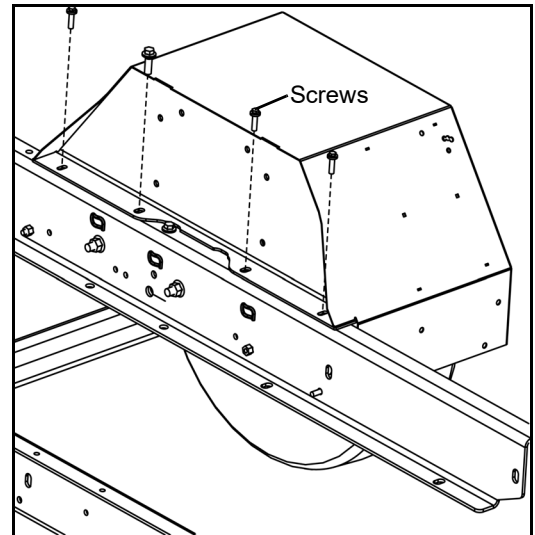

10. Remove and discard two screws, two washers and two nuts that attach the right fender to the frame on the inside of the fender.

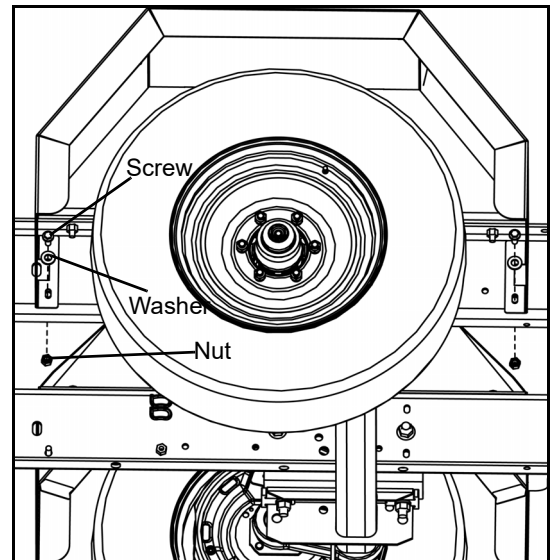

11. Remove and discard right fender.

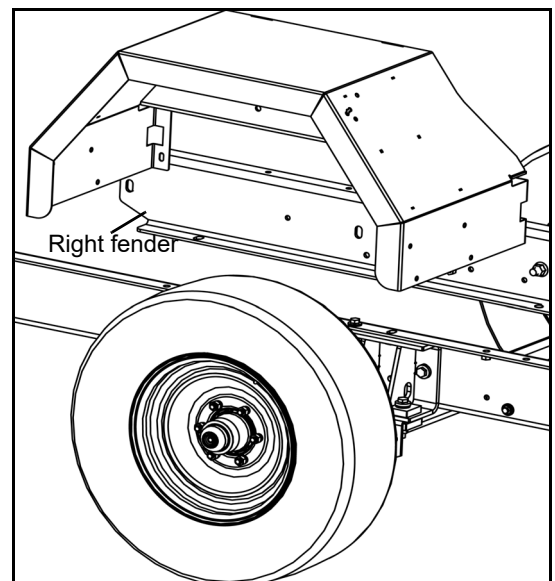

## Procedure 2:Fender replacement IK11, IK12, IK13, IK14 and IK15

1. Clean mounting surface on frame before attaching new left fender (1).
2. Align new left fender (1) up with holes on mainframe.

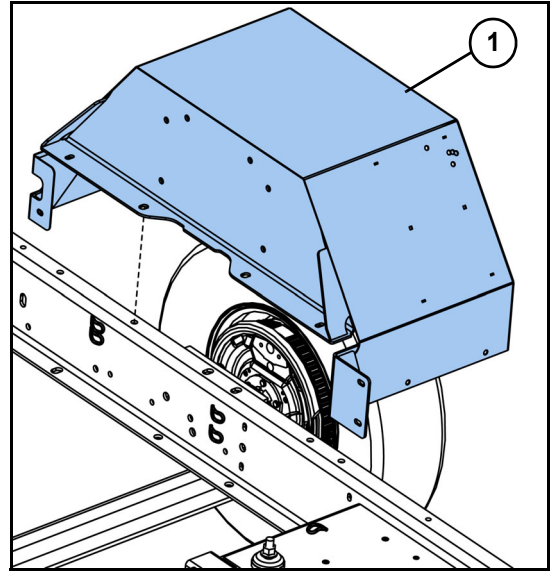

Install new left fender loosely. Once all hardware is installed, make sure fender is square and flat to mainframe before tightening.

3. Attach new left fender (1) on mainframe using three screws (2), two washers (3), one screw (4) and one nut (5). Torque screws (2) to 53 ft-lb (72 Nm). Torque screw (4) to 148 ft-lb (201 Nm).

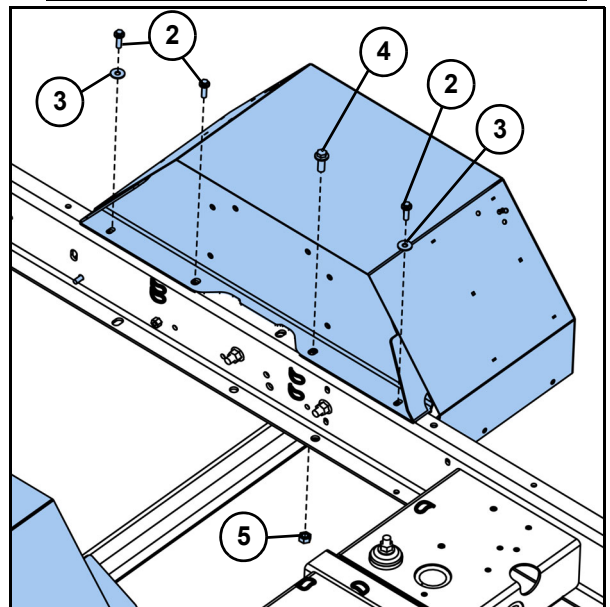

4. Attach the sides of left fender (1) on mainframe using three screws (2), one washer (3) and three nuts (6). Torque screws (2) to 53 ft-lb (72 Nm).

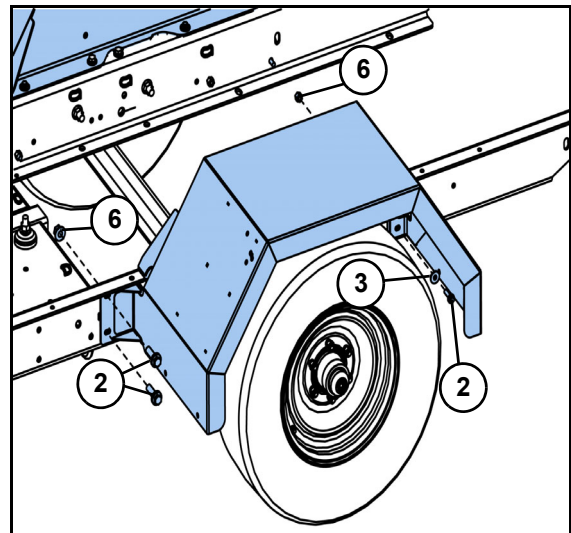

5. Attach new feed roller jack stand (7) on left fender (1) using two screws (8), two nuts (3) and screw (2). Torque screws (2 and 8) to 53 ft-lb (72 Nm).

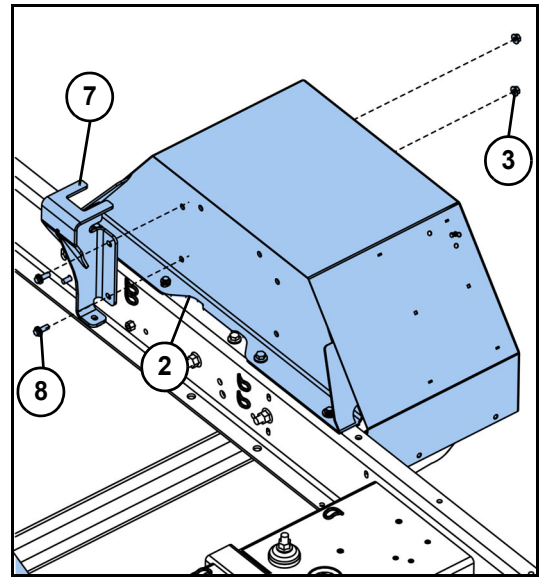

6. If machine was equipped with marker whip (B) and screws (B), reattach on left fender.

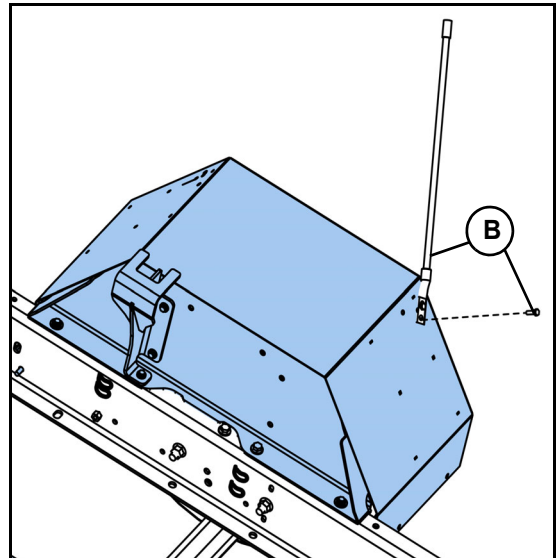

7. If machine was equipped with flag mount (A) and screws (A), reattach on left fender.

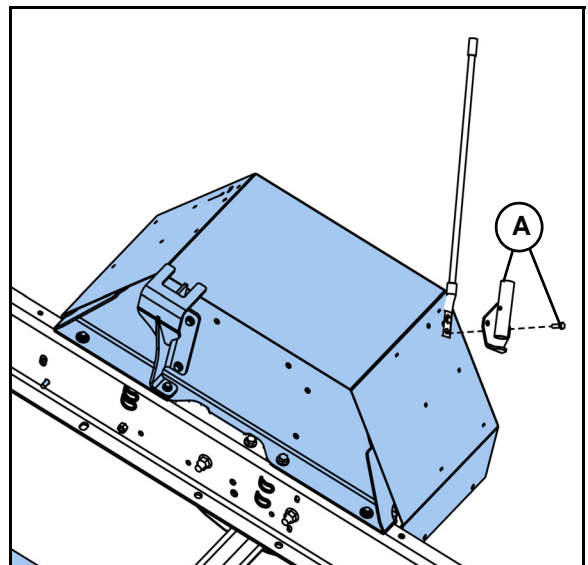

Install new right fender loosely. Once all hardware is installed, make sure fender is square and flat to mainframe before tightening.

- 8. Clean mounting surface on frame before attaching right fender (9).
- 9. Align new right fender (9) up with holes on mainframe.

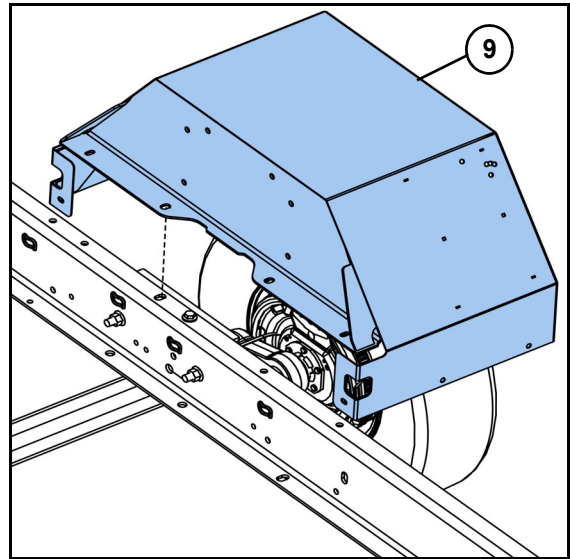

- 10. Attach new right fender (9) on mainframe using three screws (2), three washers (3), one screw (4) and one nut (5). Torque screws (2) to 53 ft-lb (72 Nm). Torque screw (4) to 148 ft-lb (201 Nm).

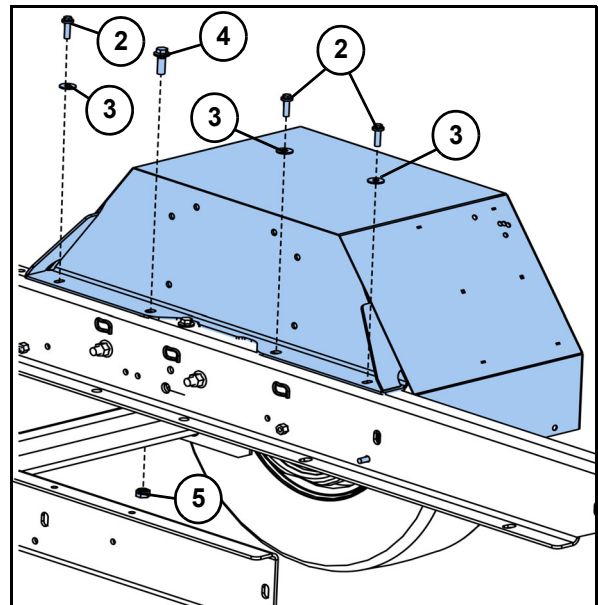

- 11. Attach the sides of right fender (9) on mainframe using two screws (2), two washers (3) and two nuts (6). Torque screws (2) to 53 ft-lb (72 Nm).

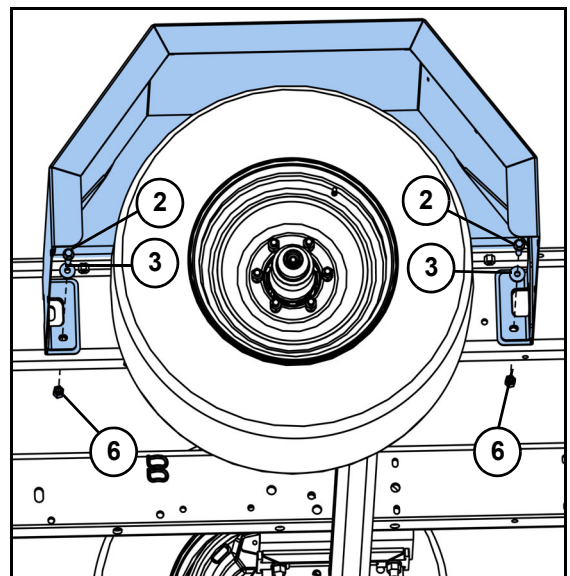

12. If machine was equipped with marker whip (E) and screws (E), reattach on right fender.

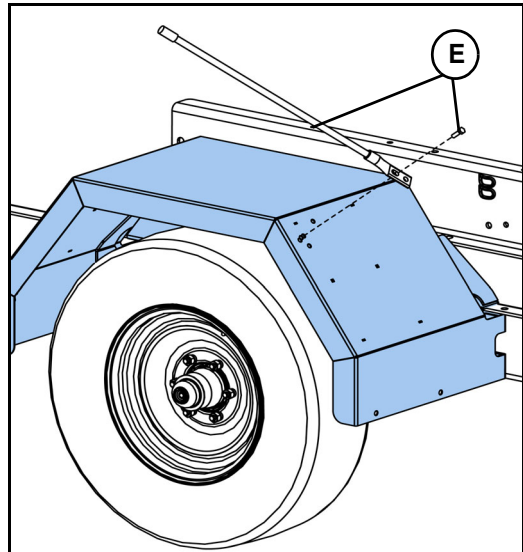

13. If machine was equipped with flag mount (D) and screws (D), reattach on right fender.

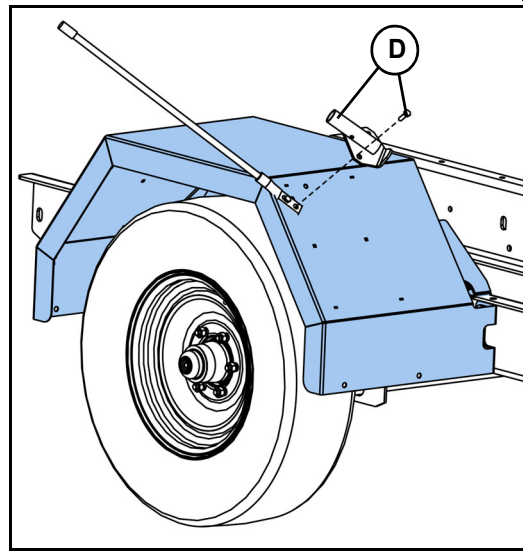

14. If machine was equipped with cone storage (C) and screws (C), reattach on right fender.

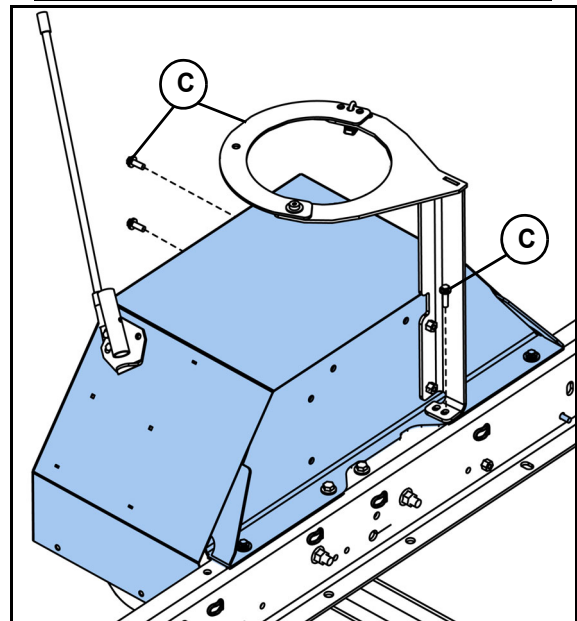

15. Attach one new warning decal (10) on the left and right fender.

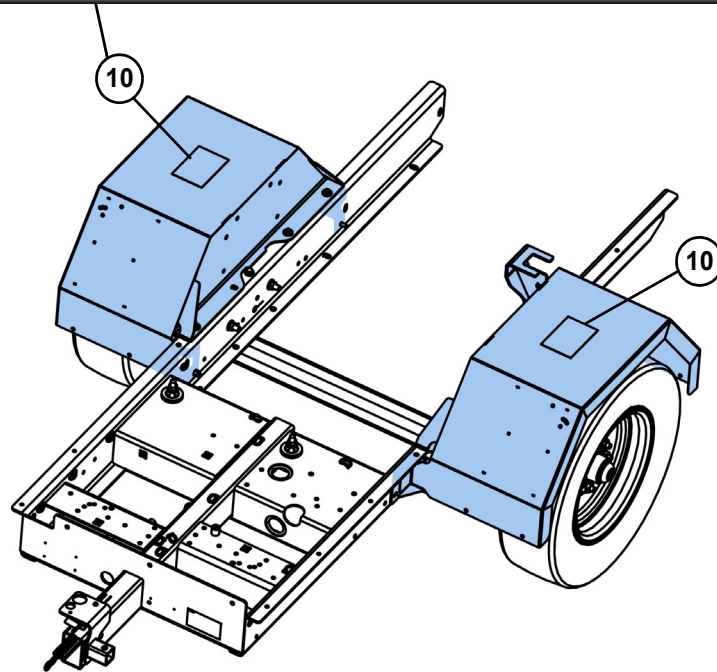
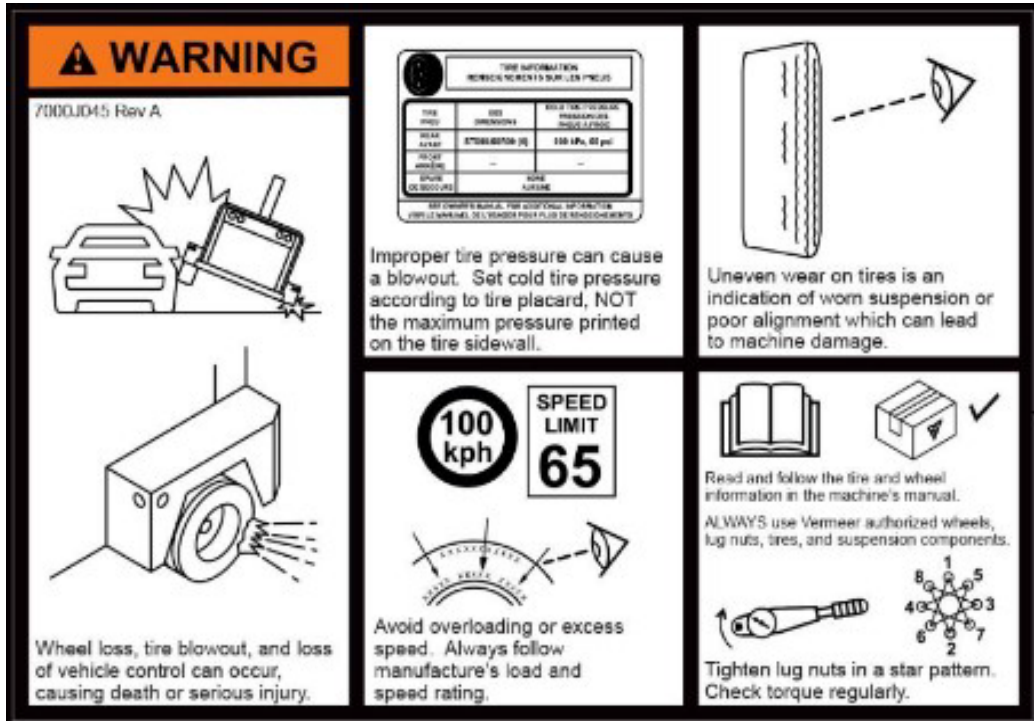

16. Remove Figure 3 and attach to the invoice or place in the manual storage box so unit owner can place with existing parts manual.



**WARNING:** Raised load can shift or fall. Death or serious injury could be possible if struck or crushed by falling load. Never allow anyone under a raised load unless load is securely supported to prevent it from shifting or falling.

**Procedure 1:Fender removal IK16, IK17, IK18, IK19 and IK20**

1. If machine is equipped with flag mount **(A)** and screws **(A)**, remove and retain from left fender.

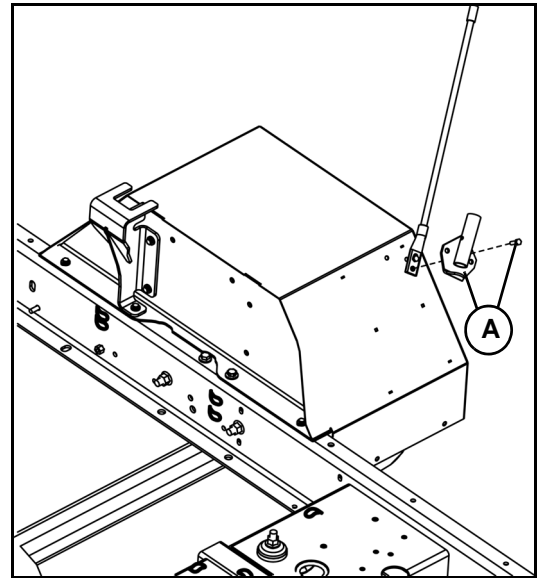

2. If machine is equipped with marker whip **(B)** and screws **(B)**, remove and retain from left fender.

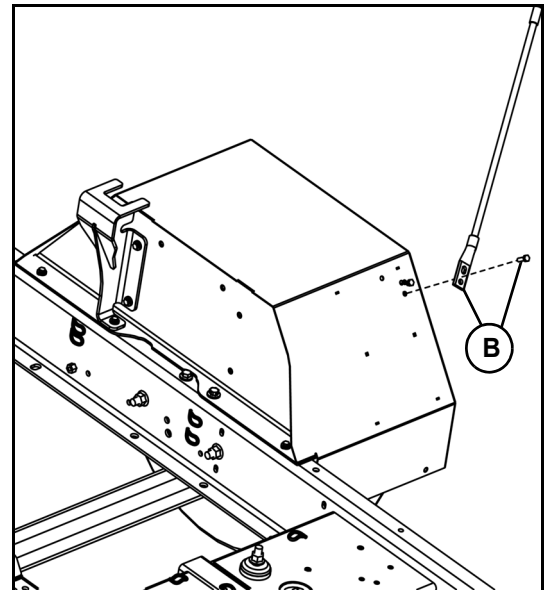

3. Remove and discard four screws that attach the left fender to frame on back side.

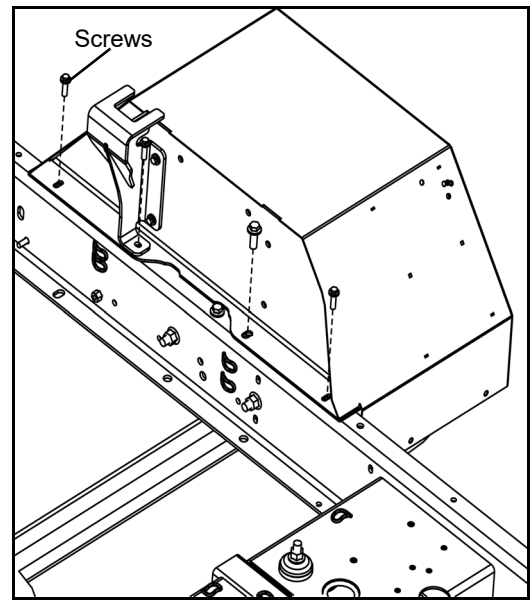

4. Remove and discard screws, nuts and washer that attach the left fender to the frame.

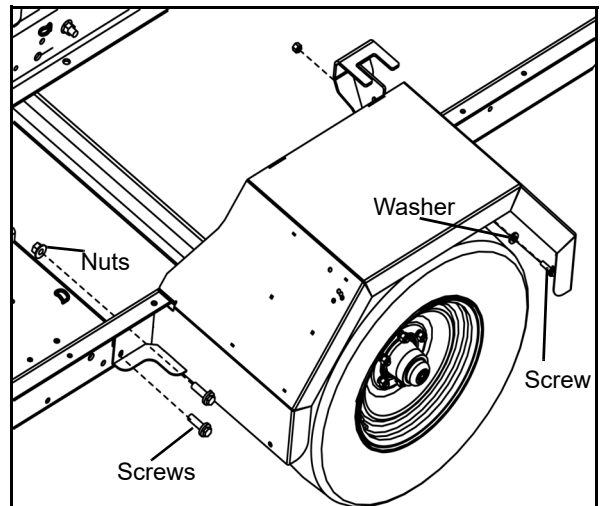

5. Remove and discard left fender and feed roller jack stand.

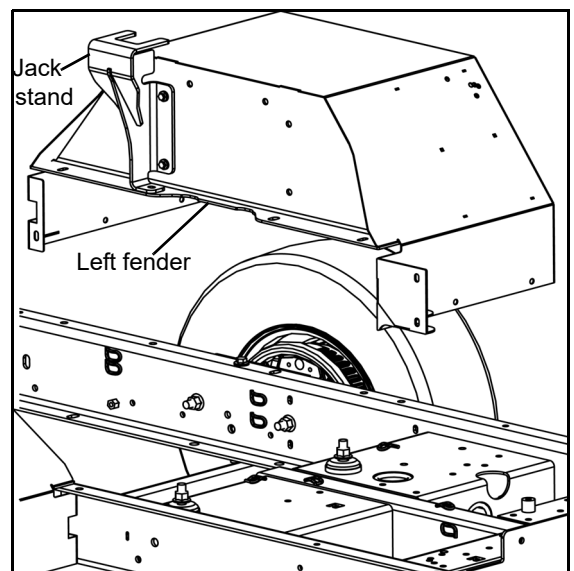

6. If machine is equipped with cone storage (C) and screws (C), remove and retain from right fender.

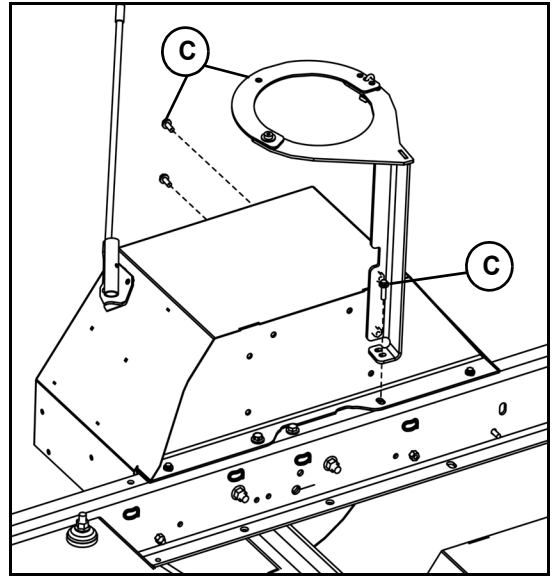

7. If machine is equipped with flag mount (D) and screws (D), remove and retain from right fender.

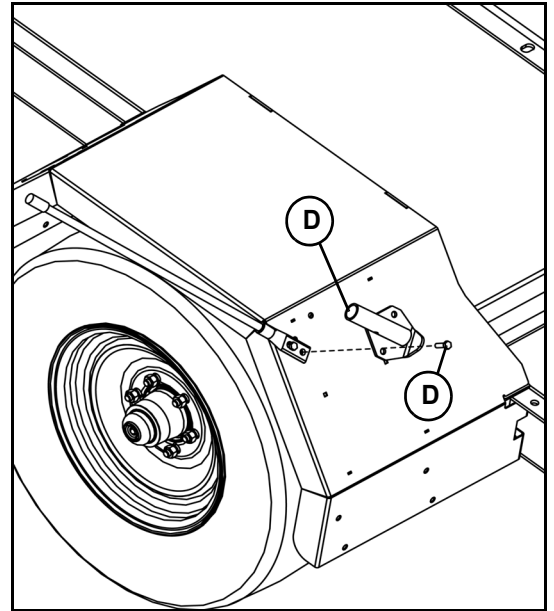

8. If machine is equipped with marker whip (E) and screws (E), remove and retain from right fender.

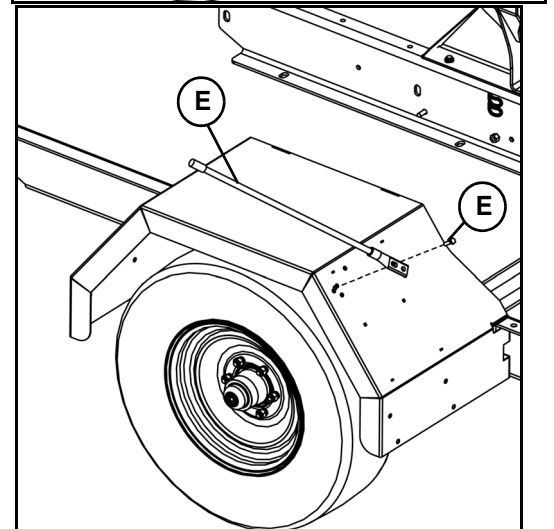

9. Remove and discard four screws that attach the right fender to frame on back side.

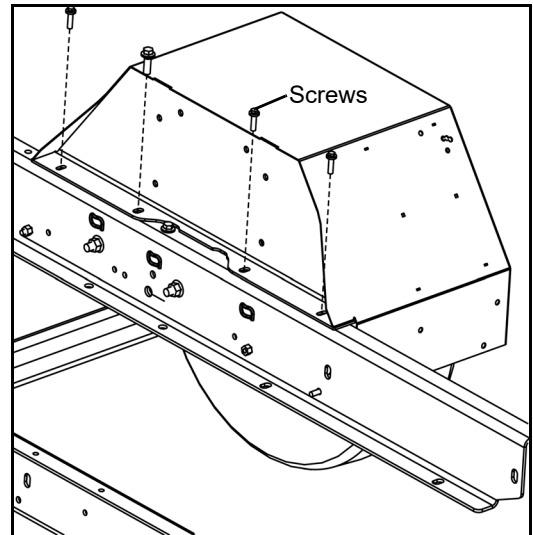

10. Remove and discard two screws, two washers and two nuts that attach the right fender to the frame on the inside of the fender.

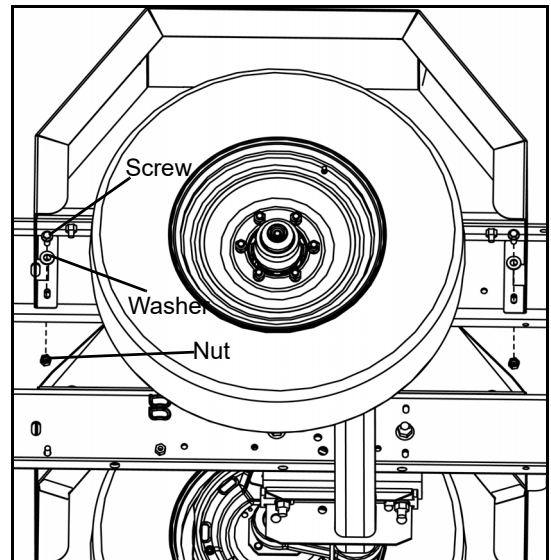

11. Remove and discard right fender.

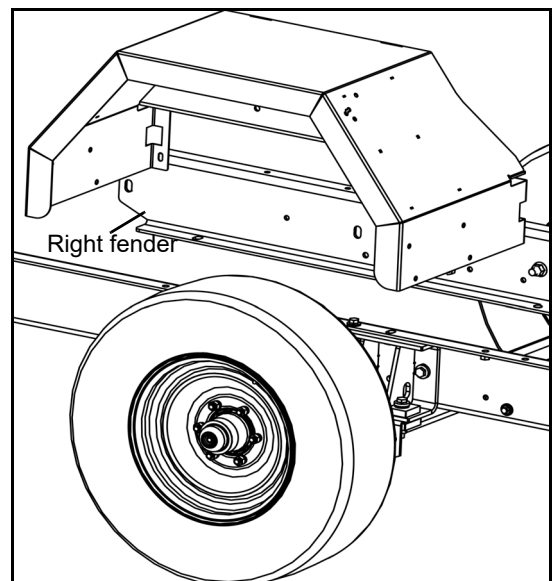

## Procedure 2:Fender replacement IK16, IK17, IK18, IK19 and IK20

1. Clean mounting surface on frame before attaching new left fender (1).
2. Align new left fender (1) up with holes on mainframe.

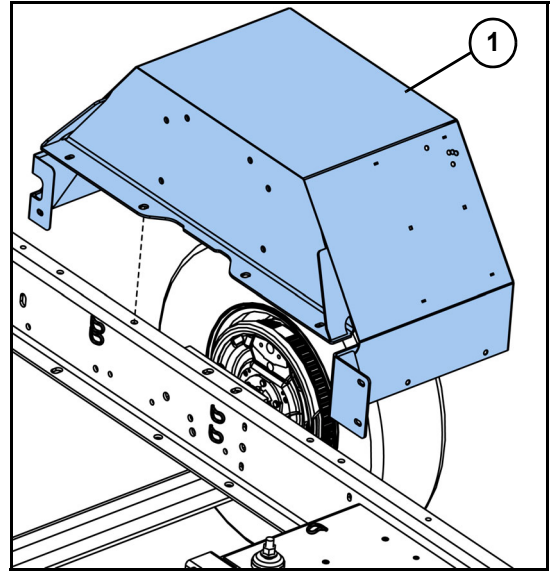

Install new left fender loosely. Once all hardware is installed, make sure fender is square and flat to mainframe before tightening.

3. Attach new left fender (1) on mainframe using three screws (2), two washers (3), one screw (4) and one nut (5). Torque screws (2) to 53 ft-lb (72 Nm). Torque screw (4) to 148 ft-lb (201 Nm).

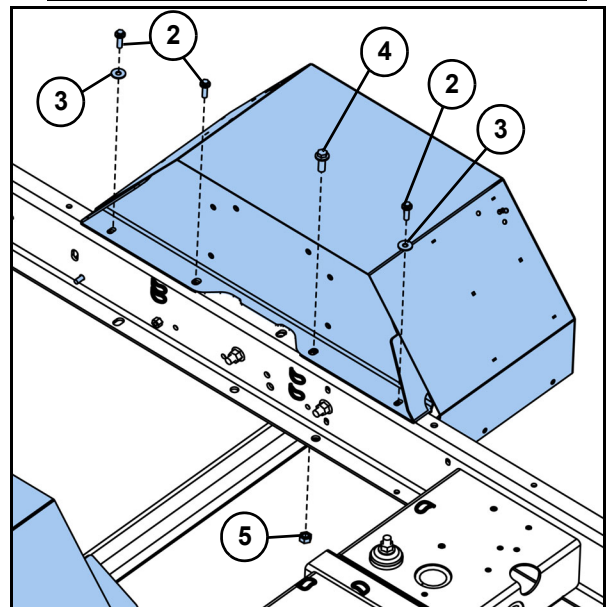

4. Attach the sides of left fender (1) on mainframe using three screws (2), one washer (3) and three nuts (6). Torque screws (2) to 53 ft-lb (72 Nm).

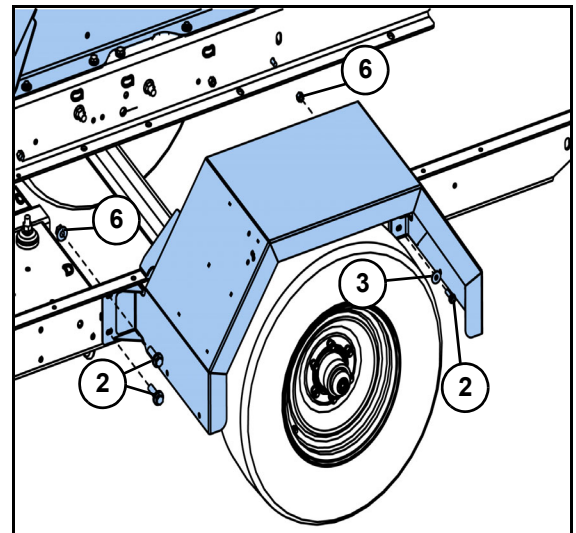

5. Attach new feed roller jack stand (7) on left fender (1) using two screws (8), two nuts (3) and screw (2). Torque screws (2 and 8) to 53 ft-lb (72 Nm).

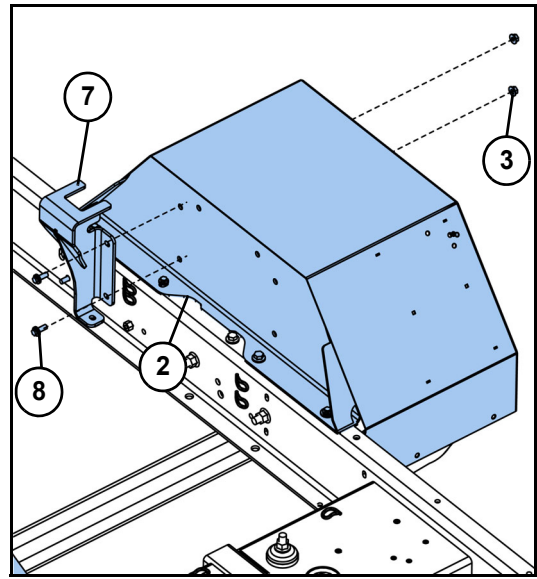

6. If machine was equipped with marker whip (B) and screws (B), reattach on left fender.

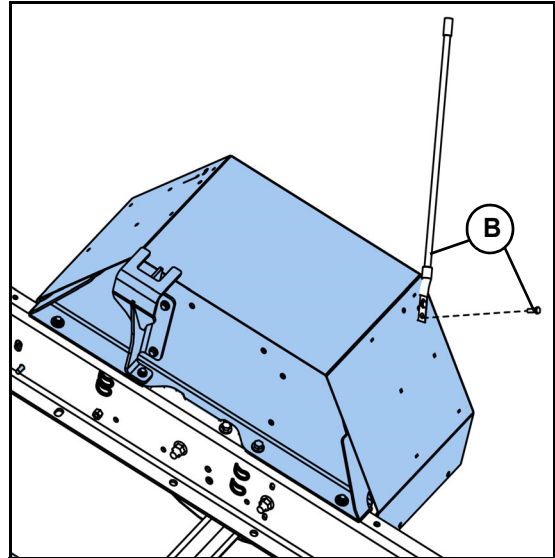

7. If machine was equipped with flag mount (A) and screws (A), reattach on left fender.

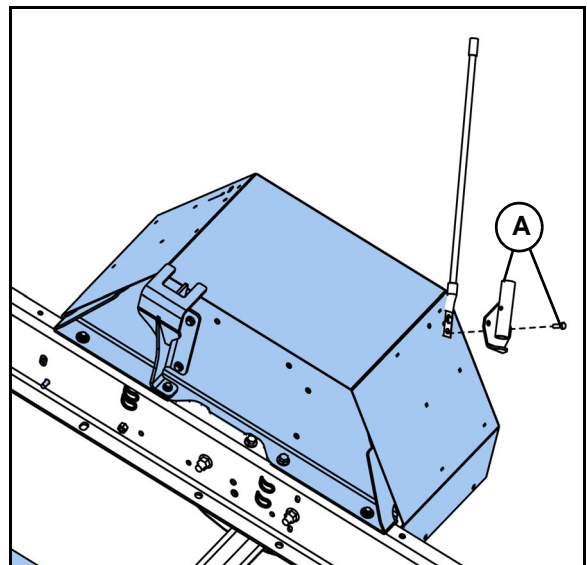

Install new right fender loosely. Once all hardware is installed, make sure fender is square and flat to mainframe before tightening.

- 8. Clean mounting surface on frame before attaching right fender (9).
- 9. Align new right fender (9) up with holes on mainframe.

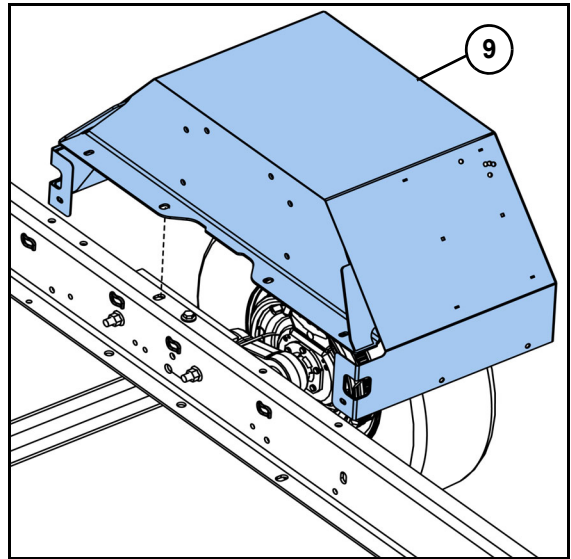

- 10. Attach new right fender (9) on mainframe using three screws (2), three washers (3), one screw (4) and one nut (5). Torque screws (2) to 53 ft-lb (72 Nm). Torque screw (4) to 148 ft-lb (201 Nm).

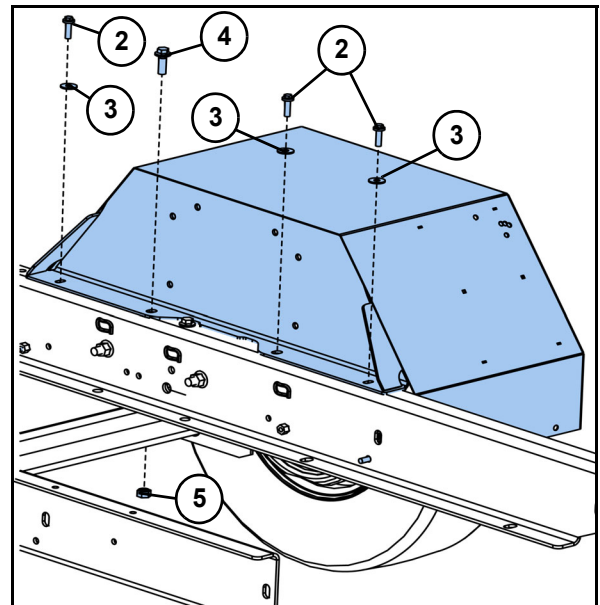

- 11. Attach the sides of right fender (9) on mainframe using two screws (2), two washers (3) and two nuts (6). Torque screws (2) to 53 ft-lb (72 Nm).

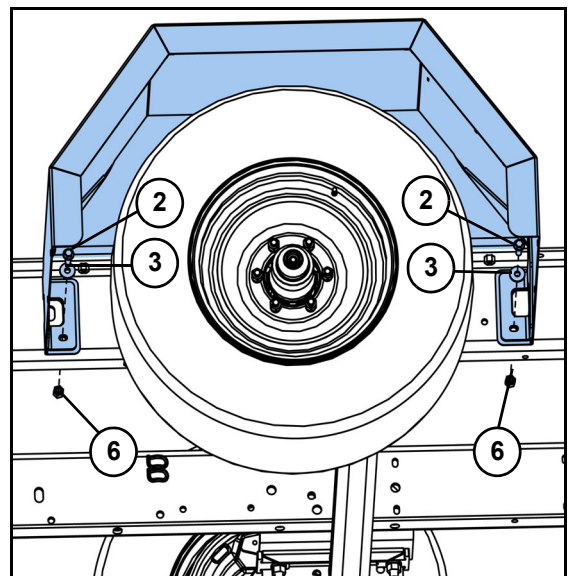

12. If machine was equipped with marker whip (E) and screws (E), reattach on right fender.

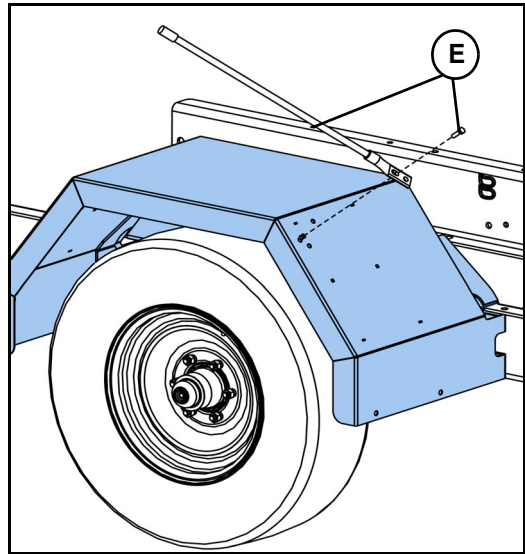

13. If machine was equipped with flag mount (D) and screws (D), reattach on right fender.

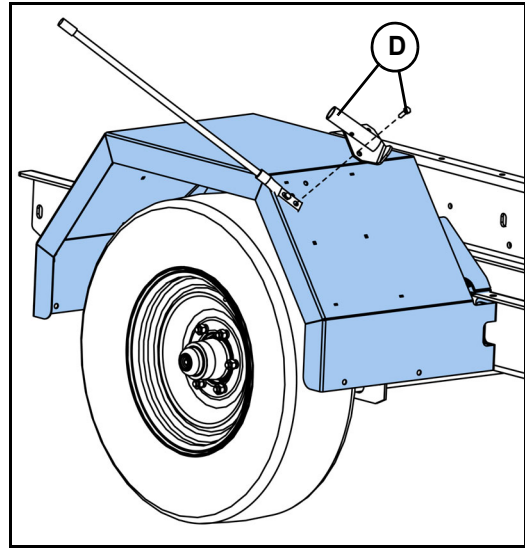

14. If machine was equipped with cone storage (C) and screws (C), reattach on right fender.

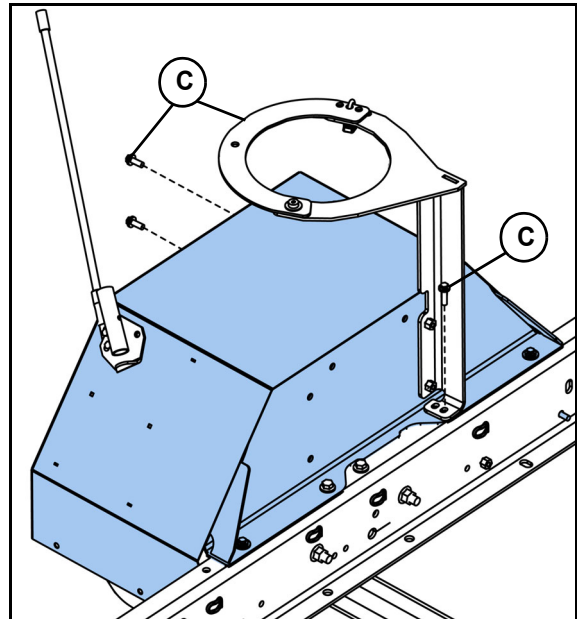

15. Attach one new warning decal (10) on the left and right fender.

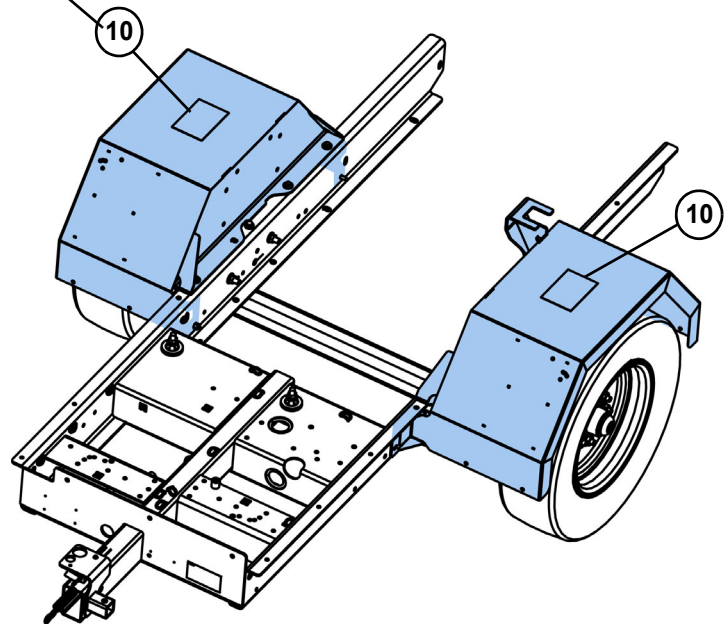
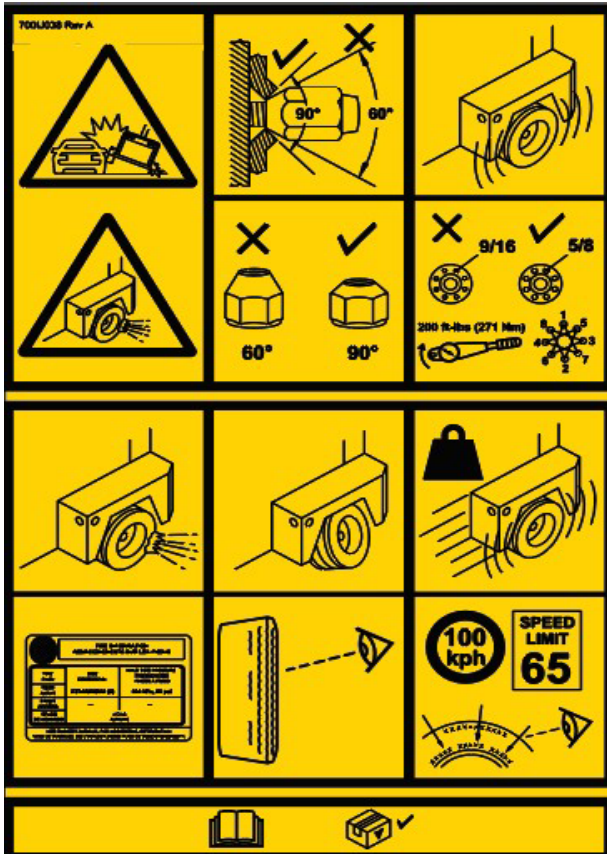

16. Remove Figure 4 and attach to the invoice or place in the manual storage box so unit owner can place with existing parts manual.

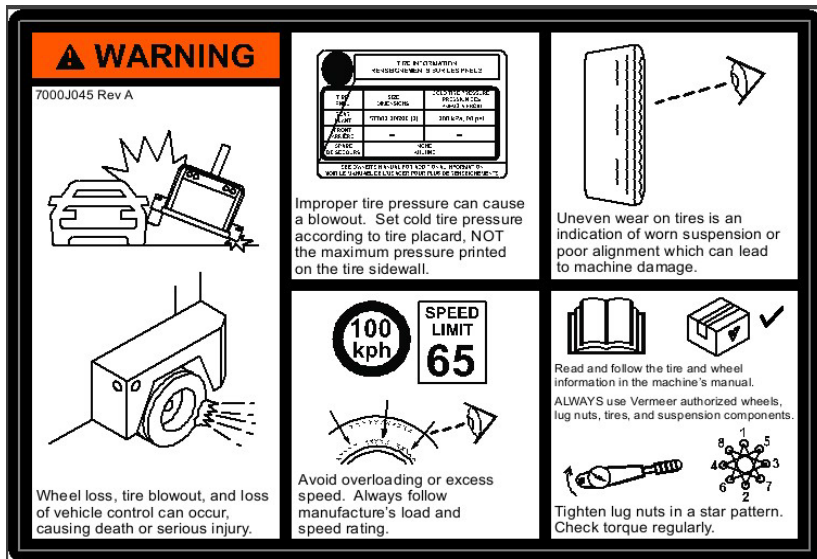

**Figure 1**

UNIT OWNER COPY  
Insert into parts manual  
for future reference.

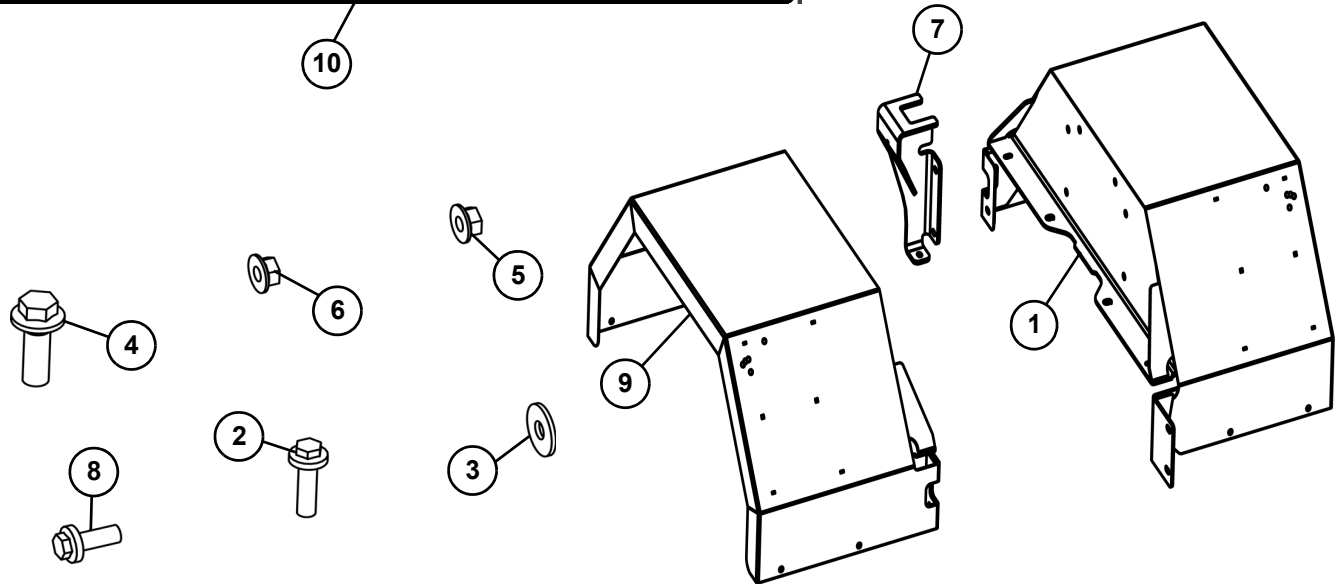

**Figure 1 parts list**

REF. NO.	PART NO.	DESCRIPTION	IK01 QTY.	IK02 QTY.	IK03 QTY.	IK04 QTY.	IK05 QTY.
1	163821450	WELDMENT - BC1000XL LEFT FENDER	1	1	1	1	1
2	507612035	SCREW-HFS-M10-1.50X35-10.9-FT	11	11	11	11	11
3	507086010	WASHER-FLAT-M10-10.5X30.0-2.5-D9021	8	8	8	8	8
4	296300879	SCREW-HFS-M14-2.0X40-10.9	2	2	2	2	2
5	507085014	NUT-HEXFLGL-M14-2.00-10.9	2	2	2	2	2
6	507085010	NUT-HEXFLGL-M10-1.50	7	7	7	7	7
7	163821465	FEED ROLLER JACK STAND	1	1	1	1	1
8	507612025	SCREW-HFS-M10-1.50X25-10.9-D6921-FT	2	2	2	2	2
9	163821460	WELDMENT - BC1000XL RIGHT FENDER	1	1	1	1	1
10	7000J045	DECAL-WARNING, WHEEL & TIRE	2	2	2	2	2
		Kit includes all items in Figure 1 parts list.					

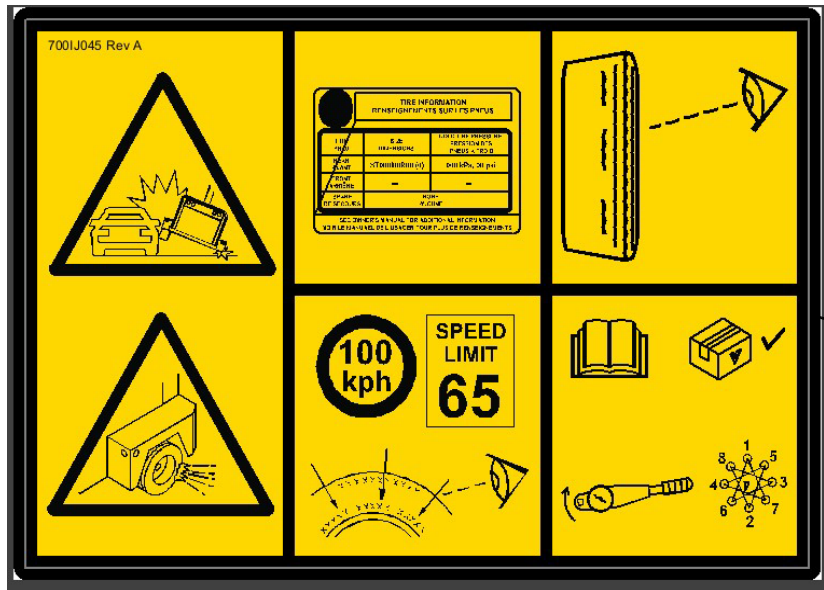

**Figure 2**

UNIT OWNER COPY  
Insert into parts manual  
for future reference.

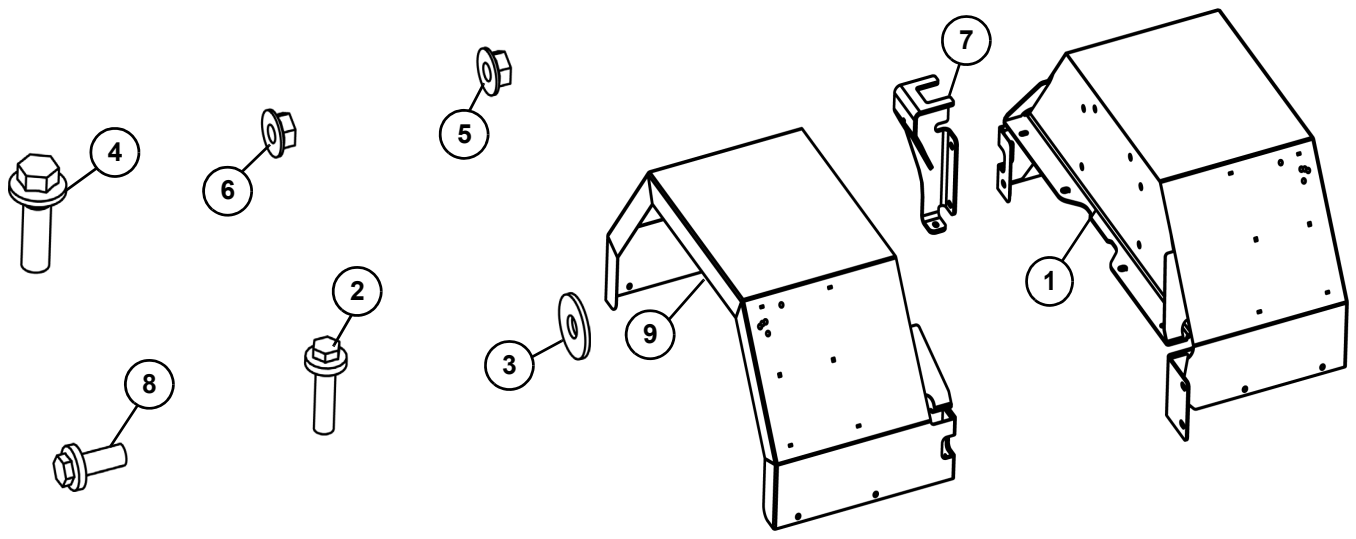
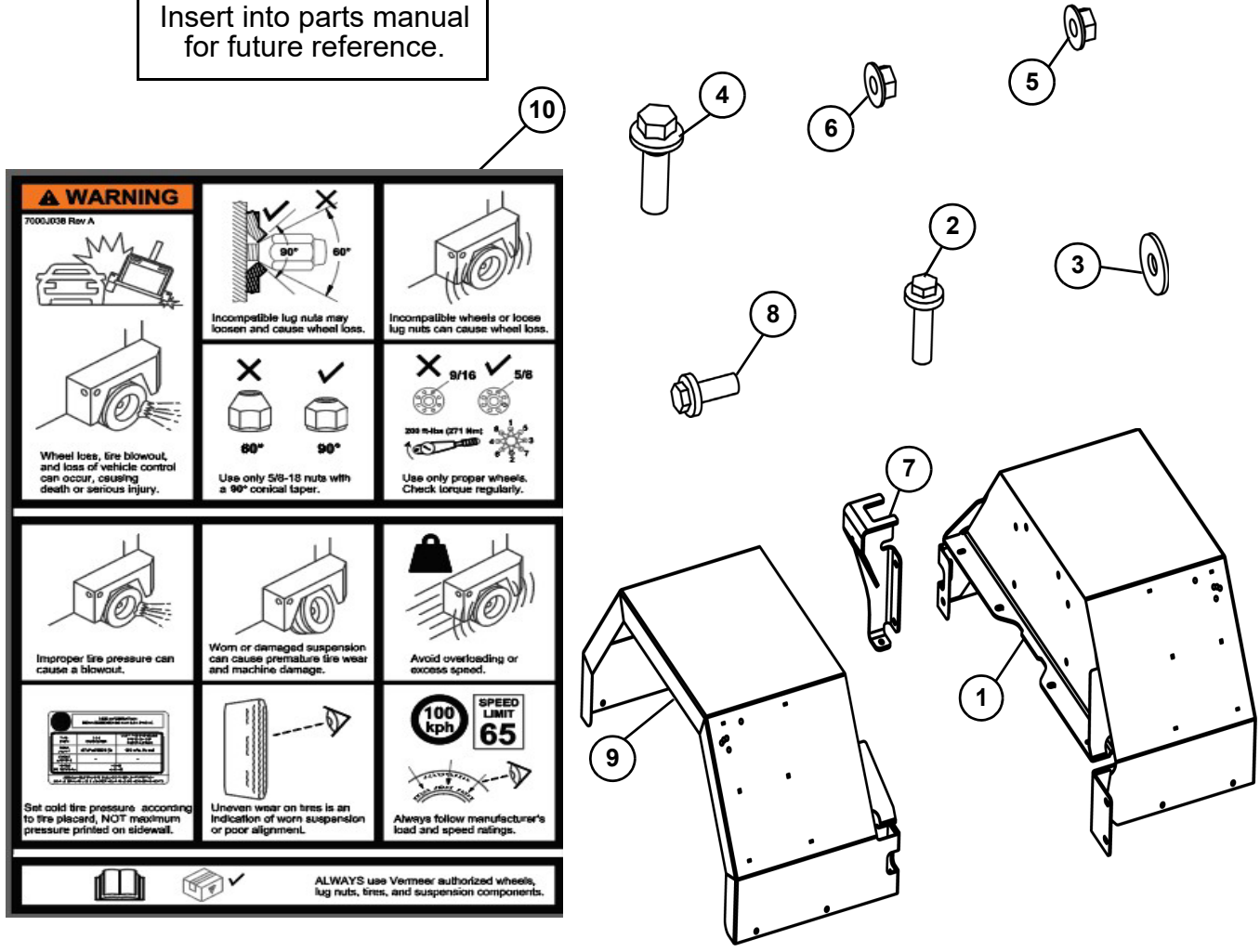

**Figure 2 parts list**

REF. NO.	PART NO.	DESCRIPTION	IK06 QTY.	IK07 QTY.	IK08 QTY.	IK09 QTY.	IK10 QTY.
1	163821450	WELDMENT - BC1000XL LEFT FENDER	1	1	1	1	1
2	507612035	SCREW-HFS-M10-1.50X35-10.9-FT	11	11	11	11	11
3	507086010	WASHER-FLAT-M10-10.5X30.0-2.5-D9021	8	8	8	8	8
4	296300879	SCREW-HFS-M14-2.0X40-10.9	2	2	2	2	2
5	507085014	NUT-HEXFLGL-M14-2.00-10.9	2	2	2	2	2
6	507085010	NUT-HEXFLGL-M10-1.50	7	7	7	7	7
7	163821465	FEED ROLLER JACK STAND	1	1	1	1	1
8	507612025	SCREW-HFS-M10-1.50X25-10.9-D6921-FT	2	2	2	2	2
9	163821460	WELDMENT - BC1000XL RIGHT FENDER	1	1	1	1	1
10	700IJ045	DECAL-WARNING, WHEEL & TIRE	2	2	2	2	2
		Kit includes all items in Figure 2 parts list.					

**Figure 3**

UNIT OWNER COPY  
Insert into parts manual  
for future reference.



**Figure 3 parts list**

REF. NO.	PART NO.	DESCRIPTION	IK11 QTY.	IK12 QTY.	IK13 QTY.	IK14 QTY.	IK15 QTY.
1	163821450	WELDMENT - BC1000XL LEFT FENDER	1	1	1	1	1
2	507612035	SCREW-HFS-M10-1.50X35-10.9-FT	11	11	11	11	11
3	507086010	WASHER-FLAT-M10-10.5X30.0-2.5-D9021	8	8	8	8	8
4	296300879	SCREW-HFS-M14-2.0X40-10.9	2	2	2	2	2
5	507085014	NUT-HEXFLGL-M14-2.00-10.9	2	2	2	2	2
6	507085010	NUT-HEXFLGL-M10-1.50	7	7	7	7	7
7	163821465	FEED ROLLER JACK STAND	1	1	1	1	1
8	507612025	SCREW-HFS-M10-1.50X25-10.9-D6921-FT	2	2	2	2	2
9	163821460	WELDMENT - BC1000XL RIGHT FENDER	1	1	1	1	1
10	7000J038	DECAL-WARNING, WHEEL & TIRE	2	2	2	2	2
		Kit includes all items in Figure 3 parts list.					

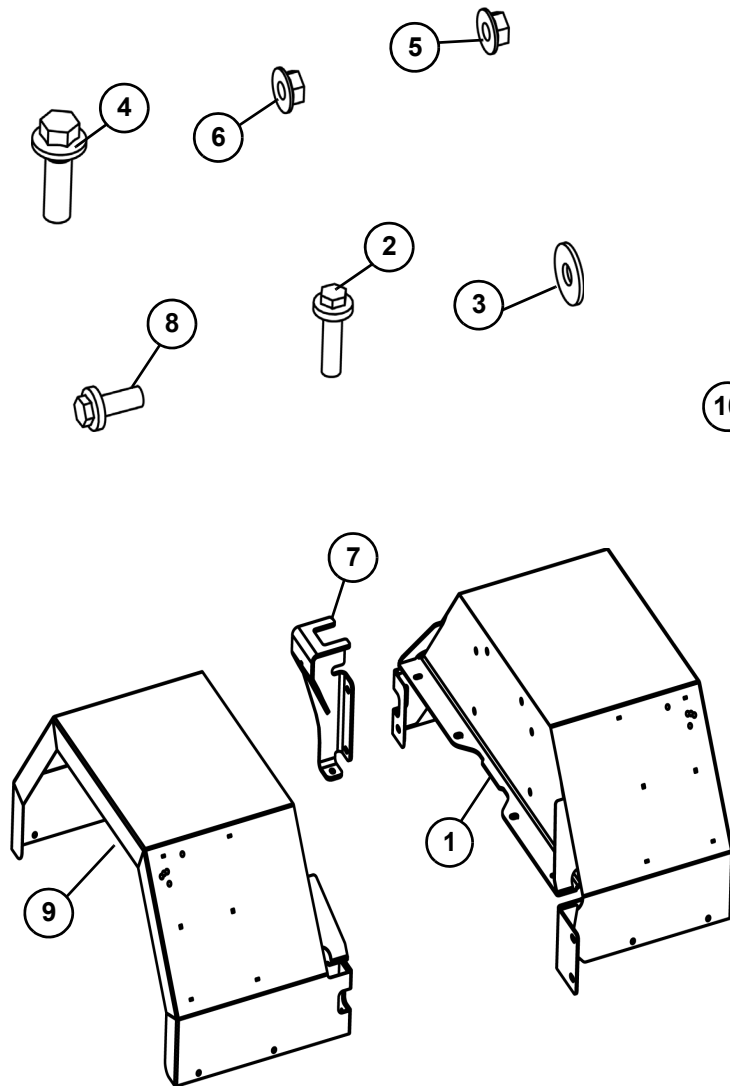

**Figure 4**

UNIT OWNER COPY  
Insert into parts manual  
for future reference.



**Figure 4 parts list**

REF. NO.	PART NO.	DESCRIPTION	IK16 QTY.	IK17 QTY.	IK18 QTY.	IK19 QTY.	IK20 QTY.
1	163821450	WELDMENT - BC1000XL LEFT FENDER	1	1	1	1	1
2	507612035	SCREW-HFS-M10-1.50X35-10.9-FT	11	11	11	11	11
3	507086010	WASHER-FLAT-M10-10.5X30.0-2.5-D9021	8	8	8	8	8
4	296300879	SCREW-HFS-M14-2.0X40-10.9	2	2	2	2	2
5	507085014	NUT-HEXFLGL-M14-2.00-10.9	2	2	2	2	2
6	507085010	NUT-HEXFLGL-M10-1.50	7	7	7	7	7
7	163821465	FEED ROLLER JACK STAND	1	1	1	1	1
8	507612025	SCREW-HFS-M10-1.50X25-10.9-D6921-FT	2	2	2	2	2
9	163821460	WELDMENT - BC1000XL RIGHT FENDER	1	1	1	1	1
10	700IJ038	DECAL-WARNING, WHEEL & TIRE	2	2	2	2	2
		Kit includes all items in Figure 4 parts list.					