

POWERTRAIN – OIL FILTER INSTALLATION CARE POINT – 4.4L NC10

Customer Voice:

- Customers will be reporting an oil leak from vehicle after oil service.

Technical Description:

- We have found that the oil filter installation instructions have not been followed correctly. **TOPIx section 303-01C: Removal and Installation, Oil filter element.**

Status:

Install a new oil filter element cap o-ring.
Lubricate the o-ring with clean engine oil.
Install a new oil filter element.

Make sure that the oil filter element is pushed correctly onto the bypass valve inside the oil filter element cap.

- Install and tighten the oil filter element and cap.
- Torque
 - Stage 1: 40Nm
 - Stage 2: Loosen 180°
 - Stage 3: 40Nm

22-23MY Range Rover
23MY Range Rover Sport

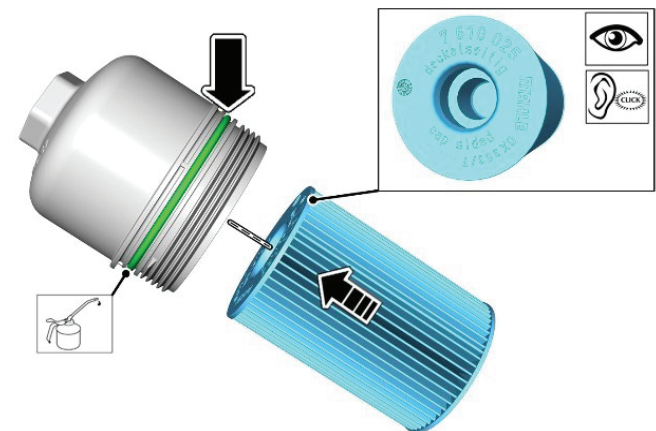

E267773