

Subject:

**DRIVER AND/OR PASSENGER SEAT WARMER(S) ARE
INOPERATIVE OR CANNOT BE TURNED OFF AND DTC B1520:49
MAY BE STORED**

Bulletin No.: 09-002/23

Last Issued : 01/03/2023

BULLETIN NOTES

APPLICABLE MODEL(S)/VINS

2023 CX-50 (with front seat warmer and without driver-side memory power seat) and (produced before December 2022)

DESCRIPTION

Some customers may complain that the front seat warmers are inoperative or cannot be turned OFF and DTC B1520:49 may be stored. This may be caused by an electrical noise of the front seat warmer control unit. To correct this issue, the anti-electric noise performance of the front seat warmer control unit has been improved.

Customers having this concern should have their vehicle repaired using the following repair procedure.

REPAIR PROCEDURE

1. Verify the customer concern.
2. Replace the seat warmer control unit located on the front passenger seat according to the instructions in MGSS ([FRONT SEAT REMOVAL/INSTALLATION](#)).
3. Disconnect the Seat Warmer Control Unit connector [0913-101 \(B\)](#).
4. Replace the Seat Warmer Control Unit (A).

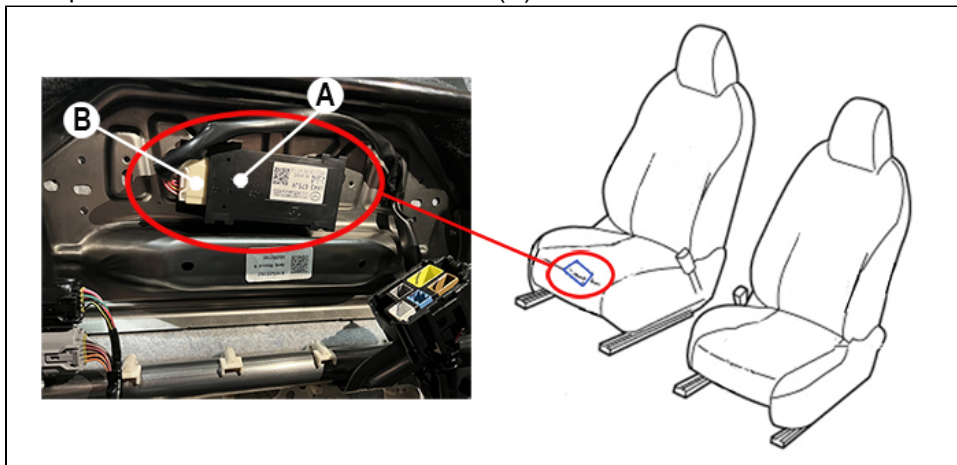

5. Install in the reverse order of removal. See MGSS ([FRONT SEAT REMOVAL/INSTALLATION](#)).
6. Verify the repair.

CONSUMER NOTICE: The information and instructions in this bulletin are intended for use by skilled technicians. Mazda technicians utilize the proper tools/ equipment and take training to correctly and safely maintain Mazda vehicles. These instructions should not be performed by "do-it-yourselfers." Customers should not assume this bulletin applies to their vehicle or that their vehicle will develop the described concern. To determine if the information applies, customers should contact their nearest authorized Mazda dealership. Mazda North American Operations reserves the right to alter the specifications and contents of this bulletin without obligation or advance notice. All rights reserved. No part of this bulletin may be reproduced in any form or by any means, electronic or mechanical--including photocopying and recording and the use of any kind of information storage and retrieval system ---without permission in writing.

PARTS INFORMATION

| Part Number | Description | Qty. |
|--------------|-------------|------|
| VA43-67-5J0A | POWER UNIT | 1 |

WARRANTY INFORMATION**NOTE:**

- This warranty information applies only to verified customer complaints on vehicles eligible for warranty repair.
- This repair will be covered under Mazda's New Vehicle Limited Warranty term.
- Additional diagnostic time cannot be claimed for this repair.

| | |
|---------------------------------|---------------------|
| Warranty Type | A |
| Symptom Code | 64 |
| Damage Code | 9Q |
| Part Number Main Cause | VA43-67-5J0A |
| Quantity | 1 |
| Operation Number / Labor Hours: | XXW8TXRX / 0.5 Hrs. |

CONSUMER NOTICE: The information and instructions in this bulletin are intended for use by skilled technicians. Mazda technicians utilize the proper tools/ equipment and take training to correctly and safely maintain Mazda vehicles. These instructions should not be performed by "do-it-yourselfers." Customers should not assume this bulletin applies to their vehicle or that their vehicle will develop the described concern. To determine if the information applies, customers should contact their nearest authorized Mazda dealership. Mazda North American Operations reserves the right to alter the specifications and contents of this bulletin without obligation or advance notice. All rights reserved. No part of this bulletin may be reproduced in any form or by any means, electronic or mechanical---including photocopying and recording and the use of any kind of information storage and retrieval system ---without permission in writing.