

PREVOST

Instruction Sheet

IS-22055

H3 SERIES LED HEADLAMPS RETROFIT

Use this kit in replacement of the following Xenon or halogen headlamps

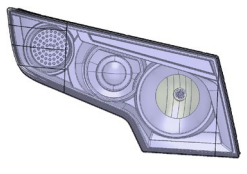
TYPE	R.H.	L.H.	
XENON	930426	930425	
	930014	930013	
HALOGEN	930403	930402	
	930011	930010	

First Release

12-15-2022

MATERIAL

Kit # IS22055 includes the following parts:

Part No.	Description	Qty
430227	LEFT HEADLAMP LED H3	1
430228	RIGHT HEADLAMP LED H3	1
470095	WATER DEFLECTOR EXTRUSION	3 ft
IS-22055	INSTRUCTION SHEET	1
FI-22055	FEUILLE D'INSTRUCTION	1

NOTE

Material can be obtained through regular channels.

PREVOST

SAFETY PRECAUTIONS

- Eye protection should always be worn when working in a shop.
- Rules for Personal Protection Equipment should always be respected. Wear your PPE including but not limited to the following:



**Safety
First!**



PREVOST

PROCEDURE



DANGER

Park vehicle safely, apply parking brake, stop the engine. Prior to working on the vehicle, set the ignition switch to the OFF position and trip the main circuit breakers equipped with a trip button. On Commuter type vehicles, set the battery master switch (master cut-out) to the OFF position.

Lockout & Tag out (LOTO) must be performed during set-up, maintenance or repair activities. Refer to your local procedure for detailed information regarding the control of hazardous energy.

HEADLAMP REMOVAL

1. Open the reclining bumper.
2. Loosen the two (2) bolts shown.



FIGURE 1

3. Pull the rod shown to flip the headlamps assembly.

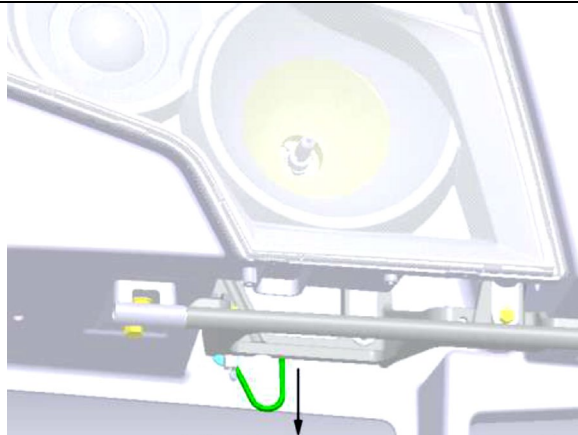

FIGURE 2

4. Unscrew and remove five (5) nuts and washers shown.

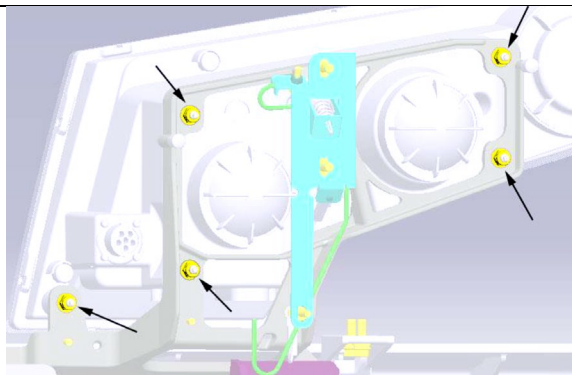

FIGURE 3

5. Disconnect the headlamp and remove.

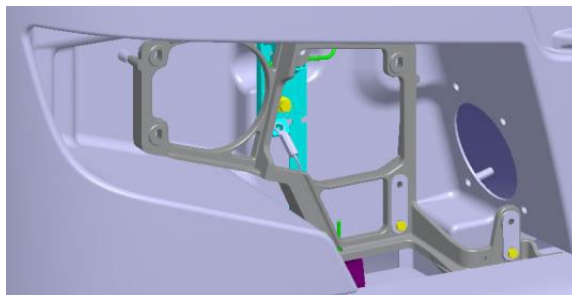

FIGURE 4

WATER DEFLECTOR INSTALLATION ON R.H. HEADLAMP

6. Cut two pieces of raw water deflector extrusion 470095 in accordance with the following measures.

- A) 366 mm
- B) 244 mm

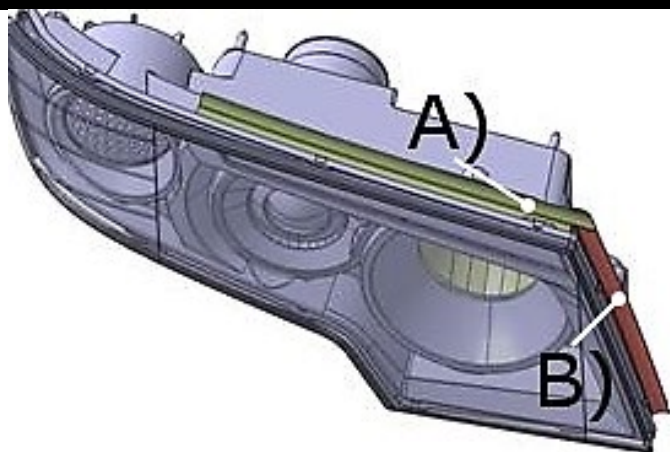

FIGURE 5

7. Cut two notches (Figure 7) on each water deflector to clear the embossed part (Figure 6) of the headlamp housing.

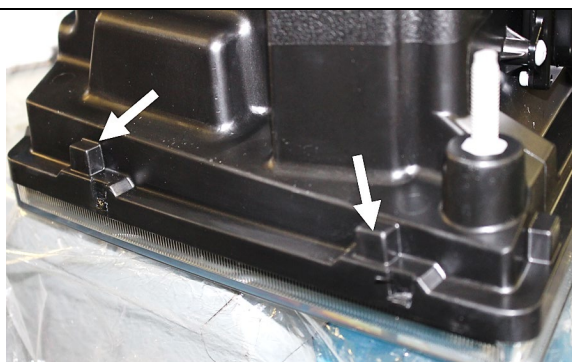

FIGURE 6



FIGURE 7

-
8. Stick the water deflector on the surface shown.

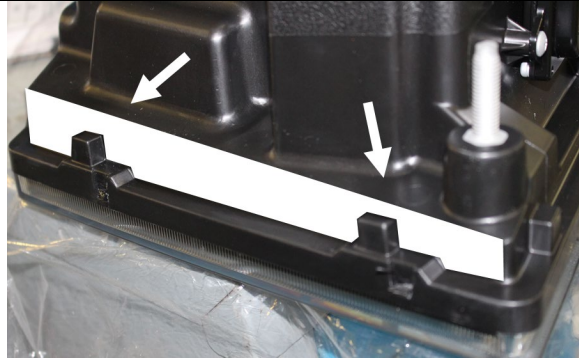

FIGURE 8

-
9. Water deflectors position.

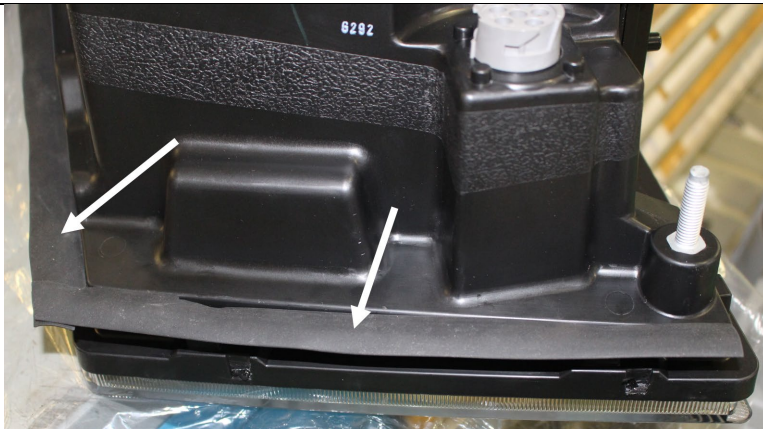

FIGURE 9

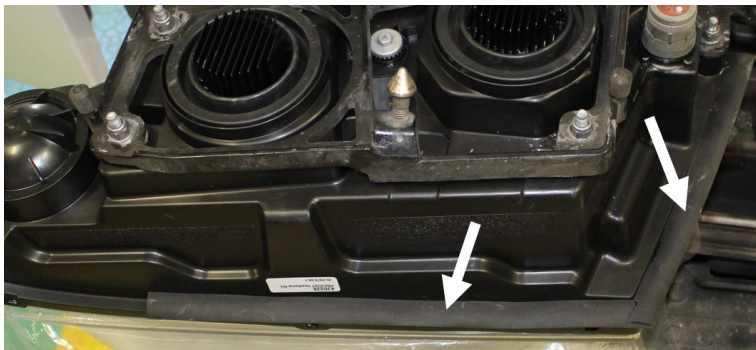

FIGURE 10



FIGURE 11

HEADLAMP INSTALLATION

10. Reinstall five (5) washers.
11. Reinstall five (5) nuts. Tighten by hand only.

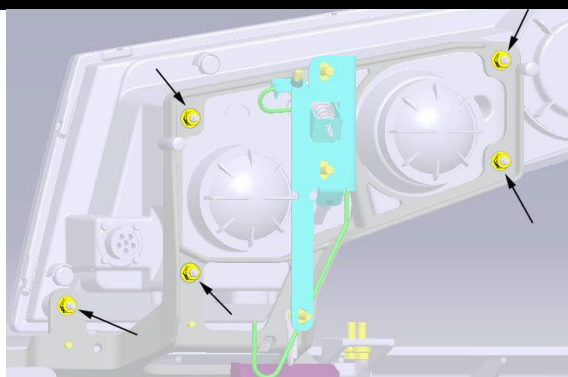

FIGURE 12

12. Adjust the headlamp vertically.
13. The gap shown in red on Figure 14 should be 5 ± 2 mm.

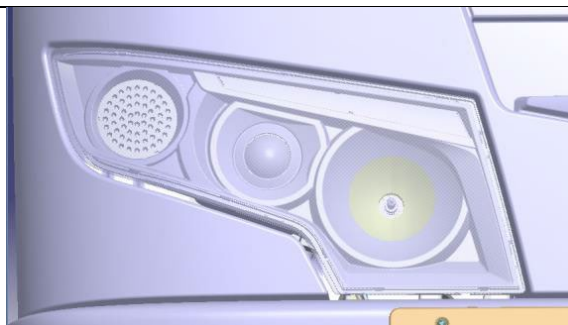

FIGURE 13

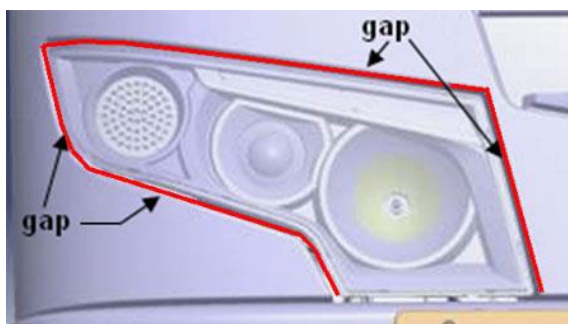

FIGURE 14

14. Once the headlamp is properly positioned, tighten the 2 bolts shown.

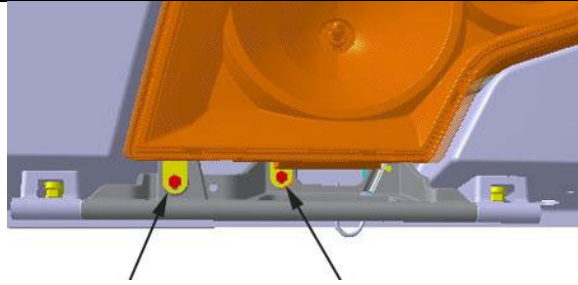

FIGURE 15

15. Flip the headlamp and tighten the 5 nuts shown. Prescribed torque: 10 ft-lbs.

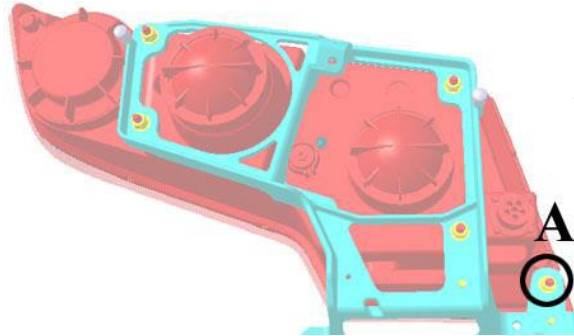

FIGURE 16

PARAMETER PROGRAMMING WITH VPG SOFTWARE TOOL

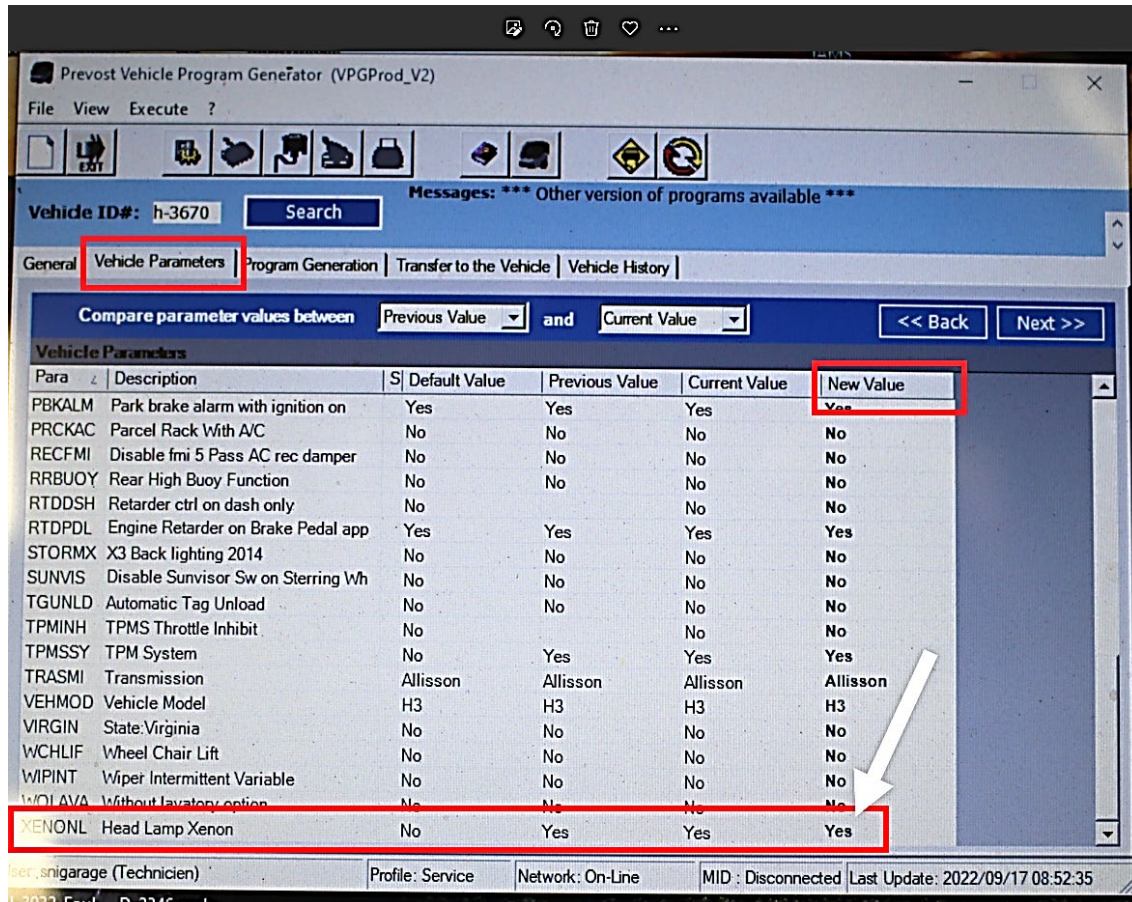

FIGURE 17

16. In VPG, set parameter **XENONL Head Lamp Xenon** new value to **Yes**.

This is applicable on Xenon or halogen type equipped vehicles.

HEADLAMP AIM

1. Headlamps must be properly aimed to provide maximum allowable road illumination. Aiming can be performed without opening headlamps assembly. Vertical aiming of each module is provided by one adjusting screw that pivots the entire module in the housing for the proper alignment. There is no adjustment for focus since the module is set for proper focus during manufacturing assembly.

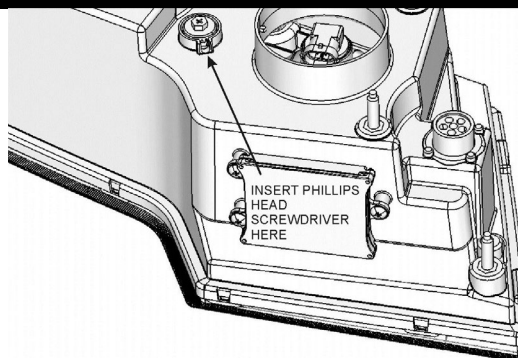

VERTICAL AIMING ADJUSTMENT

FIGURE 18

-
2. Refer to HEADLAMPS ADJUSTMENT in Section 06: ELECTRICAL of your Maintenance Manual.
-

PARTS / WASTE DISPOSAL

Discard waste according to applicable environmental regulations (Municipal/State[Prov.]/ Federal)