



SIB 54 03 22

BUZZING SOUND HEARD IN THE SKY LOUNGE ROOF

MODEL

E-Series	Model Description	Affected Option Code
I20	iX Sports Activity Vehicle	407 Panoramic Eclipsing Roof

SITUATION

A buzzing sound is heard in the Sky lounge roof while driving at highway speeds.

Note: Please see attached video V54 01 22.

CAUSE

At high outside temperatures, the inner roof trim seal will become soft. Therefore, causing the inner roof trim seal to flap against the Sky lounge roof while at highway speeds.

CORRECTION

Install sunroof surrounding seal onto the Sky lounge roof frame.

PROCEDURE

Verify that a buzzing sound from the Sky lounge roof is heard. If yes, then.

1. Remove the roof trim following the repair instructions listed in ISTA/AIR (51 13 280).
2. Using surrounding seal, cut a length of **1850 mm**.
 - **2 pieces, left and right side**

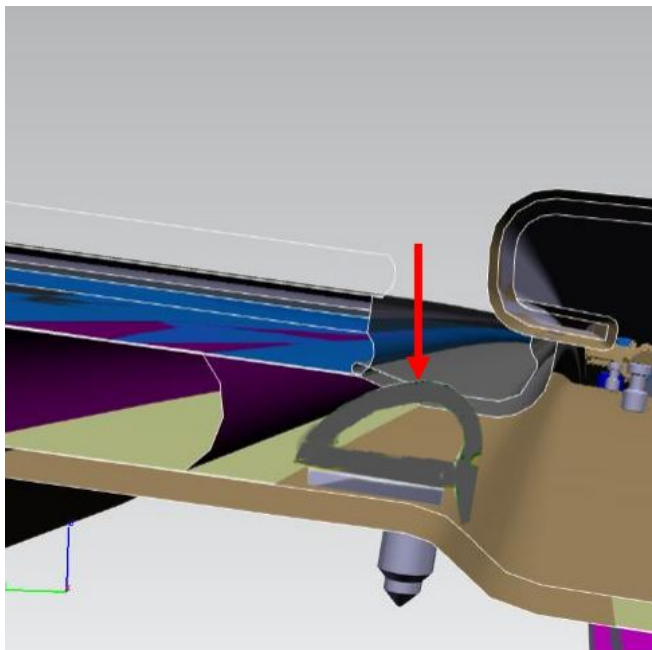

3. The sunroof surrounding seal is self-adhesive. Attach seal to the Sky lounge roof frame.

4. Install roof trim back on the vehicle and verify repair.

PARTS INFORMATION

Obtain and confirm the part numbers for your specific vehicle by entering the chassis number in either ETK or AIR which considers specific equipment and/or options.

Part Number	Description	Quantity

54 10 7 430 946	Surrounding seal (L=4300 mm)	Sublet
-----------------	------------------------------	--------

CLAIM INFORMATION

Covered under the terms of the BMW New Vehicle Limited Warranty for Passenger Cars and Light Trucks.

Defect Code:	5113193900	Roof trim strip Unpleasant noises
---------------------	-------------------	--

Refer to AIR for the corresponding flat rate unit (FRU) allowances.

Labor Operation	Description	Labor Allowance
51 13 281	Removing and installing both roof trim strips (Main work)	Refer to AIR
Or:		
51 13 781	Removing and installing both roof trim strips (Plus work)	Refer to AIR
And, as necessary:		
51 00 001*	Localizing body complaint(s) (Work time)	(WT)
Or		
00 58 500*	Diagnosis Worktime Flat Rate (See below)	2 FRU
And:		
51 99 000	Work time to install surrounding seal on the Sky lounge roof frame	3 FRU

If you are using a Main labor code for another repair, use the Plus code labor operation 51 13 781 instead of 51 13 281.

Work time labor operation codes 51 00 001, 00 58 500 and 51 99 000 are not considered a Main labor operations

*Based on which one applies to your center, please refer to **SI B01 01 20** or **B01 07 20** for the applicable procedure for documenting, claiming, and explaining, on the RO and in the claim comments, your diagnosis work time (WT), job/repair work time (WT), and the vehicle repairs your center performed, unless otherwise required by State law.

And:

Sublet – Bulk Materials (RO and Claim Comments Required)

Sublet Code 4	See the sublet reimbursement calculations below	Reimbursement for the repair-related bulk material (Do not use the BMW part numbers for claim submission)
--------------------------------	---	---

Sublet reimbursement calculation for claiming the applicable repair-related bulk material (BMW part number, 1,850 mm x 2, total length of 3,700 mm) is at the dealer net price amount for the quantities used plus your center's handling.

Enter this material cost in sublet and itemize the amount on the repair order and in claim comment section.

FEEDBACK REGARDING THIS BULLETIN

Technical Feedback	To submit feedback for the technical topics of this bulletin: Submit your feedback in the rating box at the top of this bulletin
Warranty Feedback	To submit feedback for the CLAIMS section of this bulletin: Submit an IDS ticket to the Warranty Department, or use the chat available in the Warranty

Copyright ©2022 BMW of North America, Inc.

	Documentation Portal
Parts Feedback	To submit feedback for the PARTS section of this bulletin: Submit an IDS ticket to the Parts Department

Supporting Materials

Videos

[54 01 22](#)