

# Brake Treadle Valve Removal for Rebuild

M-563-001

(February 2008)

## Valid for

All MRU Models

## Case description

On MRU model chassis, the brake treadle valve is mounted on a bracket that is secured to the front wall of the cab, and the mounting bolts that secure the valve to the bracket are installed from the front and are not accessible. Field repair of the treadle valve involves replacing the upper and lower pistons as assemblies (using kit part number 745-289353), and complete replacement of the treadle valve is seldom necessary. Should it become necessary to replace the upper and lower piston assemblies on a treadle valve in an MRU model vehicle, it can be done without removing the valve from the mounting bracket

*Note: Does not apply to Mack Trucks Australia.*

## Procedures

1. Secure the chassis for service, apply the parking brakes and block the wheels to prevent the vehicle from moving.
2. Disconnect the batteries by disconnecting the negative battery cable(s) first, and then the positive cable(s).
3. Completely drain the air system.
4. Remove the pedal cover panel which is secured to the bottom of the instrument panel, to access the pedals.

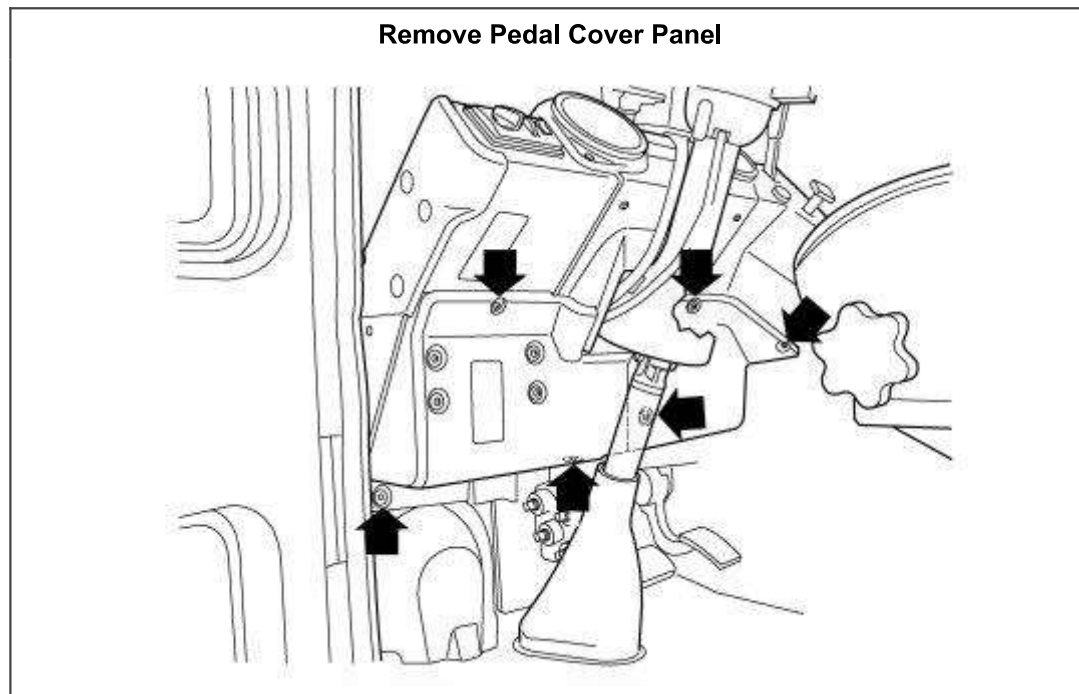

5. At the air manifold located above the treadle valve, disconnect the primary (green) and secondary (red) air lines that supply the treadle valve.

**Disconnect Treadle Valve Supply Lines at Air Manifold**

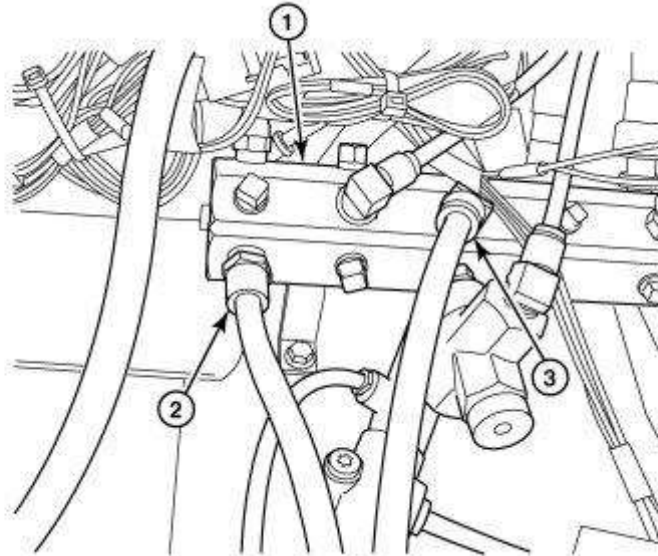

1. Air Manifold	3. Disconnect Secondary Air Line (Red)
2. Disconnect Primary Air Line (Green)	

6. The treadle valve and accelerator pedal assembly are mounted on the same mounting bracket. Remove the four capscrews that secure the bracket to the cab front wall, and then pull the bracket away from the wall.

**Remove Mounting Bracket from Cab Front Wall**

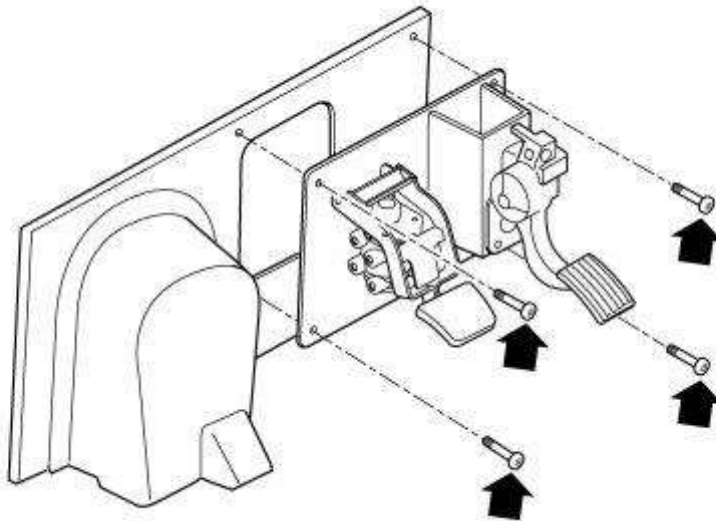

*Note: If equipped with a manual transmission, it will be necessary to remove the clutch cable from the mounting bracket located on the side of the brake and accelerator pedal mounting bracket as shown in figure 4 below. To do this, first remove the pin from the clutch cable clevis pin, and then loosen the cable jam nut at the mounting bracket. Slide the cable from the bracket.*

**Disconnect Clutch Cable from Mounting Bracket**

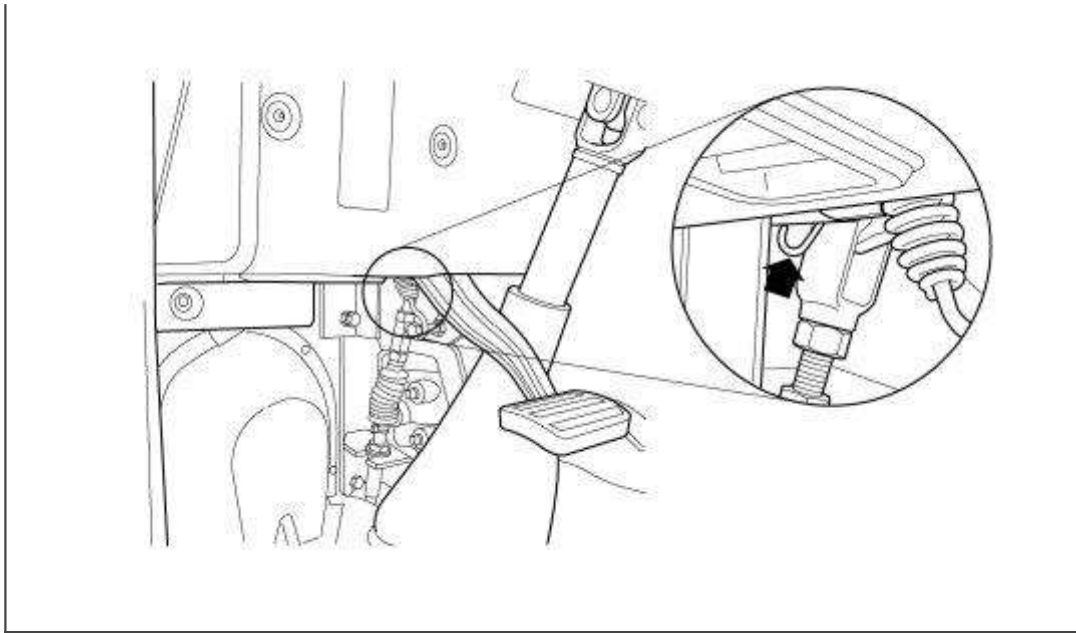

7. Remove the cotter pins from the two clevis pins that secure the brake pedal to the hinge bracket, and then remove the pedal.

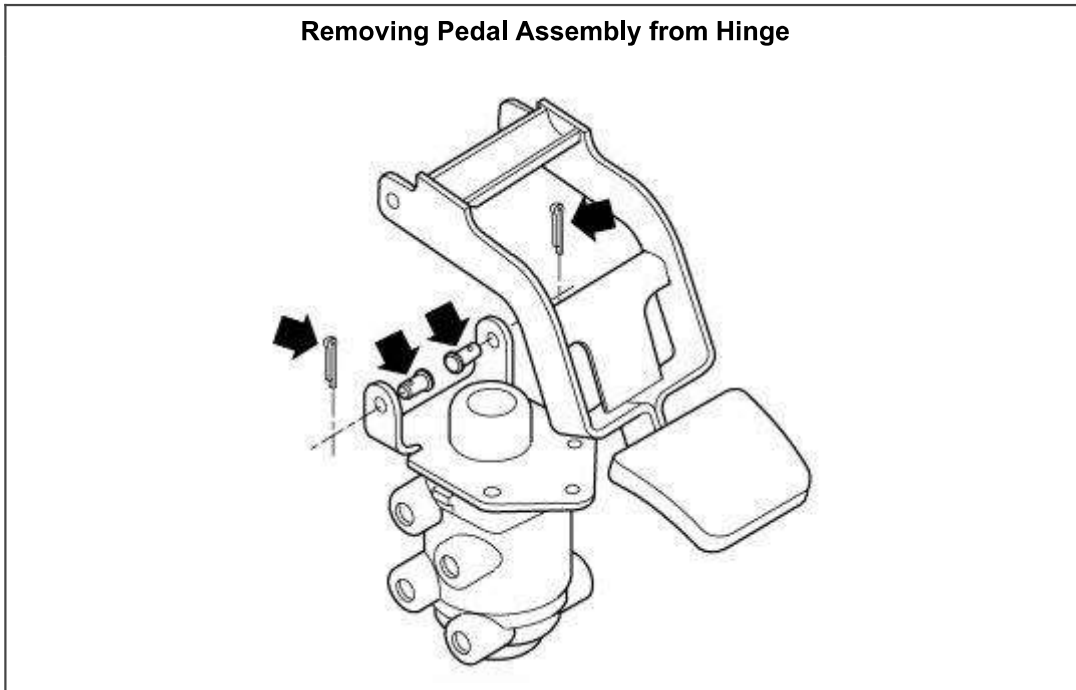

8. Remove the rubber boot and the plunger from the pedal hinge bracket, and then remove the three capscrews that secure the bracket to the valve body. Remove the bracket from the valve.

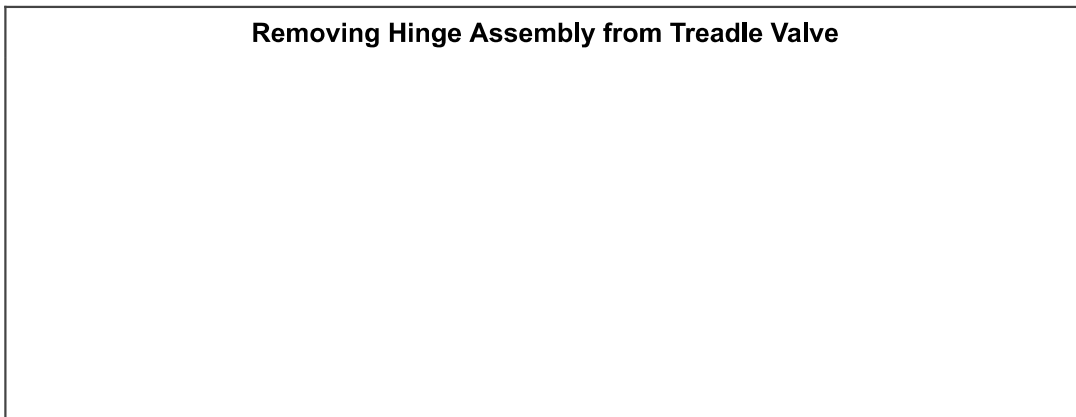

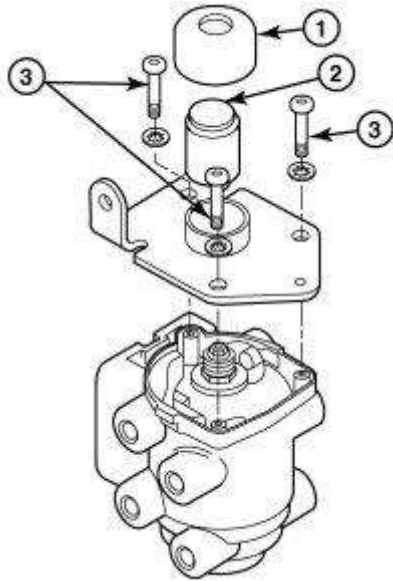

1. Remove Boot	3. Remove Mounting Screws
2. Remove Plunger	

9. After the hinge assembly has been removed from the valve body, the upper and lower pistons can be removed.

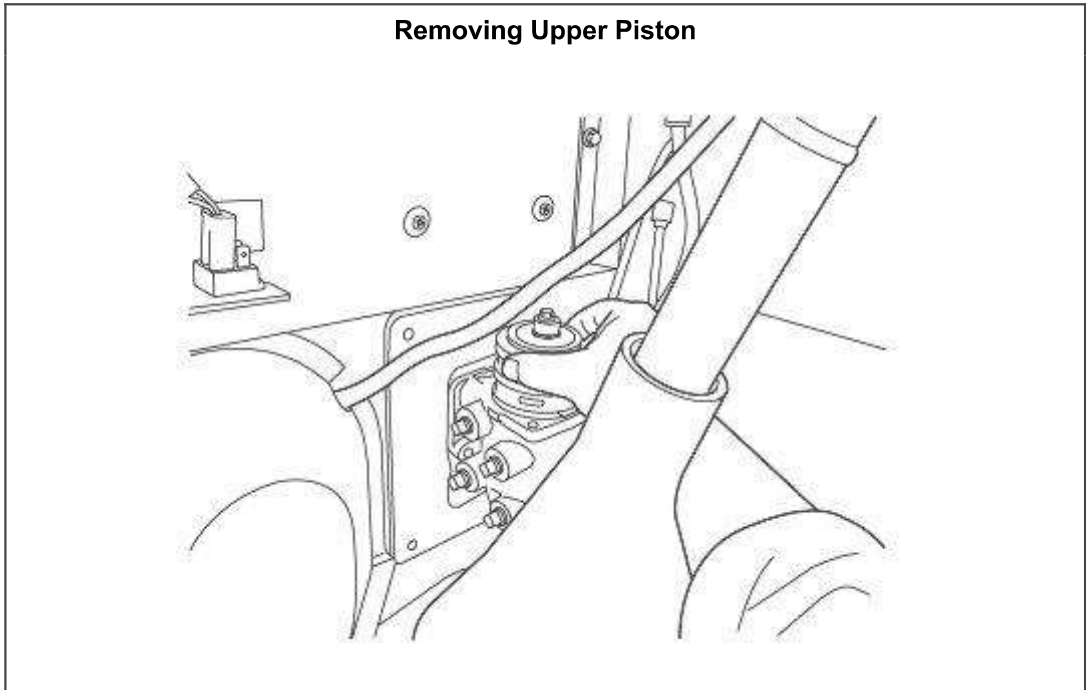

Removal of the lower piston can be accomplished by grasping the center of the piston with a pliers.

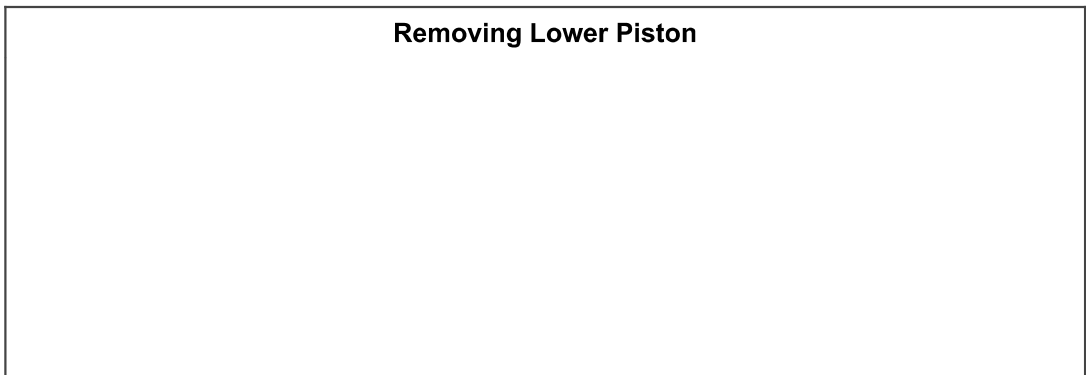

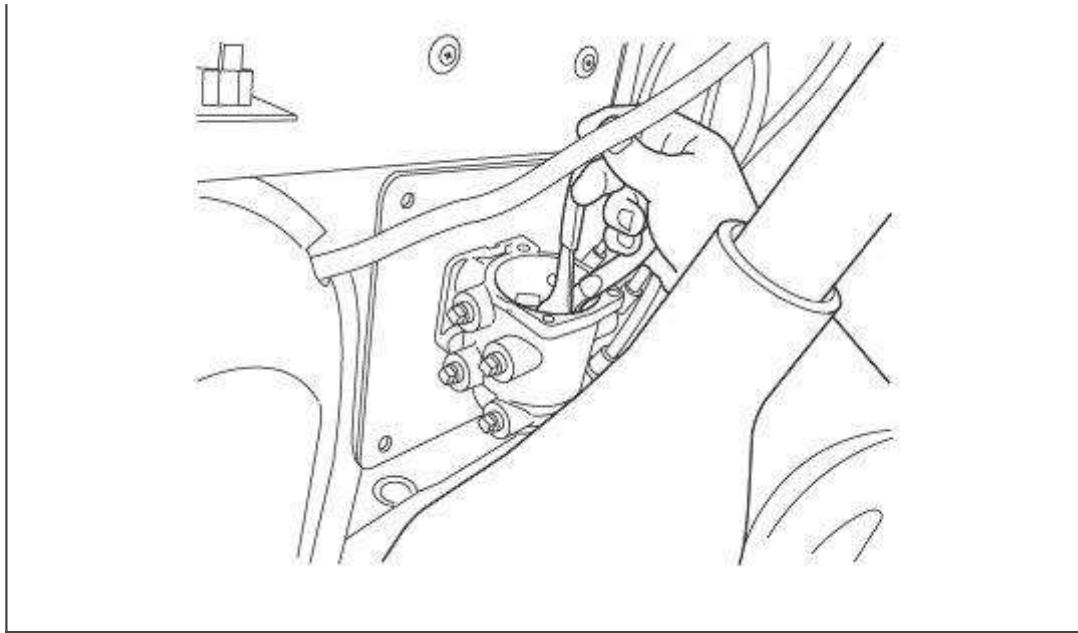

10. Rebuild the valve per the procedures outlined in the instruction sheet provided with the Bendix E7 Treadle Valve Maintenance Kit (kit No. 745-289353). Reinstallation of the valve is the reverse procedure of removal.

## **Issued by**

Technical Service