

Spare Parts Requirements for High-Voltage Battery – Observe Additional Measure Required (34/21)

Change overview

| Version | Date | Change |
|---------|----------------|--|
| 0 | April 5, 2021 | • First publication |
| 1 | April 22, 2021 | • Update of Work Procedure |
| 2 | June 14, 2022 | • Extension to model year "N" 2022 • Additional order types added |
| 3 | August 8, 2022 | • Procedure modified |

Model Line: **Taycan (Y1A / Y1B / Y1C)**

Model Year: **As of 2020 up to 2022**

Concerns: **Damping elements for high-voltage battery**

Information: After replacing the high-voltage battery or individual modules, noises can be heard while driving due to missing damping elements.

Action required: Before installation of a high-voltage battery, ensure damping elements are installed.

If the high-voltage battery is being repaired and reinstalled, ensure damping elements are affixed to the battery before installation.

If the high-voltage battery is being replaced, ensure damping elements are affixed to the new/remanufactured battery before installation.

Required parts and materials

| | | | |
|-------------|-------------------------------|--|---------------------------|
| Parts Info: | Part No. 9J1915448B | Designation ⇒ Damping elements – High-voltage battery | Number 4 pieces |
|-------------|-------------------------------|--|---------------------------|

| | | | |
|------------|-------------------------------|---|--|
| Materials: | Part No. D 00940104 | Designation ⇒ Cleaning solution or alternative (commercially available) | Quantity 250 ml/ 8.45 fl oz container (approx. 25 ml/ 0.85 fl oz required per vehicle) |
|------------|-------------------------------|---|--|

Checking damping elements

Work procedure: 1 Check how many damping elements are affixed on the high-voltage battery at the front left and right.
⇒ *Damping elements*

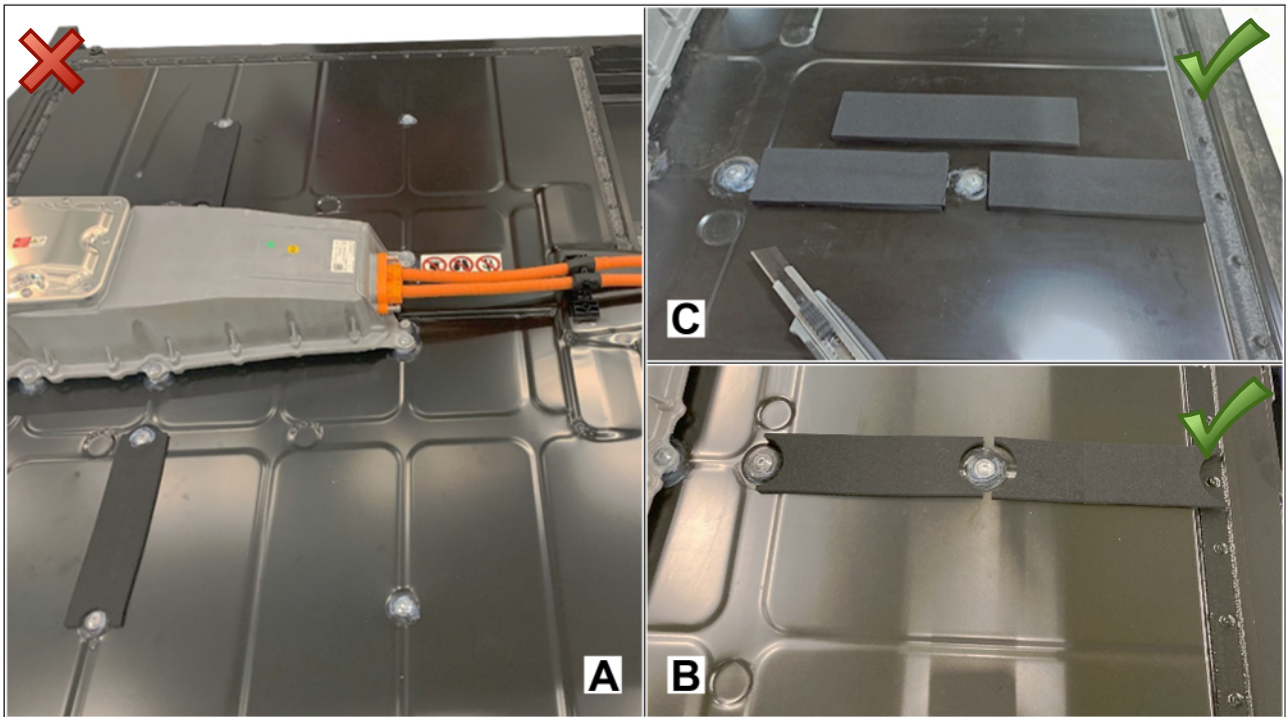

Damping elements

| Assessment | | Action |
|------------|---|---|
| (✓) | There are two ⇒ <i>Damping elements -B-</i> or three ⇒ <i>Damping elements -C-</i> damping elements affixed to both the left and right side of the battery (at least two to the left and two to the right of the e-box) | Install high-voltage battery. No further action is required. |
| (✗) | There are none or only one ⇒ <i>Damping elements -A-</i> on each side of the battery (left and right of the e-box). | Rework high-voltage battery, adding damping elements as needed. For instructions, see: ⇒ <i>Technical Information 'Affixing new damping elements (if required)'</i> |

Affixing damping elements



Information

- Never affix damping elements over the screws as they must remain accessible.
- The damping elements must be pressed into existing depressions and pressed on all the way around.
- The individual damping elements must be **at least 10 mm/ 0.39 in** apart.

- Work procedure: 1 Clean bonding areas on the damping elements on the high-voltage battery using an odor-neutral cleaning agent that is compatible with material (e.g. D00940104). → *Bonding areas on damping elements*
- 2 Dry off the surface with a clean, lint-free cloth or leave it to dry off for a sufficient length of time.
- 3 Affix damping elements in the area → *Bonding areas on damping elements -3-* on the high-voltage battery. When doing so, make sure to leave a gap of approx. 1 cm between the damping elements in order to drain the water.

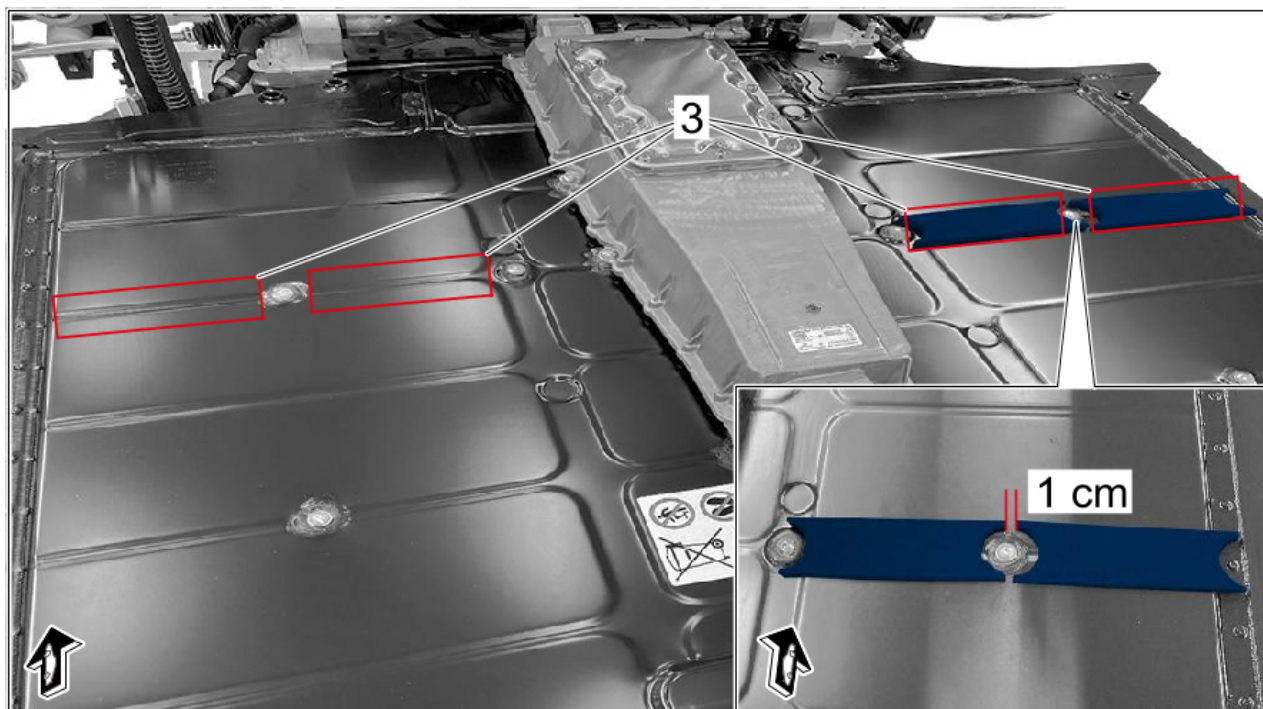

Bonding areas on damping elements

Invoicing

Invoicing: For documentation and warranty invoicing, enter the labor operations, PCSS coding and part numbers specified below in the warranty claim:

| APOS | Labour operation | I No. |
|----------|----------------------------------|-------|
| 27084990 | Reworking high-voltage batteries | |

PCSS encryption:

| | | |
|-------------------|-------|----------------------------|
| Location (FES5) | 2708T | High-voltage battery cover |
| Damage type (SA4) | 3014 | Scratches |

Important Notice: Technical Bulletins issued by Porsche Cars North America, Inc. are intended only for use by professional automotive technicians who have attended Porsche service training courses. They are written to inform those technicians of conditions that may occur on some Porsche vehicles, or to provide information that could assist in the proper servicing of a vehicle. Porsche special tools may be necessary in order to perform certain operations identified in these bulletins. Use of tools and procedures other than those Porsche recommends in these bulletins may be detrimental to the safe operation of your vehicle, and may endanger the people working on it. Properly trained Porsche technicians have the equipment, tools, safety instructions, and know-how to do the job properly and safely. Part numbers listed in these bulletins are for reference only. The work procedures updated electronically in the Porsche PIWIS diagnostic and testing device take precedence and, in the event of a discrepancy, the work procedures in the PIWIS Tester are the ones that must be followed.

© 2022 Porsche Cars North America, Inc.