

# DPF Harness Routing

M-373-001

(July 2009)

## Valid for

All MRU and LEU Models

## Case description

Should replacement of a DPF harness be necessary on an MRU or LEU model chassis, it is essential that the DPF harness-to-chassis harness connector be repositioned inside of the frame rail, out of the wheel splash area. Replacement DPF harnesses available through the MACK Parts System are longer than the existing harness to facilitate relocating the connector.

*Note: Does not apply to Mack Trucks Australia.*

## Parts

Part numbers for the longer DPF harnesses are as follows:

| Qty. | Part No. | Description  | Replaces                 |
|------|----------|--|--------------------------|
| 1    | 21285474 | Harness, DPF, MRU and LEU with MP7 engine and noncatalyzed DPF | 21175997<br>(41MR51140M) |
| 1    | 21311747 | Harness, DPF, MRU with MP8 engine and catalyzed DPF            | 21055570<br>(41MR31704)  |

## MRU Models

The following clamps, fasteners, brackets and cable ties will be necessary when relocating the DPF harness-to-chassis harness connector.

| Qty. | Part No.   | Description        |
|------|------------|--------------------|
| 1    | 48RU2313P3 | Cable tie          |
| 2    | 83AX685    | P-clamp, cushioned |
| 2    | 26AM46     | Flange screw       |
| 2    | 190AM5     | Nut                |
| 1    | 73RU4269M  | Bracket            |
| 1    | 1AX46      | Bolt               |
| 1    | 21AX784    | Locknut            |
| 1    | 35AX1249   | Flat washer        |
| 1    | 48RU3115M  | Cable Tie          |
| 5    | 48RU2313   | Cable Tie          |

1. After removing the existing DPF harness, relocate the chassis harness DPF connector so that the connector is located inside the frame rail.

2. Install the replacement DPF harness (part No. 21285474 for the non-catalyzed DPF [MRU with MP7 engine] or 21311747 for the catalyzed DPF [MRU with MP8 engine]).
3. Route the harness down the exhaust stanchion, and secure the harness to the stanchion mount with two P-clamps (part No. 83AX685), flange screws (part No. 26AM46) and nuts (part No. 190AM5) as shown in the illustration below. The lower P-clamp is secured to the same L-bracket where the hoses for the cab tilt pump are secured. Use cable tie (part No. 48RU2313P3 to secure the harness to the stanchion.

*Note: Be sure to provide enough slack in the harness where it is routed under the frame rail to prevent it from rubbing against the lower frame flange.*

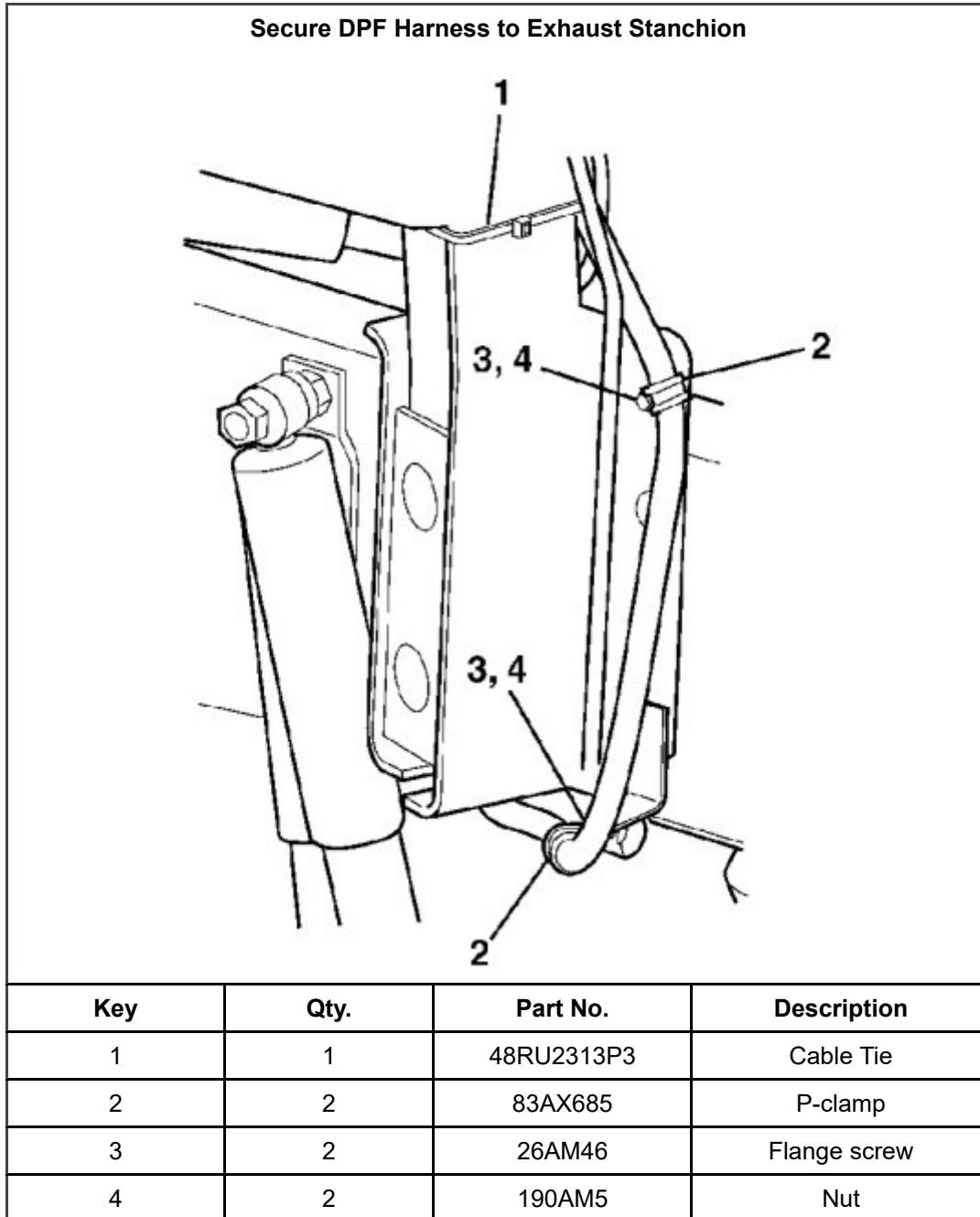

4. Continue routing the DPF harness toward the rear of the chassis, under the transmission mount. Connect the DPF harness connectors to the chassis harness connectors.

*Note: Connect DPF harness to the electric fuel pump/ shut off valve assembly (Non Catalyzed DPF models).*

5. Mounting hardware may be present at location (A) for mounting suspension brackets. If no mounting hardware is present, install mounting hardware using bolt (part No. 1AX46), flat washer (part No. 35AX1249) and locknut (part No. 21AX784). Install an L-bracket (part No. 73RU4269M) on the frame rail, just forward of the transmission mount as shown in the illustration below. Use cable tie (part No. 46RU3115M) to secure the DPF harness to the L-bracket.



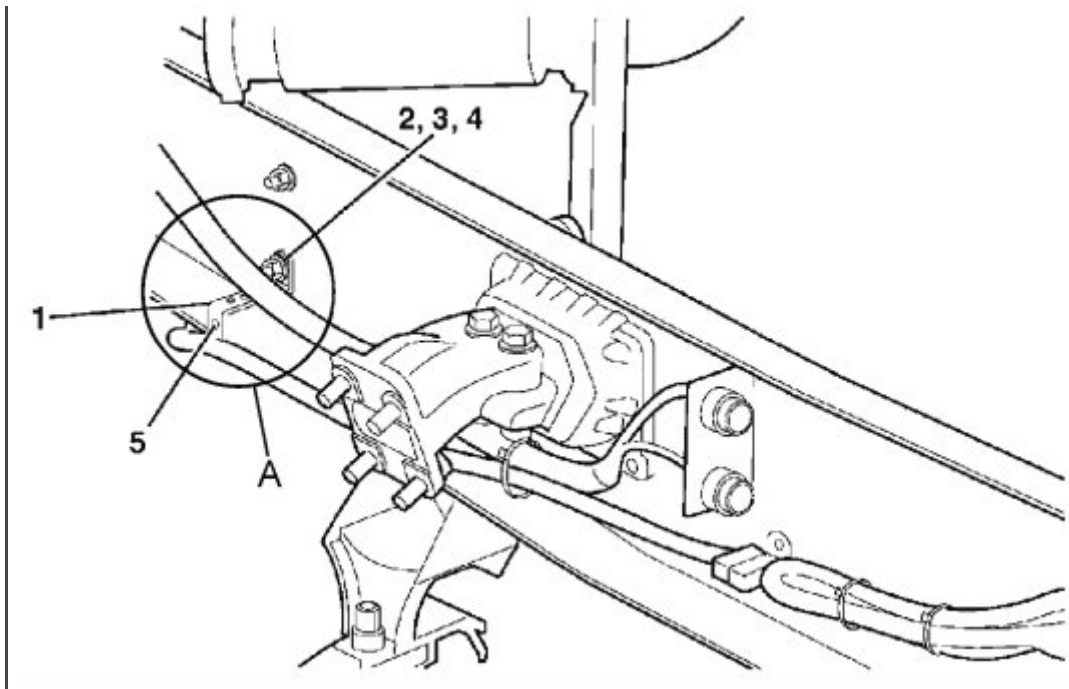

| Key | Qty. | Part No.  | Description |
|-----|------|-----------|-------------|
| 1   | 1    | 73RU4269M | L-bracket   |
| 2   | 1    | 11AX46    | Bolt        |
| 3   | 1    | 35AX1249  | Flat washer |
| 4   | 1    | 21AX784   | Locknut     |
| 5   | 1    | 48RU3115M | Cable tie   |

6. Use cable ties (part No. 48RU2313) to secure the DPF harness to the body builder harness.
7. Loop any excess chassis harness length back on itself, and secure with cable ties (part No. 48RU2313). Also, secure the harness connector to the L-bracket with cable tie (part No. 48RU2313).

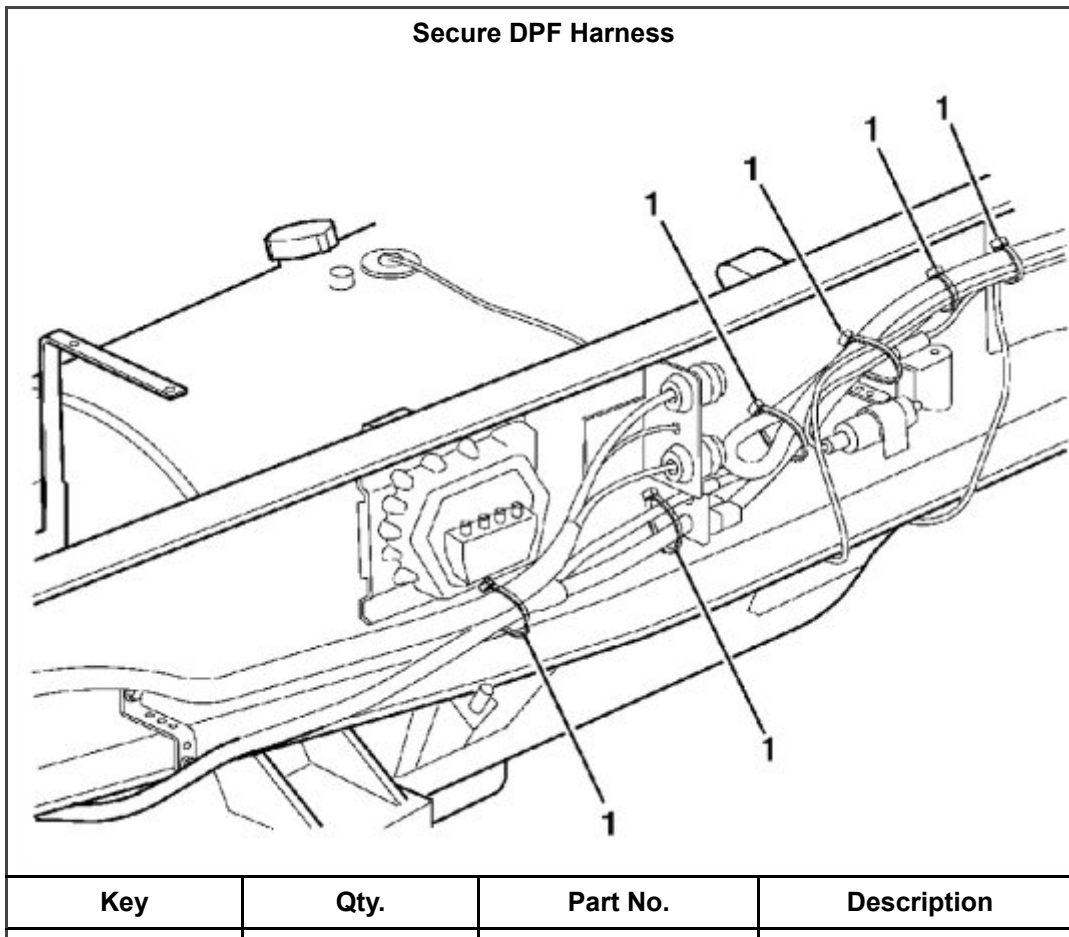

|   |   |          |           |
|---|---|----------|-----------|
| 1 | * | 48RU2313 | Cable tie |
|---|---|----------|-----------|

\* Quantity as required.

## LEU Models

The following clamps, fasteners, brackets and cable ties will be necessary when relocating the DPF harness-to-chassis harness connector.

| Qty. | Part No.   | Description        |
|------|------------|--------------------|
| 1    | 48RU2313P3 | Cable tie          |
| *    | 48RU2313   | Cable Tie          |
| 1    | 48RU3115M  | Cable Tie          |
| 2    | 83AX685    | P-clamp, cushioned |
| 2    | 1AX32      | Bolt               |
| 2    | 36AX1      | Lock washer        |
| 2    | 20AX1      | Nut                |
| 1    | 72RU439M2  | L-bracket          |
| 1    | 21AX784    | Locknut            |
| 1    | 35AX1249   | Flat washer        |
| 1    | 73RU4269M  | L-bracket          |
| 1    | 1AX46      | Bolt               |
| 1    | 35AX1249   | Flat washer        |
| 1    | 21AX784    | Lock nut           |

\* Quantity as required.

1. After removing the existing DPF harness, relocate the chassis harness DPF connector so that the connector is located inside the frame rail.
2. Install the replacement DPF harness (part No. 21285474).
3. Remove the nut from the lower front exhaust stanchion mounting bracket, and then Install an Lbracket (part No. 72RU439M2) on the bolt and secure with the existing nut. Route the harness down the exhaust stanchion. Secure the harness to the frame rail and the L-bracket with P-clamps (part No. 83AX685). Use bolts (part No. 1AX32), lock washers (part No. 36AX1) and nuts (part No. 20AX1) to secure the P-clamps to the frame rail and L-bracket. Use cable Tie (part No. 48RU2313P3) to secure the harness to the stanchion.

*Note: Be sure to provide enough slack in the harness where it is routed under the frame rail to prevent it from rubbing against the lower frame flange.*

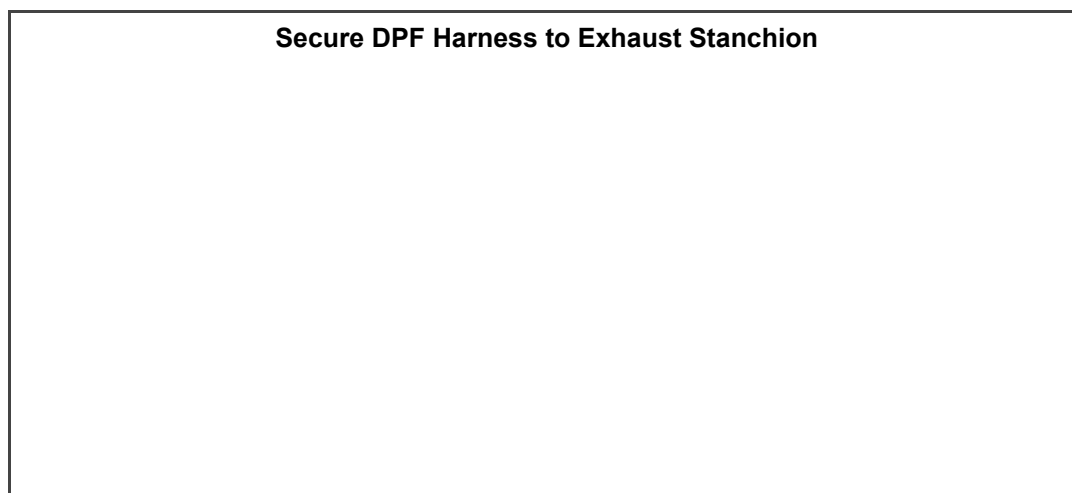

**Secure DPF Harness to Exhaust Stanchion**

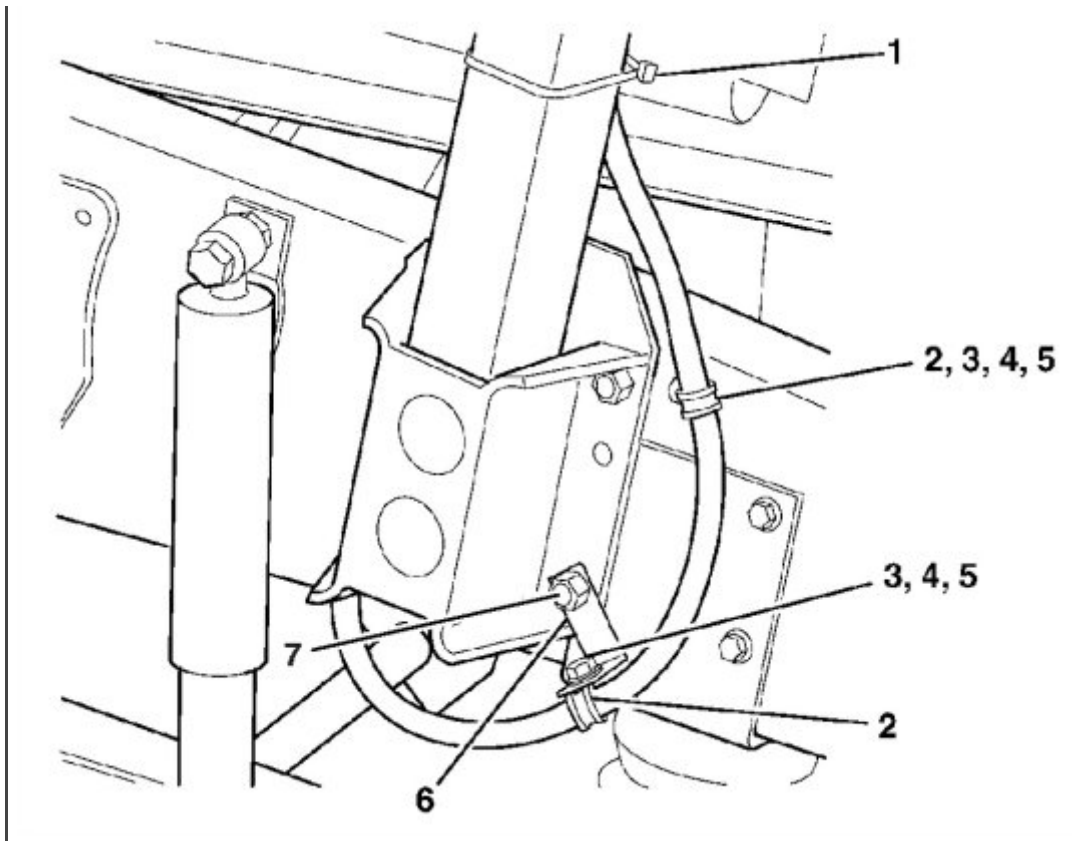

| Key | Qty. | Part No.   | Description          |
|-----|------|------------|----------------------|
| 1   | 1    | 48RU2313P3 | Cable Tie            |
| 2   | 2    | 83AX685    | P-clamp              |
| 3   | 1    | 1AX32      | Bolt                 |
| 4   | 2    | 36AX1      | Lock washer          |
| 5   | 2    | 20AX1      | Nut                  |
| 6   | 1    | 72RU439M2  | L-bracket            |
| 7   | 1    | 26AM46     | Flange Screw (M8x30) |

4. Continue routing the DPF harness toward the rear of the chassis, under the transmission mount, and connect to the chassis harness connector.
5. Mounting hardware may be present at location (A) for mounting suspension brackets. If no mounting hardware is present, install mounting hardware using using bolt (part No. 1AX46), flat washer (part No. 35AX1249) and locknut (part No. 21AX784), Install an L-bracket (part No. 73RU4269M) on the frame rail, just forward of the transmission mount as shown in the illustration below. Use cable Tie (part No. 48RU3115M) to secure the DPF harness to the L-bracket.
6. Use cable ties (part No. 48RU2313) to secure the DPF harness to the body builder harness.
7. Loop any excess chassis harness length back on itself, and secure with cable ties (part No. 48RU2313). Also, secure the harness connector to the L-bracket with cable tie (part No. 48RU2313).

**Install L-Bracket and Secure DPF Harness with Cable Ties**

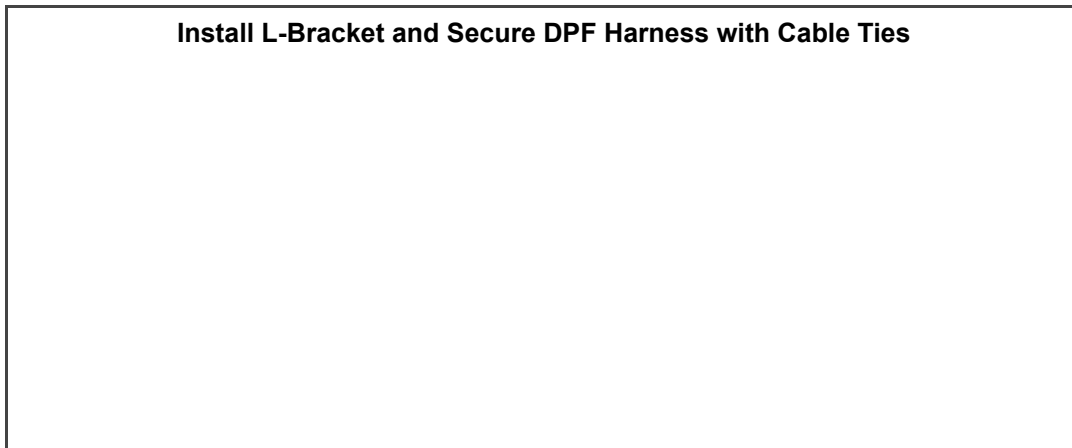

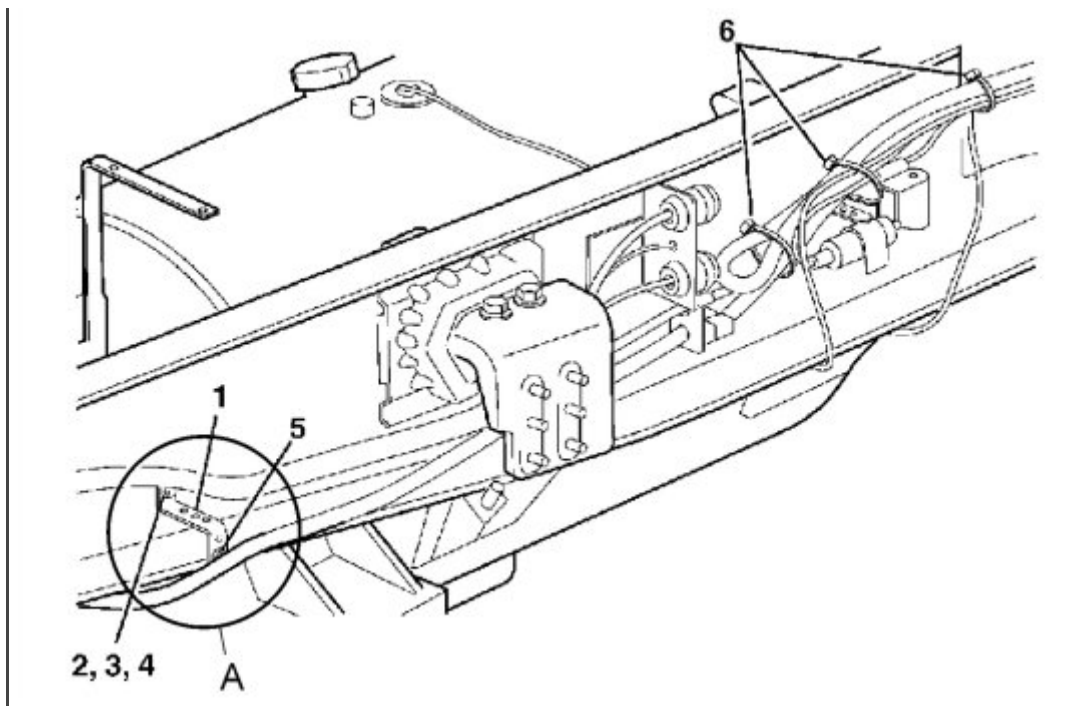

| Key | Qty. | Part No.  | Description |
|-----|------|-----------|-------------|
| 1   | 1    | 73RU4269M | L-bracket   |
| 2   | 1    | 11AX46    | Bolt        |
| 3   | 1    | 35AX1249  | Flat washer |
| 4   | 1    | 21AX784   | Locknut     |
| 5   | 1    | 48RU3115M | Cable Tie   |
| 6   | *    | 48RU2313  | Cable Tie   |

\* Quantity as required.

## Warranty information

### Reimbursement

|  |  |
|--|--|
| <b>This Repair may be eligible for reimbursement if a product failure was experienced within the time and mileage limits of the applicable warranty coverage. Reimbursement is obtained via normal claim handling process.</b> |  |
| <b>Claim Type (used only when uploading from the Dealer Bus. Sys.)</b>   | 01   |
| <b>Labour Code</b>   |  |
| Primary Labour Code  | 7237A-01-11<br>1.5 hrs.  |
| <b>Causal Part</b>   | 21175997- Harness, DPF, MRU and LEU with MP7 engine and non-catalyzed DPF. |
| <b>Causal Part</b>   | 21055570- Harness, DPF, MRU with MP8 engine and catalyzed DPF.             |

## Issued by

## Technical Service

Mack Trucks, Inc. engages in a continuous program of testing and evaluating to provide the best possible product. Mack Trucks, Inc., however, is not committed to, or liable for updating existing chassis.