



RCA-46-22-001-1: Add Shock Tower Washers to Support Front Upper Control Arm Bushings

Rivian is initiating a customer satisfaction campaign for some model year 2022 R1T vehicles that may have been built with front upper control arm bolt pass through holes in the shock tower that are larger than necessary. This could lead to premature wear of the control arm bushings, causing minor changes to vehicle suspension alignment. Rivian will inspect the front upper control arm bushings for wear and install washers on the front shock towers to better support the bushings. Rivian is launching this campaign for customer satisfaction and to ensure the quality of Rivian vehicles.

Document Type	Customer Satisfaction Campaign Bulletin
Date	July 27, 2022
Affected Region(s)	USA
Affected Model(s)	R1T
Model Year(s)	2022
Approximate Build Dates	August 2021 - October 2021
 Refer to the FSA Dashboard to determine if this document applies to a specific vehicle.	
Vehicle System	46 - Frame
Minimum Service Location	Service Center

Potentially Required Parts

Part Number	Quantity	Engineering Name	Service Name/Notes
SC00016057-A	4	WSHR - 5/8X0.125X1.5 RND FL SS	Round washer
SC00016058-A	4	WSHR - 9/16X0.09X1.5 RND FL CLIPPED SS	Clipped washer
PT00001853-H	1	ASSY - UPR CONTROL ARM; FRT; LH	Control Arm, Upper, Front, LH
PT00001857-H	1	ASSY - UPR CONTROL ARM; FRT; RH	Control Arm, Upper, Front, RH
PT00569365-A	As needed	Loctite 431	Instant adhesive
SC00002057-A	As needed	BOLT - M14X2.0X80 HX FL PIL CL10.9	Bolt, Upper Control Arm

 **Attention:** The parts listed in this table are only for unique steps that are called out in this bulletin. Some sections of this bulletin might refer to Service Manual procedures which require additional parts. Always review the bulletin and all potentially related Service Manual procedures before ordering parts and beginning work.

Inspection

1. Remove: Wheel and Tire Assembly, Front, LH (refer to service manual procedure 221010011).
2. Check for the presence of washers on the shock tower flange.

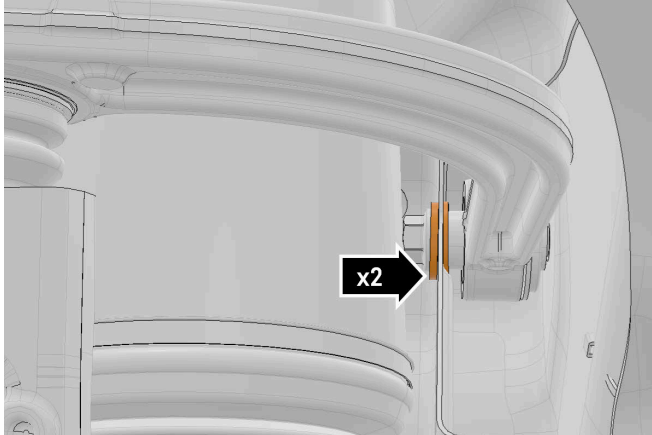

- If washers are installed on the shock tower flange: Reinstall all components that were removed for access and replace all non-reusable components.
- If no washers are present: Continue to the [Washer Installation](#) section.

Washer Installation

1. Using RiDE: Depressurize the air suspension.



CAUTION: Do not lower the vehicle until the air springs have been re-filled.

2. Using RiDE: Depressurize the hydraulic suspension. Open the valves.
3. Remove: Control Arm, Upper, Front, LH (refer to service manual procedure 181010010).

4. Clean the area(s) with a mild residue-free cleaning product.

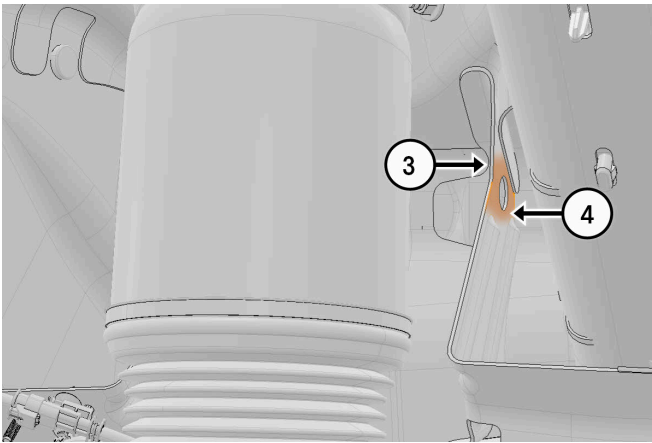
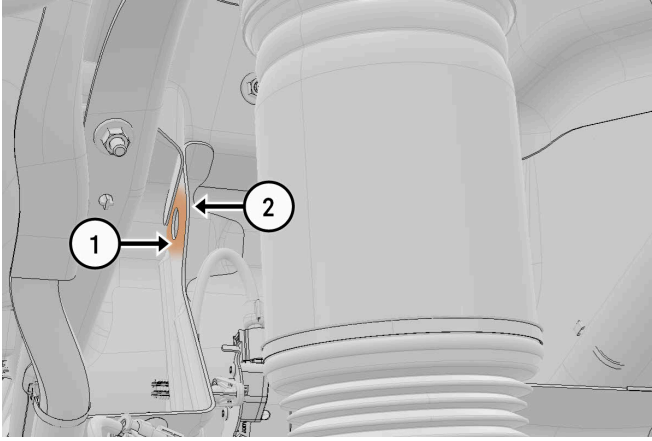

1	Front flange outboard surface
2	Front flange inboard surface
3	Rear flange inboard surface
4	Rear flange outboard surface

5. Put on disposable gloves.

 **Warning:** Wear appropriate eye protection during this procedure.

6. Install the components on the front flange.

a. Apply adhesive to 1 clipped washer and 1 round washer.

 **Warning:** The adhesive can bond skin within seconds.

b. Position the component(s) as shown. Loosely install the fastener(s).

Figure 1. Front flange

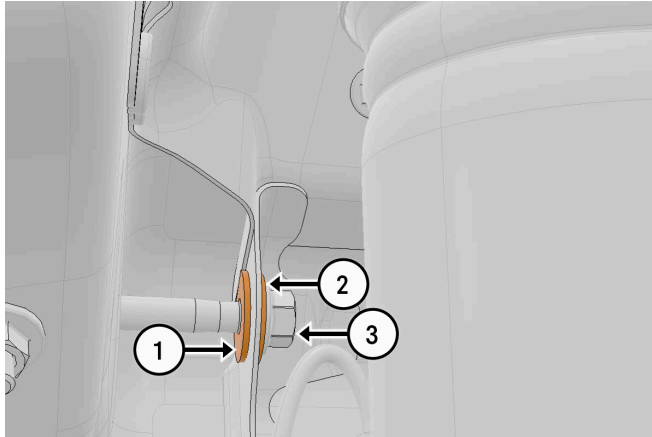

1	Clipped washer
2	Round washer
3	Upper control arm bolt

c. Using the long-nose locking pliers:



 **Note:** Shown with components removed for clarity.

7. Install the components on the rear flange.

a. Apply adhesive to 1 clipped washer and 1 round washer.

 **Warning:** The adhesive can bond skin within seconds.

b. Position the component(s) as shown. Loosely install the fastener(s).

Figure 2. Rear flange

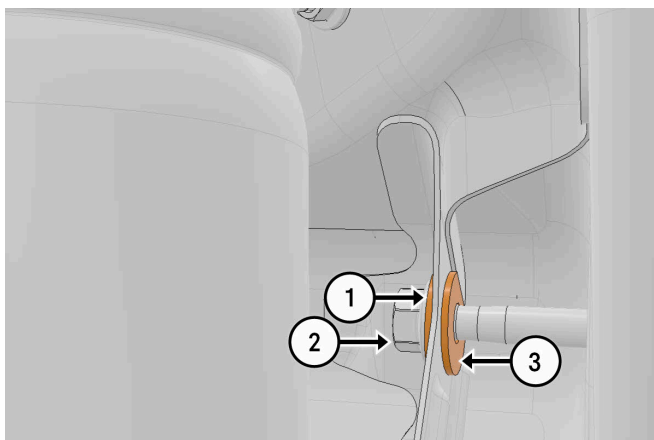

1	Round washer
2	Upper control arm bolt
3	Clipped washer

c. Using the long-nose locking pliers:



 **Note:** Shown with components removed for clarity.

8. Remove:

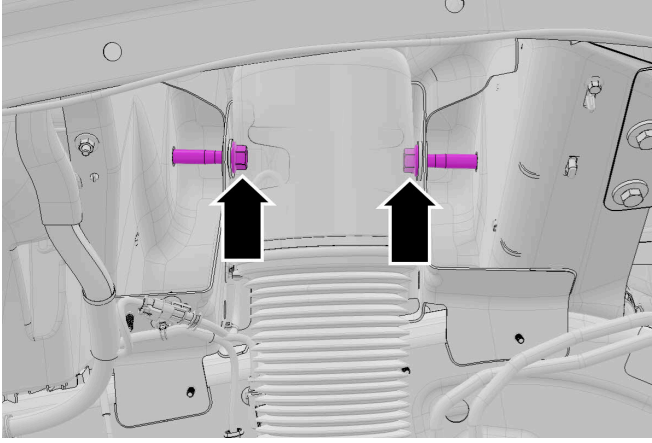

Note: Shown with components removed for clarity.

9. Check the bolts for adhesive.

- If there is adhesive on a bolt: Replace the bolt.
- If there is no adhesive on the bolts: The bolts can be reused.

10. Wait 5 minutes for the adhesive to cure.

11. Remove the long-nose locking pliers.

12. On both sides of the component: Check the highlighted area(s) for damage.

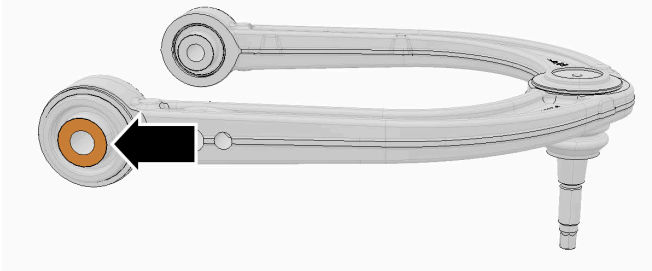

- If there is damage: Replace the component(s). Refer to service manual procedure 181010010.
- If there is no damage: Reinstall the component(s). Refer to service manual procedure 181010010.

13. Repeat the steps in this section on the opposite side of the vehicle.

14. Reinstall all components that were removed for access and replace all non-reusable components.



CAUTION: Do not lower the vehicle until the air springs have been re-filled.

15. Perform: Alignment, Four Wheel, Check (refer to service manual procedure 983210013).

Labor Codes

Labor Code	Description
RCA462200100	RCA-46-22-001-1 not applicable
RCA462200101	Vehicle inspection only; front shock tower washers already installed
RCA462200102	Install front shock tower washers, 4 wheel alignment check
RCA462200103	Install front shock tower washers, 4 wheel alignment check and adjust
RCA462200104	Replace LH front upper control arm, install front shock tower washers, 4 wheel alignment check
RCA462200105	Replace LH front upper control arm, install front shock tower washers, 4 wheel alignment check and adjust
RCA462200106	Replace RH front upper control arm, install front shock tower washers, 4 wheel alignment check
RCA462200107	Replace RH front upper control arm, install front shock tower washers, 4 wheel alignment check and adjust
RCA462200108	Replace LH and RH front upper control arms, install front shock tower washers, 4 wheel alignment check
RCA462200109	Replace LH and RH front upper control arms, install front shock tower washers, 4 wheel alignment check and adjust
Contact ServiceDocumentFeedback@rivian.com regarding labor codes and document content.	