



SIB 21 01 22

CLUTCH NOISES WHEN DRIVING OFF FROM A STANDSTILL

2022-05-26

MODEL

| Model | Model Description | Model Year |
|-------|-------------------|------------|
| K02 | G 310 GS | 2018-2020 |
| K03 | G 310 R | 2018-2020 |

SITUATION

In the clutch friction phase when driving off, the clutch makes squeaking noises.

PROCEDURE

Figure 1: Oil Pipe (#1 in picture)

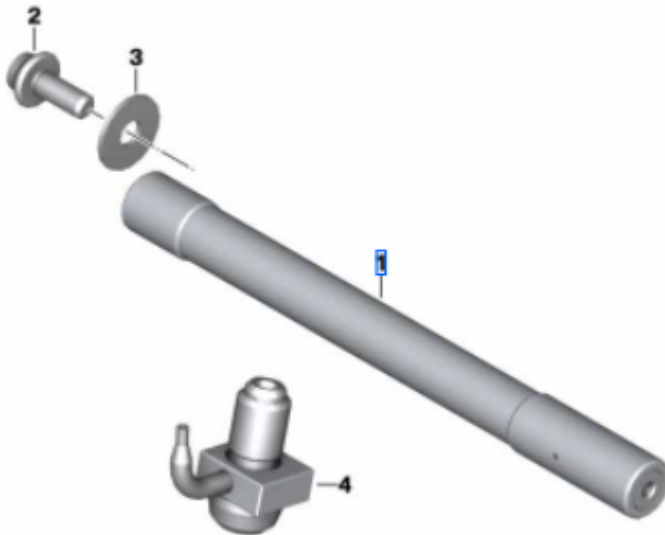

A modified oil pipe which increases the oil supply to the clutch, part number below, must only be installed in the event of a noise complaint by a customer.

In case of such a complaint, inspect the clutch discs for damage and signs of overheating; if none are found, replace the oil pipe using the information below, reusing the clutch components.

If damage and signs of overheating are found, replace the oil pipe using the information below, and replace the clutch disc set, remembering to thoroughly oil it before installation.

NOTE: Because the new and old oil pipes differ only in their internal structure - there are no external distinguishing features – there is a risk of mixing them up. Mark the new oil pipe prior to the removal of the old oil pipe.

PARTS INFORMATION

Obtain and confirm the part numbers for your specific vehicle by entering the chassis number in ETK which takes into account specific equipment and/or options.

Additional parts like gaskets, hardware and chemicals may be required for the complete repair.

Copyright ©2022 MOTORRAD USA, a division of BMW of North America, LLC. All Rights Reserved

Part Number

| | | |
|-----------------|--|--------|
| 21 21 8 387 911 | Kit of mounting parts | QTY: 1 |
| 11 42 7 107 869 | Oil pipe | QTY: 1 |
| 11 13 8 562 759 | Clutch cover seal | QTY: 1 |
| 11 51 8 568 720 | Sealing washer (bolting of coolant impeller) | QTY: 1 |
| 11 11 8 562 771 | Sealing ring | QTY: 1 |
| 21 21 8 566 432 | <i>Disc set, if required</i> | QTY: 1 |

CLAIM INFORMATION

Covered under the terms of the BMW New Vehicle Limited Warranty for Motorcycles, if applicable.

Defect code

| | |
|----------------|----------------------|
| 21 21 00 39 00 | Clutch making noises |
|----------------|----------------------|

Labor Operation

| | | |
|-----------|----------------------------------|--------------------------|
| 21 21 000 | Remove/install or replace clutch | 17 FRU K02 13 FRU K03 |
| 11 42 615 | Change oil line (clutch removed) | 1 FRU |

FRUs includes all repair procedures to complete the task with allowance for necessary ancillary tasks (e.g., visual inspection, lubrication, cleaning parts etc.) and administrative tasks.

QUESTIONS REGARDING THIS BULLETIN

| | |
|---------------------|---|
| Technical inquiries | Contact the BMW Technical Support Group via TSARA |
| Warranty inquiries | Submit an IDS ticket to the Warranty Department |
| Parts inquiries | Submit an IDS ticket to the Motorrad Parts Department |

Supporting Materials

[picture_as_pdf 21 01 22 Clutch noises when taking off from a standstill.pdf](#)

Service Information Bulletin

Clutch

May 26, 2022

21 01 22

CLUTCH NOISES WHEN DRIVING OFF FROM A STANDSTILL



**BMW
MOTORRAD**

MODEL

| Model | Model Description | Model Year |
|-------|-------------------|------------|
| K02 | G 310 GS | 2018-2020 |
| K03 | G 310 R | 2018-2020 |

SITUATION

In the clutch friction phase when driving off, the clutch makes squeaking noises.

PROCEDURE

Figure 1: Oil Pipe (#1 in picture)

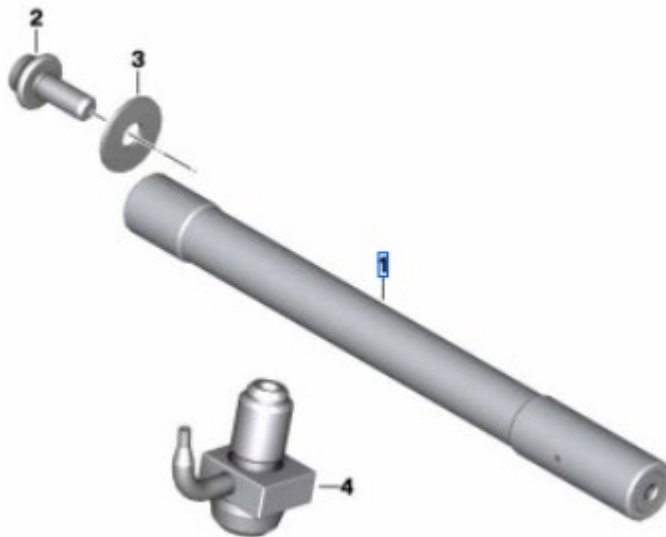

A modified oil pipe which increases the oil supply to the clutch, part number below, must only be installed in the event of a noise complaint by a customer.

In case of such a complaint, inspect the clutch discs for damage and signs of overheating; if none are found, replace the oil pipe using the information below, reusing the clutch components.

If damage and signs of overheating are found, replace the oil pipe using the information below, and replace the clutch disc set, remembering to thoroughly oil it before installation.

NOTE: Because the new and old oil pipes differ only in their internal structure - there are no external distinguishing features – there is a risk of mixing them up. Mark the new oil pipe prior to the removal of the old oil pipe.

PARTS INFORMATION

Obtain and confirm the part numbers for your specific vehicle by entering the chassis number in ETK which takes into account specific equipment and/or options.

Additional parts like gaskets, hardware and chemicals may be required for the complete repair.

Part Number

| | | |
|-----------------|--|--------|
| 21 21 8 387 911 | Kit of mounting parts | QTY: 1 |
| 11 42 7 107 869 | Oil pipe | QTY: 1 |
| 11 13 8 562 759 | Clutch cover seal | QTY: 1 |
| 11 51 8 568 720 | Sealing washer (bolting of coolant impeller) | QTY: 1 |
| 11 11 8 562 771 | Sealing ring | QTY: 1 |
| 21 21 8 566 432 | <i>Disc set, if required</i> | QTY: 1 |

CLAIM INFORMATION

Covered under the terms of the BMW New Vehicle Limited Warranty for Motorcycles, if applicable.

Defect code

| | |
|----------------|----------------------|
| 21 21 00 39 00 | Clutch making noises |
|----------------|----------------------|

Labor Operation

| | | |
|-----------|----------------------------------|--------------------------|
| 21 21 000 | Remove/install or replace clutch | 17 FRU K02 13 FRU K03 |
| 11 42 615 | Change oil line (clutch removed) | 1 FRU |

FRUs includes all repair procedures to complete the task with allowance for necessary ancillary tasks (e.g., visual inspection, lubrication, cleaning parts etc.) and administrative tasks.

QUESTIONS REGARDING THIS BULLETIN

| | |
|---------------------|---|
| Technical inquiries | Contact the BMW Technical Support Group via TSARA |
| Warranty inquiries | Submit an IDS ticket to the Warranty Department |
| Parts inquiries | Submit an IDS ticket to the Motorrad Parts Department |