

Maintenance for HV and Auxiliary Batteries

Service Category General

Section Pre-Delivery Service

Market USA

Toyota Supports
ASE Certification 

Applicability

YEAR(S)	MODEL(S)	ADDITIONAL INFORMATION
2022	Avalon HV, Camry HV, Corolla HV, Highlander HV, Mirai, Prius, Prius Prime, RAV4 HV, RAV4 Prime, Sienna HV, Tundra HV, Venza HV	

REVISION NOTICE

March 16, 2022 Rev1:

- **Applicability has been updated to include 2022 model year Tundra HV vehicles.**
- Any previous printed versions of this bulletin should be discarded.**

Maintenance for HV and Auxiliary Batteries

Introduction

Hybrid vehicles are equipped with two types of batteries:

- Hybrid vehicle (HV) battery.
- Auxiliary (12V) battery.

If the hybrid vehicle is put into storage, the State-Of-Charge (SOC) of its HV battery and auxiliary battery will gradually decrease. To prevent the auxiliary battery from becoming discharged during storage, proper maintenance is necessary.

As a matter of policy, Toyota does not provide battery warranty coverage for discharged and/or failed batteries due to lack of maintenance. It is the dealer's responsibility to maintain the specified SOC of the vehicle's battery while in stock and ensure proper SOC at delivery.

Perform the following maintenance service for the HV battery and auxiliary battery.

NOTE

- BEFORE disconnecting the auxiliary battery, confirm the shift lever is in the "P" position. The shift lever CANNOT be shifted from the "P" position with the auxiliary battery disconnected.
- Do NOT apply the parking brake. Ensure vehicles with electronic parking brakes do NOT engage and the Auto function has been DISABLED (Refer to the vehicle's Owner's Manual for details).
- If the negative (-) terminal of the auxiliary battery is reconnected, even if the Power button is in the Start mode, the hybrid system may NOT start. In this case, push the Power button and select the Start mode again to start the hybrid system (the Ready light is ON). If the hybrid system still does NOT start (the Ready light is OFF), refer to the Repair Manual.

Maintenance Items

CONDITION*	MAINTENANCE OPERATION
Before Delivery	Fully charge the auxiliary battery (deliver the vehicle to the customer AFTER it is fully charged to 12.6V or more).
To Store for 30 Days or More (Except Mirai)	Disconnect the negative (-) terminal of the auxiliary battery in the luggage compartment to prevent the SOC of the auxiliary battery from decreasing during storage due to parasitic current.
Periodical Battery Charging: Upon arrival at the dealership and then every 2 months	Keep the hybrid system ON for 30 minutes with the transmission in the "P" position (in order to charge the HV battery and the auxiliary battery).

*The condition also corresponds with the section titles within this bulletin.

Maintenance for HV and Auxiliary Batteries

Warranty Information

OP CODE	DESCRIPTION	TIME	OFF	T1	T2
N/A	Not Applicable to Warranty	–	–	–	–

Required Tools & Equipment

SPECIAL SERVICE TOOLS (SST)	PART NUMBER	QTY
Battery Diagnostic Tool*	DCA-8000P T	1

*Essential SST.

NOTE

- The DCA-8000 battery diagnostic tool (P/N DCA-8000P T) supersedes the GR8 battery diagnostic station (P/N 00002-MCGR8).
- Additional SSTs may be ordered by calling 1-800-933-8335.

Before Delivery

1. BEFORE charging the auxiliary battery, turn OFF ALL lights, accessories, and the hybrid system.
2. Check the battery SOC.
 - If the battery voltage is LESS THAN 12.6V, continue to step 3.
 - If the battery voltage is 12.6V or MORE, replace the positive (+) terminal cover, install the battery cover (if applicable), and close the luggage compartment/hood.

NOTE

- If measuring the voltage with the negative (–) terminal connected, turn OFF the Power button and turn ON the high beams for 20 – 30 seconds. This will remove the surface charge from the battery.
- If the engine has been running before measuring the voltage, wait 20 minutes or more after the engine stops. This removes the surface charge.
- For details on how to use the battery diagnostic station, refer to the [DCA-8000 Instruction Manual](#) located at TIS – *Diagnostics – Tools & Equipment – Battery Diagnostics*.

Maintenance for HV and Auxiliary Batteries

Before Delivery (continued)

3. Test the auxiliary battery using the DCA-8000 battery diagnostic tool's Advanced Battery Test mode.
If charging is required, the DCA-8000 battery diagnostic tool will automatically start to charge.
 - A. Connect the red charger clamp to the positive (+) terminal and the black charger clamp to the negative (-) terminal.
 - B. Plug the charger into a grounded 110V outlet and press the power button.
 - C. Once the DCA-8000 battery diagnostic tool is properly turned ON, perform an Advanced Battery Test. The DCA-8000 battery diagnostic tool will indicate results when complete. If the battery tests bad "Replace Battery," replace the auxiliary battery.

Figure 1. DCA-8000 Battery Diagnostic Tool



CAUTION

- Charge in a well-ventilated area.
- Do NOT allow sparks OR fire near the auxiliary battery.

NOTE

If the auxiliary battery was stored at 32°F (0°C) or below, charge the auxiliary battery in a room above 32°F (0°C).

4. If the DCA-8000 battery diagnostic tool is NOT available, you may charge the auxiliary battery by cycling the vehicle to Ready ON.
 - Run time will vary depending on the battery SOC.
 - If this method is used, you MUST confirm that the battery is charged to 12.8V using a DVOM.

Maintenance for HV and Auxiliary Batteries

To Store for 30 Days or More-Disconnect the Negative (-) Terminal (Except Mirai)

1. Turn OFF ALL lights, accessories, and the hybrid system.
2. Disconnect the negative (-) terminal.

NOTE

When it is necessary to move the vehicle, reconnect the negative (-) terminal.

3. When removing the vehicle from storage, connect the negative (-) terminal.

Please refer to applicable Repair Manual for torque specifications.

NOTE

AFTER recharging the auxiliary battery, the hybrid system may NOT start. Follow the procedure below to initialize the system.

1. Put the shift lever in the "P" position.
2. Open and close ANY of the doors.
3. Restart the hybrid system.

Figure 2.

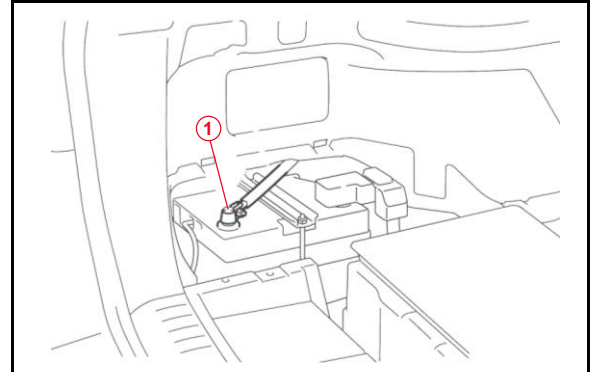

1	Negative (-) Terminal
----------	------------------------------

Periodical Battery Charging-Cycle Vehicle to Ready ON

NOTE

- When the remaining capacity of the HV battery is low, the gasoline engine automatically starts and the HV battery is charged. The auxiliary battery is also charged by the HV battery regardless of the gasoline engine operation.
- Be sure to reconnect the negative (-) terminal of the auxiliary battery BEFORE performing this procedure.

1. Park the vehicle in open air or connect the exhaust extraction hose to the exhaust pipe.
2. Apply the parking brake.

Maintenance for HV and Auxiliary Batteries

Periodical Battery Charging-Cycle Vehicle to Ready ON (continued)

3. With the brake pedal depressed, push the Power button and check that the Ready light in the meter illuminates when the hybrid system starts (the Ready light is ON).

Figure 3.

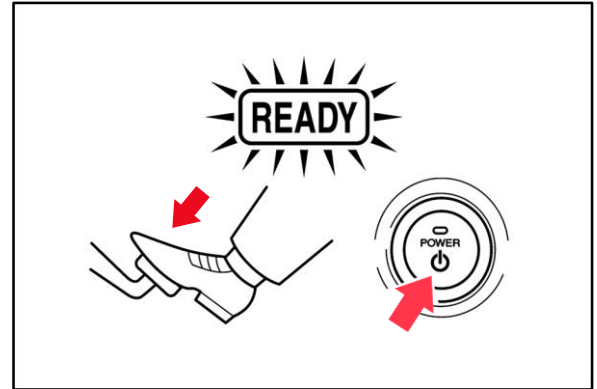

4. Turn OFF ALL lights and accessories.
5. Check that the shift lever is in the “P” position.
6. Keep the Ready light ON and charge the HV battery for 30 minutes.

NOTE

- If the amount of charging energy is small, the display may NOT indicate the energy flow.
- Ensure there is a sufficient amount of fuel for the vehicle to run for 30 minutes.