

Model: Aprilia RS - Tuono - Tuareg 660 E5

Subject: Gear shift lever (code 2B007256 RS-Tuono 660; code 2B010035 Tuareg 660)

Dear Dealer / Service Centre,

We hereby inform you that in a limited production lot of the models in question, non-compliant parts may have been installed, for this reason we invite you to carry out a check, according to the procedure below, during the PDI, for Stock vehicles, or at the earliest opportunity, per sold vehicles.

N.B: always check that there is no wear on the teeth of the lever/shaft splines.

Step 1 - Control test procedure

1. Apply a torque of 15 Nm on the fastening screw (part 12 of figure 1) of the gear shift lever on the gear pre-selector shaft.
2. Check that the coupling between the gear shift lever (part 22 of figure 1) and the gear pre-selector shaft is secure/tight by trying to pull the lever off the shaft 2-3 times. Proceed to **Step 2**.

Step 2 - Test Outcome

- **If the gear shift lever is secure/tight and does not move on the shaft:**
 1. Remove the fastening screw (part 12 of figure 1) of the gear shift lever on the gear pre-selector shaft and apply Loctite 243 (blue/medium strength) to the threads.
 2. Refit the screw applying a tightening torque of 17 Nm. No further action is required.
- **If the gear shift lever is loose and moves on the shaft:**
 1. Replace the gear shift lever with code 2B011144 for RS660 and Tuono660 or code 2B011146 for Tuareg660 (see fig. 2) and apply a torque of 15 Nm to the relative fixing screw (part 12 of figure 1).

2. After fitting the new part, check that the coupling between the gear shift lever (part 22 of figure 1) and the gear pre-selector shaft is secure/tight by trying to pull the lever off the shaft 2-3 times. Proceed to **Step 3**.

Step 3 - Only required if the gear shift lever is replaced

- **If the gear shift lever is secure/tight and does not move on the shaft:**
 1. Remove the fastening screw (part 12 of figure 1) of the gear shift lever on the gear pre-selector shaft and apply Loctite 243 (Blue/Medium Strength) to the threads.
 2. Refit the screw (part 12 of figure 1) applying a tightening torque of 17 Nm. No further action is required.

- **If the gear shift lever is loose and moves on the shaft:**
 Contact Technical Assistance for further checks and actions to be taken.

Fig.1 (gear shift lever and pre-selector shaft)

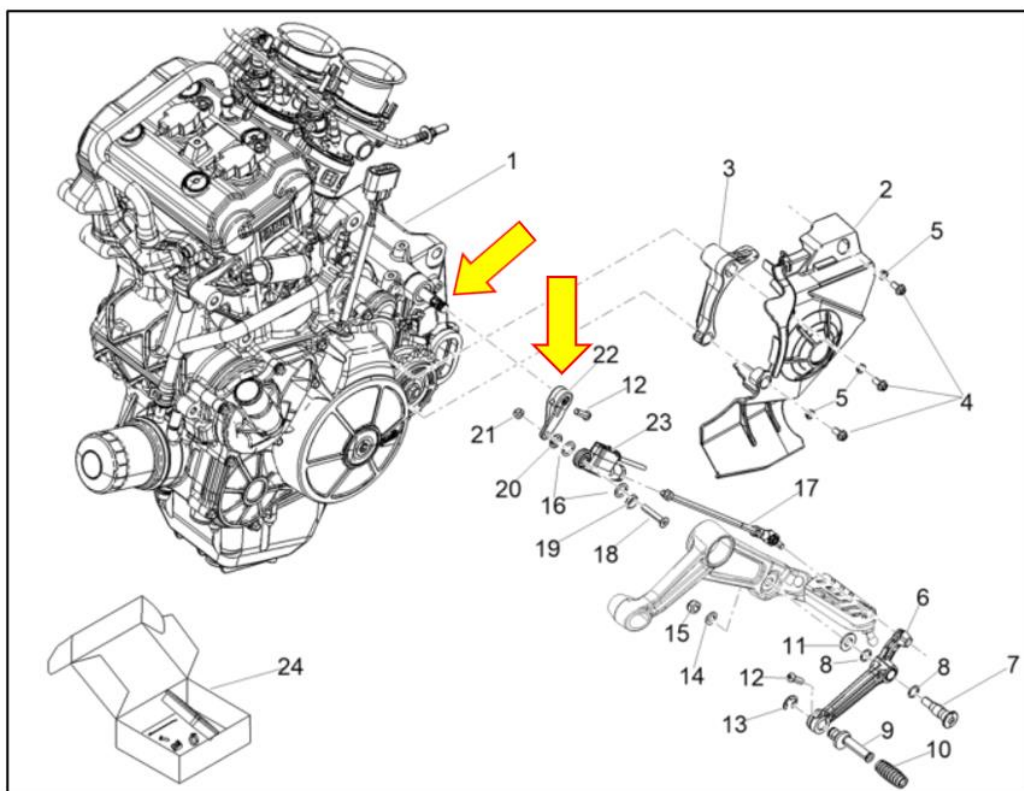
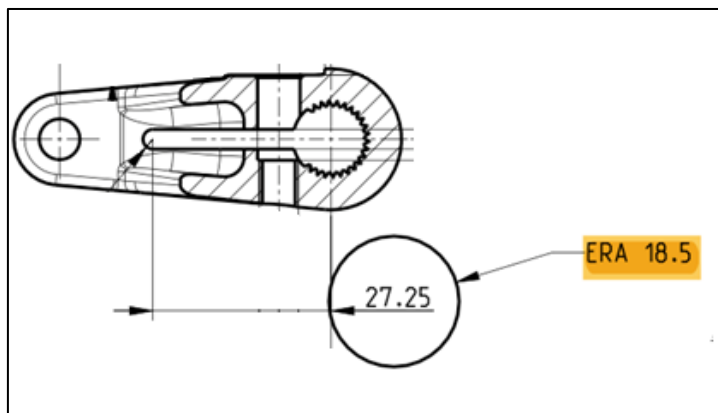



Fig.2 new gear shift lever



The new lever (Fig.2) code 2B011144 and 2B011146 differs from the previous one as it has a longer internal slot as shown in the figure above.

Our Technical Assistance Service is in any case at your disposal to provide you with any information and support you may deem necessary through the Help Desk service.

Best regards,

Piaggio & C. SpA
Business Unit Aftersales
Operations & Technical Service