

Release Date	05/24/2022	Technical Service Bulletin		
06F2 UPDATE				
Owner's Manual Supplement – (NVLW)				

Applicable Vehicles				
Country	Beginning Model Year	Ending Model Year	Vehicle	Vehicle Count
USA	2021	2023	ATLAS FL	82,588
CAN	2021	2022	ATLAS FL	9,292

Revision History		
Revision	Date	Purpose
1	05/24/2022	Original publication

Condition/Technical Background

This Update has been proactively released to prevent the following condition(s) from occurring in the vehicle:	
Criteria	Technical Background
01	The subject owner's manual contains an incomplete description of the red unlocking mark on the vehicle's backrest.

Remedy

Criteria	Remedy
01	Print out the owner's manual supplement and place it in the glove compartment.

This Update is in effect until removed.

Vehicle must meet all of the following criteria:

- Procedure is valid only for vehicles that show the **06F2** code in the ELSA Campaign/Action Information screen on the day of repair.
- Vehicle must be within the New Vehicle Limited Warranty (NVLW).
- Procedure must be performed within the allotted time frame stated in this Technical Service Bulletin.
- Procedure must be performed on applicable vehicles in dealer inventory prior to sale.

Release Date	05/24/2022	Technical Service Bulletin	
06F2 UPDATE Owner's Manual Supplement – (NVLW)			

Service

NOTE:

- ELSA is the only valid inquiry/verification source. Check ELSA on the day this vehicle UPDATE will be performed to verify vehicle eligibility for the UPDATE. Status must show “open”. Attach an ELSA printout showing the “open” status to the repair order.
- If this UPDATE appears to have already been performed but the code still shows open in ELSA, contact Warranty before proceeding further. Another dealer may have recently performed this UPDATE but not yet entered a claim for it in the system.
- ELSA may also show additional open action(s); if so, inform your customer - this work can be done while the vehicle is in for this UPDATE.
- Contact the Warranty Helpline (U.S.) or the Warranty Campaign Specialist (Canada) if you have any questions.

Applicable criteria ID(s)	Campaign/Action Status
01 ← 2	Open ← 1

EXAMPLE

Campaign/Action	Start	Designation
← 3	2015-11-10	W-SERV_ACT -
	2018-12-13	RECALL -
	2017-05-16	A-RECALL -

EXAMPLE

- Enter the VIN in ELSA and proceed to the “Campaign/Action” screen.

TIP

On the date of repair, print this screen and keep a copy with the repair order.



- Confirm the Campaign/Action is open <arrow 1>. If the status is closed, no further work is required.
- Note the Applicable Criteria ID <arrow 2> for use in determining the correct work to be done and corresponding parts associated.

CRITICAL REPAIR STEP

STOP STOP!

If multiple software update Campaign/Actions are open, they must be performed in order of the Start date <arrow 3>. The oldest should be performed first.

- **All Safety Recalls must be completed prior to completing this campaign.**

06F2 UPDATE
Owner's Manual Supplement – (NVLW)

Seats and head restraints
Atlas, Teramont

This supplement describes revisions that have been produced after publication of the Owner's Manual. The new section replaces the corresponding section "Seats and head restraints" in the Owner's Manual:

- 2020/07
- 2021/01
- 2021/08

Please refer to the other sections of the Owner's Manual for all other information, descriptions, and specifications for the operation and handling of your vehicle, such as information you should know regarding your personal safety and the safety of your passengers.

- U.S.A.: Print out the English owner's manual supplement found on one of the ELSA attachment tabs or in ServiceNet.
- CANADA: Print out the English and French owner's manual supplements found on one of the ELSA attachment tabs or in ServiceNet.
- When printing, select "Booklet" for page sizing.
- Place the printed owner's manual supplement in the vehicle glove compartment.

Release Date	05/24/2022	Technical Service Bulletin	
06F2 UPDATE			
Owner's Manual Supplement – (NVLW)			

Claim Entry Instructions

After Update has been completed, enter claim as soon as possible to help prevent work from being duplicated elsewhere. Attach the ELSA screen print showing action *open on the day of repair* to the repair order.

If customer refused campaign work or vehicle is out of the specified warranty parameter for this Update:

- ✓ U.S. dealers: Submit request via WISE under the *Campaigns/Update/Recall Closure* option.
- ✓ Canada dealers: Upload the repair order [signed by customer] to Volkswagen WIN/Operations/Campaign Closure.

Service Number	06F2		
Damage Code	0099		
Parts Vendor Code	WWO		
Claim Type	Sold vehicle: 7 10 Unsold vehicle: 7 90		
Causal Indicator	Mark labor as causal		
Vehicle Wash/Loaner	Do not claim wash/loaner under this action U.S.A.: Loaner/rental coverage cannot be claimed under this action. However, loaner/rental may be covered under the Alternate Transportation Program. Please refer to the Volkswagen Warranty Policy and Procedures Manual for loaner claims information and reimbursement details. Canada: Loaner/rental coverage cannot be claimed under this action. Please refer to the Volkswagen Service Loaner Program to determine loaner eligibility.		
Criteria I.D.	01		
	LABOR		
	Labor Op	Time Units	Description
	0671 33 99	10	Print and place owner's manual supplement in glovebox

Release Date	05/24/2022	Technical Service Bulletin	
06F2 UPDATE Owner's Manual Supplement – (NVLW)			

- Additional Actions** Some of the affected vehicles may be involved in additional Actions. Please check your ELSA Campaign/Action Information screen so that any *additional required work can be done simultaneously*.
- Verifying Vehicle Eligibility** To verify vehicle eligibility for this Update, *always* check the ELSA Campaign/Action Information screen. The ELSA system is the *only* binding inquiry and verification system; other systems are not valid and *may result in non-payment* of a claim.
- Help for Claim Entry** For questions regarding claim entry, contact Volkswagen Warranty.
- Required Customer Notification** Inform your customer in writing by recording on the Repair Order any and all work that was conducted on the vehicle, including any and all updates completed under this Update.

Additional Information

All parts and service references provided in this Update are subject to change and/or removal. Always check ELSA for the most current version of this document.



Seats and head restraints

Atlas, Teramont

This supplement describes revisions that have been produced after publication of the Owner's Manual. The new section replaces the corresponding section "Seats and head restraints" in the Owner's Manuals:

- 2020/07
- 2021/01
- 2021/08

Please refer to the other sections of the Owner's Manual for all other information, descriptions, and specifications for the operation and handling of your vehicle, such as information you should know regarding your personal safety and the safety of your passengers.

Seats and head restraints
Atlas, Teramont
V1, R1, Nachtrag 1, en_US
Print status: 06.09.2021
English USA: 2021.11
Teile-Nr.: 3CN012723FC



3CN012723FC



WARNING

Operating, servicing and maintaining a passenger vehicle or off-highway motor vehicle can expose you to chemicals including engine exhaust, carbon monoxide, phthalates, and lead, which are known to the State of California to cause cancer and birth defects or other reproductive harm. To minimize exposure, avoid breathing exhaust, do not idle the engine except as necessary, service your vehicle in a well-ventilated area and wear gloves or wash your hands frequently when servicing your vehicle. For more information go to www.P65Warnings.ca.gov/passenger-vehicle.

BT-1671

Fig. 1

Volkswagen AG works constantly to improve all of its products. Due to ongoing vehicle development, changes in design, equipment, and technology are possible at any time. The information regarding equipment, appearance, performance, dimensions, weights, fuel consumption, standards, and functions of the vehicle is the information that was available at the time of the editorial deadline for this manual. Some of the equipment and functions may not be available until later or may be available only in certain countries. Contact your local authorized Volkswagen dealer or authorized Volkswagen Service Facility for more information.

The vehicle shown may be equipped with optional equipment for an additional price and is only offered in certain markets. An authorized Volkswagen dealer can inform you about differences in your particular country. Subject to change. No legal obligations or commitments may be derived from the information, illustrations, and descriptions in this manual.

No reprint, reproduction, or translation of this Manual is permitted, even in excerpts, without the express written consent of Volkswagen AG.

Volkswagen AG expressly reserves all rights under applicable copyright law. Subject to change.

© 2021 Volkswagen AG

Folding the third row seat into the cargo floor position

Each rear seat can be folded forward individually to increase the size of the luggage compartment.

Folding the third row seats into the cargo floor position

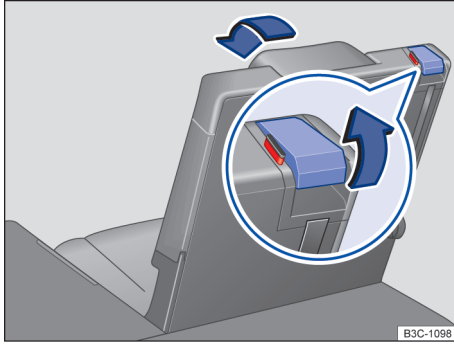

Fig. 2 Third row seat: folding the rear seat into the cargo floor position.

1. Open the trunk lid.
2. Remove the luggage compartment cover if necessary.
3. Move the head restraints all the way down.
4. Release the safety belts from both belt buckles to reduce the risk of damage to the seat and safety belt.
5. Push the seats in the second row forward.
6. Remove any objects from the footwell in front of and behind the rear seat → ①.
7. Remove any objects from the seat well behind the rear seat.
8. To release the rear seat backrest, pull the release lever → fig. 2 all the way up.
9. Guide the rear seat backrest down by hand until it lies flat on the seat frame → ⚠.
Adults or children should not ride in the rear seat when the rear seat is folded forward → ⚠.
10. Close the trunk lid.

Folding the third row seats back

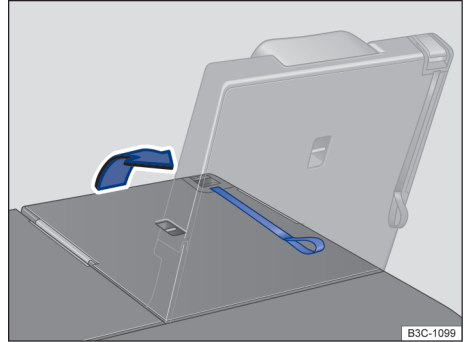

Fig. 3 Third row seat: folding the rear seat back.

1. Open the trunk lid.
2. To fold the rear seat backrest back, pull on the loop on the rear seat backrest → fig. 3.

Or: Fold the rear seat backrest back from the passenger compartment by hand.

The red marking on the release lever → fig. 2 must no longer be visible.

3. Pull and press on the rear seat backrest to make sure that it is latched in place → ⚠.
4. Install the luggage compartment cover again if necessary.
5. Close the trunk lid.

⚠ WARNING

Uncontrolled or unintentional folding of the rear seat backrests can cause serious injuries.

- Never fold the rear seat backrest forward or back while driving.
- Make sure the safety belt is not pinched or damaged when folding the rear seat backrest back.
- Keep hands, fingers, feet, and other parts of the body out of the range of operation of the seat hinges and seat locking mechanism when folding the backrest forward and back.
- Floor mats or other objects can become caught in the hinges on the rear seat backrest or seat. This can prevent the rear seat backrest or rear seat from latching when folded into the upright position.
- Each rear seat backrest must always be locked in the upright position to ensure that the safety belts in the rear seats can provide the maximum



protection. If a seat is used without the backrest being locked in place, the passenger will move forward with the backrest in the event of sudden braking and driving maneuvers or a collision.

- A red marking on the release lever → [fig. 2](#) indicates that the rear seat backrest is not latched. The red marking must not be visible when the backrest is latched.
- Never allow people to sit in a rear seat if that rear seat backrest or the rear seat is folded forward or is not engaged.

NOTICE

Objects in the footwell in front of and behind the rear seats can be damaged when the rear seats are folded forward or back. Remove any objects before folding the seat forward or back.

- Objects in the seat well behind the third row seats can be damaged when the third row seats are folded forward or back. Remove any objects before folding the seat forward or back.
- Securing elements and cover mounts that are secured on the rail system can be damaged when the third row seats are folded forward or back, which can cause damage to the rear seats. Remove the securing elements and cover net mounts from the rail system before folding the seats forward or back.

Third row seat entry assistance

To make it easier to enter and exit the third row seats in vehicles with seven seats, the outer seats in the second row can be folded forward.

Folding second row seats forward

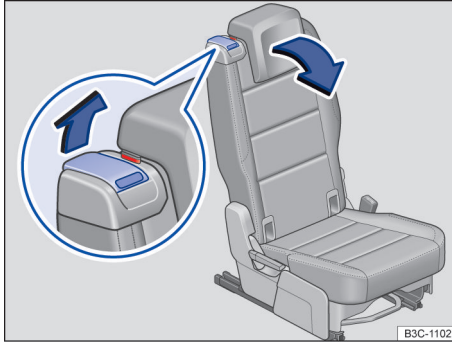

Fig. 4 Second row seats: entry assistance controls.

1. Remove any objects from the footwell in the second row of seats → ⓘ.
2. Move the head restraints all the way down.
3. Push the release lever → fig. 4 forward in the direction of the arrow until the red marking is fully visible.
4. Fold the rear seat backrest forward. The entire rear seat will fold forward and can be moved forward more → ⚠.
5. Enter and exit carefully → ⚠.

Folding the second row seats back

1. Move the rear seat all the way back.
2. Pull the release lever → fig. 4 and fold the rear seat backrest back into the upright position.

The entire rear seat will fold back → ⚠.

The rear seat must be latched securely. If the red marking on the release lever is still visible → fig. 4, the rear seat is not securely engaged.

Third row seat emergency exit function

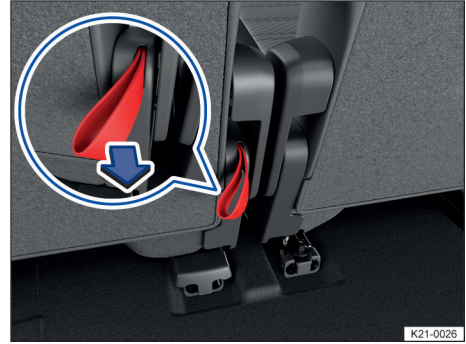

Fig. 5 Second row seats: loop for third row seat emergency exit function.

If the release lever → fig. 4 is not working, for example after a collision, the seats in the second row can be folded forward by someone in the third row to make it easier to exit the third row → ⚠.

1. Pull the loop → fig. 5 back and fold the rear seat backrest forward.

The entire rear seat will fold forward → ⚠.

⚠ WARNING

Careless or unintended use of the entry assistance and the loop for the emergency exit function can cause crashes and serious injuries.

- Never use the entry assistance or the loop for the emergency exit function while driving.
- Make sure the safety belt is not pinched or damaged when folding the rear seat backrest back.
- Keep hands, fingers, feet, and other parts of the body out of the range of operation of the seat hinges and seat locking mechanism when folding the backrest forward and back.
- Floor mats or other objects can become caught in the hinges on the rear seat backrest or seat. This can prevent the rear seat backrest or rear seat from latching when folded into the upright position.
- Each rear seat backrest must always be locked in the upright position to ensure that the safety belts in the rear seats can provide the maximum protection. If a seat is used without the backrest being locked in place, the passenger will move forward with the backrest in the event of sud-

den braking and driving maneuvers or a collision.

- A red marking on the release lever → fig. 4 indicates that the rear seat backrest is not latched. The red marking must not be visible when the backrest is latched.
- Never allow adults or children to sit in a rear seat if the rear seat or rear seat backrest is folded forward or is not securely locked into place.
- Never support yourself on or hold onto a seat in the second row that is folded forward when entering and exiting.

WARNING

If child restraints are installed in all of the second row seats, it may not be possible for someone in the third row to fold the second row seats forward in the event of an accident. Passengers sitting in the third row seats will not be able to exit the vehicle by themselves or help themselves in an emergency.

- Never install child restraints on all seats in the second row if any passengers will be riding in the third row.

NOTICE

Before folding the rear seat backrests forward or back, adjust the front seats so that the head restraints or cushions on the rear seat backrests do not bump against the front seats.

NOTICE

Objects in the footwell in the second row can be damaged when the rear seat is folded forward. Remove any objects before folding the seat forward. <