

Technical Service Bulletin

Mazda North American Operations
Irvine, CA 92618-2922



Subject: REAR CONSOLE LID DOES NOT SLIDE SMOOTHLY	Bulletin No.: 09-016/22
	Last Issued : 04/29/2022

BULLETIN NOTES

This bulletin supersedes the previously issued bulletin(s) listed below. The changes are noted in Red.

Previous TSBs:	Date(s) Issued:
09-024/20	07/22/20

APPLICABLE MODEL(S)/VINS

2020 CX-30

DESCRIPTION

Some customers may complain that the rear console lid does not slide smoothly. This may be caused by improperly positioned felt pads attached to the rear console lid lock, which may have moved out of position after repetitive use. The exposed adhesive residue may stick to the rail and disrupt smooth sliding operation.



To eliminate this concern, the felt pad positions have been changed.

Customers having this concern should have their vehicle repaired using the following repair procedure.

CONSUMER NOTICE: The information and instructions in this bulletin are intended for use by skilled technicians. Mazda technicians utilize the proper tools/ equipment and take training to correctly and safely maintain Mazda vehicles. These instructions should not be performed by "do-it-yourselfers." Customers should not assume this bulletin applies to their vehicle or that their vehicle will develop the described concern. To determine if the information applies, customers should contact their nearest authorized Mazda dealership. Mazda North American Operations reserves the right to alter the specifications and contents of this bulletin without obligation or advance notice. All rights reserved. No part of this bulletin may be reproduced in any form or by any means, electronic or mechanical---including photocopying and recording and the use of any kind of information storage and retrieval system ---without permission in writing.

REPAIR PROCEDURE

1. Verify the customer concern.
2. Open the lid and remove the felt pads (1) glued onto the locks, as shown below.

NOTE: The white arrow indicates the front side.

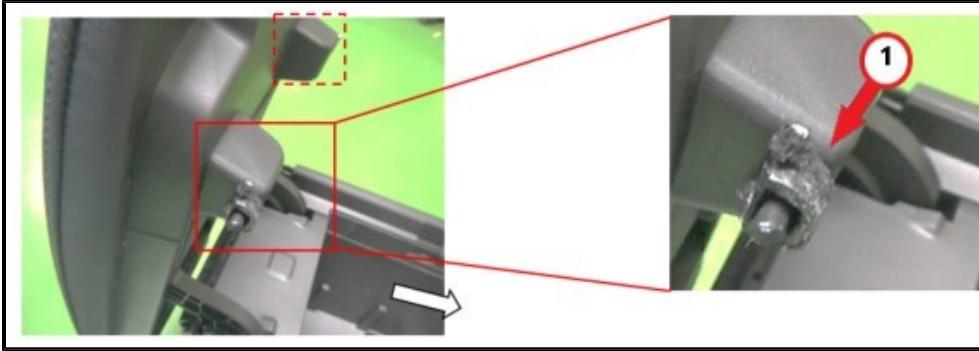

3. Remove all adhesive residue from the locks and rails (upper and lower faces).

CAUTION: Before removing the residue, verify the adhesive cleaning product will not damage the parts to be cleaned. Refer to the materials (1 - 6) list below.

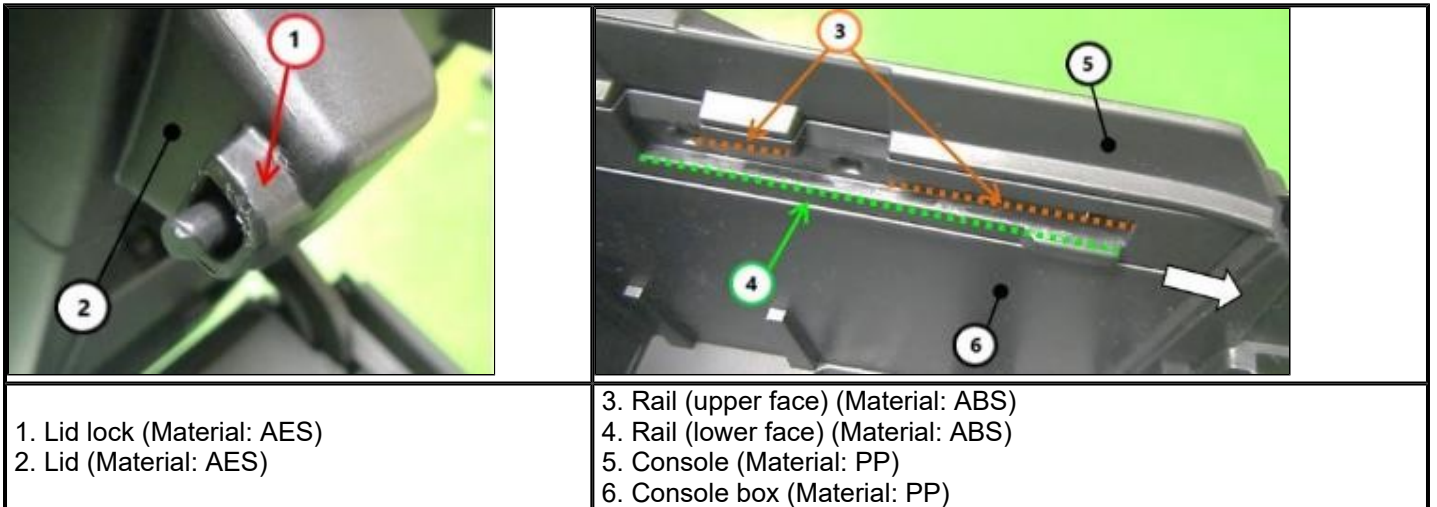

4. After removing all adhesive residue, clean the area using a clean cloth, then confirm the rails (upper and lower faces) are smooth.

CONSUMER NOTICE: The information and instructions in this bulletin are intended for use by skilled technicians. Mazda technicians utilize the proper tools/ equipment and take training to correctly and safely maintain Mazda vehicles. These instructions should not be performed by "do-it-yourselfers." Customers should not assume this bulletin applies to their vehicle or that their vehicle will develop the described concern. To determine if the information applies, customers should contact their nearest authorized Mazda dealership. Mazda North American Operations reserves the right to alter the specifications and contents of this bulletin without obligation or advance notice. All rights reserved. No part of this bulletin may be reproduced in any form or by any means, electronic or mechanical--including photocopying and recording and the use of any kind of information storage and retrieval system ---without permission in writing.

5. Prepare the felts as shown and Attach Felt A and Felt B as shown below.

<p>Felt A: 0.2 x 0.8 in (5 x 20mm) Cut Felt (1) to 0.4 x 0.8 inch (10 x 20mm) with thickness 0.2 inch (0.5mm) in half along the slit line on the felt to establish two pieces.</p>	<p>Felt B: 0.18 x 1.7 inch (4.5 x 43mm) Cut Felt (2) to 0.35 x 1.7 inch (9 x 43mm) with thickness 0.2 inch (0.5mm) in half along the slit line on the felt to establish two pieces.</p>
---	--

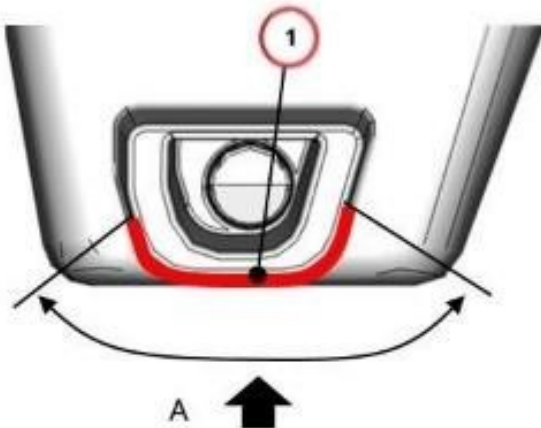
 <p>A ↑ <Side view of lid lock></p>	<p>Attach Felt A (1) to lid lock</p>
---	--------------------------------------

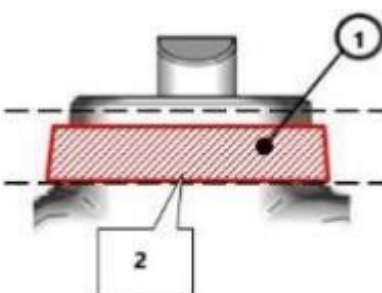
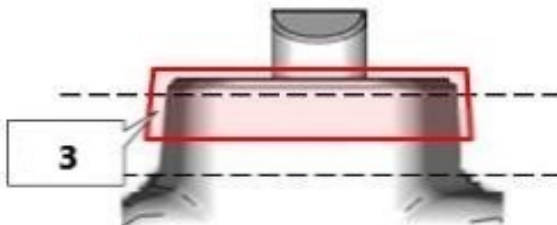
<p>Felt A Installation - Good</p> 	<p>Felt A Installation - No Good</p> 
---	---

<View from A>

- | | |
|---|---|
| 2. The felt edge must attach the lid along the entire length. | 3. The felt edge should not come out of the lid lock rim. |
|---|---|

CONSUMER NOTICE: The information and instructions in this bulletin are intended for use by skilled technicians. Mazda technicians utilize the proper tools/ equipment and take training to correctly and safely maintain Mazda vehicles. These instructions should not be performed by "do-it-yourselfers." Customers should not assume this bulletin applies to their vehicle or that their vehicle will develop the described concern. To determine if the information applies, customers should contact their nearest authorized Mazda dealership. Mazda North American Operations reserves the right to alter the specifications and contents of this bulletin without obligation or advance notice. All rights reserved. No part of this bulletin may be reproduced in any form or by any means, electronic or mechanical---including photocopying and recording and the use of any kind of information storage and retrieval system ---without permission in writing.

6. Press the newly attached felt with fingers for better bonding.

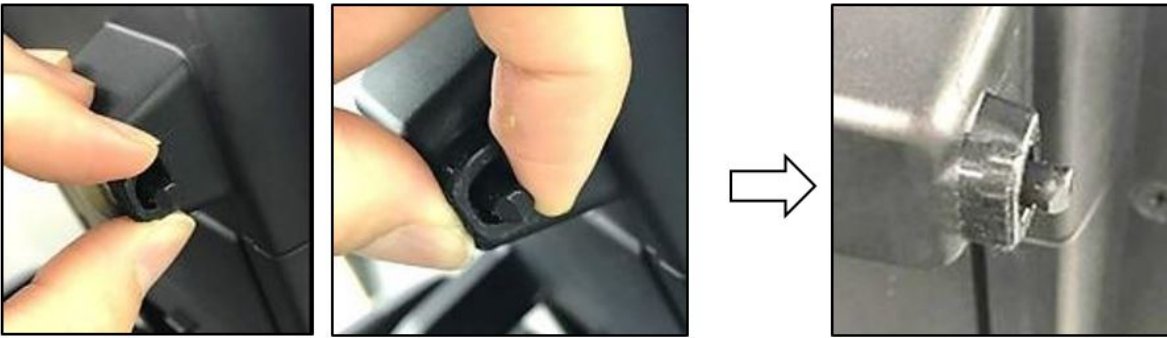

7. Attach Felt B as shown below.

NOTE: Felt B must be attached so that its two ends are located on the lock's upper face, symmetrical to the upper face central line (1), as shown below. Also, the ends of Felt B must not touch each other.

8. Glue Felt B onto Felt A (2) as shown below.

<p><Side view of lid lock></p>	<p>3. Lock's upper face central line 4. Felt B 5. Felt A</p> <p>6. Felt B 7. Felt A</p>
<p>Felt B Installation - Good</p>	<p>Felt B Installation - No Good</p>
<p><View from B></p>	
<p>2 and 8: Glue in such a way that the Felt B border does not extend past the edge of Felt A.</p>	

CONSUMER NOTICE: The information and instructions in this bulletin are intended for use by skilled technicians. Mazda technicians utilize the proper tools/ equipment and take training to correctly and safely maintain Mazda vehicles. These instructions should not be performed by "do-it-yourselfers." Customers should not assume this bulletin applies to their vehicle or that their vehicle will develop the described concern. To determine if the information applies, customers should contact their nearest authorized Mazda dealership. Mazda North American Operations reserves the right to alter the specifications and contents of this bulletin without obligation or advance notice. All rights reserved. No part of this bulletin may be reproduced in any form or by any means, electronic or mechanical--including photocopying and recording and the use of any kind of information storage and retrieval system ---without permission in writing.

9. Press the newly attached felt with fingers for better bonding.

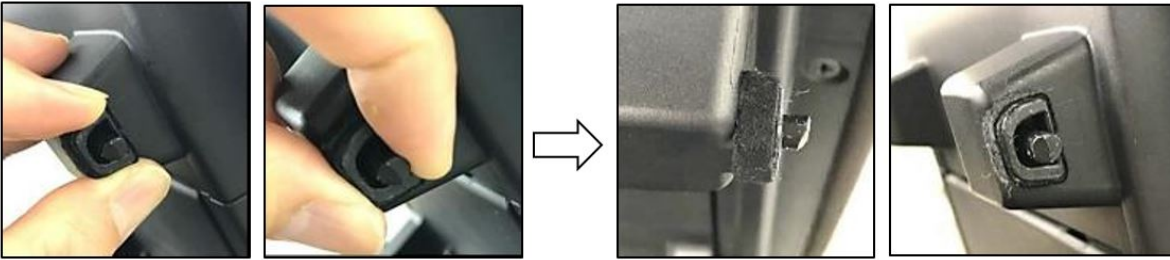

10. Repeat Steps 2 - 9 on opposite side of the console lid.

11. Verify the repair by sliding the console lid several times.

NOTE: The glue takes about 24 hours to completely dry. Recommend to the customer to wait for 24 hours before sliding the lid.

PARTS INFORMATION

Parts Number	Description	Qty.	Notes
DFY0-55-180	Spacer Set	1	2 pieces of Felt A (5mm x 20mm x 0.5mm) 2 pieces of Felt B (4.5mm x 43mm x 0.7mm)

WARRANTY INFORMATION

NOTE:

- This warranty information applies only to verified customer complaints on vehicles eligible for warranty repair.
- This repair will be covered under Mazda's New Vehicle Limited Warranty term.
- Additional diagnostic time cannot be claimed for this repair.

Warranty Type	A
Symptom Code	72
Damage Code	9G
Part Number Main Cause	DFY0-55-180
Quantity	1
Operation Number / Labor Hours:	XXS2PXRX / 0.3 Hrs.

CONSUMER NOTICE: The information and instructions in this bulletin are intended for use by skilled technicians. Mazda technicians utilize the proper tools/ equipment and take training to correctly and safely maintain Mazda vehicles. These instructions should not be performed by "do-it-yourselfers." Customers should not assume this bulletin applies to their vehicle or that their vehicle will develop the described concern. To determine if the information applies, customers should contact their nearest authorized Mazda dealership. Mazda North American Operations reserves the right to alter the specifications and contents of this bulletin without obligation or advance notice. All rights reserved. No part of this bulletin may be reproduced in any form or by any means, electronic or mechanical--including photocopying and recording and the use of any kind of information storage and retrieval system ---without permission in writing.